

morphy richards®

smart ideas for your home



POWER STEAM IntelliTemp Steam Generator with IntelliTemp

Please read and keep these instructions for future use

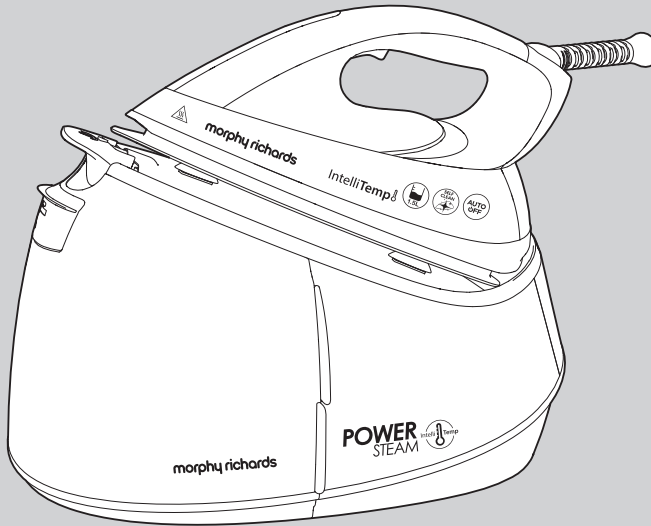

Register your guarantee online: www.morphyrichards.co.uk/support
We'll keep you updated with special offers, competitions and important product information.



IMPORTANT: To reduce limescale problems which would not be covered by the guarantee, we recommend the use of a mix of 50% tap water and 50% distilled, deionised or demineralised water (available from most large supermarkets).

Never use battery topping up fluid or water containing any substances like starch, sugar, fragrant additives or defrosted water from a refrigerator.

Remember to clean your steam generator and change the antiscald cartridge.

Failure to adhere to the above guidelines will invalidate your guarantee.

Purchase spare anti-scale cartridges to keep your product performing like new for longer. Available by calling our Spares Helpline on 0344 873 0710.

**IF YOU HAVE ANY DIFFICULTY WITH THIS PRODUCT,
INSTEAD OF TAKING IT BACK TO THE RETAILER, TRY:**

1. The instruction booklet
2. Refer to www.morphyrichards.com
3. Or call our helpline: UK: 0344 871 0944, EIRE: 1800 409 119 (For UK & Eire customers only)

www.morphyrichards.com

* Register online for your 2 year guarantee. See back of this instruction book for details. (UK and Ireland customers only)

Important safety instructions

The use of any electrical appliance requires the following common sense safety rules.
Please read these instructions carefully before using the product.

- **WARNING: Disconnect from the mains supply before carrying out any routine maintenance.**
- This appliance can be used by persons with reduced physical, sensory or mental capabilities, or lack of experience and knowledge, if they have been given supervision or instruction concerning the use of the appliance in a safe way and understand the hazards involved.
- Children shall not play with the appliance.
- Keep the appliance out of reach of children when it is energized or cooling down.
- The steam generator must not be left unattended while it is connected to the supply mains.
- The steam generator must be used and rested on a stable surface.
- When placing the iron on the steam generator base or on its heel, ensure that the surface on which the heel or base is placed is stable.
- The steam generator is not to be used if it has been dropped, if there are visible signs of damage or it is leaking.
- The filling aperture may be opened during use, due to the design of the system.
- Do not operate with a damaged steam/supply cord or grommet, it must be replaced by the manufacturer, its service agent or similarly qualified person in order to avoid a hazard.

Personal safety



CAUTION - HOT: Burns can occur from touching hot parts, hot water or steam, or the iron rest plate.

- **WARNING: Misuse of the appliance could cause personal injury.**
- **WARNING: Never direct steam at electrical components or fittings. If in doubt about the suitability of steam for cleaning an appliance, contact the appliance manufacturer for advice prior to cleaning.**
- **WARNING: Never touch the plug or cable with wet hands.**
- **WARNING: Nozzles and tools will be hot after use. Allow to cool before attempting to remove.**
- **WARNING: Do not discharge the steam towards people or animals. Danger of scalding.**

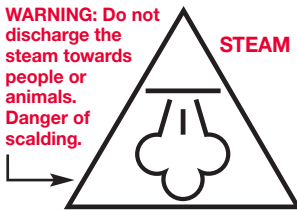

- To protect against fire, electric shock and personal injury, do not immerse cord, plug or steam generator in water or other liquid.

- The plug should be removed from the wall socket after use, before cleaning, filling or changing the accessories, or carrying out user maintenance.

Location

- Do not use or keep this product outside.
- Do not store the appliance near hot surfaces eg. ovens or heating appliances.

Mains cable

- **WARNING: A damaged or severed mains cable fitted with a plug should never be connected to the mains supply. It must be destroyed, as a damaged cable becomes hazardous if connected to a power socket.**
- Do not let the mains lead come into contact with the hot soleplate of the iron.
- Do not allow the mains lead to become strained.

Product safety

- **WARNING: Always test on an inconspicuous area first. Never use on materials that can not resist high temperature, such as dralon, natural fur etc.**
- Never modify the appliance in any way.

Other safety considerations

- Do not use any chemical detergents, perfumes, alcohol or descaler etc in water.
- Repairs to electrical appliances are only to be undertaken by trained personnel.
- Unprofessional repairs can be dangerous for users.
- Use only genuine Morphy Richards spare parts and accessories.
- The appliance must not be left unattended while connected to the supply mains.
- This appliance is intended for domestic use only. Misuse or use for commercial or any other purpose will render the guarantee invalid.

Electrical requirements

- Check that the voltage on the rating plate of your appliance corresponds with your house electricity supply which must be A.C. (Alternating Current).
- If the socket outlets in your home are not suitable for the plug supplied with this appliance, the plug should be removed by trained authorised personnel and the appropriate one fitted.
- **WARNING: This appliance must be earthed.**
- Should the fuse in the mains plug require changing, a 13 amp BS1362 fuse must be fitted.

Contents

Health and safety	2
Electrical requirements	3
Steam generator overview / Features	4
Control panel overview	5
Temperature guide	6
Location	6
Before first use	6
Using the steam generator	7 & 8
Features	9
Maintenance	9 & 10
Emptying and storing	11
Contact us	11
Guarantee	12

Steam generator overview

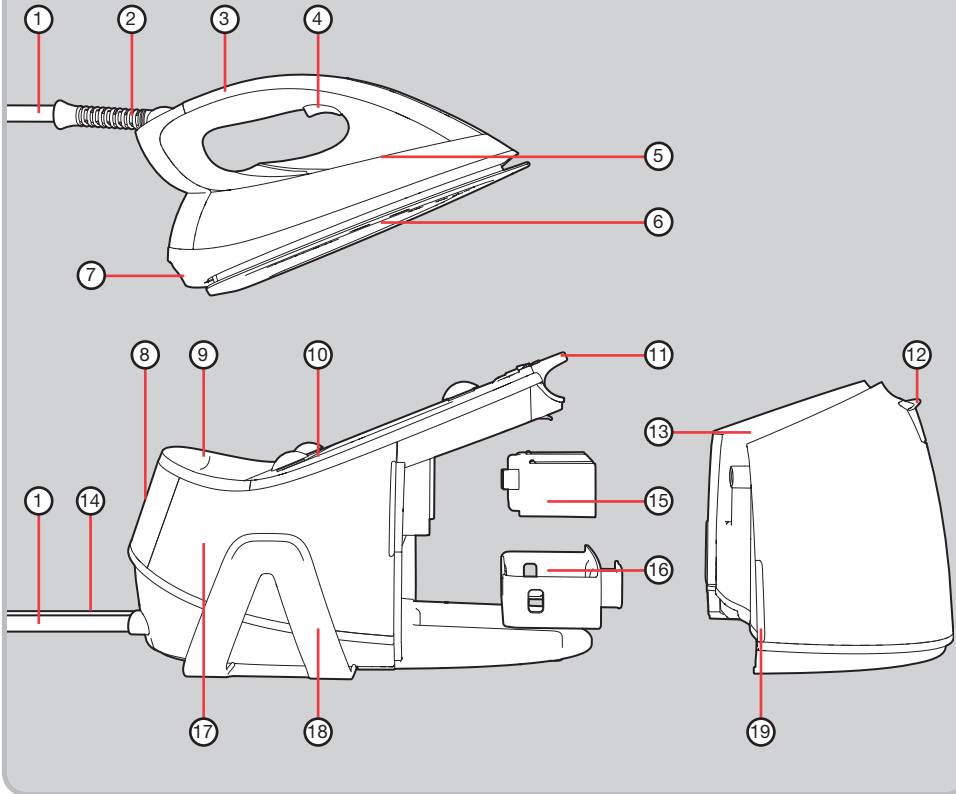

- | | | |
|-----------------------|--------------------------------|-----------------------------------|
| (1) Steam supply cord | (8) Control panel (see page 5) | (15) Antiscaling cartridge |
| (2) Cable support | (9) Iron rear docking hook | (16) Antiscaling cartridge drawer |
| (3) Iron handle | (10) Iron rest plate | (17) Base unit |
| (4) Steam trigger | (11) Iron-to-base lock | (18) Cord storage clip |
| (5) Iron | (12) Filling cap | (19) Water tank removal tabs |
| (6) Soleplate | (13) Detachable water tank | |
| (7) Iron heel | (14) Power cord | |

Control panel (8) overview

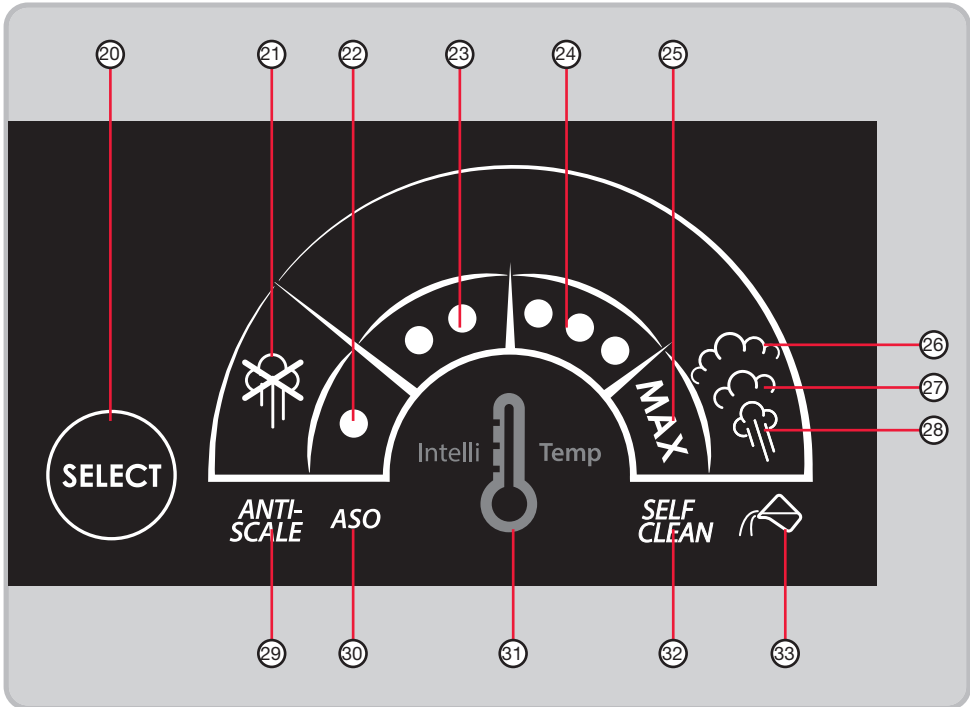

Select button (20)

Continue to press the select button until the desired temperature setting is reached.

No steam indicator (21)

This illuminates when the 1 dot temperature setting is selected. The low temperature is not suitable for steaming.

Temperature setting indicators (22/23/24/25)

The temperature indicators correspond with the International Textile Care Labelling Code as shown on the labels of your garments (see 'Temperature guide' on page 6).

Steam level indicators (26/27/28)

The steam level is automatically adjusted to suit the selected temperature setting. The steam level indicators change when you select your desired temperature setting.

Antiscale indicator (29)

When the antiscaling cartridge requires changing, the antiscaling indicator will illuminate. This indicator will flash if the antiscaling cartridge is not fitted properly.

Auto shut-off indicator (30)

This indicator illuminates if the appliance has entered auto shut-off mode after not being used for 10 minutes.

IntelliTemp setting indicator (31)

This illuminates when the product has reached the default temperature, allowing the appliance to iron all ironable fabrics without the temperature needing to be adjusted.

Self Clean indicator (32)

This indicator will illuminate when the system requires cleaning.

Low water indicator (33)

This indicator will illuminate when there is insufficient water in the tank to produce steam.

Using the Steam Generator

1a) Removing and filling the water tank

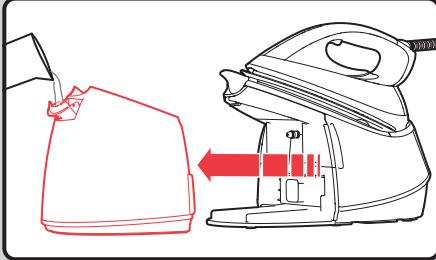

Remove the detachable water tank (13) using the water tank removal tabs (19), open the filling cap (12), and fill with water to the max fill line. Replace the water tank.

IN HARD WATER AREAS, WE RECOMMEND A MIX OF 50% TAP WATER AND 50% DISTILLED, DEIONISED OR DEMINERALISED WATER.

Never use battery topping up fluid or water containing any substances like starch, sugar, fragrant additives or defrosted water from a refrigerator.

NOTE: Please see point 2 of 'Exclusions' on page 12.

Re-filling during use

If the water level is too low, the low water indicator will illuminate and the unit will not produce steam. If this happens, refill the detachable water tank (13) with water.

2) Default IntelliTemp Setting



Plug the appliance into a mains outlet to switch the product on. A beep will be heard and the IntelliTemp logo (31) will illuminate on the control panel (8). The default temperature is the IntelliTemp setting, this allows the appliance to iron all ironable fabrics without the temperature needing to be adjusted. However, do not iron any fabric with this symbol . The IntelliTemp setting indicator (31) will stop flashing and remain constant when the IntelliTemp setting is reached.

1b) Filling the water tank in situ

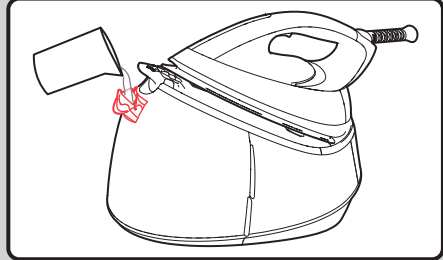

Alternatively, the water tank may be filled without removing it from the base unit (17). Simply open the filling cap (12), and fill the water tank with water to the max fill line.

3) Temperature Selection



If a different temperature than IntelliTemp setting is required to suit the garment (see 'Temperature guide' on page 6), you may adjust the temperature as follows: press the select button (20) repeatedly until the required temperature setting indicator (22/23/24/25) is displayed. Pressing the select button cycles the options as shown in the next step.

Using the Steam Generator (continued)

4) Temperature and steam level

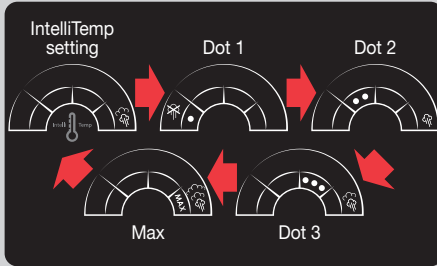

The appropriate temperature setting indicator (22/23/24/25/31) will flash until the desired temperature is reached. Begin ironing when the temperature indicator illuminates constantly. If you turn the temperature down, wait until the temperature indicator stops flashing before continuing ironing.

The steam level is automatically adjusted to suit the selected temperature setting. This is denoted by the steam level indicators (26/27/28) on the control panel (8), which will change along with the temperature setting indicators when you select your desired temperature level. Press and hold the steam trigger (4) for constant steam.

6) Steam boost

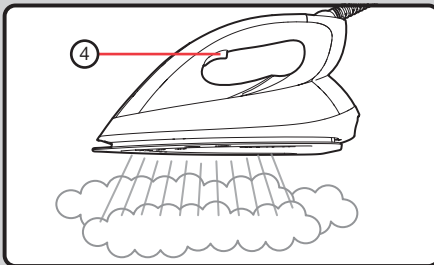

The steam function is ideal for relaxing the fibres of tougher fabrics (like jeans and linen) and getting rid of those stubborn, hard to reach creases.

To produce a steam boost during ironing, simply double-press the steam trigger (4). To deactivate the boost, press once on the steam trigger again.

The appropriate steam level indicator will flash whilst the steam trigger is pressed, indicating that steam is being produced.

NOTE: steam cannot be produced on the 1-Dot setting - this is highlighted by the no steam indicator (21) being visible on the control panel (8) whilst the 1-Dot setting is selected.

When using the steam function and replacing the iron (5) back onto the iron rest plate (10), residual steam may create condensation on the base. This is not the iron leaking and is normal.

5) Unlocking the iron

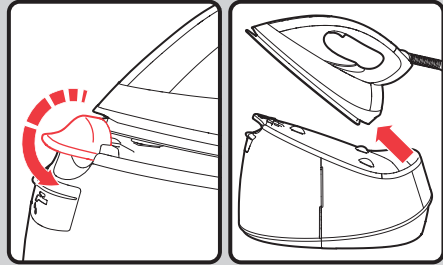

Unlock the iron (5) from its storage position on top of the base unit (17) by rotating the iron-to-base lock (11) - this enables you to lift the iron heel (7) away from the iron rear docking hook (9).

During use, the iron may be rested on the iron rest plate (10) with the iron-to-base lock rotated so the flat side is upper-most (in the unlocked position).

7) Switching off

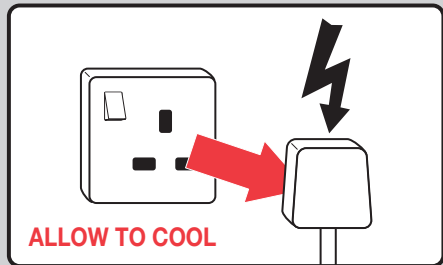

When you have finished ironing, disconnect the plug from the mains outlet.

NOTE: The product may occasionally produce a pumping sound during steam ironing. This is normal and is caused by water being pumped from the water tank to the steam generator. **If the pumping sound suddenly becomes louder or the steam diminishes, check and refill the water tank if it has become empty.**

Features

Dry ironing

To use your steam generator as a dry iron only, follow steps 2, 3, 4 and 5 of 'Using the Steam Generator' on page 7 and 8. You do not need to put water in the water tank (13).

Auto shut-off

If the steam trigger (4) is not used for 10 minutes, the product will automatically turn off for safety and to save energy. When this happens, the auto shut-off indicator (30) will flash.

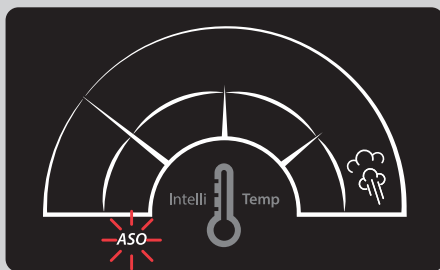

To restart, press the select button (20) and wait for the temperature to rise again.

NOTE: The appliance is not turned off completely in auto shut-off mode. To switch the product off, unplug the product from the mains outlet.

Steam function

During steaming, small amounts of water may be ejected from the soleplate (6). This is normal and can be avoided by using the steam for short amounts of time and only when the iron is at the correct temperature (the temperature setting indicator (22/23/24/25/31) on the control panel stops flashing when ready).

Sudden jolts to the boiler unit can also cause water droplets on the soleplate; therefore, do not move the base unit (17) during ironing.

We recommend for first time ironing that you iron over an old towel.

Vertical steam

Vertical steam is useful for removing creases from hanging clothes, curtains, upholstery, etc. Hold the iron (5) between 1cm and 2cm away from the item and press the steam trigger (4) twice in quick succession for a longer boost of steam. To turn the steam boost off, press the steam trigger again.

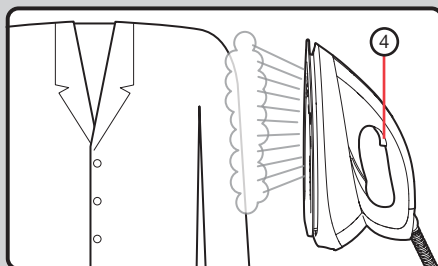

WARNING: Do not use the vertical steam feature on clothes that are being worn.

Maintenance

The product requires an antiscalc cartridge to help reduce limescale and extend its life. The antiscalc indicator (29) will illuminate to prompt you to replace the antiscalc cartridge which is located in the base unit (17) behind the water tank (13). The antiscalc indicator (29) will go out only after the antiscalc cartridge has been replaced.

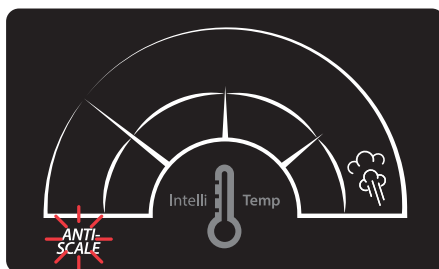

Replacing the antiscal cartridge (15)

- 1 **The appliance must be plugged in and switched ON whilst changing the cartridge, otherwise the antiscal indicator (29) will not go out.**
- 2 Remove the water tank (13) from the base unit (17) by holding the tabs on the side of the water tank and pulling the tank away from the base unit.



CAUTION: The cartridge may be very hot. Be careful when releasing the old cartridge.

- 3 Grasp the grip on the front of the cartridge drawer (16) and pull it out from the base unit. Lift the old cartridge out of the drawer and dispose of it.

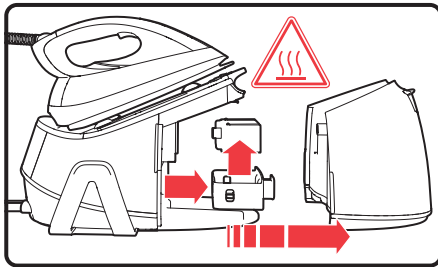

- 4 Remove the new anti-scale cartridge (15) from the bag and immerse in water for 5 minutes for better filtration.
- 5 Place the new antiscal cartridge into the cartridge drawer and push the drawer back into the base unit until it clicks into place.
- 6 Push the water tank back into the base unit until it clicks into place.
- 7 Hold the steam trigger (4) for up to two minutes to pull the water through the antiscal cartridge and out through the soleplate (6) as steam.

NOTE: If no antiscal cartridge is installed, or the antiscal cartridge is not installed correctly, the antiscal indicator will continue to flash and the appliance will not work correctly.

Self clean

The self clean function removes scale and minerals which have built-up in the steam chamber. This function must be performed every time the self clean indicator (32) illuminates.

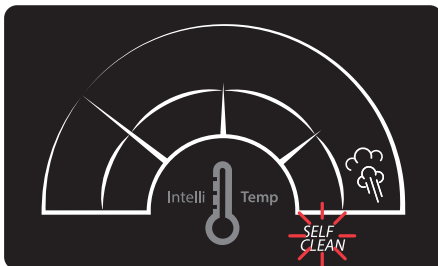

CAUTION: Boiling hot water and lots of steam will drain from the holes in the soleplate during self clean. Position yourself comfortably near a sink before you start. The self clean process will take up to 5 minutes to complete. Do not place the iron back on the base until the self clean process has completed.

- 1 Fill the water tank (13) (see step 1 of 'Using the Steam Generator' on page 7).
 - 2 Press and hold the select button (20) and steam trigger (4) and hold them both for 3 seconds. A beep will be heard and the self clean indicator (32) will flash, showing the product is ready to begin self cleaning. Release the select button and steam trigger.
 - 3 Hold the iron (5) at approximately 15 centimetres above an empty sink in the horizontal ironing position.
 - 4 Water containing loose scale and minerals will be ejected through the holes in the iron's soleplate (6).
- NOTE: Self clean cannot be aborted until the process is complete.
- 5 Once self clean is complete, the iron will resume at the previous ironing setting and your previous temperature setting indicator (22/23/24/25/31) will display on the control panel (8).
 - 6 Iron over a damp cloth to remove any deposits on the soleplate, this will also remove any water marks that may have formed on the soleplate.
 - 7 Turn off the product (see step 7 of 'Using the Steam Generator' on page 8).

To clean a coated soleplate

Do not use scouring powder or solution as this could cause damage to the coating.

If any man-made fibres fuse to the soleplate (6), set the iron at the MAX setting and pass it over a clean piece of cotton to draw the deposit off the surface.

To clean the exterior

Allow the unit to cool and wipe over with a damp cloth and mild detergent, then wipe dry.

Emptying and storing

Allow the appliance to cool.

Remove the detachable water tank (13). Open the filler cap (12), and empty the water tank. Once the water tank is empty, re-attach it to the base unit (17).

Storing the steam iron

Lock the iron (5) into the storage position on top of the base unit (17) as follows:

- 1 Ensure the iron-to base lock (11) is in the unlocked position (flat side facing upwards).

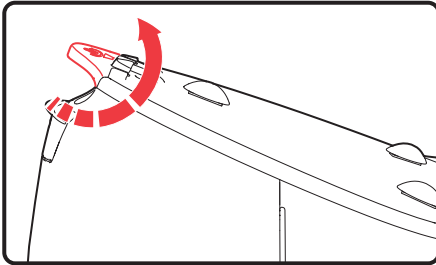

- 2 Push the iron heel (7) into the rear docking hook (9) and rest the soleplate (6) on the iron rest plate (10).

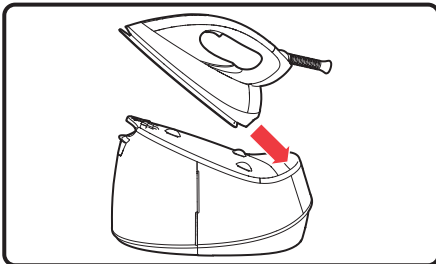

- 3 Ensure the tip of the soleplate is pointing to the arrow on the flat side of the iron-to-base lock. Then rotate the iron-to-base lock through 180° around the tip of the soleplate, securing the iron in place.

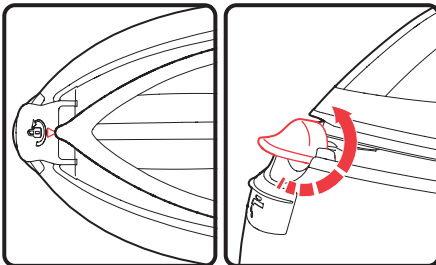

- 4 Attach the cord storage clip (18) to either side of the base unit (17) by pushing the nodules on the lower part of the clip into the holes on the underside of the base unit.

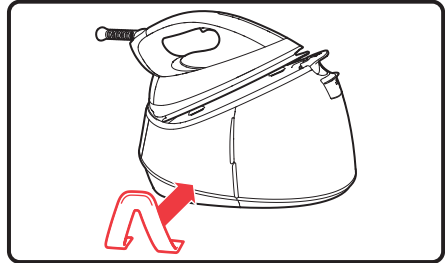

- 5 Straighten any kinks in the steam supply cord (1) and the power cord (14). Next, loosely loop the cords together in a figure 8 formation and fix them in position in the cord storage clip (18). Ensure there is slack on the cables at the base unit end, and on the steam supply cord at the cable support (2) on the iron (5).

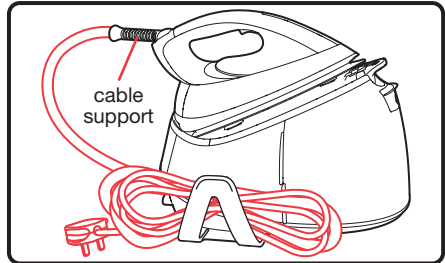

WARNING: Do not wrap the cables too tightly as this can stress and damage the wires inside. Damage to the cables caused by wrapping too tightly will not be covered by the guarantee.

Contact us

Helpline

If you are having a problem with your appliance, please call our Helpline, as we are more likely to be able to help than the store you purchased the item from. Please have the product name, model number and serial number to hand when you call to help us deal with your enquiry quicker.

UK Helpline: 0344 871 0944

IRE Helpline: 1800 409 119

Spares: 0344 873 0710

Talk To Us

If you have any questions or comments, or want some great tips to help you get the most out of your products, join us online:

Blog: www.morphyrichards.co.uk/blog

Facebook: www.facebook.com/morphyrichardsuk

Twitter: @loveyourmorphy

Website: www.morphyrichards.com

Registering your 2 year guarantee

Your standard 1 year guarantee is extended for an additional 12 months when you register the product within 28 days of purchase with Morphy Richards. If you do not register the product with Morphy Richards within 28 days, your product is guaranteed for 1 year. To validate your 2 year guarantee register with us online at www.morphyrichards.co.uk/support

Or call our customer registration line, quoting model and serial number, these numbers can be found on the base of the product.

UK 0344 871 0242
IRE 1800 409 119

N.B. Each qualifying product needs to be registered with Morphy Richards individually.

Please note that the 2 year guarantee is only available in the UK and Ireland. Please refer to the 1 year guarantee for more information.

Your 1 year guarantee

It is important to retain the retailer's receipt as proof of purchase. Staple your receipt to this back cover for future reference.

Please quote the following information if the product develops a fault. These numbers can be found on the base of the product.

Model no.

Serial no.

All Morphy Richards products are individually tested before leaving the factory. In the unlikely event of any appliance proving to be faulty within 28 days of purchase, it should be returned to the place of purchase for it to be replaced.

If the fault develops after 28 days and within 12 months of original purchase, you should contact the Helpline number quoting Model number and Serial number on the product, or write to Morphy Richards at the address shown.

You may be asked to return a copy of proof of purchase.

Subject to the exclusions, the faulty appliance will then be repaired or replaced as appropriate and dispatched usually within 7 working days of receipt.

If, for any reason, this item is replaced or repaired during the 1 year guarantee period, the guarantee on the new item will be calculated from original purchase date. Therefore it is vital to retain your original bill receipt or invoice to indicate the date of initial purchase.

To qualify for the 1 year guarantee, the appliance must have been used according to the instructions supplied. For example, water should be emptied after each use.

Exclusions

Morphy Richards shall not be liable to replace or repair the goods under the terms of the guarantee where:

- The fault has been caused or is attributable to accidental use, misuse, negligent use or used contrary to the manufacturer's recommendations or where the fault has been caused by power surges or damage caused in transit.
- The fault has been caused by using water other than that recommended by Morphy Richards.
- The fault is caused by limescale build-up.
- The cables are damaged due to wrapping too tightly or excessive kinking.
- The appliance has been used on a voltage supply other than that stamped on the products.
- Repairs have been attempted by persons other than our service staff (or authorised dealer).
- The appliance has been used for hire purposes or non domestic use.
- The appliance is second hand.
- Morphy Richards reserves the right not to carry out any type of servicing under the guarantee at its discretion.
- This guarantee does not confer any rights other than those expressly set out above and does not cover any claims for consequential loss or damage. This guarantee is offered as an additional benefit and does not affect your statutory rights as a consumer. Morphy Richards products are intended for household use only. See usage limitations within the location safety instructions.

Disclaimer

Morphy Richards has a policy of continuous improvement in product quality and design. The company, therefore reserves the right to change the specification of its models at any time.



For electrical products sold within the European Community. At the end of the electrical products useful life, it should not be disposed of with household waste.

Please recycle where facilities exist. Check with your Local Authority or retailer for recycling advice in your country

 WARNING Puro-lite® MB400	ANTI SCALE REFILL	
	Causes serious eye irritation Causes mild skin irritation Wash hands thoroughly after handling Wear protective gloves / protective clothing / eye protection / face protection.	
First Aid measures If in eyes, rinse cautiously with water for several minutes. Remove contact lenses if present and easy to do, continue rinsing. If eye irritation persists, Get medical advice / attention.		
Polystyrene sulphonic acid Polyvinyl benzyl trimethyl ammonium hydroxide	CAS 69011-20-7 CAS 69011-18-3	Max 30% by vol. Fill Weight <100g

**IF YOU ARE HAVING A PROBLEM
WITH ONE OF OUR PRODUCTS,
CALL OUR HELPLINE:**

**UK: 0344 871 0944
EIRE: 1800 409 119
SPARES: 0344 873 0710**

morphy richards

The After Sales Division
Morphy Richards Ltd
Mexborough, South Yorkshire,
England, S64 8AJ

www.morphyrichards.com

