

# Elsie

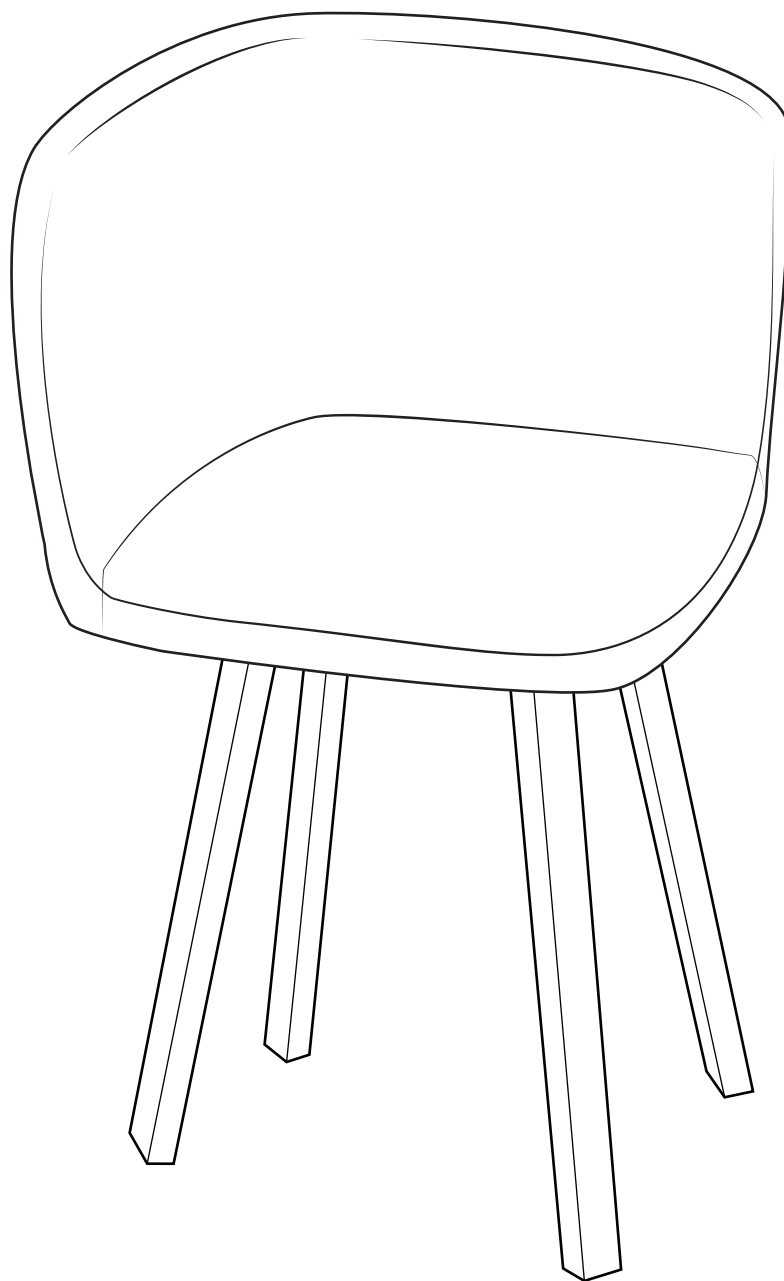

## Spare Parts

 [www.argos-support.co.uk](http://www.argos-support.co.uk)

 [Help@ClickSpares.co.uk](mailto:Help@ClickSpares.co.uk)

 0370 112 1928

## Customer Support

 0345 640 2020

 [habitat.co.uk/help/contact-us](http://habitat.co.uk/help/contact-us)



# Safety and Care Advice

---

## Product Details

8479066 - AH2 ELSIE CLEAR GLASS 4 BLACK CHRS SPAC  
7618794 -AH ELSIE GLASS BLK 4 CHAR VELVET CHAIRS  
7355992 -AH ELSIE GLASS CHRM 4 CHAR VELVET CHAIRS  
7359462 -AH ELSIE GLASS BLK 4 TAN PU CHAIRS

## IMPORTANT, RETAIN FOR FUTURE REFERENCE: READ CAREFULLY.

- Keep children and animals away from the work area, small parts could choke if swallowed.
  - Make sure you have enough space to layout the parts before starting.
  - This product has been constructed to be used in the domestic environment only and not for commercial purposes.
  - Assemble the item as close to its final position (in the same room) as possible.
  - Assemble on a soft level surface to avoid damaging the unit or your floor.
- 
- We do not recommend the use of power drill/drivers for inserting screws as this could damage the unit. Only use hand screwdrivers.
  - Parts of the assembly will be easier with 2 people.
  - Dispose of all packaging carefully and responsibly.

## Care and maintenance

---

- Only clean using a damp cloth and mild detergent. Do not use abrasive cleaners.
- Use a dry cloth to clean the product, furniture polish is not recommended.
- From time to time check that there are no loose screws, nuts or bolts. If there are please re-tighten.
- This product should not be discarded with household waste. Take to your local authority waste disposal centre.

## Additional Guidance

---

- Assemble all parts and bolts loosely during assembly, only once the product is complete should you fully tighten the bolts.
- Regularly check and ensure that all bolts and fittings are tightend properly.
- Maximum user weight 110kg.
- This product is compliant BS EN 12520 : 2015

# Parts

---

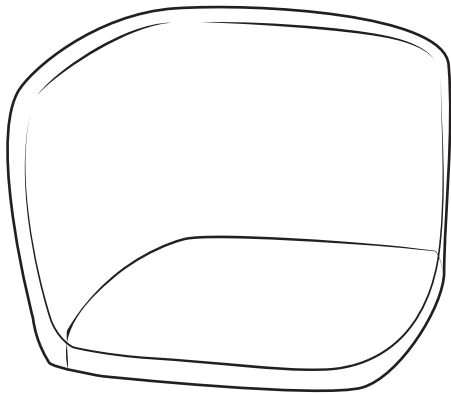

**1** Seat

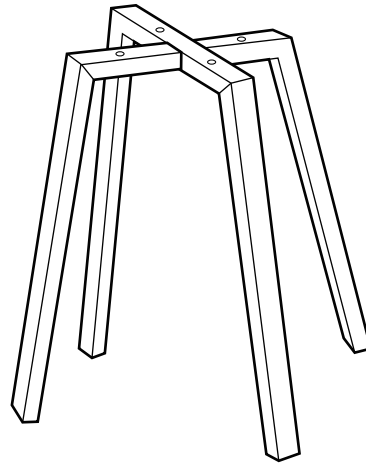

**2** Leg

## Fittings (Shown to scale)

---

### Bag 1

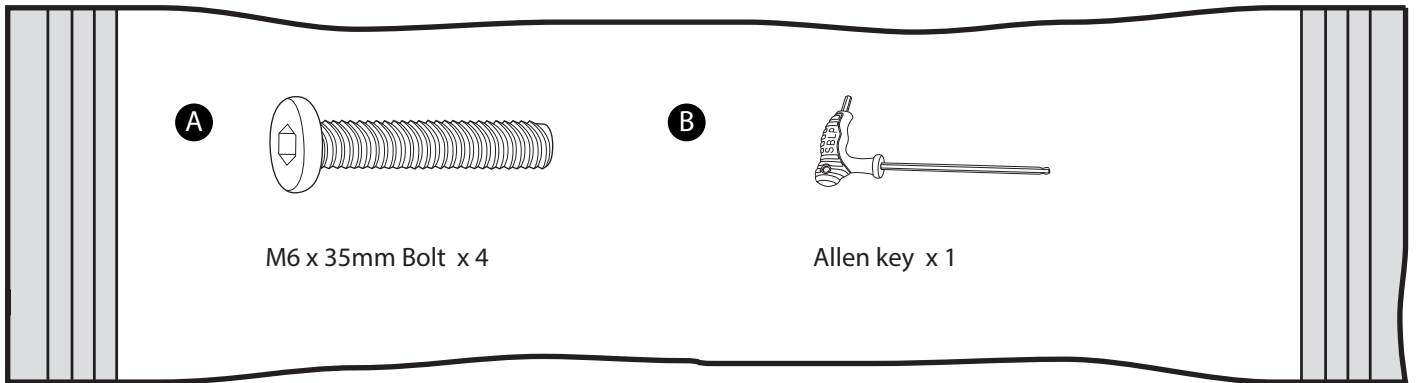

## Tools required

---

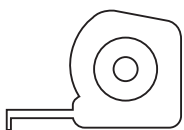

Ruler/tape  
measure

# 1

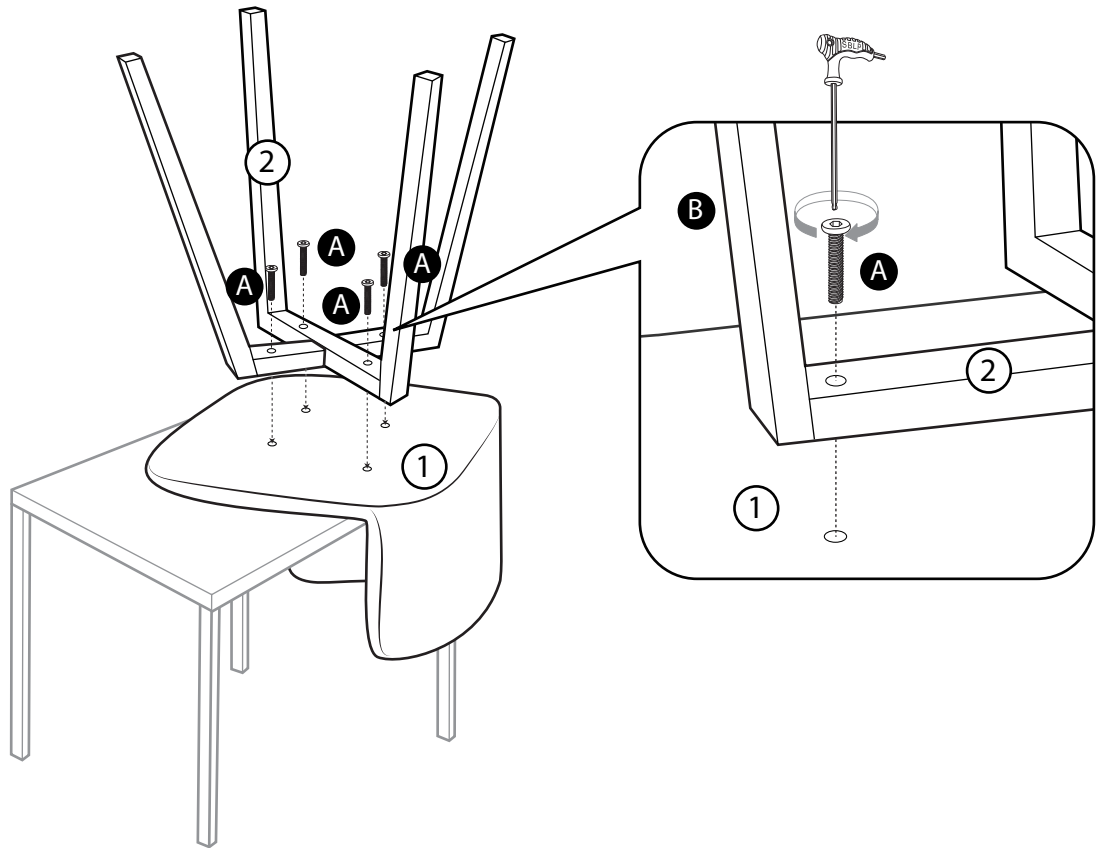
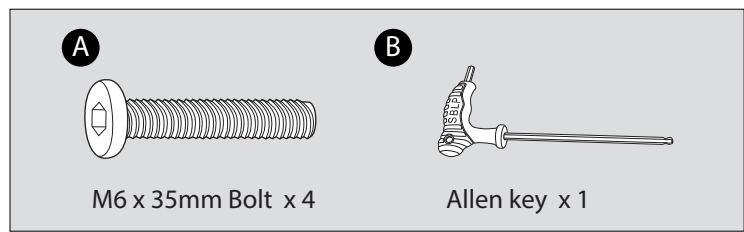
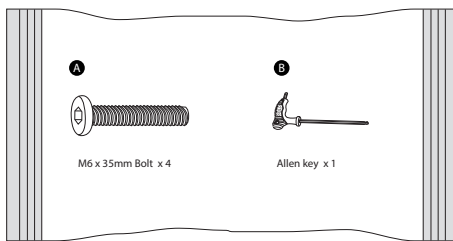

# 2

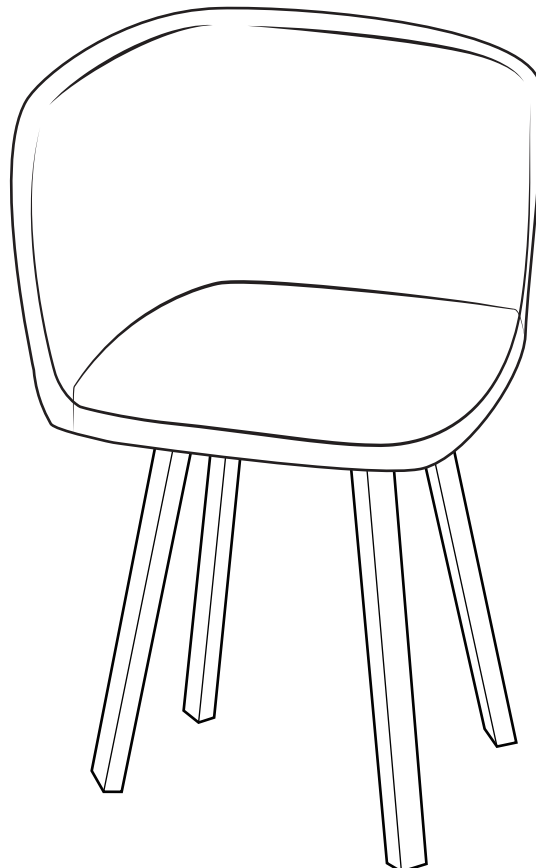

Assembly complete.