

# CUGGL WALNUT LIGHTWEIGHT STROLLER

IMPORTANT- KEEP THE INSTRUCTIONS FOR FURTHER REFERENCE

837/3399

cuggl 

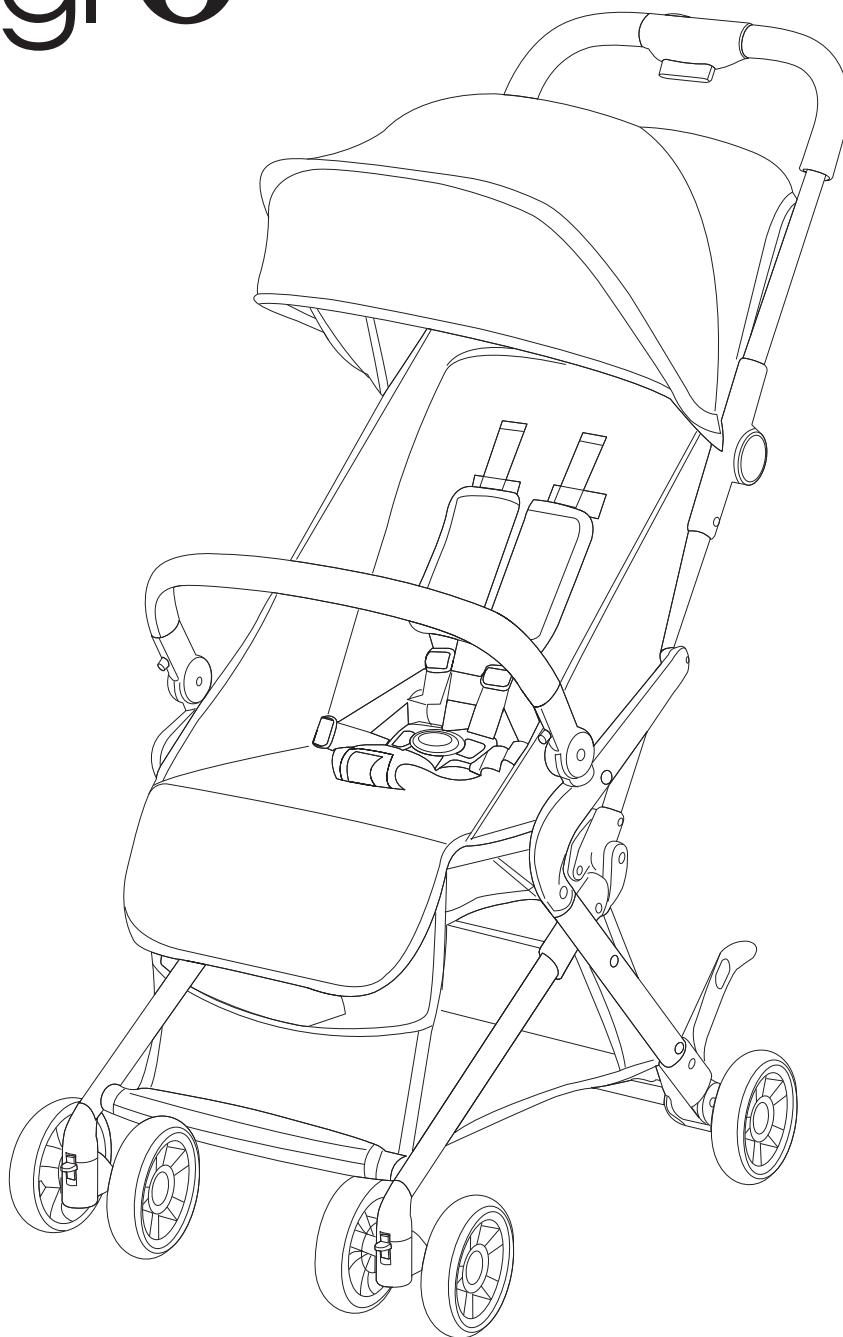

 up to	33lbs
	15kg

Suitable for children from 6 to 36 months

Important-Please read the instruction fully before starting assembly

If you need help or have further question, call the Customer Helpline 03456 400 800



# Safety Information

**Important**-Please read the instruction before assembly and keep it for further reference

Thank you for choosing our product. Please always read all the instructions provided carefully before use and remember, your child's safety may be affected if you do not follow these instructions. The stroller is suitable for children from 6 months to 36 months. The max load of the stroller is 15kg, never over loaded.

- **WARNING:** Never leave your child unattended.
- **WARNING:** Ensure that all the locking devices are engaged before use.
- **WARNING:** The parking device shall be engaged when placing and removing the children
- **WARNING:** To avoid injury ensure that your child is kept away when unfolding and folding this product.
- **WARNING:** Do not let your child play with this product.
- **WARNING:** Always use the restraint system.
- **WARNING:** This product is not suitable for running or skating .
- **WARNING:** Do not use if any part is broken, torn or missing .
- **WARNING:** It may be dangerous to leave your child unattended.
- **WARNING:** This seat unit is not suitable for children over 36 months.
- **WARNING:** Accessories which are not approved by the manufacturer shall not be used.
- **WARNING:** Avoid placing the pushchair near naked heat sources such as electric bar fires, gas fires, etc. or where a child could gain access to any other kinds of hazards.
- **WARNING:** Always use the crotch strap in combination with the waist belt.
- **WARNING:** Always use the harness provided and make sure the harness is correctly fitted.
- **WARNING:** This stroller is suitable for children from 6 months to 36 months , up to 15 kgs.
- **WARNING:** Use the stroller for only one child at a time.
- **WARNING:** The maximum permissible loading for shopping basket is 5kg.
- **WARNING:** For new born baby, the seat should be in full reclining position as the baby does not has ability to control its head.
- **WARNING:** Any load attached to the handle and/or on the back of the backrest and/or on the sides of the pushchair will affect the stability of the pushchair.
- **WARNING:** Only replacement parts supplied or recommended by the manufacturer/distributor shall be used.

# Name of parts

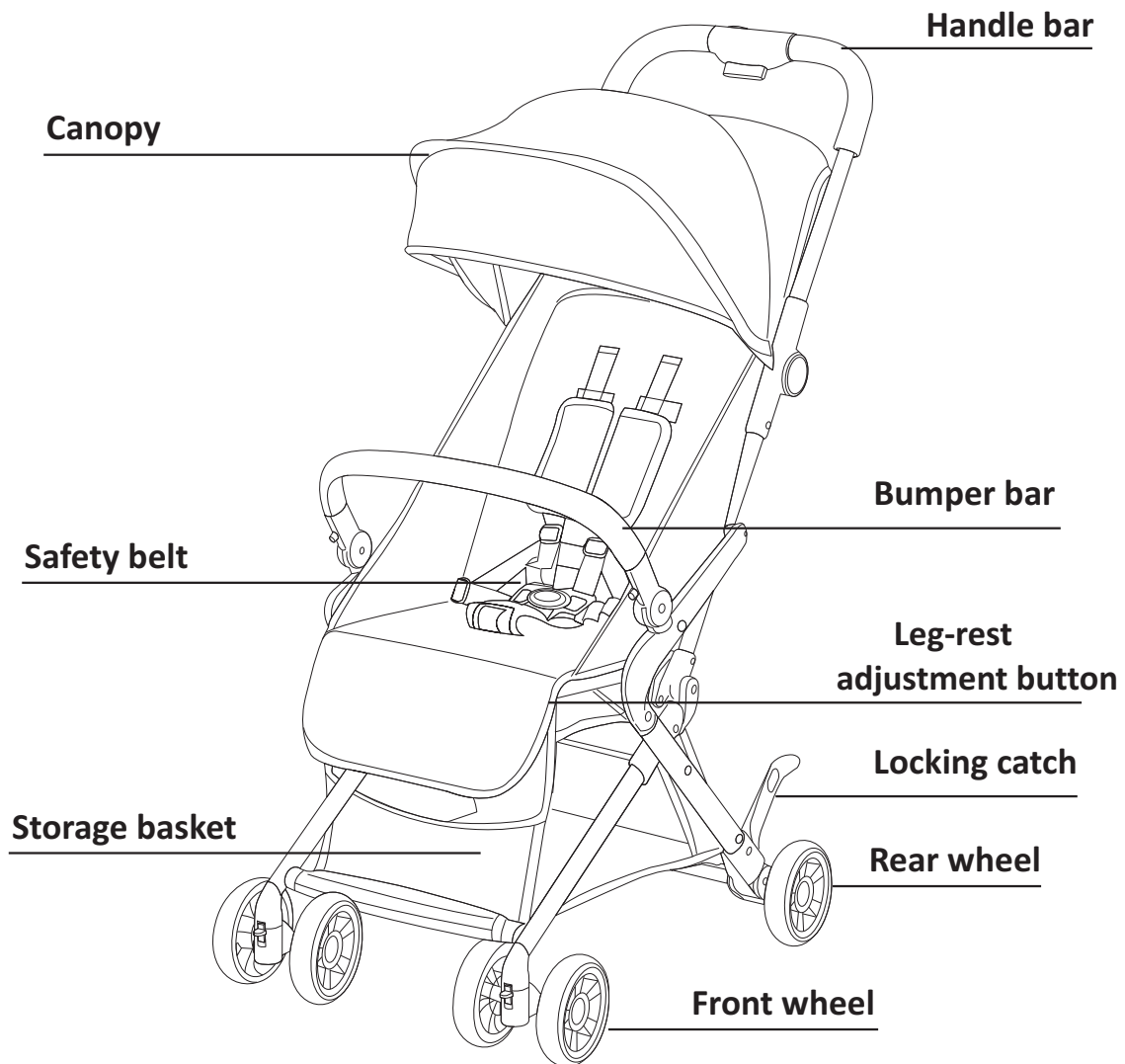

## Components

If you need help or have further question,  
call the Customer Helpline **03456 400 800**

Please check if you have all the parts listed below before starting assembly

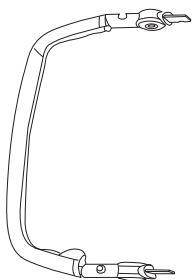

**Bumper bar**

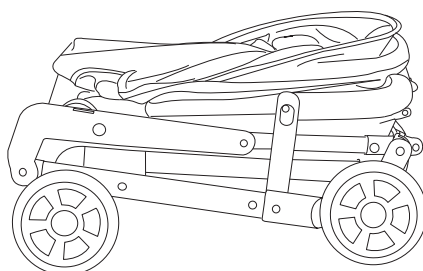

**Stroller**



**Carry bag**

# Assembly Instructions

## Step 1

### Unfold Frame:

Locate the locking catch on one side of the pushchair and lift to release it from the locking stud.

Pull the handle bar upwards first, and then pull the handle bar backwards until it "clicks" into position.

Note: check the frame whether locked before use it.

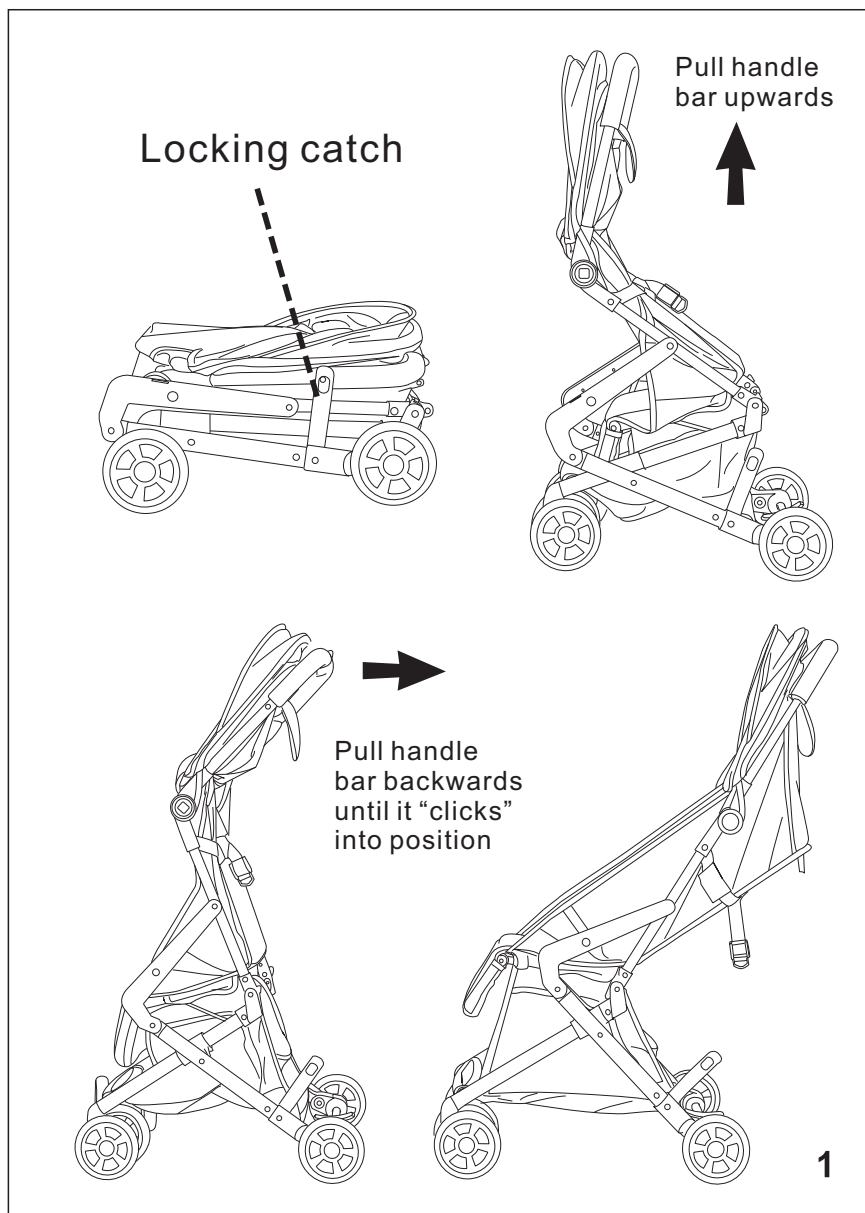

## Step 2

To open - pull gently on the front edge of the canopy.

To close - push on the front edge of the canopy.

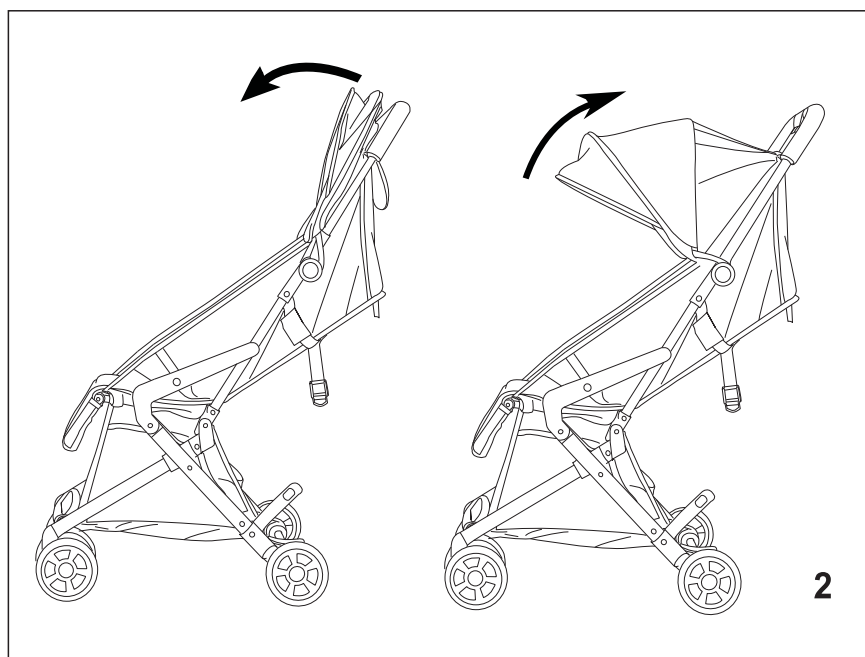

### Step 3

#### Assemble the bumper bar

Insert the bumper bar into the hole on the frame of both sides the pushchair, a click will be heard when each is engaged.

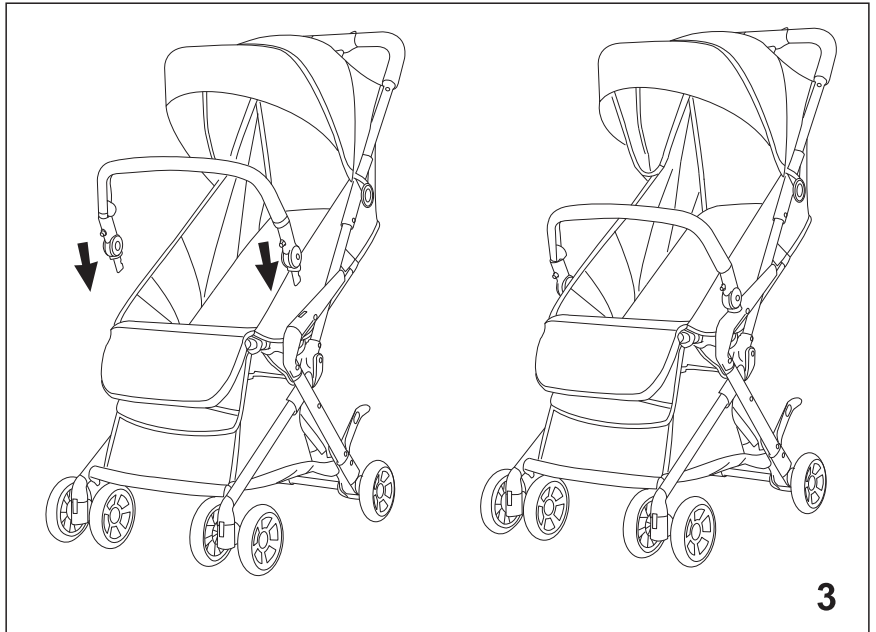

## User Instructions

### Step 1

#### The front wheel operation

The front wheels can be locked while operation so that they only travel in a straight line or unlocked so that they will swivel in any direction. Press the wheel lock downwards to fix the front wheel. Lift the wheel lock to allow the front wheel to swivel.

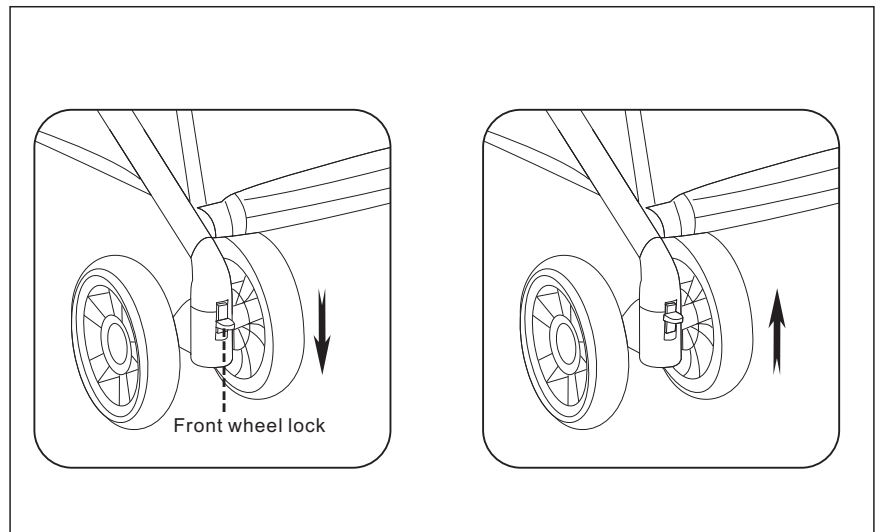

### Step 2

#### The leg rest

The leg rest can be raised or lowered using two covered levers underneath the leg rest. Squeeze both levers at the same time and lift or lower the leg rest to the desired position.

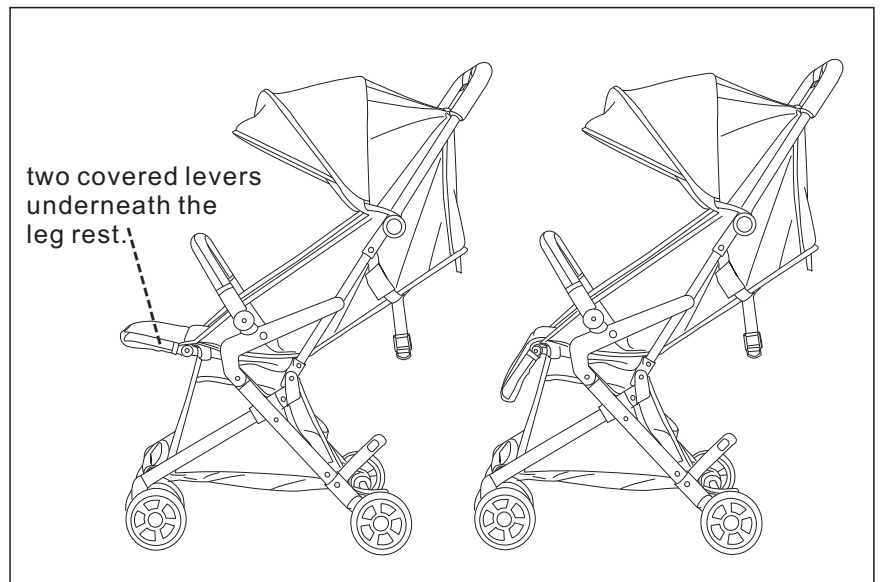

### Step 3

Slide the shoulder strap buckle ① into the housing of the waist strap buckle ②.

Repeat for the other side. Insert the completed buckle ③ into the buckle housing ④ until it engages securely in place. Repeat for the opposite side.

Adjust straps on the harness so that your child is snug but comfortable.

To release buckle, press center button on buckle housing ④.

**WARNING!** Always use the harness and ensure it is correctly fitted securely while child is in the seat.

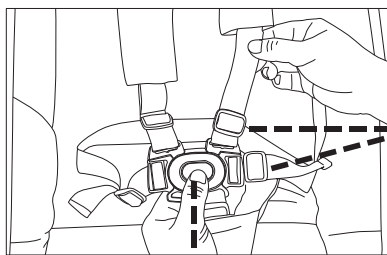
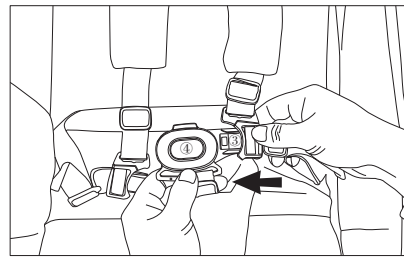
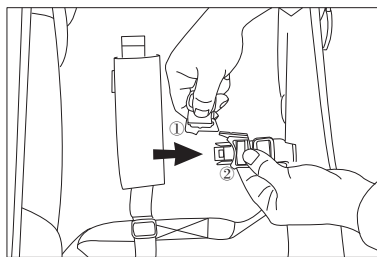

Length adjustment points

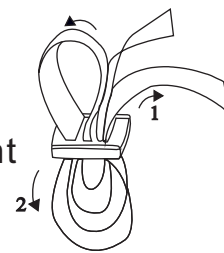

Press the center button to release buckle.

### Step 4

#### Adjusting the seat harness

Position the shoulder straps so that they use the attachment points that are just above the child's shoulders. To reposition the shoulder straps, unclip the shoulder straps from the waist band and feed through / remove from the lower strap position.

Lower shoulder strap position

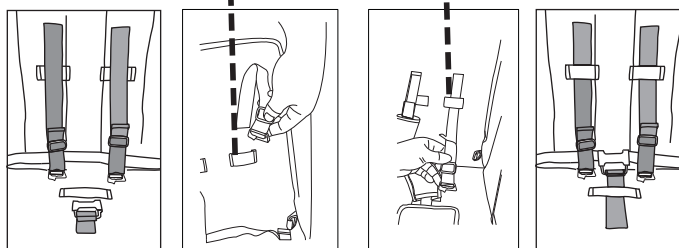

The shoulder straps can be adjusted to 2 positions

### Step 5

Press the brake pedal at the back side of stroller to brake stroller.  
Lift the brake lever to release stroller.

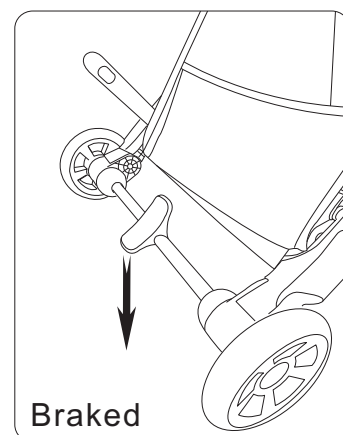
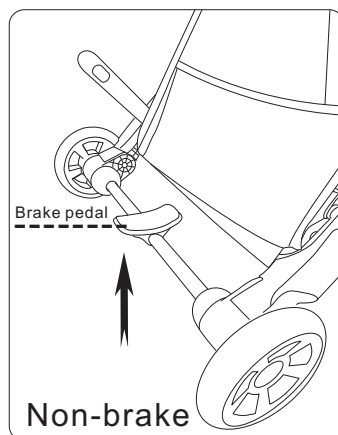

## Step 6

Adjust the backrest:  
As shown, one hand hold the end of webbing strap, another hand pinch the adjusting buckle and pull it to move backrest to desired position.

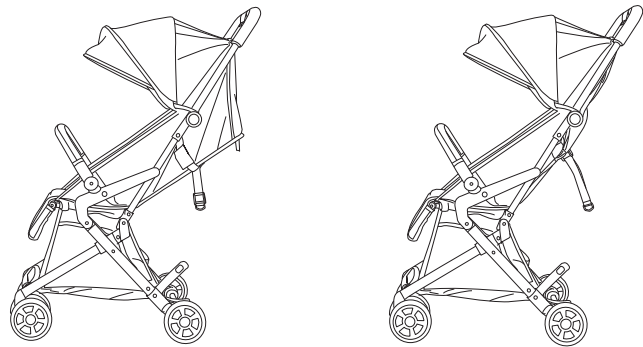
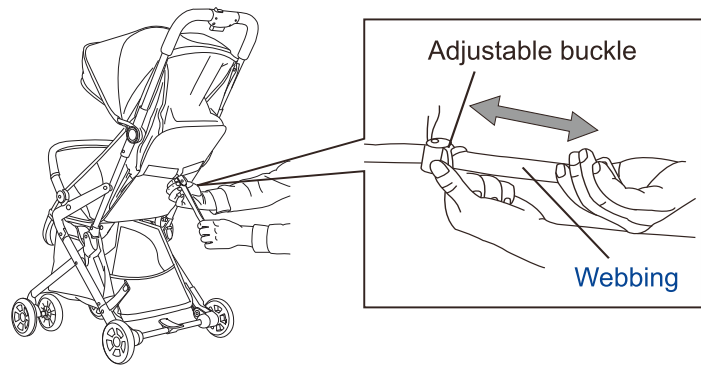

## Bumper bar

Press the buttons on both side of stroller, and then bumper bar can be released.

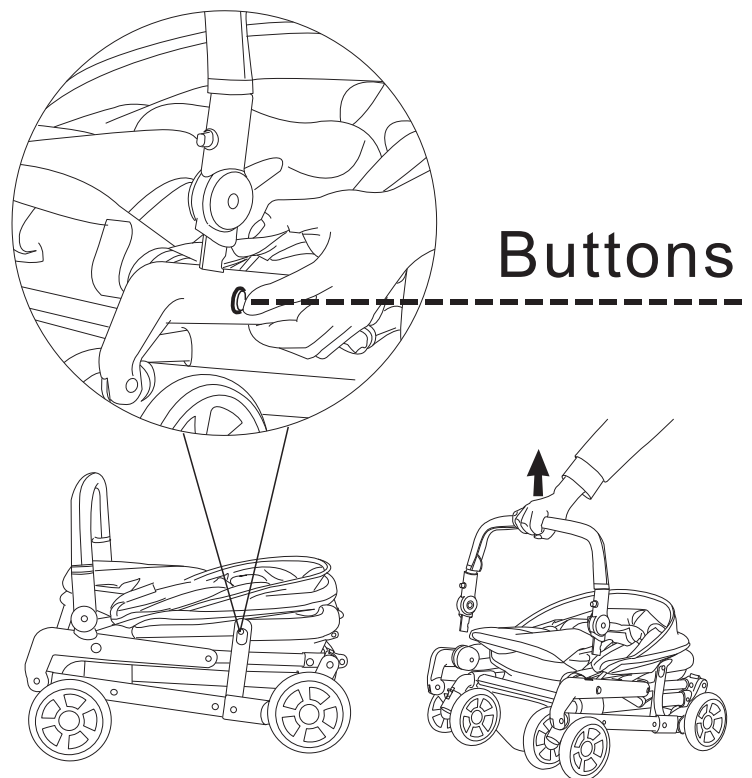

# Folding the Stroller

To fold the pushchair, first slide the thumb trigger to the left, then squeeze the center button (fig A), and then push the handle bar downwards (fig B&C).

Push the backrest board forwards and then downwards (fig D&E). The stroller will be fold smoothly.

There is locking catch on one side of stroller, push the stroller downwards to the locking catch, it will be locked in position (fig F)

Fold the bumper bar. Press the buttons on both sides of the bumper bar and push the bumper bar down. and then you can pack the stroller into the bag.

**CAUTION :** Do not allow children near the pushchair while folding.

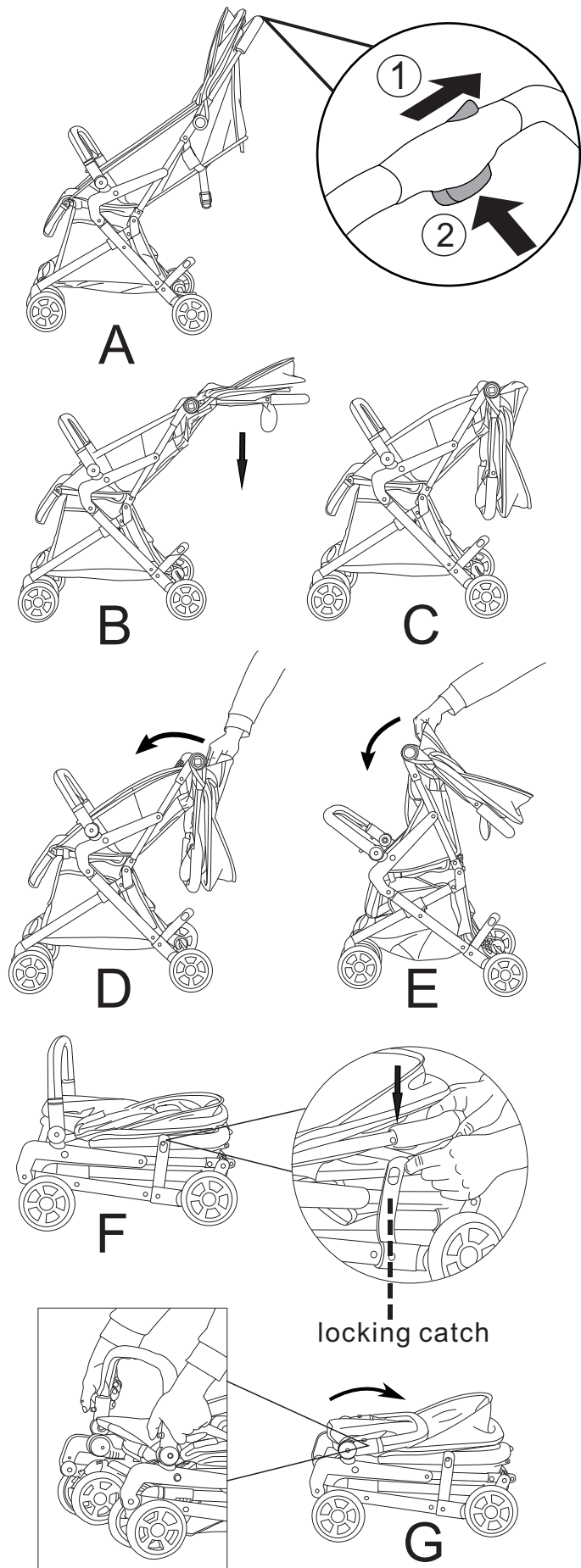



# Care and Maintenance

## General

This pushchair was designed and manufactured with qualified materials and craftsmanship.  
Always use the safety harness.

## Inspect regularly for:

- Worn parts, torn materials or stitching .
- Loose screws, bent or broken frame parts .
- Broken, damaged or missing parts.

Should any of the above be evident do not use and contact the Helpline:03456 400 800 for advice.

## Care and Maintenance:

Fabric parts may be cleaned in accordance with the fabric care labels. Do not machine wash.

Seat: Sponge clean only

Canopy/Basket:Hand wash only.

Do not leave the stroller exposed to heat i.e. by a radiator or in direct sunlight.

If the stroller chassis parts have been exposed to salt water we recommend that they be rinsed down with fresh (tap) water as soon as possible afterwards.

Do not fold or store the product while wet and never store in a damp environment as this can cause mildew to form.

If you need help or have further question, call the Customer Helpline **03456 400 800**

This pushchair has been designed to comply with the EN1888:2012.

Country of origin: China

Argos LTD, 489-499 Avebury Boulevard, Central Milton Keynes, MK9 2NW