

CUGGL CEDAR FOLD DOWN PUSHCHAIR

Assembly & User Instructions- Please keep for future reference

836/4810

cuggl 



Important

Age:0-36 months
Maximum user
Weight:15kg

Important-please read these instructions fully before assembly or use

These instructions contain important information which will help you get the best from your product and ensure safe and correct assembly, use and maintenance.

If you have any questions, call the **Customer Helpline: 03456 400 800**

Parts

If you have any questions,
call the **Customer Helpline: 03456 400 800**

Please check you have all the parts listed below:

Stroller x1

Rear wheel x2

Front wheel x2

Bumper bar x1

Raincover x1

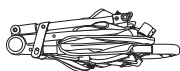

IMPORTANT - KEEP THESE INSTRUCTIONS FOR FUTURE REFERENCE

Thank you for choosing our product. Please always read all the instructions provided carefully before use and remember, your child's safety may be affected if you do not follow these instructions. The stroller is suitable for child from 0-36 months. The maximum load of the pushchair is 15kg, never overload.

Pushchair was designed for one child.

- **WARNING:** Never leave your child unattended.
- **WARNING:** Always use the restraint system.
- **WARNING:** Make sure every locking device is locked before use.
- **WARNING:** Hanging or putting things on the handle could damage the stability of the pushchair.
- **WARNING:** Never use the bumper bar as a hand lift to lift the stroller and your child in case any damage could happen.
- **WARNING:** Do not leave the pushchair at a slope.
- **WARNING:** The maximum capacity for shopping basket is 2kg.
- **WARNING:** Always use braking device when putting in or picking up the child.
- **WARNING:** Do not fold the stroller when the child is on the pushchair.
- **WARNING:** Do not detach the stroller and adjust any accessories when the child is on the stroller.
- **WARNING:** Only replacement parts supplied or recommended by the manufacturer/distributor shall be used.
- **WARNING:** To avoid injury ensure that our child is kept away when unfolding and folding this product.
- **WARNING:** Do not let your child play with this product.
- **WARNING:** The parking device shall be engaged when placing and removing the children.
- **WARNING:** The pushchair was designed to be used from birth, we recommend use of the most reclined position for new born babies.
- **WARNING:** This product is not suitable for running or skating.

Name of parts

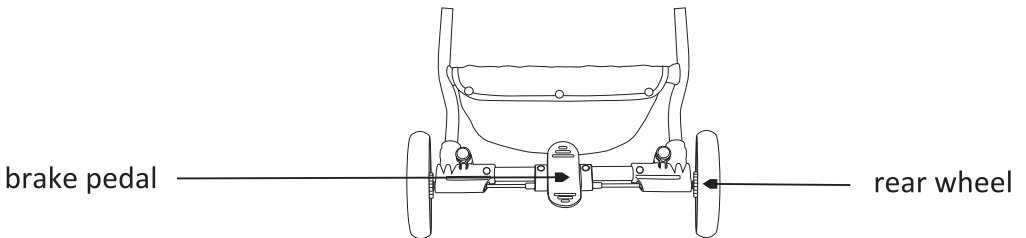
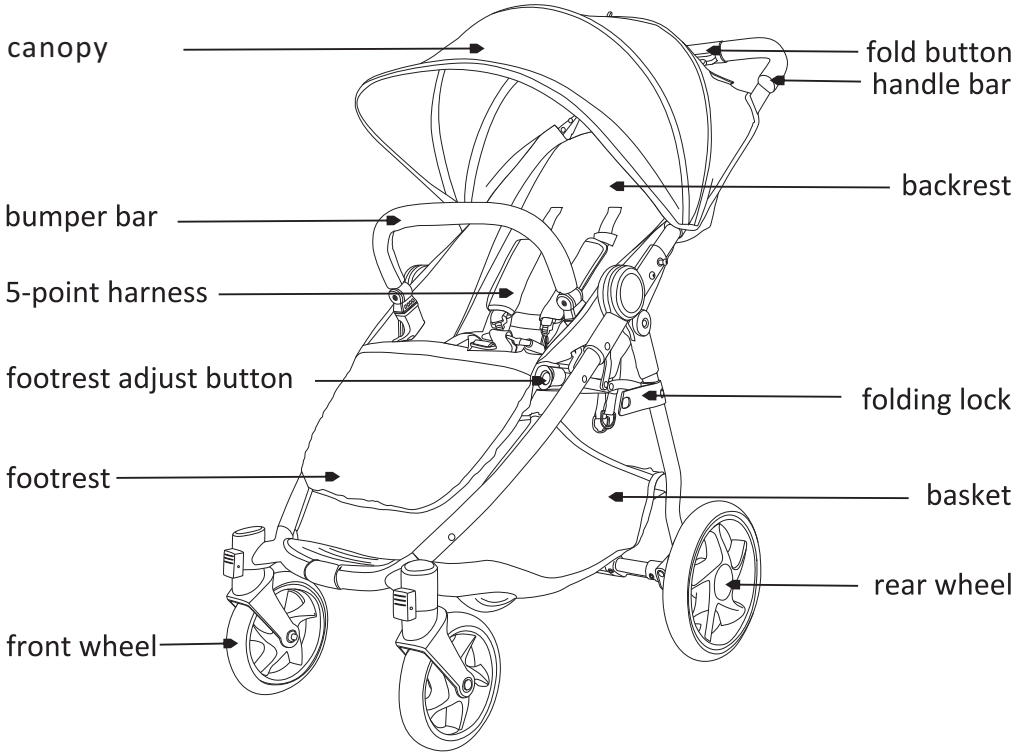

Assembly Instructions

Step 1 To unfold the stroller

Release the folding lock, pull the handle bar backwards until you hear the “click”.

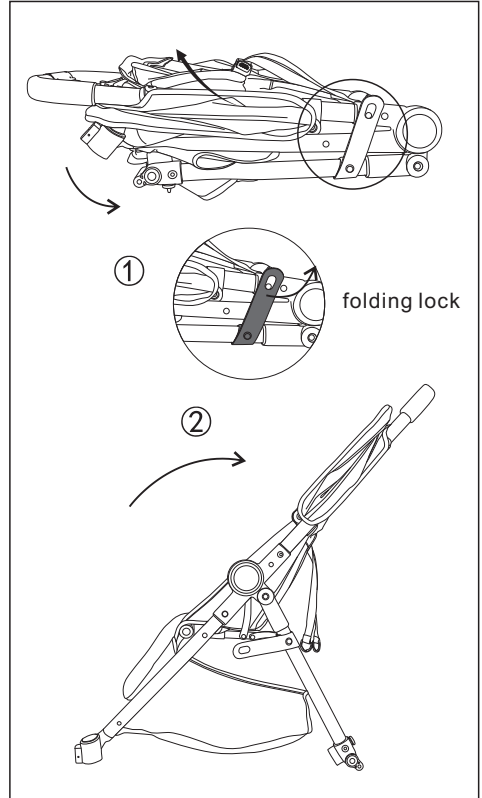

Step 2 Front wheel assembly

1. Slide front wheel brackets into front legs until you hear a “click” sound.

2. To remove the front wheels, press the small button and pull downwards.

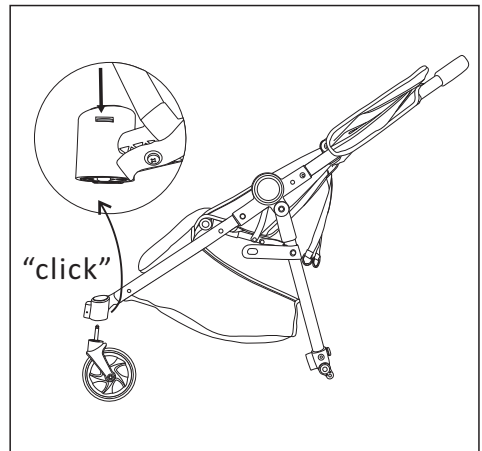

Assembly Instructions

Step 3 Rear wheel assembly

Fit the rear wheels on the axle until you hear a “click”.

To remove the rear wheels, press the release button and pull the wheels outwards.

To attach the rear wheels, follow this order

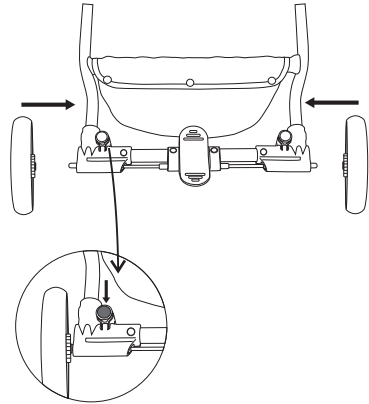

Step 4 Bumper bar assembly

To assembly the bumper bars.

Push the ends of the bumper bars into the slots on the chassis until they “click” into place.

To remove the bars, push in the buttons on both sides and pull the bars off.

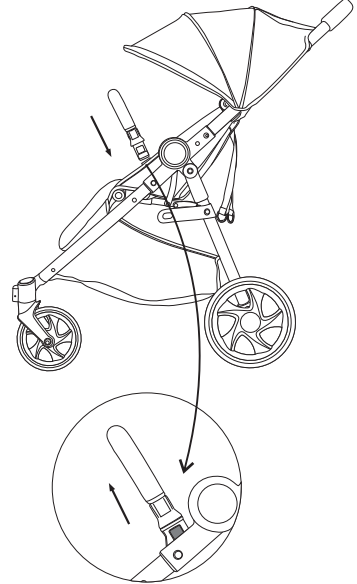

Use and operation after assembly

To lock the front wheels

1. The front wheels must be turned in the straight forward position, then push the fixing lever downwards until the button locks in place.
2. To release the wheels for free swivel, push the fixing lever upwards.

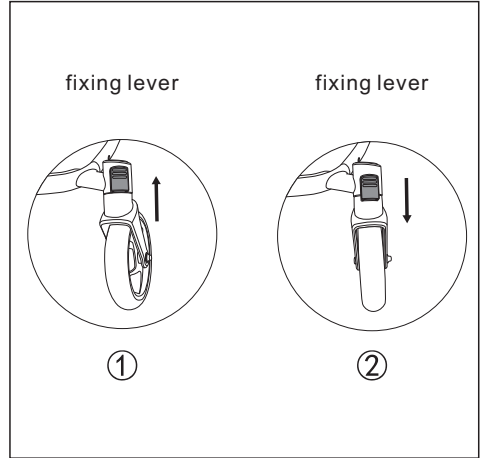

Use the brake

To lock the rear wheel brakes.

1. Press the brake pedal down until they “click” into the locked position. Make sure the brake pedals are pressed down completely.
2. Always set the brake pedal whenever you park the stroller.

To unlock the rear wheel brakes. Lift the brake pedal until they “click” into the unlocked position.

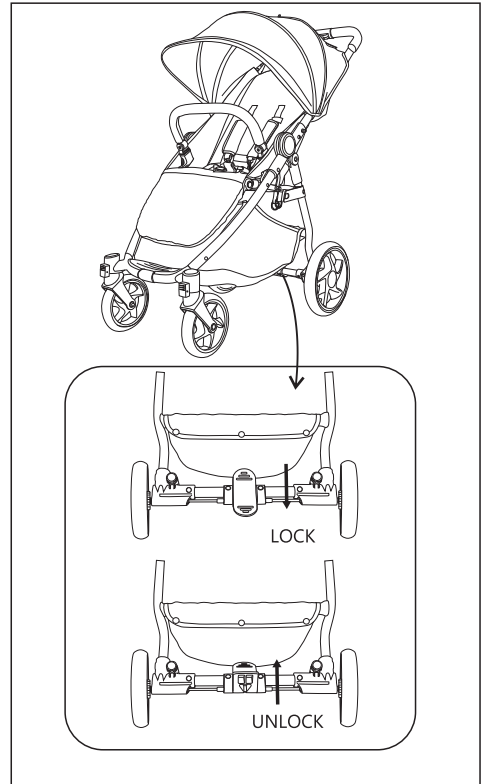

Use and operation after assembly

Use the safety belt

Harness & Buckle:

To release the harness:

Press the buckles ① and pull them ② apart.

To fasten the waist harness, insert both buckle clips into each side of the buckle until they "click" into correct position. To adjust the shoulder straps move the slides as shown.

NOTES:

The shoulder straps can be adjusted to 2 positions, to adjust the height of the shoulder strap to a lower position, insert the shoulder strap into the shoulder belt slot.

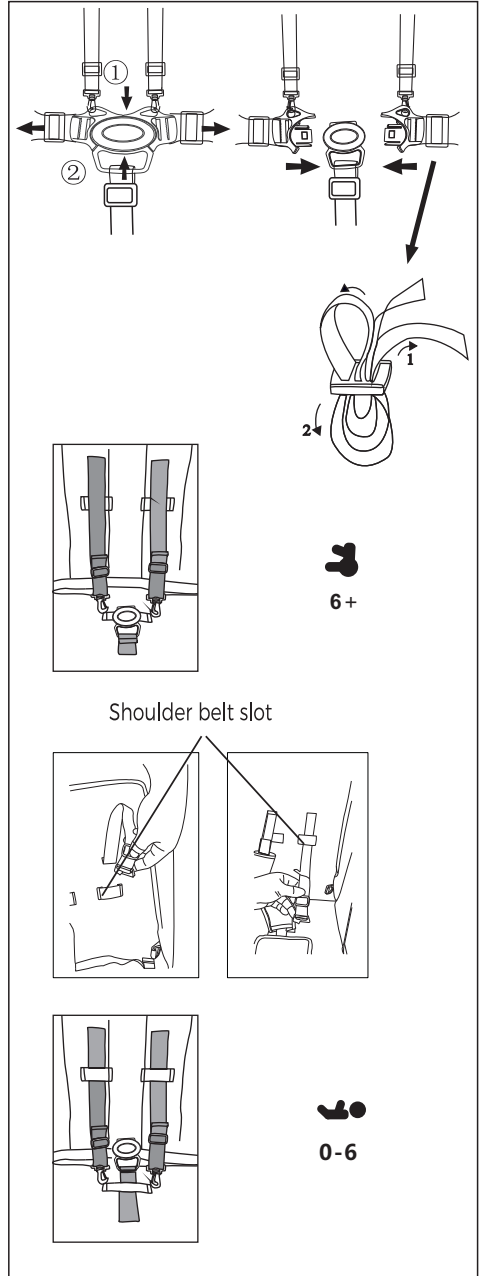

Use and operation after assembly

Adjust the canopy

Pull the hood forward by the front rim of the hood. For shade/weather protection, the hood can be unzipped further as shown.

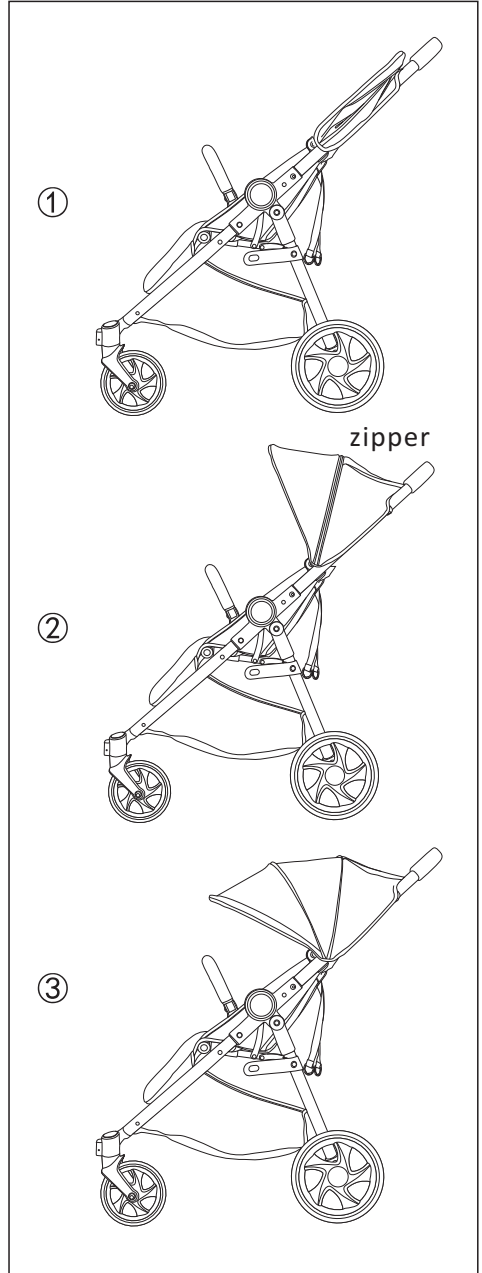

Use and operation after assembly

Adjust backrest

Squeeze the clasp on the back of the seat unit and pull downwards. When the seat unit has reached the desired position, release the trigger.

To raise the seat unit, hold both straps with one hand and push the back of the seat unit with your other hand.

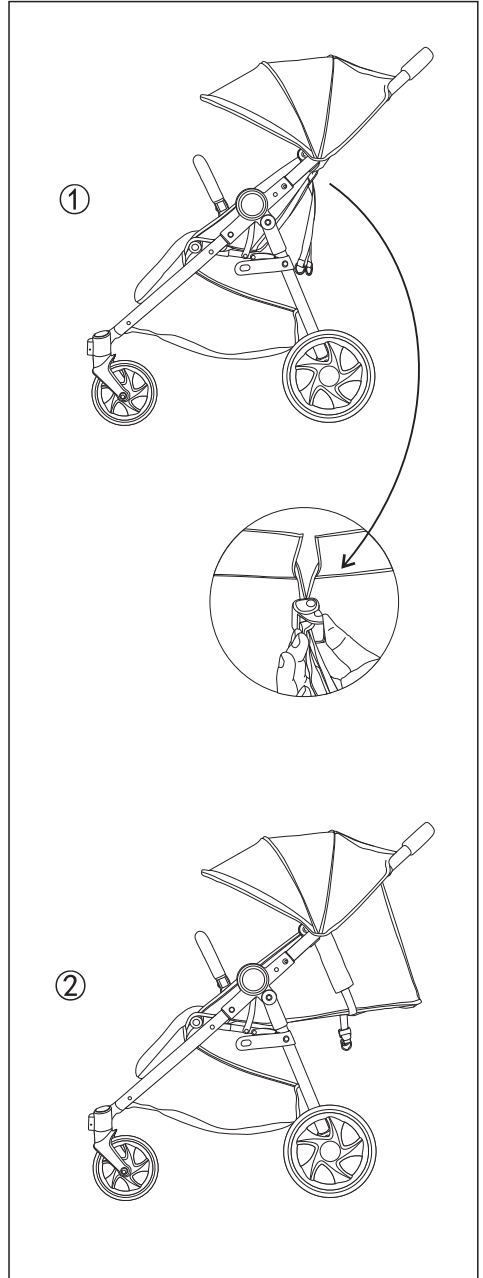

Use and operation after assembly

Adjust footrest

To adjust the footrest, press the both sides footrest adjust button and adjust the footrest to the correct position.



Use the raincover

Place the raincover over hood and then cover the stroller.

Fasten the hook & loop straps position on the A and B as picture shows.

P.V.C Clean with a damp cloth.
In accordance with safety regulation, only use when an adult is attending.
Do not leave your child under the rain cover in sunny weather in cause of overheating.

WARNING: Keep away from fire.
WARNING: Keep this plastic cover away from children to avoid suffocation.

TAKE EXTRA CARE IN WINDY CONDITION.

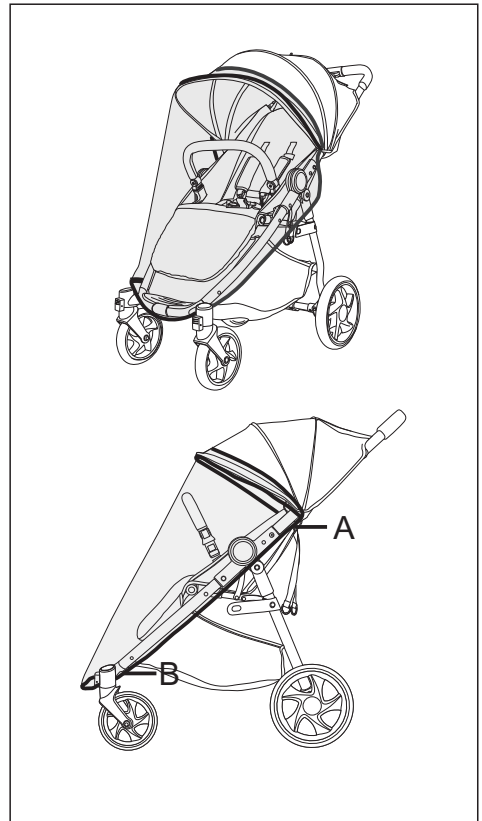

Use and operation after assembly

To fold the stroller

Make sure the seats are in the upright position, the hood is retracted and the brakes are engaged.

Slide the primary lock button (A) to the side and then squeeze the secondary lock button (B). Keep the secondary lock button held in and push up and forwards on the handle.

Fold all the way down until the folding catch locks in place.

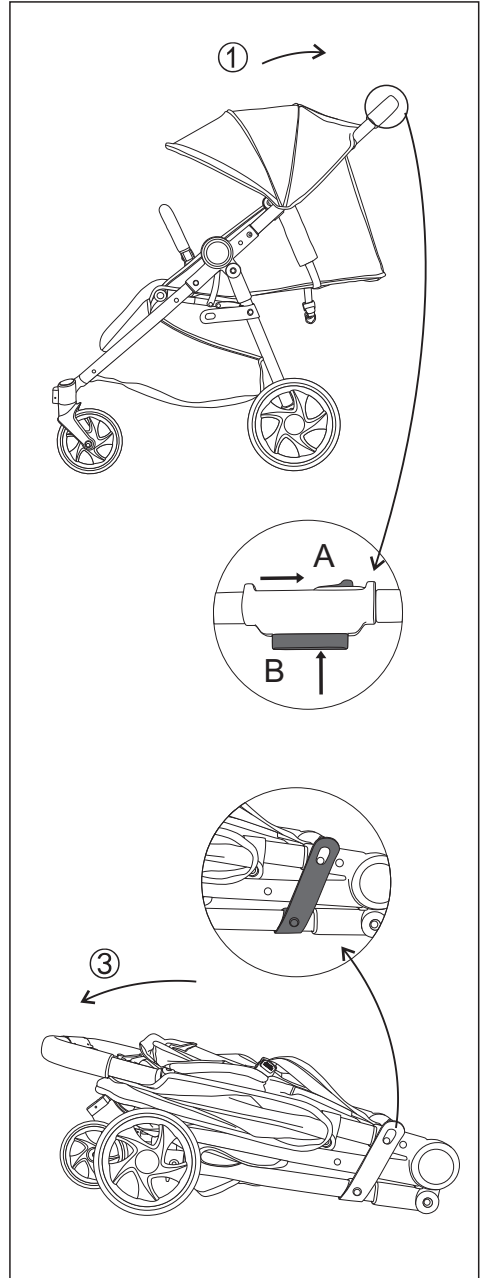

Care and Maintenance

General

This pushchair was designed and manufactured with qualified materials and craftsmanship.

Always use the safety harness.

Inspect regularly for:

- Worn parts, torn materials or stitching
- Loose screws, bent or broken frame part
- Broken, damaged or missing parts.

Should any of the above be evident do not use and contact the Helpline: 03456 400 800 for advice.

Care and Maintenance:

Fabric parts may be cleaned in accordance with the fabric care labels. Do not machine wash.

Seat: Sponge clean only

Canopy/Basket: Hand wash only.

Do not leave the stroller exposed to heat i.e. by a radiator or indirect sunlight.

If the stroller chassis parts have been exposed to salt water we recommend that they be rinsed down with fresh (tap) water as soon as possible afterwards. Do not fold or store the product while wet and never store in a damp environment as this can cause mildew to form.

If you need help or have further question, call the Customer Helpline **03456 400 800**

This pushchair has been designed to comply with the EN1888:2012.

Country of origin: China

Argos LTD, 489-499 Avebury Boulevard, Central Milton Keynes, MK9 2NW