

***challenge***<sup>®</sup>

**5000 BTU LOCAL AIR CONDITIONER  
INSTRUCTION MANUAL**



# CONTENTS

## **SAFETY PRECAUTIONS**

Safety rules.....	2
Operating condition.....	3
Suggested tools for window kit installation.....	3

## **IDENTIFICATION OF PARTS**

Names of parts.....	4
Accessories.....	4

## **INSTALLATION INSTRUCTIONS**

Installation instruction.....	5
Exhaust hose installation.....	6
Water drainage.....	8

## **OPERATION**

Control panel.....	9
Operating instruction.....	10
Remark.....	10

## **REMOTE CONTROL**

Remote Control.....	11
---------------------	----

## **CARE AND MAINTENANCE**

Care and maintenance.....	14
---------------------------	----

## **TROUBLE SHOOTING TIPS**

Trouble shooting.....	15
-----------------------	----

## **PRODUCT SPECIFICATION**

Product specification.....	16
----------------------------	----

## **CONNECTION TO POWER**

Connection to power.....	17
--------------------------	----

## **TECHNICAL INFORMATION (ERP)**

Technical information (ERP).....	18
----------------------------------	----

## **PRODUCT GUARANTEE**

Product guarantee.....	19
------------------------	----

### **NOTE**

The rating data indicated on the energy label is based on the testing condition of installing the un-extended air exhaust duct without adaptor A & B (The duct and the adaptor A & B are listed in the accessories chart of the Instruction Manual).

# SAFETY PRECAUTIONS

## Safety rules

To prevent injury to the user or other people and property damage, the following instructions must be followed. Incorrect operation due to ignoring of instructions may cause harm or damage.

### ! Always do this

- Your air conditioner should be used in such a way that it is protected from moisture. e.g. condensation, splashed water, etc. Do not place or store your air conditioner where it can fall or be pulled into water or any other liquid. Unplug immediately if it occurs.
- Always transport your air conditioner in a vertical position and stand on a stable, level surface during use.
- Turn off the product when not in use.
- Always contact a qualified person to carry out repairs. If the supply cord is damaged it must be repaired by a qualified repairer.
- Keep an air path of at least 30cm all around the unit from walls, furniture and curtains.
- If the air conditioner is knocked over during use, turn off the unit and unplug from the mains supply immediately.

### ⊘ Never do this

- Do not operate your air conditioner in a wet room such as a bathroom or laundry room.
- Do not touch the unit with wet or damp hands or when barefoot.
- Do not press the buttons on the control panel with anything other than your fingers.
- Do not remove any fixed covers. Never use this appliance if it is not working properly, or if it has been dropped or damaged.
- Never use the plug to start and stop the unit.
- Do not cover or obstruct the inlet or outlet grilles.
- Do not use hazardous chemicals to clean or come into contact with the unit. Do not use the unit in the presence of inflammable substances or vapour such as alcohol, insecticides, petrol, etc.
- Do not allow children to operate the unit unsupervised.
- Do not use this product for functions other than those described in this instruction manual.

## For your safety

- Do not store or use gasoline or other flammable vapors and liquids in the vicinity of this or any other appliance.
- Avoid fire hazard or electric shock. Do not use an extension cord or an adaptor plug. Do not remove any prong from the power cord.

### CAUTION:

- This appliance can be used by children aged from 8 years and above and persons with reduced physical, sensory or mental capabilities or lack of experience and knowledge if they have been given supervision or instruction concerning use of the appliance in a safe way and understand the hazards involved. Children shall not play with the appliance. Cleaning and user maintenance shall not be made by children without supervision.

# SAFETY PRECAUTIONS

## Energy Save

- Use the unit in the recommended room size.
- Locate the unit where furniture cannot obstruct the air flow.
- Keep blinds/curtains closed during the sunniest part of the day.
- Keep the filters clean.
- Keep doors and windows closed to keep cool air in and warm air out

## Operating condition

- The air conditioner should be operated within the temperature range indicated below:

MODE	ROOM TEMPERATURE
COOL	17°C~35°C
DRY	13°C~35°C

### Note:

1. If temperature higher than 35 degree, the air conditioner will stop frequently.
2. If the temperature lower than 17 degree in cool mode, the compressor will not work and the fan motor will stop as well. If the temperature lower than 13 degree in dry mode, the compressor will not work

## Suggested tools for window kit installation

1. Screwdriver(medium size Phillips)
2. Tape measure or ruler
3. Knife or scissors
4. Saw(In the event that the window kit needs to be cut down in size because the window is too narrow for direct installation)

# IDENTIFICATION OF PARTS

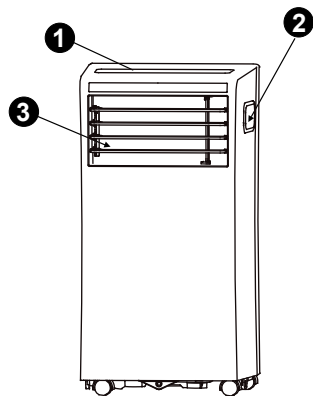
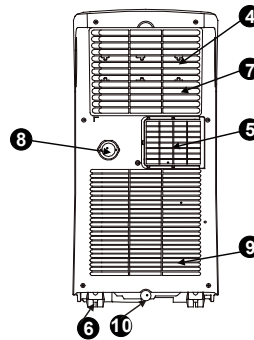

Fig.1

## NAMES OF PARTS

### Front

- ① Operation Panel
- ② Carrying Handle (both sides)
- ③ Cold air outlet



### Rear

- ④ Air Filter
- ⑤ Air Outlet
- ⑥ Wheel
- ⑦ Air intake (with filter)
- ⑧ Drain Outlet
- ⑨ Air intake
- ⑩ Bottom tray drain outlet

Fig.2

## Accessories

PARTS :	PARTS NAME :	QUANTITY :
	Unit Adaptor	1 pc
	Exhaust Hose(Length: 1.4m, diameter: 130mm)	1 pc
	Window Slider Adaptor	1 pc
	Wall Exhaust Adaptor A (only for wall installation)	1 pc
	Wall Exhaust Adaptor B(with cap)(only for wall installation)	1 pc
	Bolt	1 pc
	Window Slider A	1 pc
	Window Slider B	1 pc
	Screw A ST4.5x45 and wall plug(only for wall installation)	4 set
	Foam Seal A (Adhesive)	2 pc
	Foam Seal B (Adhesive)	2 pc
	Foam Seal C (Non-adhesive)	1 pc
	Bracket x 1 and screw (ST3.9x13) x 2	1 set
	Drain Hose(Length: 0.6m, diameter: 16.5mm)	1 pc
	Remote control	1 pc
	Battery(LR03)	2 pc

- Check all the accessories are included in the package and please refer to the installation instructions for their usage.

# INSTALLATION INSTRUCTIONS

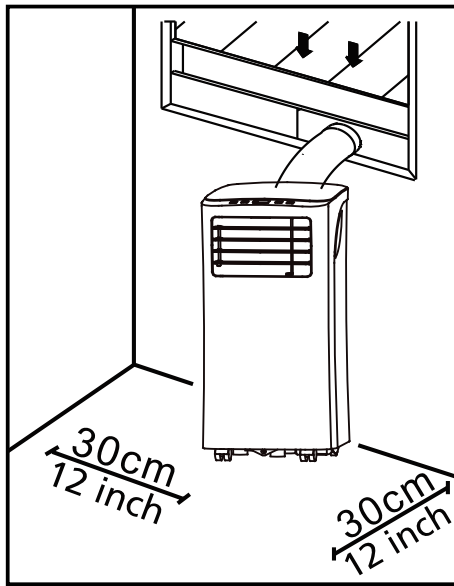

Fig. 3

## INSTALLATION INSTRUCTIONS

### Location

- The air conditioner should be placed on a firm foundation to minimize noise and vibration. For safe and secure positioning, place the unit on a smooth, level floor strong enough to support the unit.
- The unit has casters to aid placement, but it should only be rolled on smooth, flat surfaces. Use caution when rolling on carpet surfaces. Do not attempt to roll the unit over objects.
- The unit must be placed within reach of a properly rated grounded socket.
- Never place any obstacles around the air inlet or outlet of the unit.
- Allow at least 30cm of space from the wall for efficient air-conditioning.

# INSTALLATION INSTRUCTIONS

## For hung/sliding window

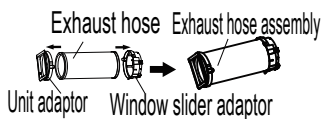

## For wall installation

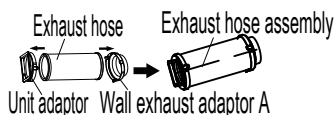

Fig. 4

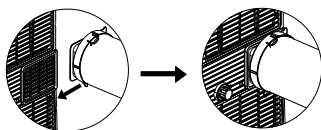

Fig.5

## Exhaust hose installation:

The exhaust hose and adaptor must be installed or removed in accordance with the usage mode.

COOL, AUTO mode	Install
FAN, DEHUMIDIFY mode	Remove

1. Connect the exhaust hose into the window slider adaptor (into wall window slider adaptor for wall installation) and unit adaptor, clamp automatically by elastic buckles of the adaptors (See Fig.4).
2. Push the Exhaust hose into the air outlet opening along the the arrow direction(See Fig. 5).

## Preparing the Adjustable Window Slider

1. Depending on the size of your window, adjust the size of the window slider.
2. If the length of the window requires two window sliders, use the bolt to fasten the window sliders once they are adjusted to the proper length.

## Installation

Note: Once the Exhaust Hose assembly and Adjustable Window Slider are prepared, choose from one of the following three installation methods.

### Type 1: Hung Window Installation(optional)

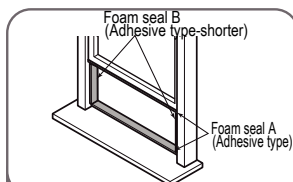

- 1 Cut the adhesive foam seal A and B strips to the proper lengths, and attach them to the window sash and frame as shown.

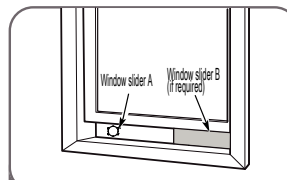

- 2 Insert the window slider assembly into the window opening.

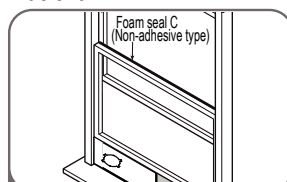

- 3 Cut the non-adhesive foam seal C strip to match the width of the window. Insert the seal between the glass and the window frame to prevent air and insects from getting into the room.

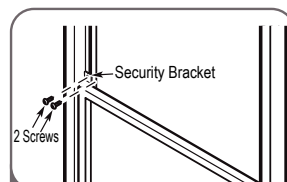

- 4 If desired, install the security bracket with 2 screws as shown.

# INSTALLATION INSTRUCTIONS

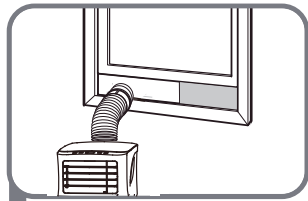

5 Insert the window slider adaptor into the hole of the window slider.

## Type 2: Sliding Window Installation(optional)

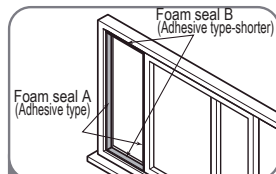

1 Cut the adhesive foam seal A and B strips to the proper lengths, and attach them to the window sash and frame as shown.

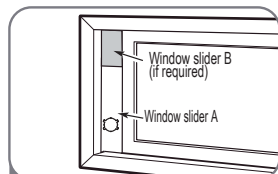

2 Insert the window slider assembly into the window opening.

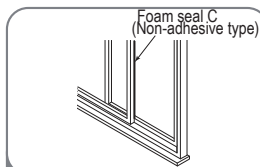

3 Cut the non-adhesive foam seal C strip to match the window height. Insert the foam seal between the glass and the window frame to prevent air and insects from getting into the room.

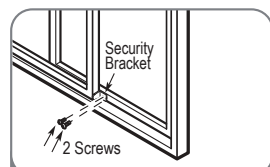

4 If desired, install the security bracket with 2 screws as shown.

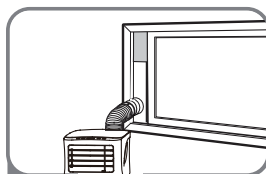

5 Insert the window slider adaptor into the hole of the window slider.

## Type 3: Wall Installation(optional)

- Cut a 125mm (4.9inch) diameter hole into the wall for the Wall Exhaust Adaptor B.
- Secure the Wall Exhaust Adaptor B to the wall using the four Anchors and Screws provided in the kit.
- Connect the Exhaust Hose Assembly(with Wall Exhaust Adaptor A) to the Wall Exhaust Adaptor B.

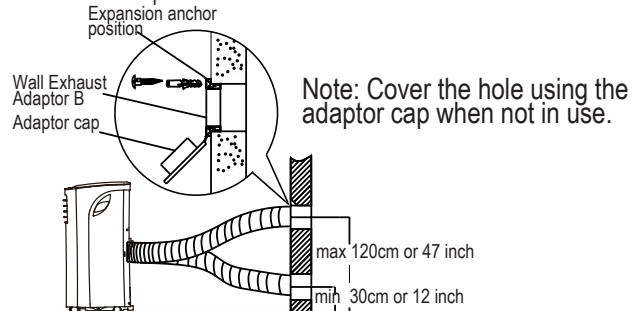

Note: To ensure proper function, DO NOT overextend or bend the hose. Make sure that there is no obstacle around the air outlet of the exhaust hose (in the range of 500mm) in order to the exhaust system works properly. All the illustrations in this manual are for explanation purpose only. Your air conditioner may be slightly different. The actual shape shall prevail.





# INSTALLATION INSTRUCTIONS

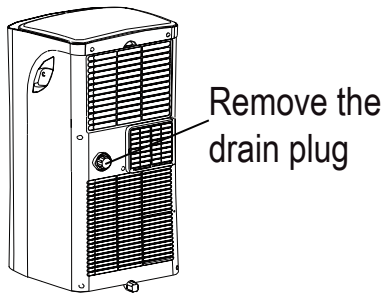

Fig.6

Continuous  
drain hose

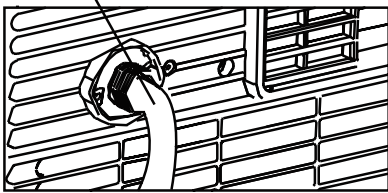

Fig.7

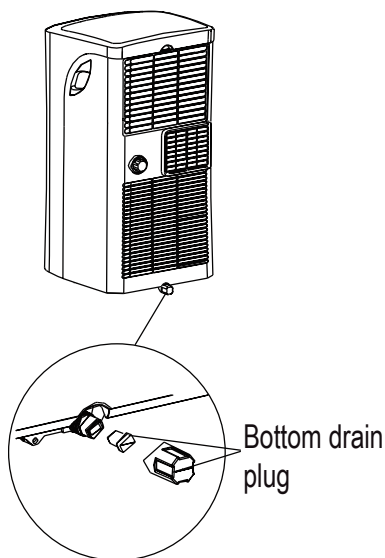

Fig.8

## Water drainage:

- During dehumidifying modes, remove the drain plug from the back of the unit, install the drain connector(5/8" universal female mender) with 3/4" hose(not.included). Place the open end of the hose directly over the drain area . Please refer to Fig.6 & 7.
- Under dehumidifying mode, when the water level of the bottom tray reaches a predetermined level, the unit beeps 8 times, the digital display area shows "P1". At this time the air conditioner will stop immediately. However, the fan motor will continue to operate (this is normal). Carefully move the unit to a drain location, remove the bottom drain plug and let the water drain away (Fig.8). Re-install the bottom drain plug and Restart the machine until the "P1" symbol disappears. If the error repeats, call for service.

NOTE: Be sure to reinstall the bottom drain plug before using the unit.

# OPERATION

## Control Panel

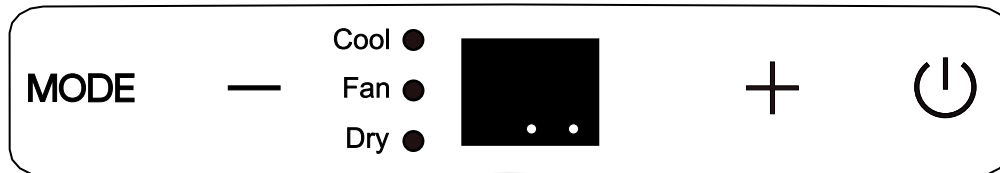

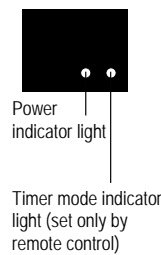

Fig. 9

- MODE** MODE button  
Selects the appropriate operating mode. Each time you press the button, a mode is selected in a sequence that goes from COOL, FAN and DRY. The mode indicator light illuminates under the different mode setting.  
NOTE: On above modes, the unit operates the auto fan speed automatically. You can set fan speed only by the remote control on COOL and FAN modes.
- + Up (+) and Down (-) buttons  
Used to adjust (increasing/decreasing) temperature settings in 1°C/2°F (or 1°F) increments in a range of 17°C/62°F to 30°C/88°F (or 86°F).  
NOTE: The control is capable of displaying temperature in degrees Fahrenheit or degrees Celsius. To convert from one to the other, press and hold the Up and Down buttons at the same time for 3 seconds.

-  **Power button**  
Turn the unit on/off.



- LED display**  
Shows the set temperature while on cool mode. While on DRY and FAN modes, it shows the room temperature.  
Shows Error codes:  
E1-Room temperature sensor error.  
E2-Evaporator temperature sensor error.  
E4-Display panel communication error.  
EC-Refrigerant leakage detection malfunction (on some models).  
Shows protection code:  
P1-Bottom tray is full--Connect the drain hose and drain the collected water away. If protection repeats, call for service.  
Note: When one of the above malfunctions occurs, turn off the unit, and check for any obstructions. Restart the unit, if the malfunction is still present, turn off the unit and unplug the power cord. Contact the manufacturer or its service agents or a similar qualified person for service.



# OPERATION

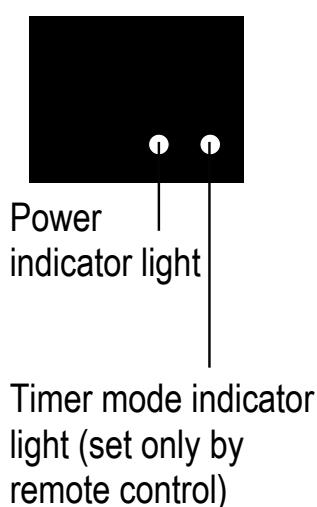
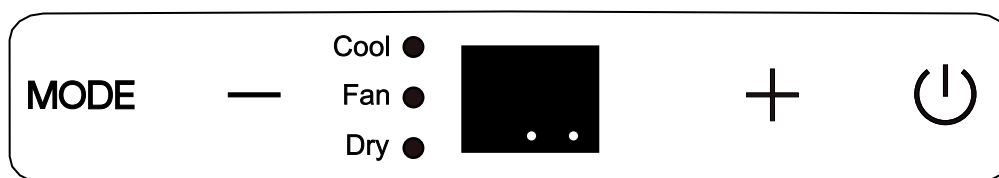

## Operating Instruction

### COOL operation

- Continue to press the "MODE" button until the "COOL" indicator light comes on.
- Continue to press the ADJUST buttons "+" or "-" to select your desired room temperature. The temperature can be set within a range of 17°C-30°C
- To change the fan speed, please use the remote control.

### Dehumidifying operation

- Press the "MODE" button until the "DRY" indicator light comes on.
- Under this mode, you cannot select a fan speed or adjust the temperature.
- Keep windows and doors closed for the best dehumidifying effect.
- Do not put the hose to window.

### FAN operation

- Press the "MODE" button until the "FAN" indicator light comes on.
- To change the fan speed, please use the remote control.
- Do not put the hose to window.

### Remark

#### Auto-Restart

If the unit shut down unexpectedly due to the power cut, it will restart with the previous function setting automatically when the power resumes.

### **Important for compressor protection device**

After the unit has stopped, it cannot operation in the first 3 minutes. This is to protect the unit. Operation will automatically start after 3 minutes.

### **Air flow direction adjustment**

#### - Adjust the air flow direction manually

The louver can be set to the desired position manually.

Do not place any heavy objects or other loads on the louver, doing so will cause damage to the unit.

#### - Keep the louver fully opened during operation.

# REMOTE CONTROL

## Handling the remote control

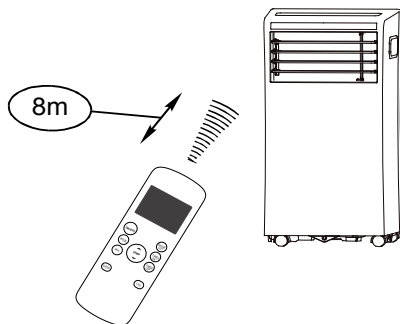

## Location of the remote control

- Use the remote control within a distance of 8 meters from the appliance, pointing it towards the receiver. Reception is confirmed by a beep.

### ⚠ CAUTIONS

- The air conditioner will not operate if curtains, doors or other materials block the signals from the remote control to the indoor unit.
- Prevent any liquid from falling into the remote control. Do not expose the remote control to direct sunlight or heat.
- If the infrared signal receiver on the indoor unit is exposed to direct sunlight, the air conditioner may not function properly. Use curtains to prevent the sunlight from falling on the receiver.
- If other electrical appliances react to the remote control, either move these appliances or consult your local dealer.

## Replacing batteries

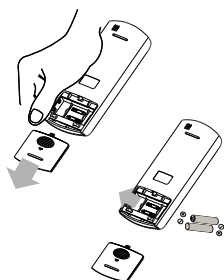

The remote control is powered by two dry batteries (R03/LR03X2) housed in the rear part and protected by a cover.

- (1) Remove the cover by pressing and sliding off.
- (2) Remove the old batteries and insert the new batteries, placing the (+) and (-) ends correctly.
- (3) Replace the cover by sliding it back into position.

### ⚠ CAUTIONS

- Do not mix old and new batteries or batteries of a different type.
- Do not leave the batteries in the remote control if it is not going to be used for more than 2 months.
- Dispose of the old batteries in the special containers to be found in the sales outlets.

# REMOTE CONTROL

## Function buttons

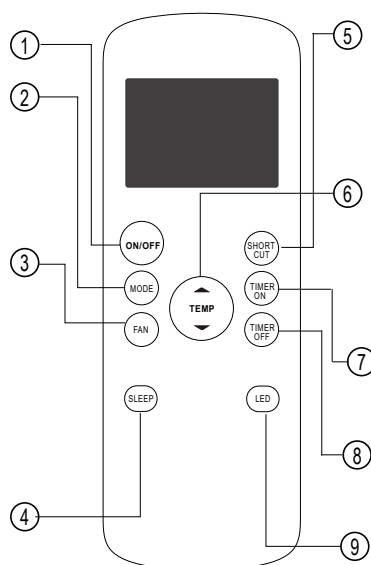

### 1 ON/OFF Button

Operation starts when this button is pressed and stops when the button is pressed again.

### 2 MODE Button

It is for you to select different operation mode.

### 3 FAN SPEED Button

Used to select the fan speed in four steps:

Auto → Low → High

### 4 SLEEP Button

Select this function during the sleeping time. It can maintain the most comfortable temperature and save energy. This function is available on COOL, or AUTO mode only.

This feature can be activated from the remote control ONLY. To activate SLEEP feature, the set temperature will increase by 1 °C/2°F (or 1 °F) in 30 minutes. The set temperature will then increase by another 1 °C/2°F (or 1 °F) after an additional 30 minutes. This new temperature will be maintained for 7 hours before it returns to the originally selected temperature. This ends the Sleep mode and the unit will continue to operate as originally programmed.

NOTE: This feature is unavailable under FAN or Dehumidifying mode.

**NOTE:** While the unit is running under SLEEP mode, it would be cancelled if ON/OFF, FAN SPEED, SLEEP or MODE button is pressed.

### 5 SHORT CUT Button

Sets and activates your favorite pre-settings.

Used to restore the current settings or resume previous settings.

Push this button when remote controller is on, the system will automatically revert back to the previous settings including operating mode, setting temperature, fan speed level and sleep feature (if activated).

If pushing more than 2 seconds, the system will automatically restore the current operation settings including operating mode, setting temperature, fan speed level and sleep feature (if activated).

### 6 TEMP UP/DOWN BUTTON

Push UP ▲ button to increase the indoor temperature setting in 1 °C increments to 30 °C.

Push DOWN ▼ button to decrease the indoor temperature setting in 1 °C decrements to 17 °C.

### 7 TIMER OFF Button

Press this button to activate the Auto-off time setting. Each press will increase the time setting in 30 minutes increments, up to 10 hours, then at 1 hour increments up to 24 hours. To cancel the Auto-off time setting, just press the button until the time setting is 0.0.

### 8 TIMER ON Button

Press this button to activate the Auto-on time setting. Each press will increase the time setting in 30 minutes increments, up to 10 hours, then at 1 hour increments up to 24 hours. To cancel the Auto-on time setting, just press the button until the time setting is 0.0.

### 9 LED Button

Turns unit's LED display on and off. If you are sensitive to light when you go to sleep, you can press the LED button to turn off the LED display on the unit. Press the button again to turn it back on.



# CARE AND MAINTENANCE

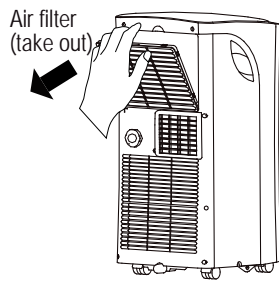

## CARE AND MAINTENANCE

### IMPORTANT:

- 1) Be sure to unplug the unit before cleaning or servicing.
- 2) Do not use gasoline, thinner or other chemicals to clean the unit.
- 3) Do not wash the unit directly under a tap or using a hose. It may cause electrical danger.
- 4) If the power cord is damaged, it should be repaired by manufacture or its agency.

### 1. Air filter

- Clean the air filter at least once every two weeks.
- Removal  
This unit has an upper filter. Take it out along the arrow direction, then take the filter down.
- Cleaning  
Wash the air filter by immersing it gently in warm water (about 40°C) with a neutral detergent. Rinse the filter and dry it in a shady place. Do not put it under the direct sunlight.
- Mounting  
Install the upper filter after cleaning.

### 2. Unit enclosure

- Use a lint-free cloth soaked with neutral detergent to clean the unit enclosure. Finished by a dry clean cloth.

### 3. Unit idle for a long time

- Remove the rubber plug at the back of the unit and attach a hose to drain outlet. Place the open end of the hose directly over the drain area in your basement floor
- Remove the plug from the bottom drain outlet, all the water in the bottom tray would drain out.
- Keep the appliance running on FAN mode for half a day in a warm room to dry the appliance inside and prevent mold forming.
- Stop the appliance and unplug it, wrapped the cord and bundle it with the tape. Remove the batteries from the remote control.
- Clean the air filter and reinstall it.

# TROUBLESHOOTING TIPS

## TRUBLE SHOOTING

TROUBLES	POSSIBLE CAUSES	SUGGEST REMEDIES
<b>1. Unit does not Start when Pressing on/off Button</b>	- P1 appears in the display window	Drain the water in the bottom tray.
	- Room temperature is lower than the set temperature.(Cooling mode)	Reset the temperature.
<b>2. Not cool enough</b>	- The windows or doors in the room are not closed.	Make sure all the windows and doors are closed.
	- There are heat sources inside the room.	Remove the heat sources if possible.
	- The unit is low on refrigerant.	Call a service technician to inspect the unit and top off refrigerant
	- Exhaust air duct is not connected or blocked.	Connect the duct and make sure it can function properly.
	- Temperature setting is too high.	Decrease the set temperature.
	- Air filter is blocked by dust.	Clean the air filter.
<b>3. Noisy or vibration</b>	- The air filter is blocked with dust	Clean the air filter.
	- The ground is not level or not flat enough.	Place the unit on a flat, level ground if possible.
<b>4. Gurgling sound</b>	- The sound comes from the flowing of the refrigerant inside the air-conditioner.	It is normal.
<b>5. LED displays E1 code</b>	- Room temperature sensor error	Unplug the unit and plug in. If error is still happened, please check with the qualified person / or return it to store.
<b>6. LED displays E2 code</b>	- Evaporator temperature sensor error	Unplug the unit and plug in. If error is still happened, please check with the qualified person / or return it to store.
<b>7. LED displays E4 code</b>	- Display panel communication error	Unplug the unit and plug in. If error is still happened, please check with the qualified person / or return it to store.
<b>8. LED displays P1 code</b>	- Bottom tray is full	Connect the drain hose and drain the collected water away. If error is still happened, please check with the qualified person / or return it to store.



## PRODUCT SPECIFICATION

The figures below are for reference only and are based on practical operation. Performance may vary slightly depending on environmental conditions.

Description of product	Local air conditioner
Model	MPPHA-05CRN1-QB6
Voltage/Frequency	220-240V~/50Hz
Cooling capacity	5000BTU/H
	1.4 kW
Dehumidifying capacity	1.4L/H
Refrigerant	R-410A/200g
Timer	24 hours
Air flow volume	275 m <sup>3</sup> /hour
Dimensions (W) X (H) X (D)	32.9x61.5x31.8
Weight	19.5kg
Room size	Up to 10 m <sup>2</sup>
Contains fluorinated greenhouse gases covered by the Kyoto Protocol. GWP:2088; 0.42 tonnes CO <sub>2</sub> equivalent. Hermetically sealed.	

**(EC) NO.842/2006:**

**Do not vent R-410A into atmosphere: R-410A is a fluorinated greenhouse gas, covered by Kyoto Protocol, with a Global Warming Potential (GWP)=2088.**

## CONNECTION TO POWER ( FOR UK ONLY)

Before Switching on make sure that the voltage of your electricity supply is the same as that indicated on the rating plate.

### MAIN CORD

**Wiring Instructions: Should it be necessary to change the plug please note the wires in the mains lead are coloured in accordance with the following code :**

**BLUE - NEUTRAL**  
**BROWN - LIVE**  
**GREEN AND YELLOW - EARTH**

As the colours of the wires in the mains lead of this appliance may not correspond with the coloured markings identifying the terminals in your plug, proceed as follows:

1. The **BLUE** wire is the **NEUTRAL** and must be connected to the terminal which is marked with the letter **N** or coloured **BLACK**.
2. The **BROWN** wire is the **LIVE** and must be connected to the terminal which is marked with the letter **L** or coloured **RED**.
3. The **GREEN/YELLOW** is the **EARTH** and must be connected to the terminal which is marked with the letter **E** or  or coloured **GREEN OR GREEN/YELLOW**.
4. Always ensure that the cord grip is positioned and fastened correctly.

If a **13 Amp (BS 1363)** fused plug is used it must be fitted with a **13Amp** fuse. If in doubt consult a qualified electrician.

### Wiring for a 13 Amp Plug (BS1363)

Please note. The Earth Terminal is marked with the letter **E** or Earth Symbol .

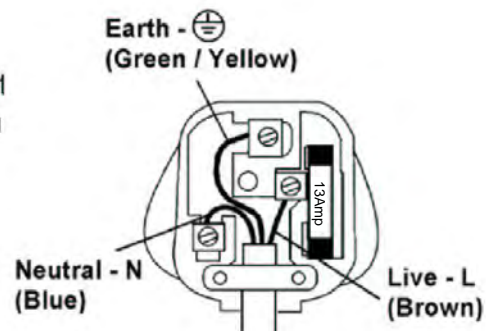

### IMPORTANT

If a 13 Amps (BS 1363) plug is used, it must be fitted with a 13 Amp Fuse conforming to BS1362 and be ASTA approved. If in doubt consult a qualified electrician who will be pleased to do this for you.



**DISPOSAL:** Do not dispose this product as unsorted municipal waste. Collection of such waste separately for special treatment is necessary.

It is prohibited to dispose of this appliance in domestic household waste.

For disposal, there are several possibilities:

- A) The municipality has established collection systems, where electronic waste can be disposed of at least free of charge to the user.
- B) When buying a new product, the retailer will take back the old product at least free of charge.
- C) The manufacture will take back the old appliance for disposal at least free of charge to the user.
- D) As old products contain valuable resources, they can be sold to scrap metal dealers.

Wild disposal of waste in forests and landscapes endangers your health when hazardous substances leak into the ground-water and find their way into the food chain.

## TECHNICAL INFORMATION (ERP)

Description	Symbol	Value	Unit
Rated capacity for cooling	P for cooling	1.4	KW
Rated power input for cooling	Peer	0.6	KW
Rated Energy efficiency ratio	EER	2.6	
Power consumption in thermostat-off mode	Pto	1.0	W
Power consumption in standby mode	Psb	0.5	W
Electricity consumption of single duct appliances	Q	0.6	KWh/60min
Sound power level	Lwa	65	dB(A)
Global Warning potential	GWP	2088	KgCO2eq
Contact details for obtaining more information	Customer helpline 0345 640 0800		

Installs, services, maintains, repairs, checks for leaks or decommissions equipment and product recycling should be carried out by natural persons that hold relevant certificates.

The fluorinated greenhouse gases are contained in hermetically sealed equipment.



## PRODUCT GUARANTEE

This product is guaranteed against manufacturing defects for a period of



Year

This product is guaranteed for twelve months from the date of original purchase.

Any defect that arises due to faulty materials or workmanship will either be replaced, refunded or repaired free of charge where possible during this period by the dealer from whom you purchased the unit.

The guarantee is subject to the following provisions:

- The guarantee does not cover accidental damage, misuse, cabinet parts, knobs or consumable items.
- The product must be correctly installed and operated in accordance with the instructions contained in this manual.
- It must be used solely for domestic purpose.
- The guarantee will be rendered invalid if the product is re-sold or has been damaged by inexpert repair.
- Specifications are subject to change without notice.
- The manufacturer disclaims any liability for the incidental or consequential damages.
- The guarantee is in addition to, and does not diminish your statutory or legal rights.

Guarantor: Argos Ltd  
489 - 499 Avebury Boulevard  
Central Milton Keynes  
MK9 2NW