

BUSH

Instruction manual

Steam Iron Model:
ES2530



You'll soon be enjoying your new Bush Steam Iron.

It all begins here, with your instructions. Don't worry, there's nothing too technical coming up. Just simple, step-by-step guidance to get you up and running quickly. Sound good? Then let's get started.

Help and Guidance

We're here to help you get the most from your Bush Steam Iron. Should you require any guidance; call our Help line on 0345 604 0105. Further contact details can be found online at: **www.bush-support.com**

Or by calling one of our experts on **0345 604 0105**

Contents

1	Safety information	4
2	Getting to know your steam iron	8
3	Using your steam iron	10
4	Care and maintenance	16
5	Product support	19

Safety information 1



Safety information

Important - Please read these instructions fully before installing or operating

- The iron must be used only for its intended purpose.
- The iron must not be left unattended while it is connected to the supply mains.
- Always unplug the appliance from the socket outlet before you fill in the water reservoir, when emptying it or when not in use.
- The iron must be used and rested on a flat, stable and heat-resistant surface
- When placing the iron on its heel, ensure that the surface on which the heel is placed is stable.
- The iron is not to be used if it has been dropped, if there are visible signs of damage or if it is leaking.
- Keep the iron and its cord out of reach of children less than 8 years of age when it is energized or cooling down.
- The surfaces of the iron are liable to get hot during use. Burns can occur from touching hot parts, hot water or steam.
- This appliance can be used by children aged from 8 years and above and persons with reduced physical, sensory or mental capabilities or lack of experience and knowledge if they have been given supervision or instructions concerning use of the appliance in a safe way and understand the hazards involved.
- Children shall not play with the appliance.
- Cleaning and user maintenance shall not be made by children without supervision.
- Check the mains cord regularly for possible damage. If the supply cord is damaged, it must be replaced by the manufacturer, its service agent or similarly qualified persons in order to avoid a hazard.
- Never immerse the iron, cable or plug in water
- Do not leave the hot iron touching fabrics or inflammable surfaces, do not let the cord come into contact with hot soleplate of the iron.



Safety information

Important - Please read these instructions fully before installing or operating

- Never touch the appliance with wet or damp hands.
- Do not put scented substances, descaling agents or other chemicals in the water tank. Failure to comply will lead to the loss of guarantee.
- The water inlet cover must not be open during operation.
- Only connect the iron to an earthed wall socket. If the extension cord is required, a 13-ampere cord should be used. Cords with lower amperage may overheat.



Safety information

Important - Please read these instructions fully before installing or operating

Plug / Wiring advice

The wires in this mains lead are coloured in accordance with the following UK electrical code:

BLUE = NEUTRAL

BROWN = LIVE

GREEN + YELLOW = EARTH

Rewireable plug

The colours of the wires in the mains lead of this appliance may not correspond with the coloured markings identifying the terminals in a rewireable plug. **Rewireable plugs should only be replaced by a suitably competent person. If in doubt, consult a qualified electrician.**

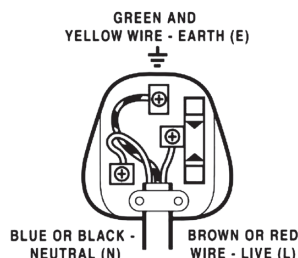

The BLUE wire must be connected to the terminal marked with the letter N

The BROWN wire must be connected to the terminal marked with the letter L

The GREEN & YELLOW wire must be connecting to the terminal

Getting to know your steam iron 2

Getting to know your steam iron

You'll be up and running in no time

Ready? Let's begin...

Please read these instructions carefully. They contain important information which will help you get the best from your steam iron and ensure safe and correct installation and operation.

If you require any further assistance, our technical experts are happy to help. For full details, refer to the product support section at the end of these instructions.

Part identification

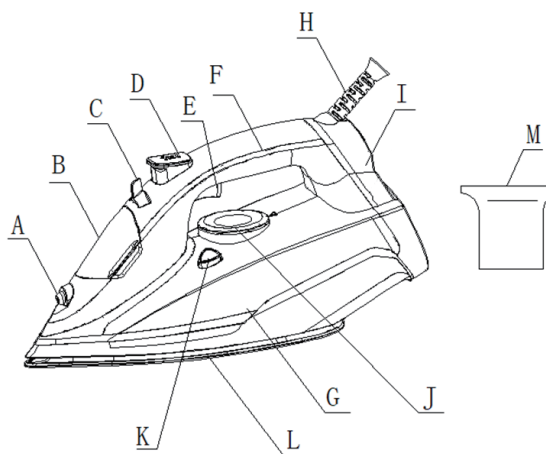

- A. Spray nozzle
- B. Water inlet cover
- C. Steam dial
- D. Spray button
- E. Shot steam button
- F. LED light strip
- G. Water tank

- H. Cord bushing
- I. Rear cover
- J. Temperature dial
- K. Self clean button
- L. Soleplate
- M. Water cup

If you require any technical guidance or find that your product is not operating as intended, a simple solution can often be found in the **Troubleshooting** section of these instructions

Using your steam iron **3**





Using your steam iron

Let's get started

Note: When using the iron for the first time, you may notice a slight emission of smoke and hear some sounds made by the expanding plastics. This is quite normal and it stops after a short time. We also recommend passing the iron over an ordinary cloth before using it for the first time.

PREPARATIONS:

Sort the laundry to be ironed according to the international symbols on the garment label, or if this is missing, according to the type of fabric.

GARMENT LABEL	FABRIC TYPE	THERMOSTAT REGULATION
	synthetic	• low temperature
	silk - wool	•• medium temperature
	Cotton - linen	••• high temperature
	Fabric not to be ironed	

Start ironing the garments requiring a low temperature.
This reduces the waiting times (the iron takes less time to heat up than to cool down) and eliminates the risk of scorching the fabric.

Using your steam iron

Let's get started

- STEAM IRONING

Filling the reservoir

- Check that the plug is disconnected from the socket.
- Move the steam dial (C) to "Off" [Fig. 1].
- Open the water inlet cover (B).
- Raise the tip of the iron to help the water enter the opening without overflowing.
- Slowly pour the water into the water tank by using the water cup and taking care not to go over the maximum level (about 350ml) indicated by "MAX" on the water tank.
- Close the water inlet cover (B).

Selecting the temperature.

- Put the iron in a vertical position.
- Put the plug in the socket.
- Adjust the temperature dial (J) according to the international symbol on the garment label .
- The LED light strip(F) flash that means iron is heating up. Wait until the light remains on before ironing.[Fig. 3]

Warning: during ironing, the LED light strip flash at intervals, indicating that the selected temperature is maintained. If you lower the thermostat temperature after ironing at a high temperature, do not start ironing until the LED light strip re-flash and remains on again.

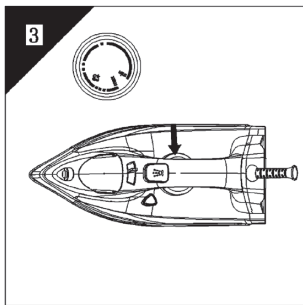
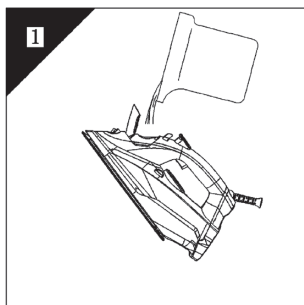

Using your steam iron

Let's get started

- STEAM IRONING

Selecting the steam.

The quantity of steam is regulated by the steam dial(C).

- Move the steam dial to a position between minimum and maximum depending on the quantity of steam required and the temperature selected [Fig.3].

Warning: the iron gives off steam continuously only if you hold the iron horizontally. You can stop the continuous steam by placing the iron in a vertical position or by moving the steam dial to "off". As indicated on the temperature dial (J) and in the initial table, you can only use steam at the highest temperatures. If the selected temperature is too low, water may drip onto the plate.

Selecting Shot-steam and steam when ironing vertically.

Press the shot-steam button (E) to generate a powerful burst of steam that can penetrate the fabrics and smooth the most difficult and tough creases. Wait for a few seconds before pressing again [Fig. 4].

By pressing the shot-steam button at intervals you can also iron vertically (curtains, hung garments, etc.) [Fig. 5].

Warning: the shot-steam function can only be used at high temperatures. Stop the emission when the LED light strip flash, then start ironing again only after the light remains on.

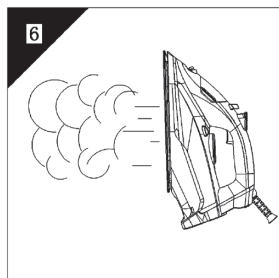
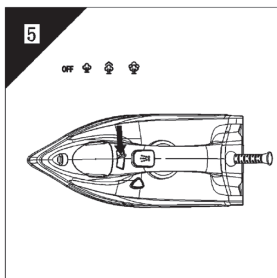
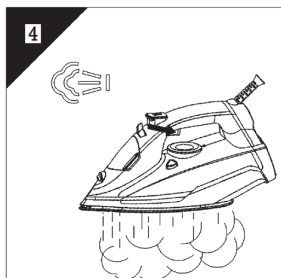

Using your steam iron

Let's get started

- **DRY IRONING**

To iron without steam, follow the instructions in section “steam ironing”, leaving the steam dial(C) on position “ off ”.

Spray Function

Make sure that there is water in the reservoir. Press the spray button (D) slowly (for a dense spray) or quickly (for a vaporized spray) [Fig. 2].

Warning: for delicate fabrics, we recommend moistening the fabric beforehand using the spray function (D), or putting a damp cloth between the iron and the fabric. To avoid staining, do not use the spray on silk or synthetic fabrics.

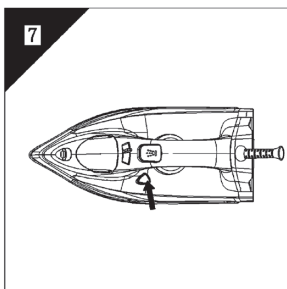
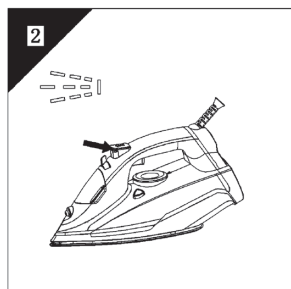

- **CLEANING**

Please note: before cleaning the iron, make sure that the appliance plug is not connected to the socket.

Any mineral deposits, starch residue left on the plate can be removed using a damp cloth or a non-corrosive liquid detergent.

Avoid scratching the plate with steel wool or metallic objects.

The plastic parts can be cleaned with a damp cloth then wiped over with a dry cloth.

- **SELF CLEANING**

The self-cleaning feature cleans inside the plate, removing impurities. We recommend using it every 10-15days.

Directions:

- Fill the water tank up to the max level indicated and set the steam dial (C) to “OFF”.
- Set the temperature dial (J) to the max temperature and wait for the

Or by calling one of our experts on **0345 604 0105**

light (F) remain on.

- Disconnect the plug from the socket and hold the iron horizontally over the sink.

- Hold the self clean button (J) until all the boiling water, steam, impurities come out[Fig. 7].

- When the soleplate has cooled down, you can clean it with a damp cloth.

Warning: Boiling hot water and lots of steam will drain from the holes of the soleplate during self clean. Position yourself comfortably near a sink before you start. The self clean process will take up to 5 minutes to complete. Do not place the iron back on the base until the self clean process has completed.

Using your steam iron

Let's get started

- ANTI-CALC SYSTEM

A special resin filter inside the water reservoir softens the water and prevents scale build-up in the plate. The resin filter is permanent and does not need replacing.

Please note:

Use tap water only. Distilled and/demineralised water makes the “Zero-Calc” anti-calc system ineffective by altering its physicochemical characteristics.

Do not use chemical additives, scented substances or decalcifiers. Failure to comply with the above-mentioned regulations leads to the loss of guarantee.

- ANTI-DRIP SYSTEM

With the anti-drip system, you can perfectly iron even the most delicate fabrics.

Always iron these fabrics at low temperatures. The plate may cool down to the point where no more steam comes out, but rather drops of boiling water that can leave marks or stains. In these cases, the Anti-drip system automatically activates to prevent vaporization, so that you can iron the most delicate fabrics without risk of spoiling or staining them.

- AUTOMATIC SHUT OFF

The automatic shut off feature stops heating the iron when it has been left for approx. eight minutes in the upright position or unused for approx. thirty seconds in the horizontal position. The light comes on to indicate that shut off feature is in progress. As soon as you move the iron, the device turns off and the iron starts working again.

Care and maintenance 4

Care and maintenance

Looking after your appliance

- HOW TO PUT IT AWAY

Disconnect the plug of the iron from the socket.

- Empty the reservoir by turning the iron upside down and gently shaking it.
- Leave the iron to cool down completely before storing away
- Don't wrap the cable round the appliance
- Always put the iron away in a vertical position.

- ADVICE FOR GOOD IRONING

We recommend using the lowest temperatures with fabrics that have unusual finishes (sequins, embroidery, flush, etc.).

If the fabric is mixed (e.g. 40% cotton 60% synthetics), set the thermostat to the temperature of the fibre requiring the lower temperature.

If you don't know the composition of the fabric, determine the suitable temperature by testing on a hidden corner of the garment. Start with a low temperature and increase it gradually until it reaches the ideal temperature.

Never iron areas with traces of perspiration or other marks: the heat of the plate fixes the stains on the fabric, making them unremovable.

To avoid making silk, woolen or synthetic garments shiny, iron them inside out.

To avoid marking velvet garments shiny, iron in one direction (following the fibre) and do not press down on the iron.

Many fabrics are easier to iron if they are not completely dry.

For example, silk should always be ironed damp

Other information

Technical Specification

Model	ES2530
Argos Number	7413645
JS Number	145758541
Rated voltage	220-240V ~ 50/60Hz
Power	2800W
Class rating	Class I
BS 1362 fuse	13A
Heating time	1minutes
Water reservoir capacity	350ml
Cord length	1.9m
Ingress protection	IPX4
Accessory(water jug)	200ml



Recycling electrical products



You should now recycle your waste electrical goods and in doing so help the environment.
This symbol means an electrical product should not be disposed of with normal household waste. Please ensure it is taken to a suitable facility for disposal when finished with.
Visit www.recycle-more.co.uk, click on "bank locator" and enter your postcode to find your nearest recycling site.

Or by calling one of our experts on **0345 604 0105**

Product support 5

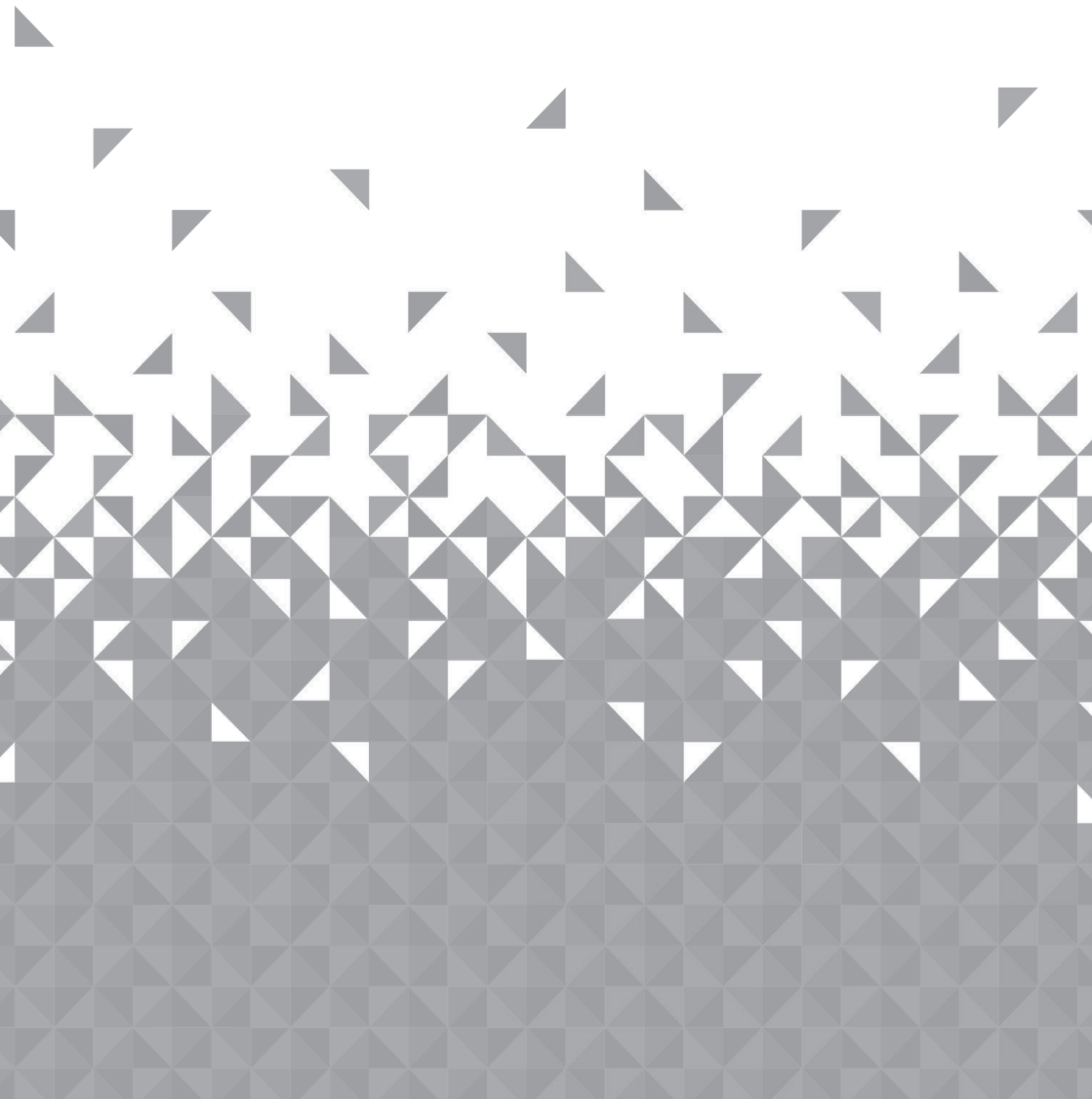

Product support

Help is always at hand

Help and assistance

If you require any technical guidance or find that your Bush steam cleaner is not operating as intended, a simple solution can often be found in the Troubleshooting section of these instructions or online at www.bush-support.com

If you still require further assistance, call one of our expert on 0345 604 0105*.

To help give us give you a fast and efficient service please have the following information ready:

Model Ref:	<input type="text"/>	You can find this information on the rating plate – a small sticker (usually a sticker or metal plate on the rear of your product)
Serial number	<input type="text"/>	
Date of purchase	<input type="text"/>	This will be shown on your receipt

Local call rate applies*

Lines open 8am-7pm Monday to Saturday and
10am-4pm Sunday.

*Calls to Bush enquiry lines may attract a charge and set up fee from residential lines depending on your call plan / tariff. Mobile and providers costs may vary, see www.bt.com/pricing for details

For security and training purchase, telephone calls to and from customer service centres maybe recorder and monitored. Calls from Republic of Ireland will attract international call charges.

Or by calling one of our experts on **0345 604 0105**

Product support

Help is always at hand

BUSH

Call us now and register your 12 month guarantee

Thank you for choosing Bush. Your new product is guaranteed against faults and breakdowns for 12 months. Don't forget to register it with us today so we can provide you with our best possible after-sales service and useful updates.

www.bush-support.com

FREEPHONE*

0800 597 8548

Lines open 8am-8pm, 365 days a year. *Calls may be recorded and monitored.

Your Bush Guarantee

This product is guaranteed for twelve months from the date of original purchase. Any defect that arises due to faulty materials or workmanship will be repaired free of charge (or if applicable the product will be replaced or the purchase price refunded) where possible during this period by the dealer from whom you purchased the unit.

The guarantee is subject to the following provisions:

- The guarantee does not cover accidental damage, misuse, cabinet parts, knobs or consumable items.
- The product must be correctly installed and operated in accordance with the instructions contained in the material.
- It must be used solely for domestic purposes. The guarantee will be rendered invalid if the product is re-sold or has been damaged by inexpert repair.
- Specifications are subject to change without notice.
- Bush disclaim any liability for loss or damage arising from the breakdown of the product.
- This guarantee is in addition to and does not diminish your statutory or legal rights.

For your personal Guarantee Confirmation code call 0800 597 8548

Guarantee Confirmation Code

If you require any technical guidance or find that your product is not operating as intended, a simple solution can often be found in the **Troubleshooting** section of these instructions

BUSH

Product support

Help is always at hand

Important Data Protection Information

Bush has appointed Domestic & General Insurance PLC to provide product registration services and protection plans to accompany its products.

What we do with your information

At Domestic & General we want to reassure you that we use your information both responsibly and securely to provide you with the best possible service. Below we explain what we do with your information and your rights to your information. If you would like any further details you can get in touch with us using the contact details below or visit our website (www.domesticandgeneral.com).

Using your information

Domestic & General Insurance PLC ("we") is the "data controller" of your information. We process two sets of information about you. "Personal Information" (your name, address, contact and payment details) and the "Good Information" you provide to register your appliance or device (your name, address, contact and good details). We'll use your information: (i) as necessary to fulfill our contract with you (including to recover any amounts owing); (ii) for our legitimate interests in: undertaking marketing (about our products and services and those of our third party partners) by post, telephone, email and/or other electronic messaging services; recording your conversations for training, quality and compliance purposes; and for analytics and profiling for marketing purposes; and (iii) where required to do so by law. We may also ask for your consent to some uses of your information.

Sharing your information

From time to time your Personal Information and Goods Information may also be shared with other members of the Domestic & General Group of Companies (Domestic & General Insurance or Services and other future members of the Group whose details we will notify to you ("Group")), with companies acting on our behalf or providing services to us (e.g. the companies we use to carry out repairs, IT & mailing services storage of paper records and telecommunications) and with the Sainsbury's Argos Group (which currently includes Sainsbury's Supermarkets, Sainsbury's Bank, Argos Limited, Tu Clothing, Habitat, Argos Financial Services, Nectar and Insight 2 Communication, Argos Business Solution Limited). The Sainsbury's Argos Group will process your Personal information for their legitimate business interests (marketing and analytic) in accordance with their privacy policy, which can be found at www.argos.co.uk/help/privacy-policy

Transferring your information

In exceptional cases, we may transfer your information to countries outside the European Economic Area (including the US) which may not have data protection laws, which provide the same level of protection as provided in the UK. We have put in place Model Clause as an appropriate safeguard to ensure that such information is adequately secured and protected and that such transfers meet the requirements of appliance data protection law.

Product support

Help is always at hand

Keeping your information

We keep your Personal Information for six years after you terminate your policy so that we can deal with any claims. Your goods information we keep for a bit longer, normally 10 years (that average life of an appliance) for health and safety. We also keep your information to send you marketing that you might be interested in, unless we receive a request from you to opt-out of marketing.

Rights to your information

By writing to the Data Protection Officer using the contact details provided below, you have the right to ask us:

- for a copy of the Personal Information we hold about you
- for a copy of the Personal Information you provided to us be sent to you or a third party in a commonly used, machine readable format
- to update or correct your Personal Information to keep it accurate
- to delete your Personal Information from our records if it is no longer needed for the original purpose; and
- to restrict the processing of your Personal Information in certain circumstances

And you may also:

- object to us processing your Personal Information – in which case we will wither agree to stop processing or explain why we're unable to; and
- where we rely on your consent, withdraw that consent at any time.

Please note that the above rights are not absolute and certain exemptions apply to them.

You can also make a complaint to the Information Commissioner (www.ico.org.uk) if you feel your personal Information has been mishandled.

Marketing

We, along with other members of our Group, Argos Limited, and other members of the J Sainsbury's Group of Companies may use your information to tell you about any offers, products or services which may be of interest to you. We may contact you by post, telephone, email, and/or other electronic messaging services. To change your marketing preference, let us know by emailing marketingpreference@domesticandgeneral.com or by writing to us using the contact details provided below. If you don't want Argos to send you marketing by phone, email or post then please see Argos's Privacy Policy, which can be found on their website at www.argos.co.uk/help/privacy-policy to opt out of this marketing. Argos will stop sending you marketing communication but will still contact you service-related messages every now and then.

Contact Details

If you need to contact us about your information or your information rights, or to see a copy of our Model Clauses, please write to: Freepost Plus RTKS-CLRA-GRYE, Data Protection Officer, Domestic & General, Leicester House, 17 Leicester Street, Bedworth, CV12 8JP or dataprotection@domesticandgeneral.com and we'll be happy to help you.

BUSH

Should you require any guidance:
call our Help line on 0345 604 0105.
Further contact details can be found online at:
www.bush-support.com

Produced in China for Argos Limited, London, EC1M 6HA, UK.
Argos (N.I.) Ltd., forestside Shopping Centre.
Upper Galwally, Belfast, BT8 6FX UK.