

2017-11-11(1)

145.00 mm

BUSH

Instruction manual
SM-518



210.00 mm



You'll soon be enjoying your new steam mop .

It all begins here, with your instructions. Don't worry, there's nothing too technical coming up. Just simple, step-by-step guidance to get you up and running quickly. Sound good? Then let's get started.

Help and Guidance

We're here to help you get the most from your steam mop. Should you require any guidance, a simple solution can often be found online at:

www.argos-support.co.uk

If you still require further assistance, call one of our experts on **HELPLINE 0345 604 0105** .

Contents

1 Safety information

Safety information	6
Electrical	11

2 Care and maintenance

Cleaning	14
Care and maintenance	14

3 Getting to know your steam mop

Ready?Let's begin	18
Accessories	19

4 Installing your steam mop

Unpacking	22
Assembly	23

5 Using your steam mop

First use of steam mop	26
Using the steam mop	26
Technical specification	33

6 Product support

Troubleshooting	36
Help and assistance	37
Declaration of conformance to product Standards	38
Disposal	38

Safety information 1



Safety Information

Important - Please read all instructions before use and keep for future reference



WARNING: To reduce the risk of fire, electrical shock, or injury, the following basic safety precautions should always be followed when using an electrical appliance.

WARNING: To reduce the risk of electrical shock, this appliance has a ground (three-pronged) plug. This plug will fit in a polarized wall outlet only one way. If the plug does not fit fully in the outlet, contact a licensed electrician to install a proper outlet, contact a licensed electrician to install a proper outlet. Do NOT attempt to modify the plug or defeat this safety feature.

READ ALL INSTRUCTIONS BEFORE USE



DANGER

Any appliance is electrically live even when switch is off. To reduce risk of electrical shock:

1. Always unplug power cord immediately after using.
2. Do not place or store unit where it can fall or be pulled into a sink or tub.
3. Do not place in, or drop into water or other liquid.
4. If unit falls into water, immediately unplug power cord. Do not reach into the water.

If you require any technical guidance or find that your product is not operating as intended, a simple solution can often be found in the **Troubleshooting** section of these instructions.

Safety Information

Important - Please read all instructions before use and keep for future reference



WARNING

To reduce risk of burns, electrocution, fire, or injury to persons:

1. Use Multi-Purpose Steamer only for its intended purpose as indicated in manual.
2. Before plugging power cord into electrical outlet, be sure that all electrical information on rating label agrees with your power supply.
3. To reduce likelihood of circuit overload, DO NOT operate another high wattage appliance on the same circuit as this unit.
4. To protect against risk of electrical shock, do not immerse unit in water or other liquids. Do not use power cord as handle, allow it to hang over edge of counters, or be crimped or closed in doors.
5. Steam Control Dial should always be set to "OFF" position before plugging or unplugging unit from outlet. Never yank power cord to disconnect from outlet; instead, grasp plug and pull to disconnect.
6. Do not operate unit with a damaged power cord or if the unit has been dropped or damaged. To avoid risk of electrical shock, do not disassemble unit; take it to a qualified service repair person for examination and repair. Incorrect reassembly can cause a risk of electrical shock when unit is used.

Safety Information

Important - Please read all instructions before use and keep for future reference

7. Close supervision is required for any appliance being used near children, pets and plants. Do not leave unit unattended while plugged in.
8. This appliance can be used by persons with reduced physical, sensory or mental capabilities or lack of experience and knowledge if they have been given supervision or instruction concerning use of the appliance in a safe way and understand the hazards involved. Children shall not play with the appliance.
9. If Power Indicator Light does not illuminate when Steam Control Dial is set to one of three steam intensity settings, unit is not operating normally. Immediately turn unit off and disconnect from power supply-have unit serviced by qualified service personnel.
10. Unplug power cord before filling Water Tank with water.
11. Do not use unit where aerosol-based products are being used, or where oxygen is being administered.
12. Unit is only meant to be used with recommended SM-08 accessories. Using other types of attachments may cause damage to unit or injury.
13. When filling Water Tank, only water should be used in unit-other cleaning agents, could damage unit or cause injury. Distilled or de-mineralized water is highly recommended, in order to minimize potential build-up of mineral deposits. Do not overfill unit.

If you require any technical guidance or find that your product is not operating as intended, a simple solution can often be found in the **Troubleshooting** section of these instructions.

14. Do not attempt to use unit without properly filling Water Tank.
15. To reduce risk of contact with hot water emitting from Steam Nozzle, check appliance before each use by positioning it away from body and turning it on. Do not operate unit if Steam Nozzle is blocked.
16. Burn can occur from touching hot metal parts, hot water, or steam. Do not touch Steam Nozzle or attempt to connect accessories while unit is in use. Use caution when you turn unit upside-down-there may be hot water in unit.
17. When steaming any item for the first time, it is recommended that you consult the manufacturer's guidelines for material being steamed. For items in question, test on an inconspicuous area before proceeding.
18. Steaming unsealed floor surfaces such as hardwood is not recommended, and may result in warping or damage to the surface.
19. Do not allow power cord to touch hot surfaces during use. Wrap cord loosely around Cord Brackets when storing.
20. Always allow Multi-Purpose Steamer to cool completely (at least 30 minutes) and empty Water Tank before storing.
21. Liquid or steam must not be directed towards equipment containing electrical components such as the interior of ovens.



22. Do not use the appliance if dropped, leaking or there are visible signs of damage. Keep appliance out of reach of children when it is energised or cooling down.

This appliance is intended for domestic household use only and should not be used for any other purpose or in any other application, such as for non-domestic use or in a commercial environment.

Safety Information

Important - Please read all instructions before use and keep for future reference

Electrical



Any electrical work that is required to install this appliance MUST be carried out by a qualified electrician.

Before making any electrical connections, ensure that:

- Do not bend, stretch or pull the supply cable to avoid electric shock.
- Ensure the power socket is suitable for the maximum power of the machine.
- The supply voltage should be the same as that indicated in the technical specifications and the appliance rating plate.
- If the socket outlets in your home are not suitable for the plug supplied with this unit check with a qualified electrician for replacement.
- The use of adapters, multiple connectors or extension cables are not recommended.
- The appliance must be connected to a 220-240 volt 50Hz AC supply by means of a three pin socket, suitably earthed and protected by a 13 amp fuse.
- Should the fuse need to be replaced, a 13 amp fuse approved to BS1362 must be used.
- The plug contains a removable fuse cover that must be refitted when the fuse is replaced. If the fuse cover is lost or damaged, the plug must not be used until a replacement cover has been fitted or the plug is replaced.

Safety Information

Important - Please read all instructions before use and keep for future reference

Electrical

- A damaged plug should be cut off as close to the plug body as possible, the fuse should be removed and the plug disposed of safely.

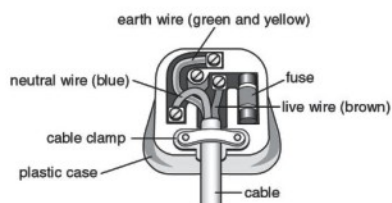

As the colours of the wires in the power cable may not correspond with the coloured markings identifying the terminals in your plug, and proceed as follows:

The blue wire must be connected to the terminal that is marked with the letter N.

The brown wire must be connected to the terminal that is marked with the letter L.

The green+yellow wire must be connected to the terminal that is marked with the letter E.

If power supply cord is damaged, it must be replaced by the manufacturer or its service agent or a similar qualified person in order to avoid a hazard.

Care and maintenance 2



Care and maintenance

Looking after your appliance

Cleaning

Always switch off the appliance and unplug from the mains socket before carrying out any maintenance or cleaning.

Clean the outside of the appliance with a damp cloth. Dry thoroughly before use.

Never immerse the appliance in the water.

Do not use abrasive or chemical cleaning agents.

PROPER STORAGE

Preparing your *Multi-Purpose Steamer* for storage is quick and simple. When you have finished your steaming tasks, follow the steps listed below.

1. Unplug power cord from electrical outlet.
2. Allow unit time to cool (at least 5 minutes).
3. Remove all accessories from unit.
4. Remove Water Tank Cap and drain any remaining water from Water Tank into a sink or tub to minimize potential mineral build-up. Replace Water Tank Cap when done.
5. Collapse Extension Pole to shortest length (if storage space is limited), and wrap power cord around Cord Brackets.
6. Store *Multi-Purpose Steamer* in a cool, dry location, along with all attachments.

REMOVING MINERAL BUILD-UP

A common maintenance need for steam appliances is the removal of building-up caused by high mineral content in many municipal water supplies. This mineral build-up may limit the effectiveness and reduce the life of your *Multi-Purpose Steamer*.

The best way to minimize mineral build-up is to use distilled or de-mineralized water when using your *Multi-Purpose Steamer*. In addition, it is recommended that the cleaning procedure below be followed at least once a month in order to remove any deposits that form. This will help to extend the life of your *Multi-Purpose Steamer* and keep it functioning at its maximum potential.

1. Follow **STEPS 1-4** under **Proper Storage** section above. However, do not replace Water Tank Cap at the end of **STEP 4**.
2. Insert tip of Cleaning Pin into opening of Steam Nozzle to remove mineral build-up in nozzle. This may also be done to clean accessories such as the Jet Nozzle.
3. Use Measuring Cup to make a mixture of approximately 100mL. distilled water and 50mL. vinegar.
4. Slowly pour water-vinegar solution into Water Tank through fill hole, then replace Water Tank Cap.

5. Plug in power cord, set Steam Control Dial to HIGH, and spray full contents of Water Tank into a sink or tub.
6. Once Water Tank is drained, turn unit off and refill Tank with 330mL. of fresh distilled water. Set Steam Control Dial back to HIGH and repeat **STEP 5**. If you used a water-vinegar solution, you may need to repeat this until vinegar odor dissipates.
7. Replace Water Tank Cap, unplug power cord, and store *Multi-Purpose Steamer* as usual.

IMPORTANT: On average, it is recommended that you follow the Removing Mineral Build-up procedure once per month (if unit is used once every week). More frequent use may require following the procedure more often in order to keep your Multi-Purpose Steamer operating at full potential. Do not exceed 20 hours of use without cleaning out mineral build-up.

Getting to know your steam mop

3



Getting to know your steam mop

You'll be up and running in no time

Ready? Let's begin...

Please read these instructions carefully. They contain important information which will help you get the best from your steam mop and ensure safe and correct installation and operation.

If you require any further assistance, our technical experts are happy to help. For full details, refer to the product support section at the end of these instructions.

If you require any technical guidance or find that your product is not operating as intended, a simple solution can often be found in the **Troubleshooting** section of these instructions.

Getting to know your steam mop

You'll be up and running in no time

The following features and accessories are included with your *Multi-Purpose Steamer*. Carefully inspect Styrofoam packing material for all parts listed below.

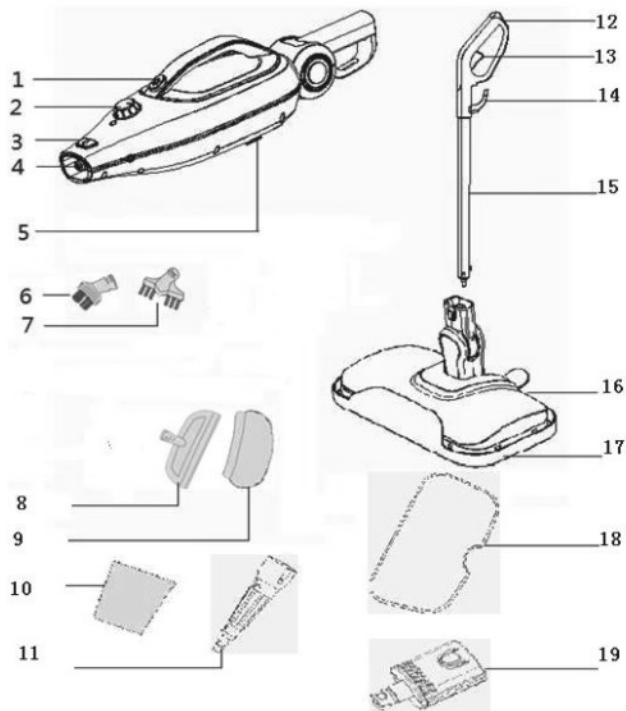

UNIT FEATURES&ACCESSORIES

- | | | |
|-------------------------|--------------------------|--------------------------------|
| 1 Handheld steam button | 2 Steam adjusting knob | 3 Brush release button |
| 4 steam outlet | 5 Hard Water Filter | 6 Small Plastic Brush |
| 7 Grout Brush | 8 Window/Upholstery Tool | 9 Window/Upholstery Tool Cloth |
| 10 Water Tank | 11 Concentration Tool | 12 Handle |
| 13 Handle steam button | 14 Cord Hook | 15 AL Tube |
| 16 Floor Head | 17 Carpet Glider | 18 Microfibre Pads |
| 19 Accessory connector | | |

Installing your steam mop

4



Installing your multi function steam mop

Bringing it all together

Unpacking

Unpacking your steam mop

Assembling the extension pole

Insert threaded connector on bottom of Extension Pole base on main unit (FIGURE 1-A).

1. Insert the metal tube into the main body, it assembled well once you hear "click"(FIGURE 1-B)
2. To disassemble length of Extension Pole :
 - 1) press the switch button ①, to make sure the metal tube was equipped tightly
 - 2) push it out (FIGURE 1-C)

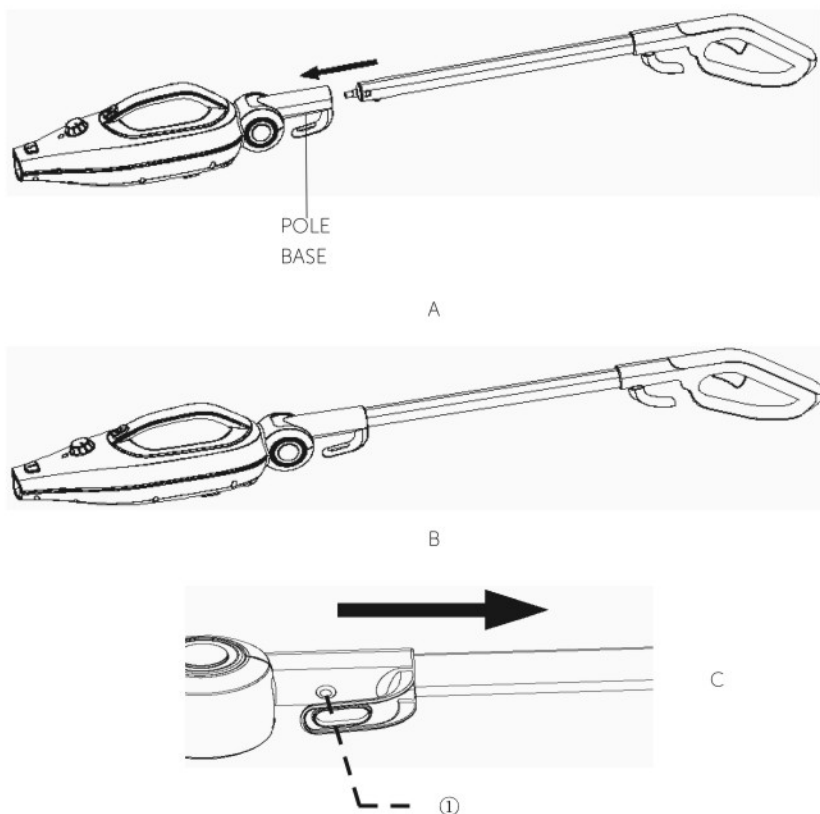

FIGURE 1

If you require any technical guidance or find that your product is not operating as intended, a simple solution can often be found in the **Troubleshooting** section of these instructions.

Assembling the mop head

1. Align Mop Head with main unit as shown (FIGURE 2), so that neck is in line with Steam Nozzle.
2. Slide Mop Head neck into Steam Nozzle, pressing firmly until release button snaps through hole.
3. To remove Mop Head, press firmly on release button while simultaneously pulling Mop Head away from Steam Nozzle.

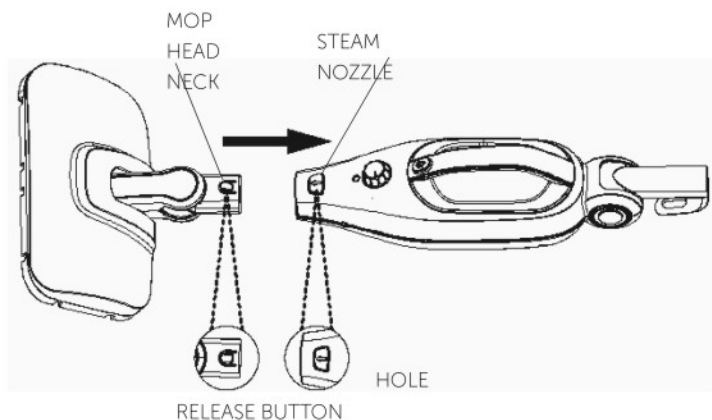

FIGURE 2

Assembling the jet nozzle

CAUTION: Metal tip of Jet Nozzle becomes hot during use. Do not touch tip to avoid burns.

1. Align Jet Nozzle with Steam Nozzle as shown (FIGURE 3).
2. Slide Jet Nozzle into Steam Nozzle, pressing firmly until release button snaps through hole.
3. To remove Jet Nozzle, press firmly on release button while simultaneously pulling Jet Nozzle away from Steam Nozzle.

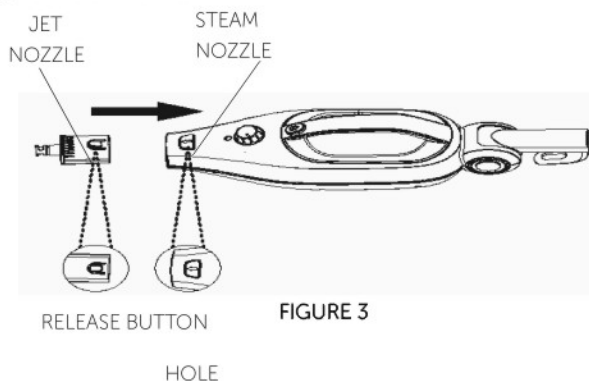

FIGURE 3

Assembling the utility head

1. Align Utility Head with Steam Nozzle as shown (FIGURE 4).
2. Slide Utility Head into Steam Nozzle, pressing firmly until it slides all the way in.
3. To remove Utility Head, simply grasp it and pull it away from Steam Nozzle.

NOTE: The Utility Head does not utilize a release button like the Mop Head and Jet Nozzle.

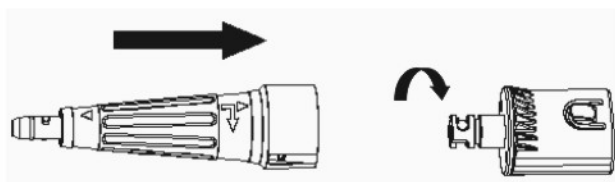
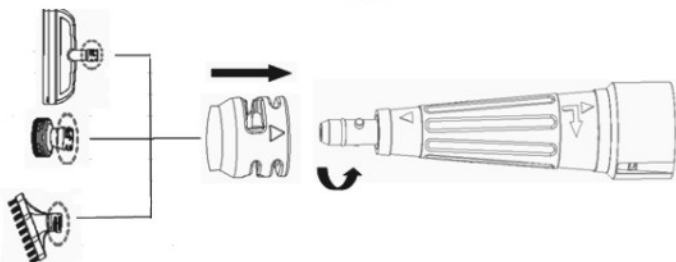
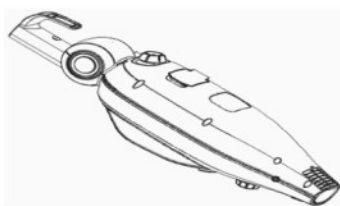

FIGURE 4



Assembling/disassembling the water filter

1. Remove the water filter as the pics shows in A & B.
2. Assembling the water filter as pics C & D, make sure is pressed to be firmly on the main body



A

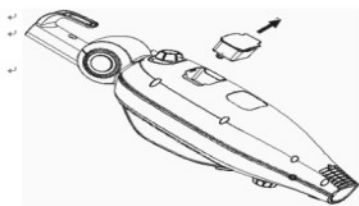

B

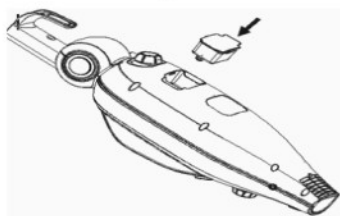

C

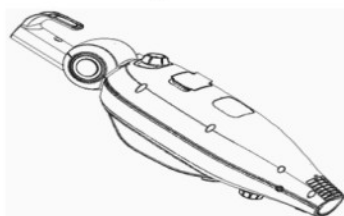

D

If you require any technical guidance or find that your product is not operating as intended, a simple solution can often be found in the **Troubleshooting** section of these instructions.

Using your steam mop

5



Using your steam mop

Getting the most from your appliance

First use of steam mop

CAUTION : Always switch off the steam mop before connecting or disconnecting the hose/attachments or removing and emptying the dirt container.

Using the accessory tools



Concentrated steam flow to lift grime . Use on car to tackle stubborn stains. The nozzle allows a powerful jet of steam to remove dirt in hard to reach places. Use with handheld wand and also your connector for other tools.



Hard-wearing for use on hard sealed surfaces. Always test a hidden area before use.



Squeegee tool window/shower tool Clean your windows and mirrors quickly and easily. The Squeegee disperses steam evenly to clean then swipe dry to avoid streaks. Use on any glass surface including shower doors, oven glass and in your car.



Upholstery tool Attach the cloth to the window/shower tool for use on upholstery and clothes.



Grout brush Wide straight brush to tackle grout on tiled floors and surfaces. Lifts embedded dirt from in between tiles and grouting. Use with the handheld wand.



Grout brush Wide straight brush to tackle grout on tiled floors and surfaces. Lifts embedded dirt from in between tiles and grouting. Use with the handheld wand.

If you require any technical guidance or find that your product is not operating as intended, a simple solution can often be found in the **Troubleshooting** section of these instructions.

FILLING WATER TANK

NOTE: Do not remove or cut small rubber air valve on top of Water Tank Cap (FIGURE 9-A). Do not turn unit upside-down when Water Tank is full – some water may leak through air valve.

1. Make sure Steam Control Dial is set to "OFF" position.
2. Rotate Water Tank Cap one quarter turn in "Unlock" direction (counter-clockwise) indicated by illustration on Cap, and remove.
3. Carefully fill Cup with maximum amount of water and pour into water Tank through fill hole. Repeat up to one more times to fill Water Tank to maximum capacity (Tank holds a maximum of 330 ml. of water).

NOTE: In order to significantly reduce mineral build-up and prolong the life of your *Multi-Purpose Steamer*, use of distilled or de-mineralized water in the unit is highly recommended.

4. Replace Water Tank Cap so that thread grooves on bottom of Cap (FIGURE 9-B) align with tabs inside fill hole (FIGURE 9-C). Press Water Tank Cap down so that it sits flush with top of fill hole (FIGURE 9-D). Rotate one quarter turn in clockwise direction (as indicated by "Lock" illustration on Cap) to lock it in place.

NOTE: The tube which transfers water from the Water Tank to the boiler is weighted down with a brass ball. This is an intentional design to improve efficiency of water usage. It is normal for this ball to create a rattling sound inside of Water Tank during use.

IF you think brass ball has come loose from tube, refer to Troubleshooting Guide on Page 32 for directions to reconnect it.

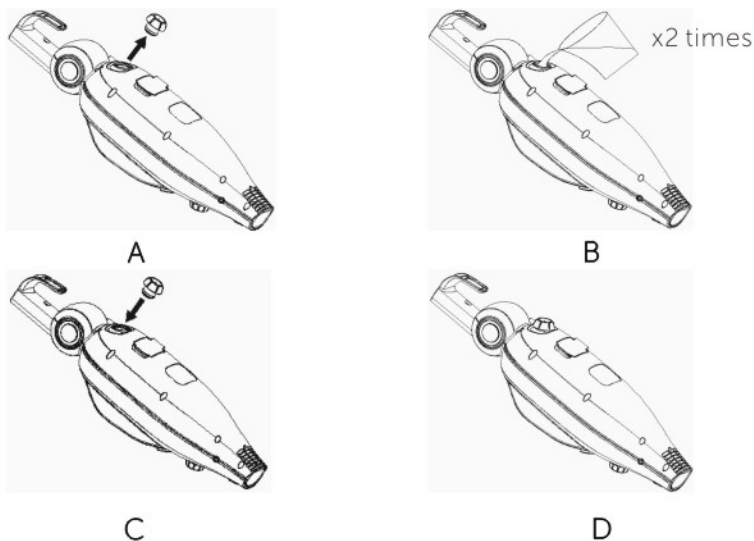

FIGURE 9

OPERATING THE *MULTI-PURPOSE STEAMER*

GENERAL

NOTE: Be sure that Water Tank has been filled and all desired accessories are connected before following these steps.

1. For first-time use, remove protective plastic cover that is shipped on electrical plug, Plug power cord into a convenient electrical outlet.

2. Turn Steam Control Dial clockwise from "OFF" position to some of the settings: LOW, or HIGH (FIGURE 10). Power Indicator Light will immediately illuminate to indicate that unit is powered on and heating.

NOTE: The desired steam intensity setting depends on the current steaming task.

3. After approximately 30 seconds, you will hear a buzzing sound as unit begins to emit steam.

4. Direct Steam Nozzle (with any connected accessories) towards surface you wish to steam.

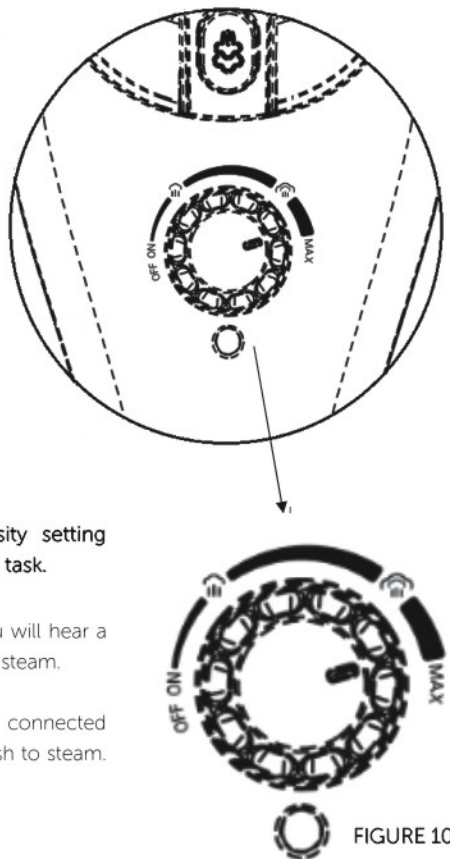

FIGURE 10



CAUTION: Always be sure that Steam Nozzle and any accessories are pointed in a safe direction (away from yourself, other people, pets and plants) when steam is being emitted.

STEAM MOPPING

NOTE: It is recommended to vacuum floors before mopping in order to remove dust and dirt particles.

·Make sure Extension Pole, Mop Head and Microfiber Cloth are all properly connected.

·For mopping, make sure Extension Pole is properly connected.

·Follow **General** operating instructions above to begin steaming. Refer to **Selecting Steam**

If you require any technical guidance or find that your product is not operating as intended, a simple solution can often be found in the **Troubleshooting** section of these instructions.

·Use a steady back-and-forth motion over the floor, pushing Mop away and pulling it back towards you. Work your way backwards over the floor, in order to avoid walking over the freshly mopped area.

·The Microfiber Cloth will absorb moisture during mopping. However, depending on floor surface and steam intensity setting, some residual moisture may be left behind. In this case, it is recommended to allow floor time to air-dry. A fan may be directed towards area to facilitate drying.

NOTE: Setting Steam Control Dial to LOW setting will help to minimize moisture left on floor.

NOTE: To avoid warping or damage caused by heat and moisture, the *Multi-Purpose Steamer* should only be used on properly sealed floor surfaces.

·Due to large size of the Mop Head, it may have difficulty completely cleaning certain types of floors (such as ceramic tile) that include crevices of grouting. To more thoroughly clean floor grout, it is recommended to use *Multi-Purpose Steamer* in steam cleaning mode.

OPERATING THE *MULTI-PURPOSE STEAMER* STEAM CLEANING

·Make sure desired cleaning accessories (Jet Nozzle, Utility Brush, Utility Head with Squeegee) are properly connected.

·For general cleaning convenience, Extension Pole should be removed so that unit functions as a handheld steam cleaner. However, Pole may be attached for cleaning hard-to-reach spots, such as floor grout or ceilings. BE CAREFUL TO SUPPORT POLE WITH TWO HANDS WHEN LIFTING.

·Direct Jet Nozzle towards surface you wish to steam. Use a slight back-and-forth motion over area to enhance the cleaning process. To sanitize surfaces, set Steam Control Dial to HIGH and hold Jet Nozzle approximately 1/2 inch from surface for at least 5 seconds. This will most effectively kill germs and bacteria.

·When using Squeegee, start by thoroughly steaming entire window or mirror, then turn steam off. Next, press Squeegee to top of window or mirror, and pull slowly downward. Move slowly from one side of the surface to the other in this fashion until entire surface is clean.

·Wipe steamed areas with a clean cloth to remove loosened dirt and grime. Wiping the area while it is still wet is recommended, but use caution when wiping surfaces such as metal that may still be hot.

FABRIC STEAMING

·Make sure desired steaming accessories (Utility Head with Small Cloth) are properly connected.

-For fabrics and linens, direct Utility Head towards material you wish to steam, and keep the flow of steam focused there. Using a slight back-and-forth motion over the area you are steaming will further enhance the steaming process.

-For garments:

-Hang garment from a clean, rust-free hanger.

-Direct Utility Head towards bottom of garment. Steam will rise along inside and outside of material, removing wrinkles. Slowly slide Utility Head upward from bottom to top of garment.

-Direct Utility Head away from garment and smooth material with your free hand.

-Repeat as necessary until garment is fresh and wrinkle-free.

-General steaming tips:

-Curtains and draperies can be steamed while still hanging.

-To remove wrinkles from towels, handkerchiefs and napkins, drape them over a rod or towel rack and gently steam them.

-Heavier fabrics may require repeated steaming to achieve desired results.

-To remove exceptionally stubborn wrinkles, steam both sides of fabric.

-Be especially careful when steaming delicate fabrics and those likely to be damaged by water spotting.

SELECTING STEAM SETTINGS

Below is a general listing of just some of the possible uses for the *Multi-Purpose Steamer*, separated by intensity setting of Steam Control Dial. These are only meant to provide some general guidelines for using your steamer; you will likely discover a wide variety of other uses around your home.

NOTE: When steaming, it is best to use the lowest possible Steam Control Dial setting that completes the task while remaining easy and convenient. Start with lower settings and increase only if needed to quickly and easily accomplish the required cleaning task.

Higher steam setting increase the amount of moisture being emitted with the steam.

GENERAL STEAMING TIPS

You will find nearly limitless uses for your *Multi-Purpose Steamer*. There are no rule when it comes to steam cleaning and / or the attachments you received with your unit. Use whichever attachment seems to accomplish the intended job quickly and easily. Below are a few guidelines for starting out:

·Many surfaces only require to be sprayed with the Jet Nozzle to clean and disinfect them, then wiped with a clean dry cloth, towel, or paper towel.

EX: kitchen counters, microwaves, stove tops, bathroom sinks, kitchen and bath fixtures

·The nylon Utility Brushes can be used on most surfaces for hard-to-remove dirt, grime spots or stains.

EX: backed on food on ovens and oven doors, backed on stovetop spills, bath and / or kitchen grease and grime, rubber seal on the refrigerator, under / around bath and kitchen fixtures, bath tile seams, grouting



·The nylon Utility Brushes are also very effective in removing spots and stains and stains from clothing and upholstery. This can be done with steam alone or with a stain remover designed for your specific use. DO NOT put any type of chemical or liquid product in your steamer; only water is to be used in the unit.

·The Mop Head with Microfiber Cloth is designed primarily for use on floors, including linoleum, tile, marble, stone and more. However, it can also be used on upholstery, depending on the type of fabric being cleaned.

·When dried, some stains (whether on carpet or other surfaces) may require a bit of extra scrubbing with one of the Utility Brushes and / or a product designed for stain removal. It is helpful on carpet and cloth surfaces to blot with a clean dry towel to help removal. It is helpful on carpet and cloth surfaces to blot with a clean dry towel to help remove the spot / stain.

Technical Specifications

Model Number	SM-518
voltage	220-240V AC
Wattage	1500W
Water capacity	330mL
Heating time	30s
Working time	≥15mins
Unit weight	3.5kg

Product support 6



Product support

Help is always at hand

TROUBLESHOOTING

Please check the following details before you have your appliance repaired by an authorised servicing agent.

PROBLEM	POSSIBLE CAUSE	SOLUTION
Unit fails to heat up. Power Indicator Light does not illuminate	Unit is not plugged in.	Plug electrical cord into outlet.
	Household circuit breaker / ground fault interrupter has tripped or blown a fuse.	Reset circuit breaker / ground fault interrupter, or replace fuse. If you need assistance, contact a licensed electrician.
Unit heats up, but fails to steam. Power Indicator Light does illuminate. (NOTE: Always allow proper time for unit to heat up begin producing steam.)	Water Tank is empty.	Refill Water Tank using procedures on Page 21 of this manual.
	Mineral build-up in unit.	Refer to Removing Mineral Build-up section on Page 15 of this manual for removal procedure.
	Weighted brass ball connected to end of water tube inside Water Tank may have come loose.	If brass ball has become disconnected from tube, simply reattach it by snapping it back onto black nozzle at end of tube.
Steam output is weak or intermittent.	Steam Control Dial is set to LOW.	Increasing the setting of the Steam Control Dial to MEDIUM or HIGH will result in a stronger (and wetter) flow of steam.
	Mineral building-up in unit.	Refer to Removing Mineral Building-Up section on Page 15 of this manual for removal procedure.
Unit is emitting water in the steam flow.	Steam Control Dial is set to HIGH.	At the HIGH setting, small amounts of water may be released along with the steam. Decreasing the setting of the Steam Control Dial to MEDIUM or LOW will reduce this water spotting.
Rattling sound is heard coming from Water Tank.	Sound is being caused by weighted brass ball connected to end of water tube inside Tank.	The weighted brass ball is an intentional design that helps the unit more efficiently utilize all water inside of Tank.

If you require any technical guidance or find that your product is not operating as intended, a simple solution can often be found in the **Troubleshooting** section of these instructions.

Product support

Help is always at hand

Help and assistance

If you require any technical guidance or find that your wash vacuum cleaner is not operating as intended, a simple solution can often be found in the **Troubleshooting** section of these instructions or online at

www.argos-support.co.uk

If you still require further assistance, call one of our experts on **0345 604 0105**. To help give us give you a fast and efficient service please have the following information ready:

Model Ref.

You can find these on the rating plate - a small information panel (usually a sticker or metal plate) on the rear of your appliance

Serial number

Date of purchase

This will be shown on your receipt

Local call rates applies*

Lines open 8am-7pm Monday to Saturday and 10am-4pm Sunday.

*Calls to Argos enquiry lines may attract a charge and set up fee from residential lines depending on your call plan/tarif. Mobile and other providers costs may vary, see www.bt.com/pricing for details.

For Security and training purposes, telephone calls to and from customer service centres maybe recorded and monitored. Calls from Republic of Ireland will attract international call charges.

Product support

Help is always at hand



This appliance complies with the following CE directives:
2014/35/EU low voltage directive
2014/30/EU the EMC directive
2011/65/EU the ROHS directive

This is a class I appliance.

Notes on disposal:



This marking indicates that this product should not be disposed with other household wastes throughout the EU. To prevent possible harm to the environment or human health from uncontrolled waste disposal, recycle it responsibly to promote the sustainable reuse of material resources. To return your used device, please use the collection systems or contact the retailer where the product was purchased. They return and can take this product for environmental safe recycling.

If you require any technical guidance or find that your product is not operating as intended, a simple solution can often be found in the **Troubleshooting** section of these instructions.

Product support

Help is always at hand

BUSH

Call us now and activate your 12 month guarantee

Thank you for choosing Bush. Your new product is guaranteed against faults and breakdowns for 12 months. Don't forget to register it with us today so we can provide you with our best possible after-sales service and useful updates.

www.bushregistration.co.uk

FREEPHONE*

0800 597 8548

Lines are open 8am - 8pm, 365 days a year. *Calls may be recorded and monitored.

Your Bush Guarantee

This product is guaranteed for twelve months from the date of original purchase. Any defect that arises due to faulty materials or workmanship will be repaired free of charge (or if applicable the product will be replaced or the purchase price refunded) where possible during this period by the dealer from who your purchased the unit.

The guarantee is subject to the following provisions:

- The guarantee does not cover accidental damage, misuse, cabinet parts, knobs or consumable items.
- The product must be correctly installed and operated in accordance with the instructions contained in the manual.
- It must be used solely for domestic purposes. The guarantee will be rendered invalid if the product is re-sold or has been damaged by inexpert repair.
- Specifications are subject to change without notice.
- Bush disclaim any liability for loss or damage arising from the breakdown of the product.
- This guarantee is in addition to and does not diminish your statutory or legal rights.

Important Data Protection Information

If you provide us with information about another person, you confirm that they have appointed you to act for them, to consent to the processing of their personal data including sensitive personal data and that you have informed them of our identity and the purposes (as set out in the Important Data Privacy notice displayed overleaf) for which their personal data will be processed.

You are entitled to ask for a copy of the information we hold about you (for which we may charge a small fee) and to have any inaccuracies in your information corrected.

For quality control and training purposes, we may monitor or record your communications with us.

If your personal details change, if you change your mind about any of your marketing preferences or if you have any queries about how we use your information, please let us know by contacting our Data Protection Officer, Domestic & General, Leicester House 17 Leicester Street, Bedworth, Warwickshire CV12 8JP.

Guarantor: Argos Limited - 489 - 499 Avelbury Blvd - Milton Keynes - MK9 2NW

or online at www.argos-support.co.uk if you still require further assistance, call one of our experts on 0345 604 0105 .

BUSH

Contact:

www.argos-support.co.uk

Helpline: 0345 604 0105