



Tefal[®]

EN



SNACK COLLECTION





SAFETY INSTRUCTIONS

IMPORTANT SAFEGUARDS

- This appliance is intended for indoor, domestic household use only.

It is not intended to be used in the following applications, and the guarantee will not apply for:

- staff kitchen areas in shops, offices and other working environments;
- farm houses;
- by clients in hotels, motels and other residential type environments;
- bed and breakfast type environments.

- This appliance is not intended for use by persons (including children) with reduced physical, sensory or mental capabilities, or lack of experience and knowledge, unless they have been given supervision or instruction concerning use of the appliance by an adult responsible for their safety.

Children should be supervised to ensure that they do not play with the appliance.

- This appliance can be used by children aged from 8 years and above and persons with reduced physical, sensory or mental capabilities or lack of experience and knowledge if they have been given supervision or instruction concerning use of the appliance in a safe way and understand the hazards involved. Children shall not play with the appliance. Cleaning and user maintenance shall not be made by children unless they are older than 8 and supervised. Keep the appliance and its cord out of reach of children less than 8 years.

2



-  Accessible surface temperatures can be high when the appliance is operating. Do not touch the hot surfaces of the appliance.
- This appliance is not intended to be operated by means of an external timer or separate remote-control system.
- If the power supply cord is damaged, it must be replaced by the manufacturer or its after sales service in order to avoid any danger.
- Wash the plates with a damp sponge. Use a cloth to clean the body of the appliance.

Do

- Before first use, remove all packaging materials, stickers and accessories from the inside and the outside of the appliance.
- CAUTION: the safety precautions, common to different versions depending on the accessories supplied with your appliance, are part of the appliance. Read them carefully before using your new appliance for the first time. Keep them in a place where you can find and refer to them later on.
- Always plug the appliance into an earthed socket.
- Any intervention other than normal cleaning and maintenance by the customer must be performed by an Approved Service Centre.
- Make sure that the electric power supply is compatible with the power rating and voltage indicated on the bottom of the appliance.
- Do not use an extension lead. If you accept liability for doing so, only use an extension lead which is in good condition, has a plug with an earth connection and is suited to the power rating of the appliance.
- Position the power cord carefully, whether an extension is used or not, so that guests can move freely around the table without tripping over it.
- Cooking fumes may be dangerous for animals which have a particularly sensitive respiratory system, such as birds. We advise bird owners to keep them away from the cooking area.
- If the appliance is used in the centre of the table, keep it out of the reach of children.
- If an accident occurs, rinse the burn immediately with cold water and call a doctor if necessary.
- Fully unwind the power cord before plugging in the appliance.

Do not

- Never leave the appliance plugged in when not in use.
- Never run the appliance empty.
- Do not heat the appliance in a vertical position.
- Never leave the appliance unattended when in use.
- To prevent the appliance from overheating, do not place it in a corner or below a wall cupboard.
- Never place the appliance directly on a fragile surface (glass table, tablecloth, varnished furniture, etc.) or on a soft surface such as a tea-towel.



- Never place the appliance on or near hot or slippery surfaces; the power cord must never be close to or in contact with hot parts of the appliance, close to a source of heat or resting on sharp edges.
- Do not place cooking utensils on the cooking surfaces of the appliance.
- To preserve the cooking surface do not use metallic utensils.
- Never cut food directly on the plates.
- Do not use metal scourers or scouring powders to avoid damaging the cooking surface (non-stick coating).
- Never immerse the appliance, power cord or plug in water or any other liquid. They are not dishwasher safe.
- To avoid spoiling your appliance, do not use flambé recipes in connection with it at any time.
- Do not use aluminium foil or other objects between the plate and the food being cooked. Do not cook food in aluminium foil.

Removable plates:

- To prevent damage to the plates, only use them on the appliance for which they were designed (e.g., do not place in an oven, on the gas ring or electric hot-plate, etc.).
- Check that both faces of the plate are cleaned before use. Never turn the plate over during use.
- Plates should not be handled while they are hot.
- Do not place the hot plate on a fragile surface or under water.
- The heating coil is not to be cleaned. If it is really dirty, wait until it has cooled down and wipe with a dry cloth.

Advice/information

- Thank you for buying this appliance, which is intended for domestic use only.
- For your safety, this appliance conforms to applicable standards and regulations (Low Voltage Directive, Electromagnetic Compatibility, Environment, Materials in contact with food...).
- On first use, there may be a slight odour and a little smoke during the first few minutes.
- Our company has an ongoing policy of research and development and may modify these products without prior notice.
- Any solid or liquid foods that come into contact with parts marked with the symbol  are unfit for consumption.
- Only use accessories supplied with the appliance or acquired from an approved service centre.
- Before disposing of your appliance, the timer battery must be removed and disposed of in a dedicated waste collection centre or service centre (depending on model).

Environment



Environment protection first!

- ① Your appliance contains valuable materials which can be recovered or recycled.
- ② Leave it at a local civic waste collection point.





EN

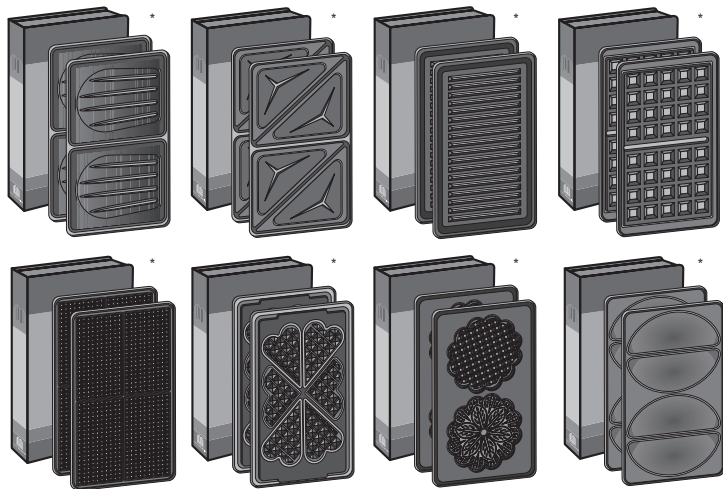
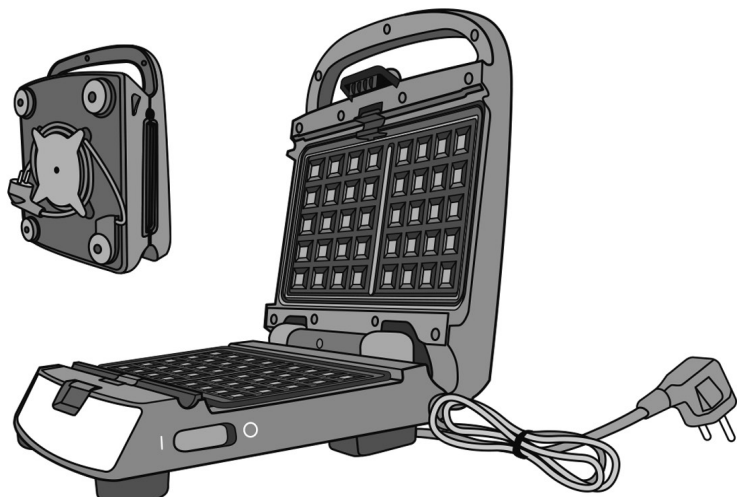

5



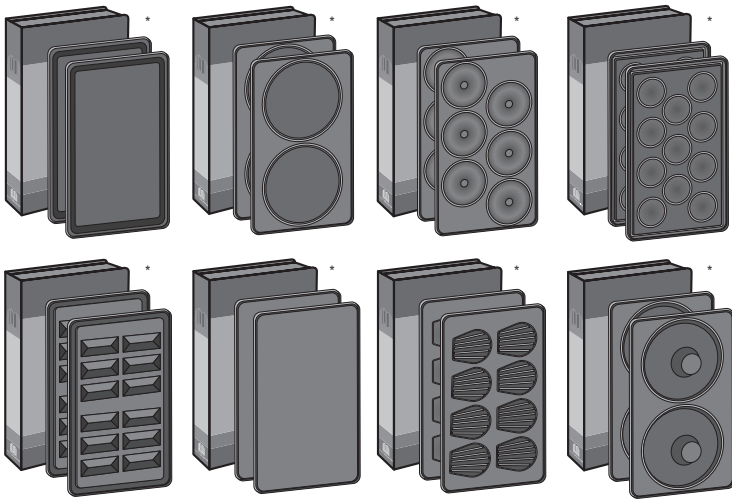

* Depending on the model and/or availability in store or online.





A



1

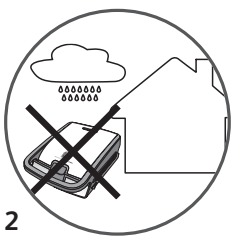

2

EN

B

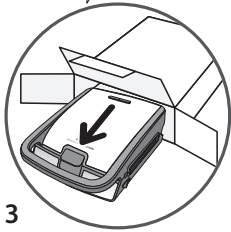
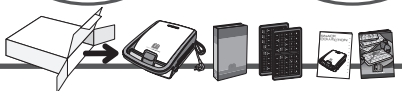

3

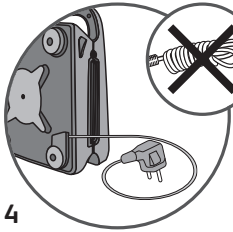

4

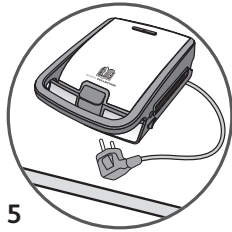

5

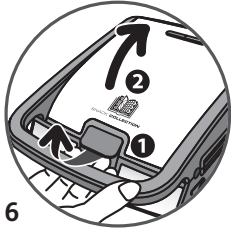

6

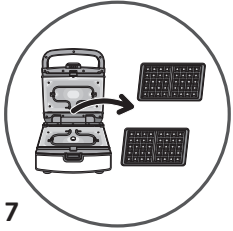

7

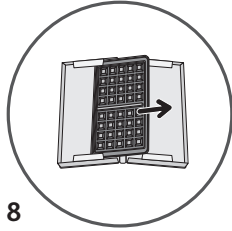

8

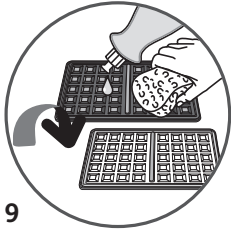

9

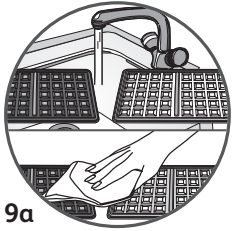

9a

7





C

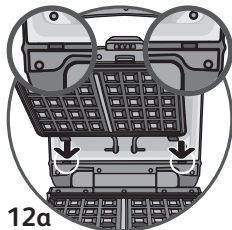
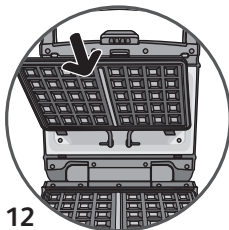
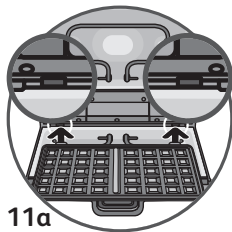
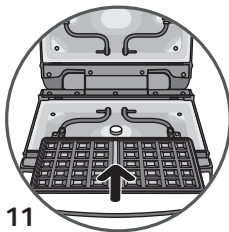
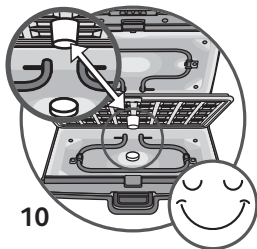



EN



13 CLICK

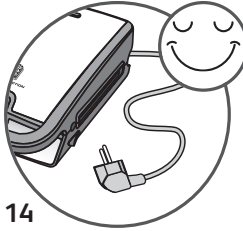

14

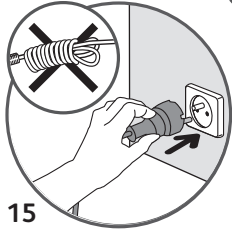

15



16

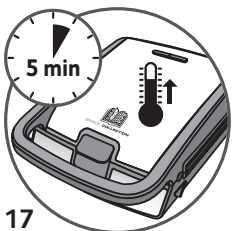

17



18



19

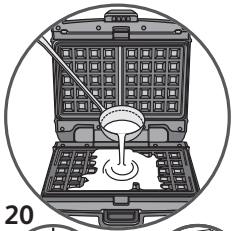

20

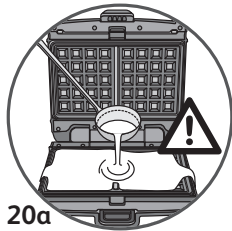

20a



21

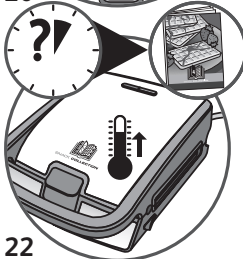

22

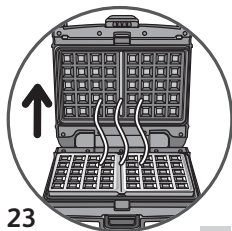

23

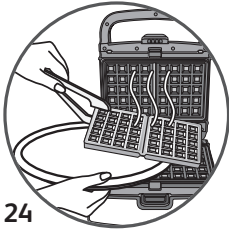

24

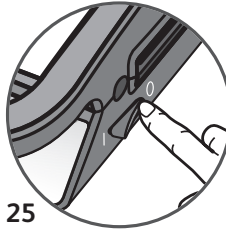

25

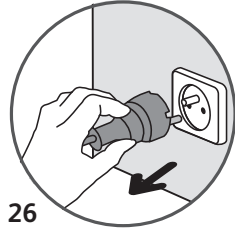

26

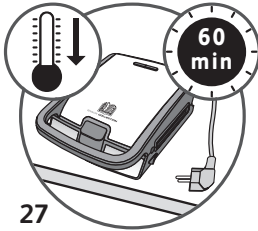

27



E

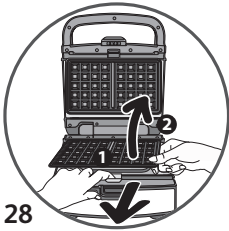

28

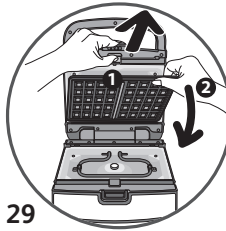

29

10





F



30

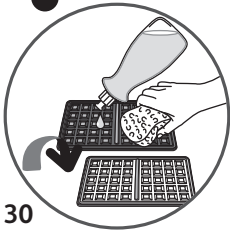

31

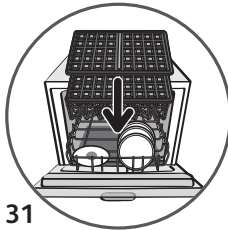

32

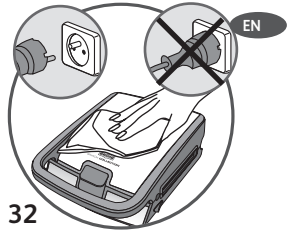

33

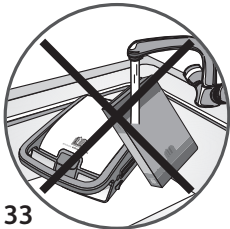

34



G



35

CLICK

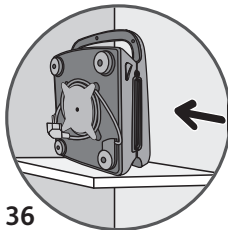

36

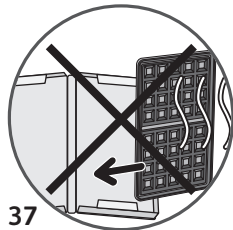

37

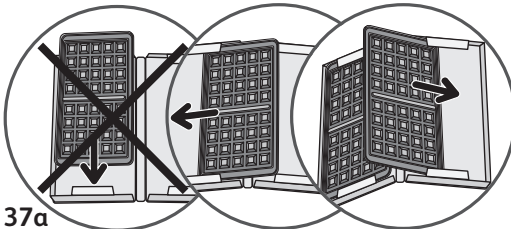

37a

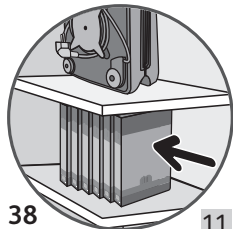

38

11



TEFAL/T-FAL SDA INTERNATIONAL GUARANTEE COUNTRY LIST
www.tefal.com

			
ARGENTINA	0800-122-2732	SUOMI FINLAND	09 622 94 20
ՀԱՅԱՍՏԱՆ ARMENIA	010 55-76-07	FRANCE Continentale + Guadeloupe, Martinique, Réunion, St-Martin	09 74 50 47 74
AUSTRALIA	1300307824	DEUTSCHLAND GERMANY	0212 387 400
ÖSTERREICH AUSTRIA	01 890 3476	ELLADA GREECE	2106371251
البحرين BAHRAIN	17716666	香港 HONG KONG	8130 8998
БЕЛАРУСЬ BELARUS	017 2239290	MAGYARORSZÁG HUNGARY	06 1 801 8434
BELGIQUE BELGIE BELGIUM	070 23 31 59	INDIA	1860-200-1232
BOSNA I HERCEGOVINA	Info-linija za potrošače	INDONESIA	+62 21 5793 7007
BRASIL BRAZIL	11 2915-4400	ITALIA ITALY	1 99 207 354
БЪЛГАРИЯ BULGARIA	0700 10 330	日本 JAPAN	0570-077772
CANADA	1-800-418-3325	الأردن JORDAN	5665505
CHILE	02 2 884 46 06	ҚАЗАҚСТАН KAZAKHSTAN	727 378 39 39
COLOMBIA	018000520022	한국어 KOREA	1588-1588
HRVATSKA CROATIA	01 30 15 294	الكويت KUWAIT	1807777 Ext :2104
ČESKÁ REPUBLIKA	731 010 111	LATVJA LATVIA	6 616 3403
DANMARK DENMARK	44 66 31 55	لبنان LEBANON	4414727
مصر EGYPT	16622	LIETUVA LITHUANIA	5 214 0057

			
EESTI ESTONIA	668 1286	LUXEMBOURG	0032 70 23 31 59
МАКЕДОНИЈА MACEDONIA	(02) 20 50 319	SRBIJA SERBIA	060 0 732 000
MALAYSIA	603 7802 3000	SINGAPORE	6550 8900
MEXICO	(01800) 112 8325	SLOVENSKO SLOVAKIA	232 199 930
MOLDOVA	22 929249	SLOVENIJA SLOVENIA	02 234 94 90
NEDERLAND The Netherlands	0318 58 24 24	SOUTH AFRICA	www.tefal.co.za
NEW ZEALAND	0800 700 711	ESPAÑA SPAIN	902 31 24 00
NORGE NORWAY	815 09 567	SVERIGE SWEDEN	08 594 213 30
عمان سلطنة OMAN	24703471	SUISSE SCHWEIZ SWITZERLAND	044 837 18 40
POLSKA POLAND	801 300 420 koszt jak za połączenie lokalne	ประเทศไทย THAILAND	02 769 7477
PORTUGAL	808 284 735	TÜRKIYE TURKEY	444 40 50
قطر QATAR	44485555	المتحدة العربية الامارات UAE	8002272
REPUBLIC OF IRELAND	01 677 4003	Україна UKRAINE	044 300 13 04
ROMANIA	0 21 316 87 84	UNITED KINGDOM	0345 602 1454
РОССИЯ RUSSIA	495 213 32 30	U.S.A.	800-395-8325
السعودية العربية المملكة SAUDI ARABIA	920023701	VENEZUELA	0800-7268724
		www.tefal.com	12/08/2016



TEFAL/T-FAL INTERNATIONAL GUARANTEE

Date of purchase / Date d'achat / Fecha de compra / Købsdato / Ostopäivä / Kjøpsdato /
Inkøpsdatum / Ostukuupäev / Pirkuma datums / Įsigijimo data / Data zakupu / Datum izročitve
blaga / Datum kupovine / Vásárlás dátuma / Data achiziției / Дата на закупуване / Дата продажы
/ ජූරැඳුණු ඉ. / Дата продажи / Сатылган күні / 購入日 / วันที่ซื้อ / 구입일자 / Датум на
купување :

Product reference / Référence produit / Referencia del producto / Referencenummer /
Tuotenumero / Artikelnummer / Produktreferens / Toote viitenumber / Produkta atsauces numurs
/ Gaminio numeris / Referenja produktu / Oznaka proizvoda / Tip aparata / Készülék típusa /
Cod produs / Модел / Модель / Умодел / Модель / Yürlüci / 製品リファレンス番号 / รุ่น
ผลิตภัณฑ์ / 제품명 / Податоци за производот:

Retailer name and address / Nom et adresse du revendeur / Nombre y dirección del minorista /
Forhandler navn & adresse / Jälleenmyyjän nimi ja osoite / Forhandler navn og adresse /
Återförsäljarens namn och adress / Müüja kauplus ja aadress / Veikala nosaukums un adrese /
Parduotuvės pavadinimas ir adresas / Nazwa i adres sprzedawcy / Naziv i adresa prodajnog mjesta
/ Naziv in naslov trgovine / Forgalmazó neve és címe / Numele și adresa vânzătorului / Търговки
обект / Назва та адреса продавця / Чыгушныц агауы мен мекен-жайы / 販売店名、住所 / ชื่อและที่อยู่ของ
ห้าง/ร้านที่ซื้อ / 소매점 이름과 주소 / Име и адреса на продавач :

Distributor stamp / Cachet / Sello del distribuidor / Forhandler stempel / Jälleenmyyjän leima /
Forhandler stempel / Återförsäljarens stämpel / Tempel / Zimogs / Antspaudas / Pieczęć
sprzedawcy / Pečat distributera / Pečat trgovine / Forgalmazó pecsétje / Ștampila vânzătorului /
Печат на търговския обект / Печатка продавця / Чыгуш. / Печать продавця / Сатушының
мөрі / 販売店印 / ตราประทับของห้าง/ร้านที่ซื้อ / 소매점 직인 / Печат на дистрибутер :







Ref. NC00138828

