

CUGGL BEECH PUSHCHAIR

IMPORTANT! KEEP THE INSTRUCTION FOR FURTHER REFERENCE

699/5346

cuggl 

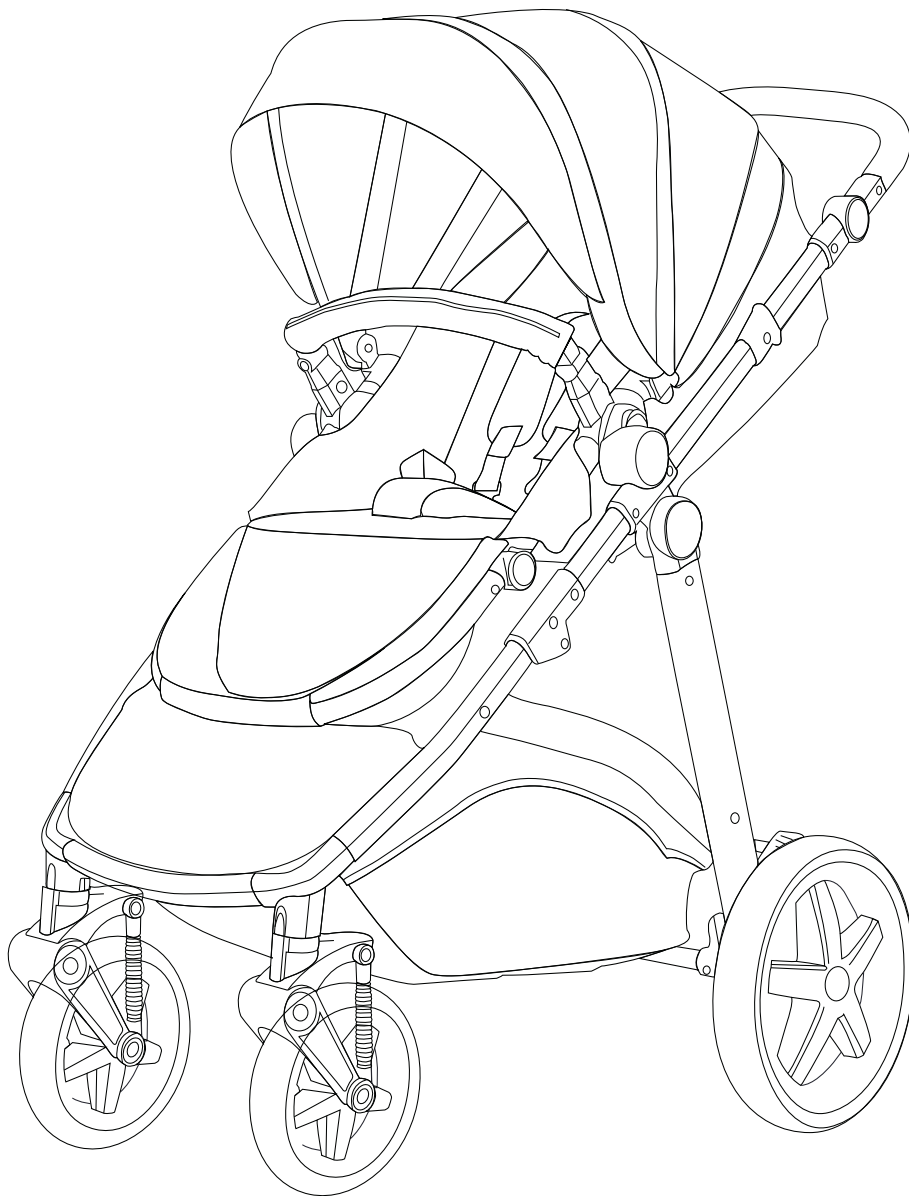

	33lbs
	15kg

Suitable from birth to 36 months.

Important-Please read the instruction fully before starting assembly

If you need help or have further question, call the Customer Helpline **03456 400 800**



Safety Information

Important-Please read the instruction before assembly and keep it for further reference

Thank you for choosing our product. Please always read all the instructions provided carefully before use and remember, your child's safety may be affected if you don't follow these instructions. The stroller is suitable for children under 36 months. The max load of the stroller is 15kgs. Never overload.

- **WARNING:** Do not use if any part is broken, torn or missing .
- **WARNING:** Never leave your child unattended.
- **WARNING:** Always use the restraint system.
- **WARNING:** It may be dangerous to leave your child unattended.
- **WARNING:** This seat unit is not suitable for children over 36 months.
- **WARNING:** Accessories which are not approved by the manufacturer shall not be used.
- **WARNING:** Avoid placing the stroller near naked heat sources such as electric bar fires, gas fires, etc. or where a child could gain access to any other kinds of hazards.
- **WARNING:** Always use the harness provided and make sure the harness is correctly fitted.
- **WARNING:** Ensure that all the locking devices are engaged before use.
- **WARNING:** The brake must be engaged when placing and removing the children.
- **WARNING:** This product is not suitable for running or skating.
- **WARNING:** To avoid injury ensure that your child is kept away when unfolding and folding this product.
- **WARNING:** Do not let your child play with this product.
- **WARNING:** Use the stroller for only one child at a time.
- **WARNING:** The maximum permissible loading for shopping basket is 5 kg.
- **WARNING:** For new born baby, please use the most reclined position as the baby does not have ability to control its head.
- **WARNING:** Only replacement parts supplied or recommended by the manufacturer/distributor shall be used
- **WARNING:** Any load attached to the handle and/or on the back of backrest and/or on the sides of the stroller will affect the stability of the stroller.

Components

If you need help or have further question,
call the Customer Helpline **03456 400 800**

Please check if you have all the parts listed below before starting assembly

CHECK THAT YOU HAVE ALL THE PARTS FOR THIS MODEL BEFORE ASSEMBLING THE PRAM.

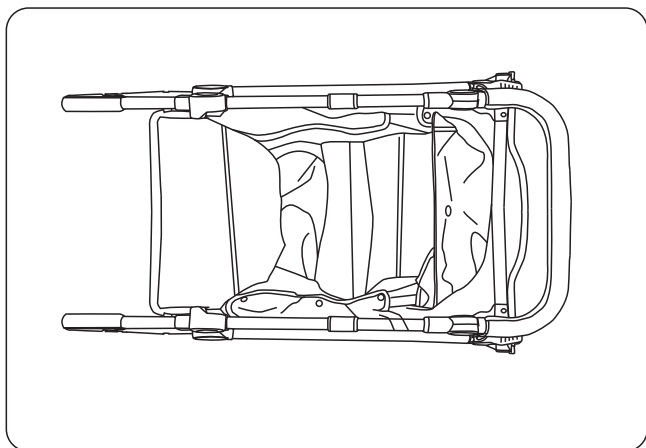

FRAME

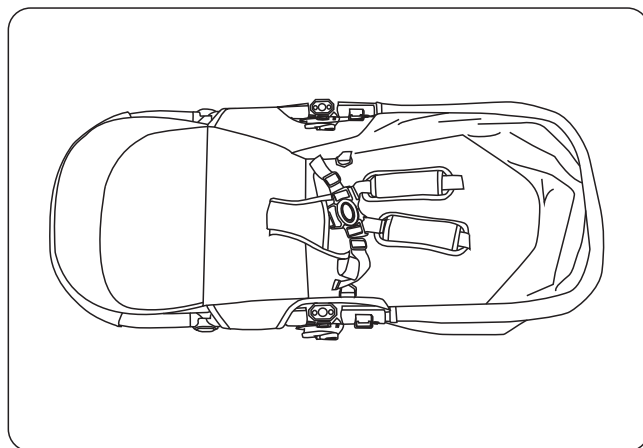

SEAT

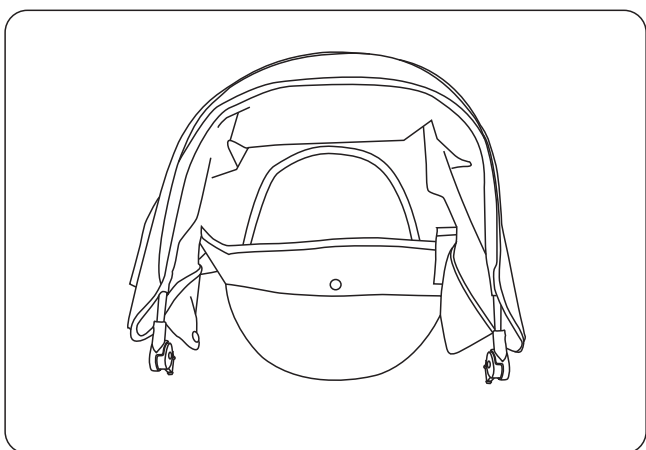

CANOPY

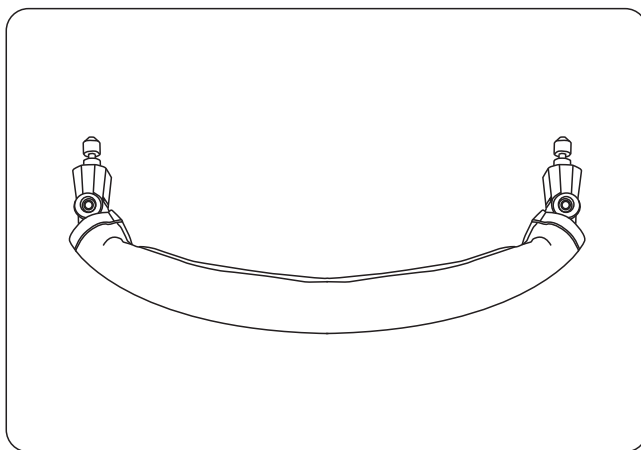

FRONT BUMPER

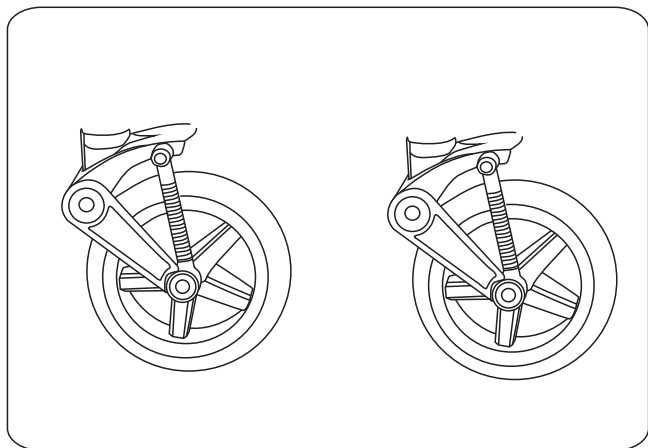

FRONT WHEELS

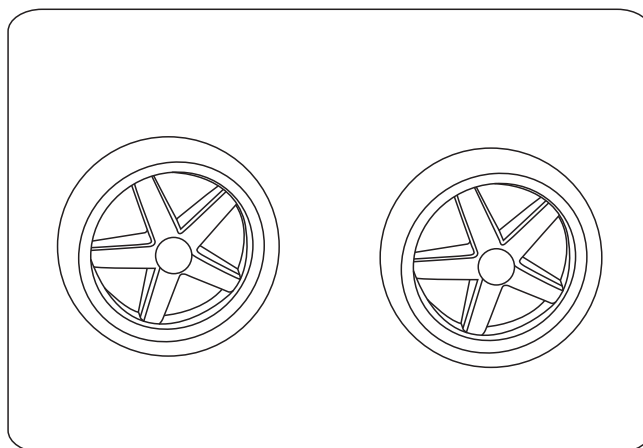

REAR WHEELS

Name of parts

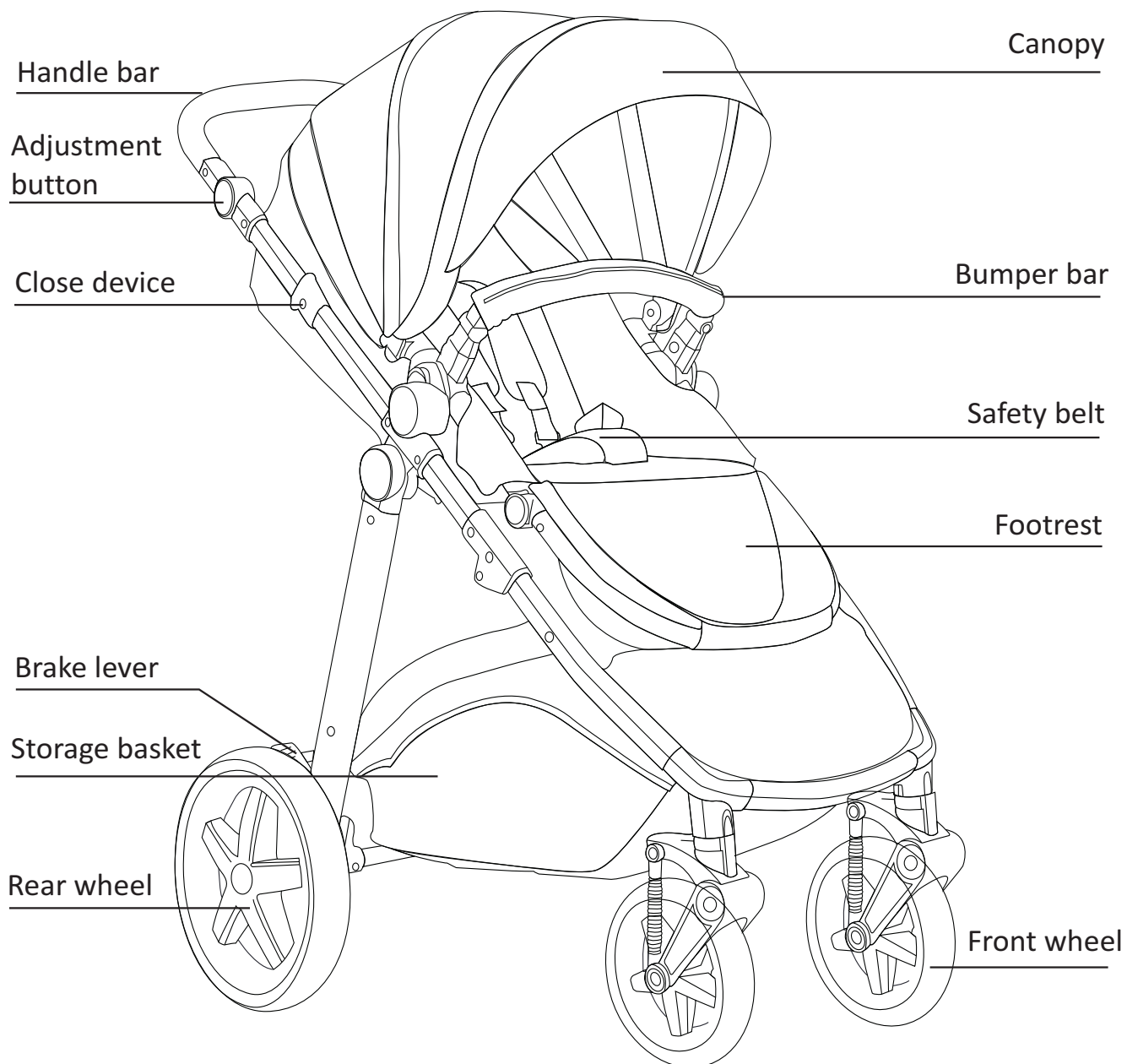

Assembly Instructions

Step 1

SET UP THE FRAME

Remove pram from box, unfold the pram frame first by stepping on the rear tube and pulling upward on the lock bar, then lean forward until the folding hinge is fully engaged. The folding mechanism will lock into place when the legs are fully extended.

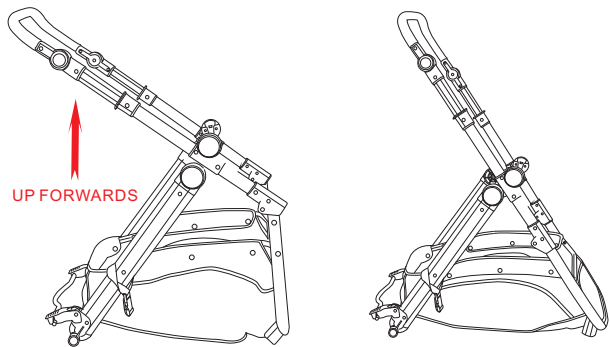

Step 2

FRONT WHEEL INSTALLATION

Lean the stroller backwards and push each front wheel assembly into the front wheel housing until they lock into place.

NOTE: Pull on the wheel assembly to ensure that it is securely attached to the pram.

To remove, push release button on the side of the wheel hub and pull wheel from hub.

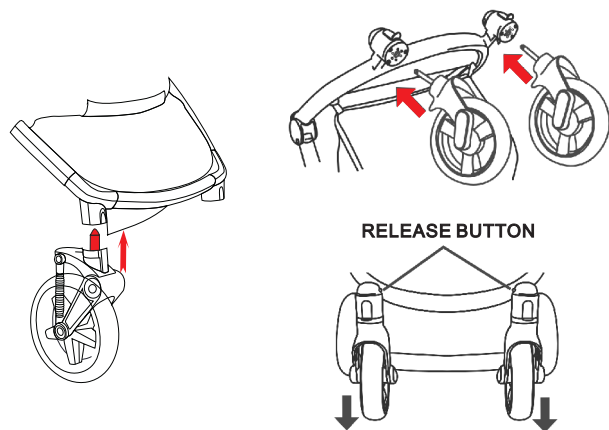

Step 3

REAR WHEEL INSTALLATION

Lean the stroller forward and press the rear wheel post into the rear frame hub until it clicks into place.

NOTE: Pull on the rear wheel to ensure that it is securely attached to the stroller.

To remove, push release button and pull wheel from hub.

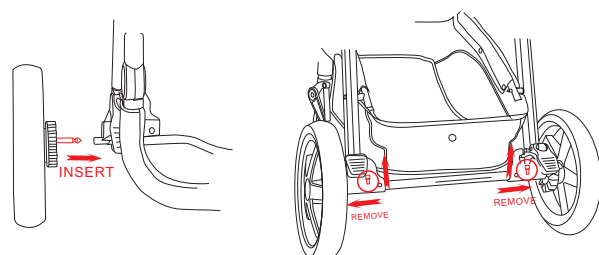

Assembly Instructions

Step 5

ATTACHING THE SEAT

Align the seat with the anchors on the side of the stroller frame and push them together until they click securely.

Attach the front bumper by aligning anchors with the slots on the seat. Push until it clicks into place.

Insert the canopy clips onto the slot located on each side of the seat.

Push forward on the front edge of the canopy while holding the rear of canopy in place.

The seat can face in either direction, forward or backward.

Note: The bumper must be securely attached before using this product.

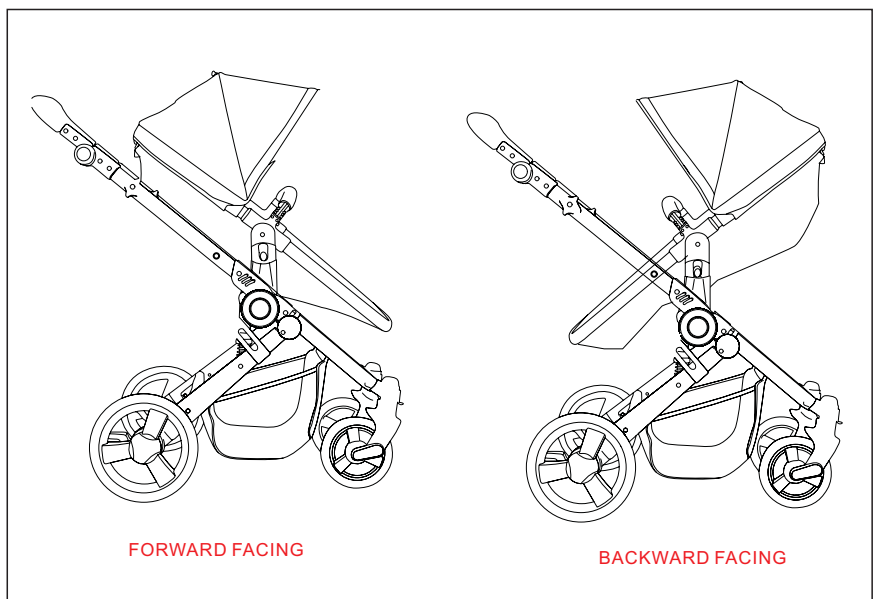
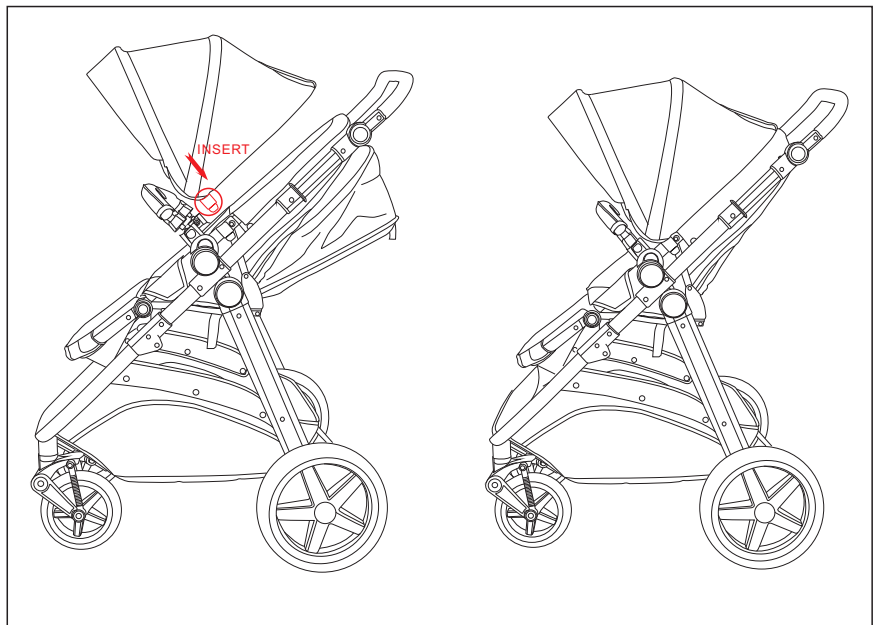
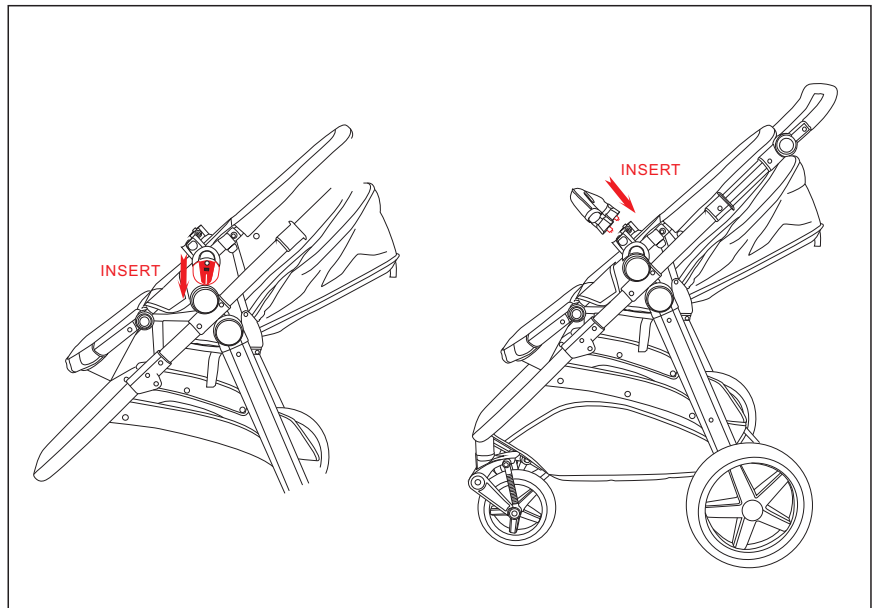

Assembly Instructions

Step 5

BACKREST ADJUSTMENT

The seat can be adjusted into upright, half-reclined and reclined positions.

Press the recline button on the rear of the seat and rotate the seat into the desired position.

Reclined position: Make sure both footrest and backrest are unlocked and extend the seat surround fully.

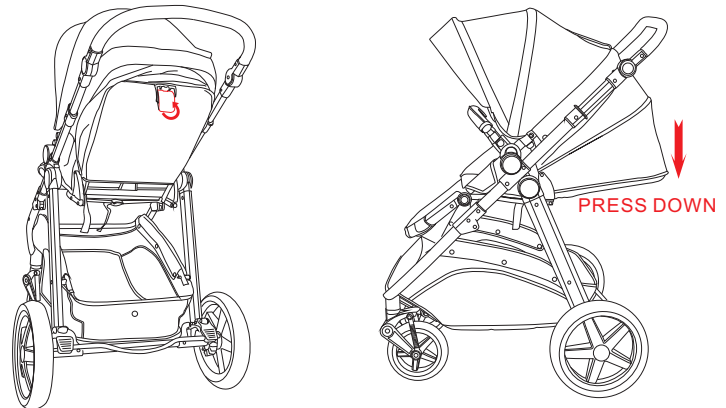

Step 6

FOOTREST ADJUSTMENT

Hands hold the foot pedal adjustment button, press the buttons on both sides of the footrest support to adjust up or down.

Adjust the foot pedal to the practical state.

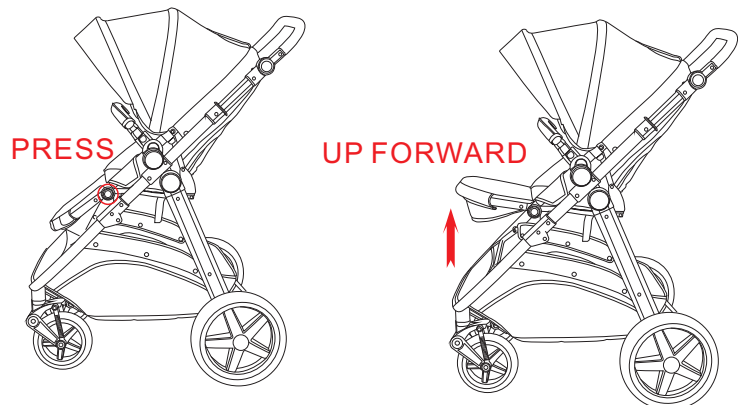

MULTI-POSITION HANDLE

To adjust the handle, press the release buttons to move it up or down into a comfortable position for the user.

Note: Make sure the handle clicks into place before using.

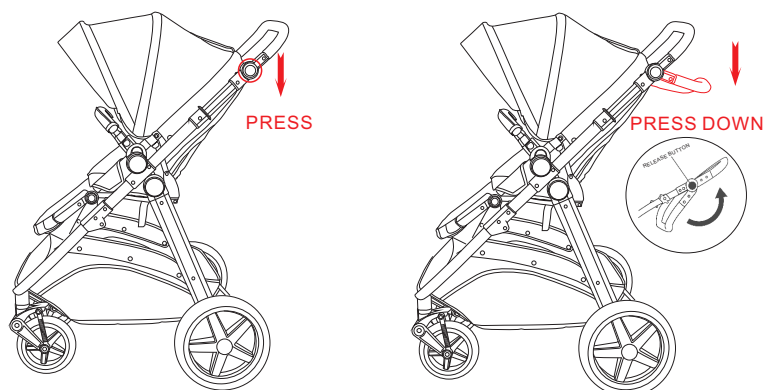

Assembly Instructions

Step 7

FRONT WHEEL LOCK

The front wheels are equipped with a swivel locking device. Push the button on each wheel down to fix the locks and push upward to disengage the locks.

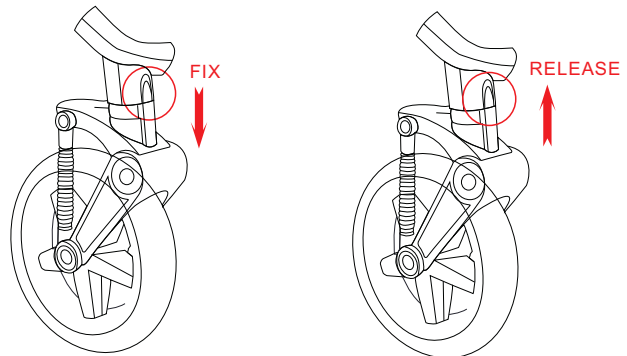

Step 8

BRAKE OPERATION

To engage brakes, apply downward pressure to the brake lever located on the rear axle. The pram might have to be rolled back and forth to fully engage the brake.

Check that the pram will not move once the brakes are properly applied.

To release, gently lift up on the brake lever.

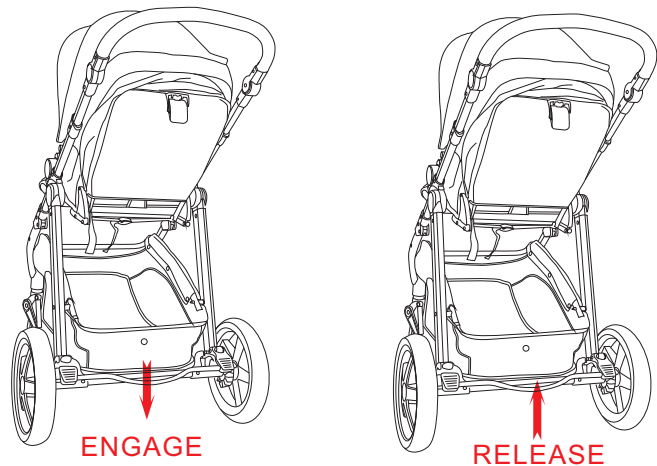

TO USE SAFETY HARNESS

Slide the shoulder strap buckle ① into the housing of the waist strap buckle ②.

Repeat for the other side. Insert the completed buckle ③ into the buckle housing ④ until it engages securely in place. Repeat for the opposite side.

To release buckle, press centre button on buckle housing ④.

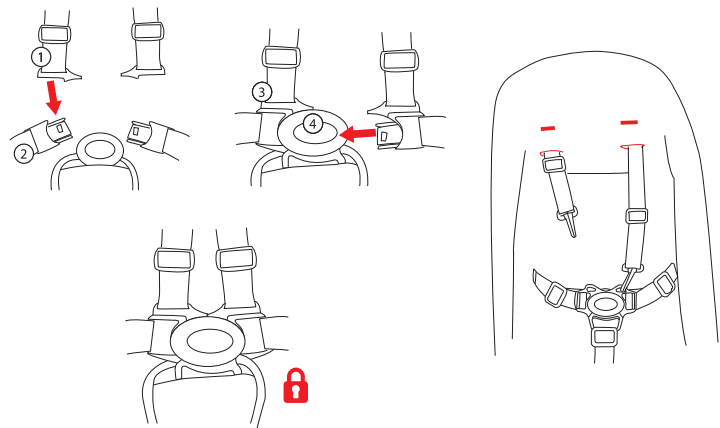

WARNING! Always use the harness and ensure it is correctly fitted securely while child is in the seat.

The shoulder straps of the 5-point harness have 2 attachment positions. Select the position that places the shoulder strap level with, or below the top of the child's shoulder.

To adjust harness height unhook the shoulder strap from the crotch buckle.

Feed the shoulder strap through the harness spread slots. You can access these slots from the rear of the seat underneath the fabric. Feed shoulder strap through the appropriate slot and reattach the shoulder strap to the crotch buckle.

TO FOLD PRAM

Push backwards on the front edge of canopy.

Then pull the stroller backward several inches to adjust the front wheels to the front.

Fold the stroller by pulling both release triggers and press handle toward the floor.

Make sure the front wheels lie flat, then secure the stroller in the folded position by locking the fold strap, located on the right side of the stroller through the rear frame.

Note: The stroller can not be folded in parent facing position.

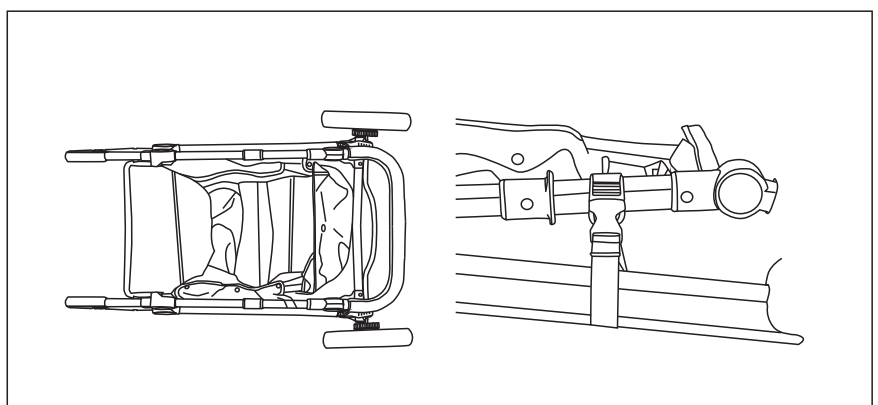
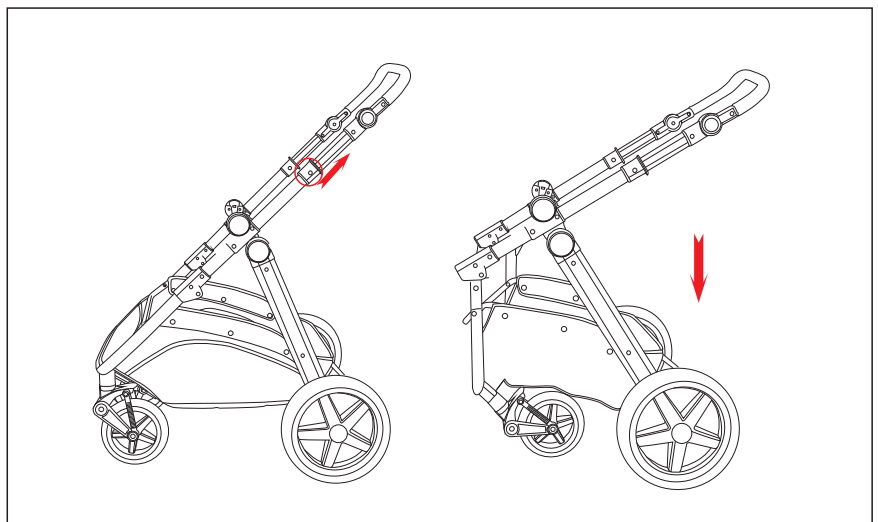
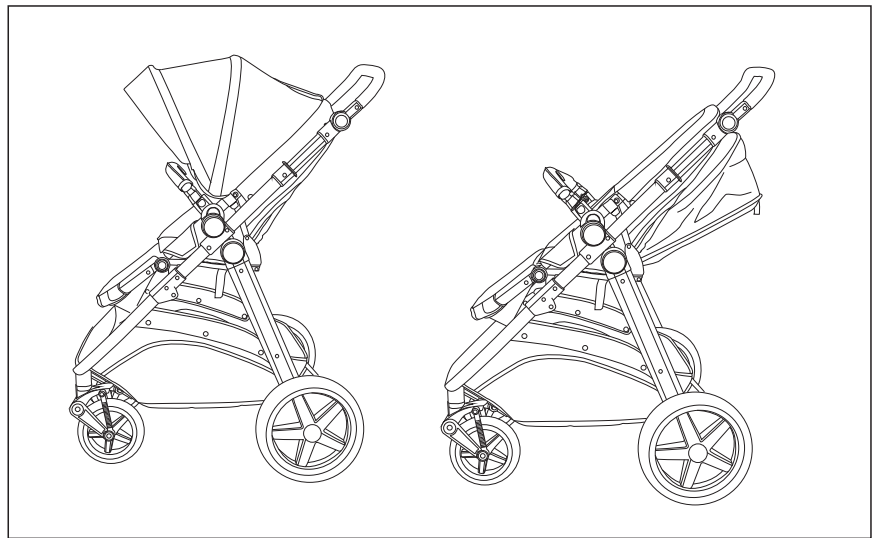

Care and Maintenance

General

This pushchair was designed and manufactured with qualified materials and craftsmanship. Always use the safety harness.

Always check your pushchair for bullet points. Lubricate moving parts regularly, especially the wheels, and lower parts of the chassis that tend to collect dirt.

Inspect regularly for:

- Worn parts, torn materials or stitching .
- Loose screws, bent or broken frame parts .
- Broken, damaged or missing parts.

Should any of the above be evident do not use and contact the Helpline:03456 400 800 for advice.

Care and Maintenance:

Fabric parts may be cleaned in accordance with the fabric care labels. Do not machine wash.

Seat: Sponge clean only

Canopy/Basket:Hand wash only.

Do not leave the stroller exposed to heat i.e. by a radiator or in direct sunlight.

If the stroller chassis parts have been exposed to salt water we recommend that they be rinsed down with fresh (tap) water as soon as possible afterwards.

Do not fold or store the product while wet and never store in a damp environment as this can cause mildew to form.

If you need help or have further question, call the Customer Helpline **03456 400 800**

This pushchair has been designed to comply with the EN1888:2012.

Country of origin: China

Argos LTD, 489-499 Avebury Boulevard, Central Milton Keynes, MK9 2NW