

BUSH

Instruction manual

Bush Bagged Cylinder Vacuum Cleaner PET

Model: VCB43C17M-60



You'll soon be enjoying your new Bush Bagged Cylinder vacuum cleaner PET.

It all begins here, with your instructions. Don't worry, there's nothing too technical coming up. Just simple, step-by-step guidance to get you up and running quickly. Sound good? Then let's get started.

Help and Guidance

We're here to help you get the most from your Bush Bagged Cylinder vacuum cleaner.

Should you require any guidance; call our Help line on 0345 604 0105.

Further contact details can be found online at: www.bush-support.co.uk

Contents

1	Safety information	
	Power source	6
	Ventilation heat and moisture	7
	Warning	8
	Plug / Wiring advice	9
2	Getting to know your vacuum cleaner	
	Accessories	12
	Part identification	13
3	Assembling your vacuum cleaner	
	Assembly	16
4	Using your vacuum	
	Hose	18
	Connecting tube and accessories	18
	Operating the appliance	19
	Nozzle use	19
	Using the Cleaning Accessories	20
	Storage	20
5	Care and maintenance	
	Disposable dust bags and filters	22
	Replacing the dust bag	22
	Cleaning and Replacing the Filters	23
	Care and Cleaning	23
	Other information	25
6	Product support	
	Troubleshooting	27
	Help and assistance	28
	Guarantee	29

If you require any technical guidance or find that your product is not operating as intended, a simple solution can often be found in the **Troubleshooting** section of these instructions

Safety information

1





Safety information

Important - Please read these instructions fully before assembling or operating

FOR HOUSEHOLD USE ONLY.

When using the vacuum cleaner, basic safety precautions should always be observed, including the following:

- Only use the vacuum cleaner indoors on dry surfaces. Do not handle the plug or vacuum cleaner with wet hands. Do not use outdoors or on wet surfaces.
- Turn off the vacuum cleaner controls before disconnecting or connecting from the mains supply.
- Always unplug the vacuum cleaner before connecting or disconnecting the vacuum hose and accessories.
- Children shall not play with the appliance.
- Cleaning and user maintenance shall not be made by children without supervision.
- This appliance can be used by children aged from 8 years and above and persons with reduced physical, sensory or mental capabilities or lack of experience and knowledge if they have been given supervision or instruction concerning use of the appliance in a safe way and understand the hazards involved.
- Only use as described in this manual. Only use recommended attachments.
- Do not use the vacuum cleaner if it has been dropped, damaged, left outdoors or dropped into water.
- Do not use the vacuum cleaner with a damaged cord or plug. If the supply cord is damaged, it must be replaced by a qualified technician in order to avoid hazard.



Safety information

Important - Please read these instructions fully before assembling or operating

- Do not pull or carry by cord. Do not use the cord as a handle, close a door on the cord or pull cord around sharp edges or corners. Do not run the vacuum cleaner over the cord. Keep the cord away from heated surfaces.
- Do not put any objects into openings. Do not use with any openings blocked and do not restrict air-flow. Keep all openings free of dust, lint, hair or anything that might reduce airflow.
- Keep hair, loose clothing, fingers and all parts of the body away from openings and moving parts.
- Do not pick up hot coals, cigarette butts, matches or any hot, smoking or burning objects.
- Do not pick up flammable or combustible materials (lighter fluid, petrol, kerosene etc.) or use in the presence of explosive liquids or vapours.
- Do not vacuum up harmful or toxic material (chlorine, bleach, ammonia, drain cleaner etc.).
- Do not vacuum up hard or sharp objects such as glass, nails, screws, coins, etc.
- Do not use without all of the filters in place.
- Take extra care when vacuuming on stairs.
- Keep vacuuming area well lit.
- Store the vacuum cleaner in a cool, dry area.
- Turn off the on/off switch before unplugging the vacuum cleaner.
- Only use CE-approved 13 amp extension cords.
Non-approved cords may overheat. Care should be taken to arrange the cord so that the cord cannot be tripped over.



Safety information

Important - Please read these instructions fully before assembling or operating

WARNING: Always switch off and unplug the vacuum cleaner from the electrical outlet before assembling, opening or emptying the dirt container, connecting/ disconnecting the attachments, or carrying out maintenance or troubleshooting checks.

CAUTION: The vacuum cleaner is a very powerful unit. Before plugging the cord into the electrical outlet, make sure the switch is in the 'off' position. Hold the vacuum cleaner firmly when starting and in use.

IMPORTANT: If the inlet, hose or extension tube is blocked, switch off the vacuum cleaner and remove the blockage(s) before re-starting the vacuum cleaner.

IMPORTANT: We recommend that filters should be checked and cleaned periodically. For washable filters, ensure they are completely dry before inserting back into the vacuum cleaner. Do not wash with detergents. Only use warm water, max 40°C.

PLEASE KEEP INSTRUCTIONS
FOR FURTHER USE



Safety information

Important - Please read these instructions fully before assembling or operating

Plug / Wiring advice

The wires in this mains lead are coloured in accordance with the following UK electrical code:

BLUE = NEUTRAL

BROWN = LIVE

Non-rewireable plug

This appliance may be fitted with a "non-rewireable" plug. If you need to change the fuse in a "non-rewireable" plug, the fuse cover must be refitted. If the fuse cover is lost or damaged, the appliance must not be used.

Rewireable plug

The colours of the wires in the mains lead of this appliance may not correspond with the coloured markings identifying the terminals in a rewireable plug. Rewireable plugs should only be replaced by a suitably competent person. If in doubt, consult a qualified electrician in order to avoid hazard.

Should the fuse need to be replaced, a 13 amp fuse approved to BS1363/A must be used

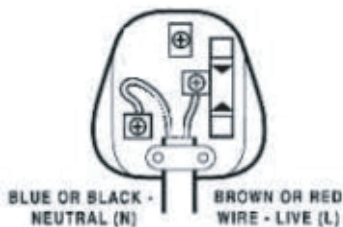

The BLUE wire must be connected to the terminal marked with the letter N

The BROWN wire must be connected to the terminal marked with the letter L

If you require any technical guidance or find that your product is not operating as intended, a simple solution can often be found in the **Troubleshooting** section of these instructions

Getting to know your vacuum cleaner

2



Getting to know your vacuum

You'll be up and running in no time

Ready? Let's begin...

Please read these instructions carefully. They contain important information which will help you get the best from your Vacuum cleaner and ensure safe and correct installation and operation.

If you require any further assistance, our technical experts are happy to help. For full details, refer to the product support section at the end of these instructions.

Accessories

One hose, one telescope tube, one floor brush, crevice tool, dusting brush.

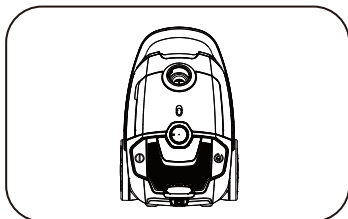

Vacuum cleaner

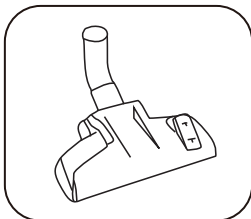

Floor head

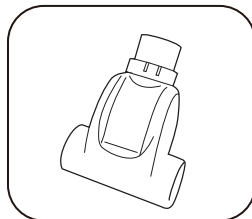

Small turbo brush

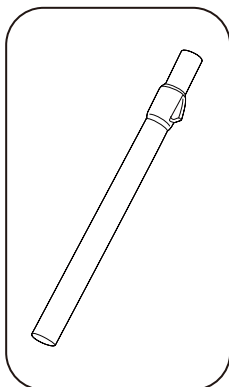

Extension tube

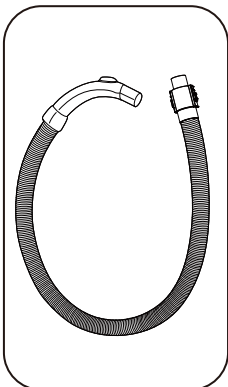

Flexible hose

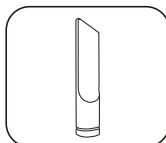

Crevice tool

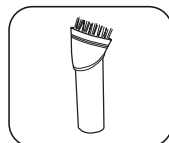

Dusting brush

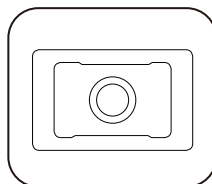

3X paper bags

If you require any technical guidance or find that your product is not operating as intended, a simple solution can often be found in the **Troubleshooting** section of these instructions

Getting to know your vacuum

You'll be up and running in no time

Part identification

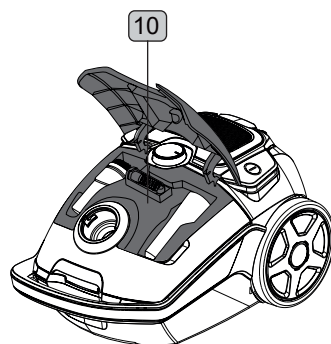
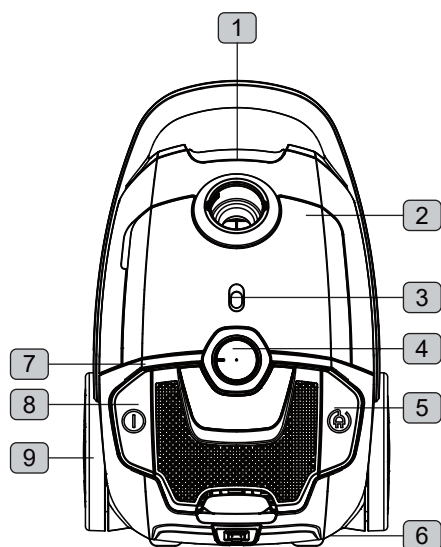

- 1 Lock clip
- 2 Front cover
- 3 Dust full indicator
- 4 Speed control button
- 5 Cord rewinding pedal

- 6 Power cord
- 7 Back cover
- 8 ON/OFF switch pedal
- 9 Big wheel
- 10 On board storage

If you require any technical guidance or find that your product is not operating as intended, a simple solution can often be found in the **Troubleshooting** section of these instructions

Assembling your vacuum cleaner

3



Assembling your vacuum

Bringing it all together

Assembly

1. Insert the flexible hose coupling into the hose socket and push to secure until you hear a click.
2. Fit the handle of the flexible hose into the extension tube. Insert the extension tube into the floor head (fig.1). The crevice nozzle can be attached to the curved handle or the extension tube.

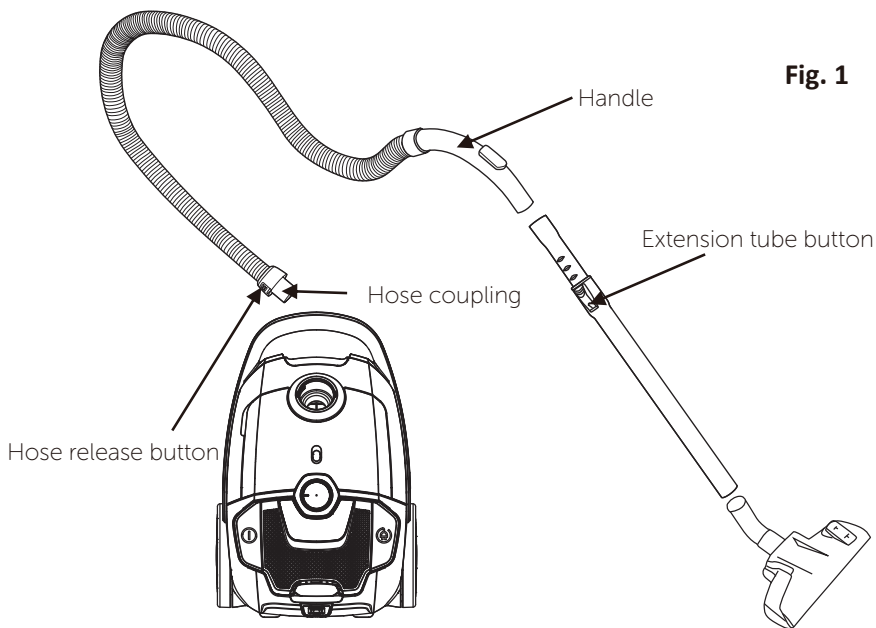

3. To adjust the length of the extension tube, press the extension tube button and pull out the inner tube to the required length.
4. To remove the extension tube and accessories firmly pull apart.
5. To disconnect the flexible hose from the body of the cleaner ensure that vacuum cleaner is switched off. Press the hose release button and pull apart.

Using your vacuum 4



Using your vacuum

Let's get started

Operating the appliance

1. Pull the power cord out of the appliance and insert the mains plug into the mains socket.

A YELLOW mark on the power cord indicates the ideal cable length. Do not extend the power cord beyond the RED mark.

Warning: To avoid over heating always extend to ideal cable length BEFORE use.

2. Press the power button on top of the appliance to switch on the appliance.

3. You can quickly reduce the suction power by pushing the air flow regulator on the hose handle. Push it forward, suction power will increase; push it backward, suction power will reduce.

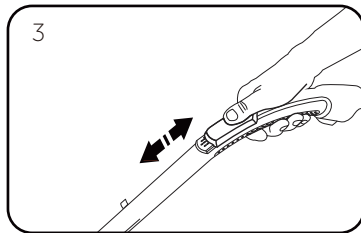
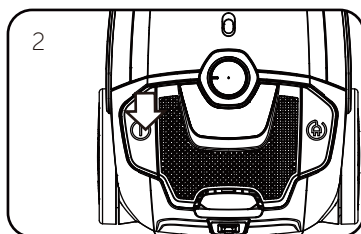
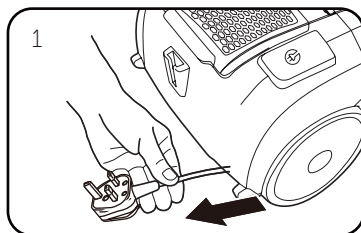

Using the Cleaning Accessories

Dual position carpet / floor brush (Drawings for reference only)

Position 1: Bristles extended
- For hard floors

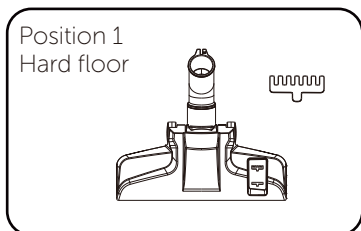

Position 2: Bristles retracted
- For carpets

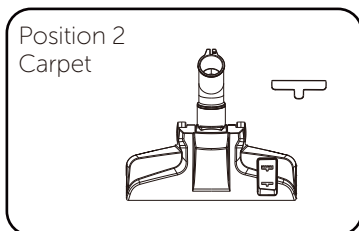

Using your vacuum

Let's get started

Combination tool (dusting brush and crevice tool)

For corners, edges or small spaces

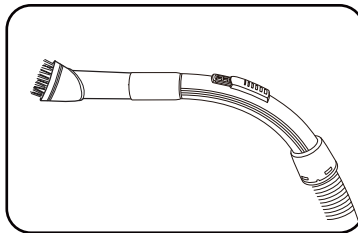
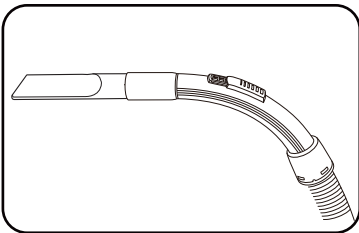

Nozzle use

Nozzle	Cleaning area							
	Floor & carpets	Furniture	Between cushions	Curtains	Stairs	Walls	Skirting edges	Radiators
Dusting brush	✓				✓			
Combination-crevice tool		✓	✓		✓		✓	✓

Storage

To store the vacuum cleaner tidily when not in use, slide the storage point on the floor head into the socket at the rear of the cleaner as shown.

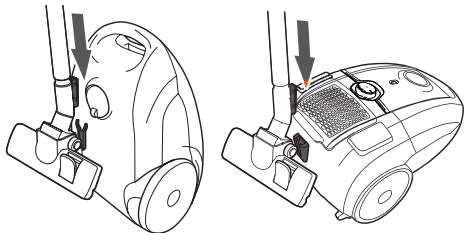

If you require any technical guidance or find that your product is not operating as intended, a simple solution can often be found in the **Troubleshooting** section of these instructions

Care and maintenance 5



Care and maintenance

Looking after your appliance

Disposable dust bags and filters

The dust bag and the motor filter play a very important roll in the efficiency of the vacuum cleaner. The purpose of the dust bag is to capture dirt, but at the same time the filter needs to be porous enough to allow air to pass through. If the bag or motor filter get clogged, no air can pass through the cleaner and no cleaning can take place regardless of how powerful the unit is. To keep the cleaner operating at maximum efficiency, change the dust bag frequently and clean the filter when needed. Some fine particles can restrict the air flow very quickly and will decrease the performance even before the bag appears to be full. For that reason, the bag and filter may need to be changed more often when vacuuming carpet fresheners or cleaners, powder, plaster dust or similar fine substances.

When the 'Dust Bag Full' indicator goes red the dust bag must be emptied to avoid damage to the cleaner.

Empty the dust bag at regular intervals to prevent clogging, which carries a risk of loss of suction power and poor cleaning performance.

Replacing the dust bag

Be sure to turn off and unplug the vacuum cleaner before replacing the dust bag or cleaning the filter. Never vacuum without the dust bag or filter in place.

1. Turn off and unplug the vacuum cleaner.
2. Remove the hose from the hose connection and open the dust bag compartment by pushing the handle upwards and lifting the lid.
3. Slide the dust bag out of the frame and remove the dust bag from the dust bag compartment.

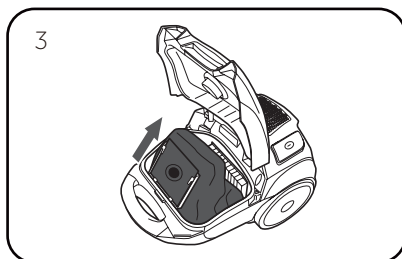
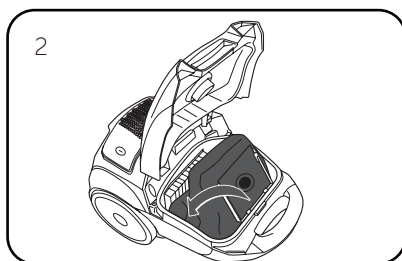

Care and maintenance

Looking after your appliance

4. Fit a new bag into the cavity. The edge marked with a black arrow fits into a slot in the base of the cavity.

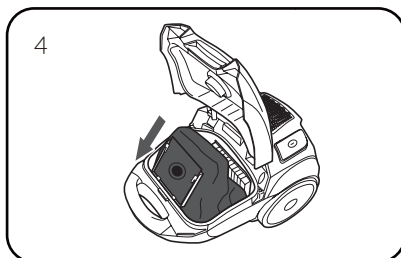

5. Close the lid.

Cleaning and Replacing Inlet Filter and Air Out Filter

1. The Inlet Filter is at the rear of the inside compartment. Open the lid and pull the filter out of its cradle. Wash the filter in cold running water until the water runs clear. Allow to air dry fully. Using a damp or wet filter will reduce the suction and damage the motor.

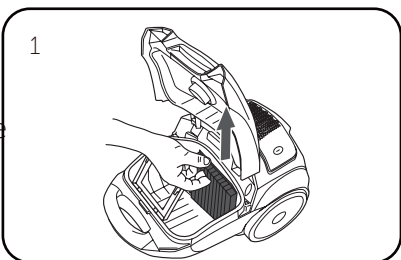

2. To clean or replace the air outlet (HEPA) filter, remove the filter cage(2-A), brush out the cavity in the rear of the cleaner(2-B), Wash and dry the filter in accordance with step 1 above.

It is recommended to remove debris once a week and rinse the filter under water once a month.

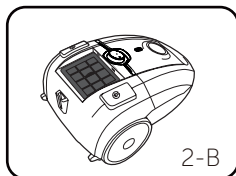
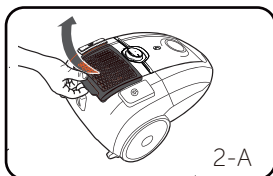

Care and Cleaning

Switch the cleaner off and unplug from the mains.

Empty the dust bag and clean the filters.

Wipe the cleaner body with a damp cloth and dry thoroughly. Do NOT allow water or liquids to penetrate the vacuum cleaner. This could be dangerous.

Store the cleaner safely out of the reach of children and pets.

How to maintain small turbo brush

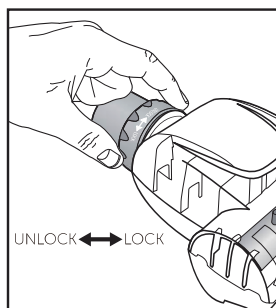

1. To release the turbo tool transparent cover for cleaning, twist the locking ring to the unlock position and remove it.

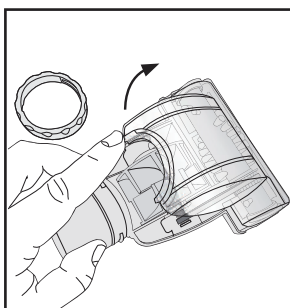

2. Pull cap up on the top of the pet tool as shown.

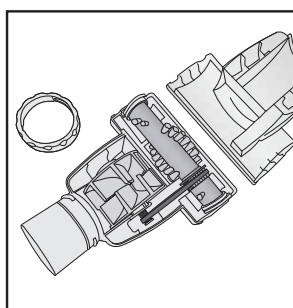

3. Remove plastic upper cap to clean, remove pet hair and debris.

- Do not clean the vacuum cleaner, components or accessories using petrol or any other flammable liquid or solvents, etc.
- Clean only the outside of the vacuum cleaner.
- Use only a moist cloth and mild detergent for cleaning the vacuum cleaner, components and accessories.
- After cleaning, wipe off the moisture on vacuum cleaner, components and accessories with a dry cloth.
- Do not place accessories, tools or components in a dishwasher.

Other information

Technical Specification

Model	VCB43C17M-60
SKU	145136072
Cat No	5797071
Rated voltage	220-240V 50-60Hz
Power	600W nominal
Class rating	II(double insulated)
BS 1362 fuse	13A
Capacity	3.0L
Noise	66 dB(A)



Recycling electrical products



You should now recycle your waste electrical goods and in doing so help the environment.

This symbol means an electrical product should not be disposed of with normal household waste. Please ensure it is taken to a suitable facility for disposal when finished with.

Visit www.recycle-more.co.uk, click on "bank locator" and enter your postcode to find your nearest recycling site.

Product support 6



Product support

Help is always at hand

TROUBLESHOOTING

In case of malfunction, please refer to the following table.

Problem	Possible reason	Solution
There is an accessory missing	<ul style="list-style-type: none">- A part(s) is missing from box	<ul style="list-style-type: none">- Check the 'PARTS' page of your instructions
The vacuum cleaner does not switch on	<ul style="list-style-type: none">- The unit is not plugged into a mains socket- The power button on the unit has not been depressed- The thermal motor cut out has been activated- There is no electricity to the power socket	<ul style="list-style-type: none">- Ensure the plug is firmly in the socket and switched on- Depress the power switch on the unit- If the unit has cut out during use, disconnect the unit from the wall socket, allow to cool for one hour, clean the filters, empty bin and check the hose/accessories for blockages- Seek expert help from a qualified electrician
The vacuum cleaner won't pick up	<ul style="list-style-type: none">- The accessories are not correctly fitted- There are blockages in the hose/ accessory- The dust bag is full- The filters are blocked/clogged	<ul style="list-style-type: none">- Check hose/tools are correctly attached to the machine/hose/tube; refer to 'ASSEMBLY/ OPERATION' section- Check the air paths of the hose/ accessory are not obstructed by blockages- Check dust bag and if necessary empty- Frequently cleaning filters will maintain performance; see 'MAINTENANCE' section
Dust is escaping from the vacuum cleaner	<ul style="list-style-type: none">- The filters/dust bag are not fitted correctly- The filters are damaged	<ul style="list-style-type: none">- See 'PARTS' and 'MAINTENANCE' sections- If the filters are damaged these will need to be replaced
Accessories won't pick up dust/debris	<ul style="list-style-type: none">- The wrong tool is fitted for the task- The tools are blocked- The filters are blocked- The dust bag is full- The hose/tubes are blocked	<ul style="list-style-type: none">- See 'PARTS' section- Check the air paths of the tools are not obstructed by blockages- Frequently cleaning filters will maintain performance; check 'MAINTENANCE' section- Check and empty the dust bag- Check the air paths of the hose/tubes are not obstructed by blockages
The blockage indicator (if applicable to model) activates	<ul style="list-style-type: none">- The filters/dust bag are blocked- The dust bag is full- The accessories/hose/tube are blocked	<ul style="list-style-type: none">- Frequently cleaning filters will maintain performance; check 'MAINTENANCE' section- Check and empty dust bag- Check the air paths of the accessories /hose/tubes are not obstructed by blockages

Or by calling one of our experts on **0345 604 0105**

Product support

Help is always at hand

Help and assistance

If you require any technical guidance or find that your Bush vacuum cleaner is not operating as intended, a simple solution can often be found in the **Troubleshooting** section of these instructions or online at www.bush-support.co.uk

If you still require further assistance, call one of our experts on 0345 604 0105*. To help give us give you a fast and efficient service please have the following information ready:

Model Ref.

You can find this information on the rating plate – a small sticker (usually a sticker or metal plate on the rear of your product)

Serial number

Date of purchase

This will be shown on your receipt

Local call rates applies*

Lines open 8am-7pm Monday to Saturday and 10am-4pm Sunday.

*Calls to Bush enquiry lines may attract a charge and set up fee from residential lines depending on your call plan / tariff. Mobile and providers costs may vary, see www.bt.com/pricing for details

For security and training purposes, telephone calls to and from customer service centres maybe recorded and monitored. Calls from Republic of Ireland will attract international call charges.

If you require any technical guidance or find that your product is not operating as intended, a simple solution can often be found in the **Troubleshooting** section of these instructions

Product support

Help is always at hand



Call us now and register your 12 month guarantee

Thank you for choosing Bush. Your new product is guaranteed against faults and breakdowns for 12 months. Don't forget to register it with us today so we can provide you with our best possible after-sales service and useful updates.

www.bushregistration.co.uk

FREEPHONE*

0800 597 8548

Lines are open 8am - 8pm, 365 days a year. *Calls may be recorded and monitored.

Your Bush Guarantee

This product is guaranteed for twelve months from the date of original purchase. Any defect that arises due to faulty materials or workmanship will be repaired free of charge (or if applicable the product will be replaced or the purchase price refunded) where possible during this period by the dealer from whom you purchased the unit.

The guarantee is subject to the following provisions:

- The guarantee does not cover accidental damage, misuse, cabinet parts, knobs or consumable items.
- The product must be correctly installed and operated in accordance with the instructions contained in the manual.
- It must be used solely for domestic purposes. The guarantee will be rendered invalid if the product is re-sold or has been damaged by inexpert repair.
- Specifications are subject to change without notice.
- Bush disclaim any liability for loss or damage arising from the breakdown of the product.
- This guarantee is in addition to and does not diminish your statutory or legal rights.

For your personal Guarantee Confirmation code call **0800 597 8548**
Guarantee Confirmation Code

Product support

Help is always at hand

Important Data Protection Information

Bush has appointed Domestic & General Insurance PLC to provide product registration services and protection plans to accompany its products.

What we do with your information

At Domestic & General we want to reassure you that we use your information both responsibly and securely to provide you with the best possible service. Below we explain what we do with your information and your rights to your information. If you would like any further details you can get in touch with us using the contact details below or visit our website (www.domesticandgeneral.com).

Using your information

Domestic & General Insurance PLC ("we") is the "data controller" of your information. We process two sets of information about you, "Personal Information" (your name, address, contact and payment details) and the "Goods Information" you provide to register your appliance or device (your name, address, contact and goods details). We'll use your information: (i) as necessary to fulfil our contract with you (including to recover any amounts owing); (ii) for our legitimate interests in: undertaking marketing (about our products and services and those of our third party partners) by post, telephone, email and/or other electronic messaging services; market research; customer surveys; printing services; checking and verifying your identity and contact details; recording your conversations for training, quality and compliance purposes; and for analytics and profiling for marketing purposes; and (iii) where required to do so by law. We may also ask for your consent to some uses of your information.

Sharing your information

From time to time your Personal Information and Goods Information may also be shared with other members of the Domestic & General Group of Companies (Domestic & General Insurance or Services and other future members of the Group whose details we will notify to you ("Group")), with companies acting on our behalf or providing services to us (e.g. the companies we use to carry out repairs, IT & mailing services, storage of paper records and telecommunications) and with the Sainsbury's Argos Group (which currently includes Sainsbury's Supermarkets, Sainsbury's Bank, Argos Limited, Tu Clothing, Habitat, Argos Financial Services, Nectar and Insight 2 Communication, Argos Business Solutions Limited). The Sainsbury's Argos Group will process your Personal Information for their legitimate business interests (including marketing and analytics) in accordance with their privacy policy, which can be found at www.argos.co.uk/help/privacy-policy

Transferring your information

In exceptional cases, we may transfer your information to countries outside the European Economic Area (including the US) which may not have data protection laws which provide the same level of protection as provided in the UK. We have put in place Model Clauses as an appropriate safeguard to ensure that such information is adequately secured and protected and that such transfers meet the requirements of applicable data protection law.

Product support

Help is always at hand

Keeping your information

We keep your Personal Information for six years after you terminate your policy so that we can deal with any claims. Your goods information we keep for a bit longer, normally 10 years (the average life of an appliance) for health and safety. We also keep your information to send you marketing that you might be interested in, unless we receive a request from you to opt-out of marketing.

Rights to your information

By writing to the Data Protection Officer using the contact details provided below, you have the right to ask us:

- for a copy of the Personal Information we hold about you
- for a copy of the Personal Information you provided to us to be sent to you or a third party in a commonly used, machine readable format
- to update or correct your Personal Information to keep it accurate
- to delete your Personal Information from our records if it is no longer needed for the original purpose; and
- to restrict the processing of your Personal Information in certain circumstances

And you may also:

- object to us processing your Personal Information – in which case we will either agree to stop processing or explain why we're unable to; and
- where we rely on your consent, withdraw that consent at any time.

Please note that the above rights are not absolute and certain exemptions apply to them. You can also make a complaint to the Information Commissioner (www.ico.org.uk) if you feel your Personal Information has been mishandled.

Marketing

We, along with other members of our Group, Argos Limited, and other members of the J Sainsbury's Group of Companies may use your information to tell you about any offers, products or services which may be of interest to you. We may contact you by post, telephone, email and/or other electronic messaging services. To change your marketing preference, let us know by emailing marketingpreferences@domesticandgeneral.com or by writing to us using the contact details provided below. If you don't want Argos to send you marketing by phone, email or post then please see Argos's Privacy Policy, which can be found on their website at www.argos.co.uk/help/privacy-policy to opt out of this marketing. Argos will stop sending you marketing communications but will still contact you with service-related messages every now and then.

Contact Details

If you need to contact us about your information or your information rights, or to see a copy of our Model Clauses, please write to: Freepost Plus RTKS-CLRA-GRYE, Data Protection Officer, Domestic & General, Leicester House, 17 Leicester Street, Bedworth, CV12 8JP or dataprotection@domesticandgeneral.com and we'll be happy to help you.

BUSH

Should you require any guidance;
call our Help line on 0345 604 0105.
Further contact details can be found online at:
www.bush-support.co.uk

Produced in China for Argos Limited,
London, EC1N 2HT, UK. Argos (N.I.) Ltd, Forestside Shopping Centre,
Upper Galwally, Belfast, BT8 6FX, UK.

Bush is a registered trademark of Argos Ltd.