

# Tefal

EN

## ULTRAGLIDE Anti-Calc



[www.tefal.com](http://www.tefal.com)



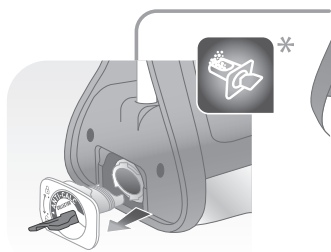
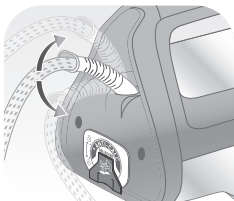
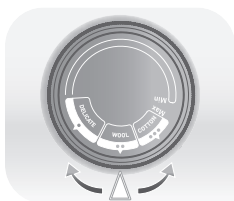
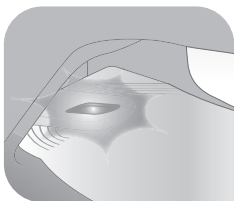

\* According to model

SAFETY  
AUTO-OFF \*

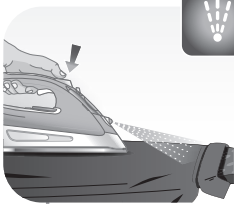
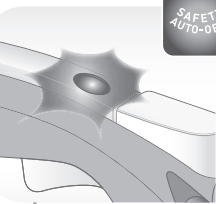

TURBO

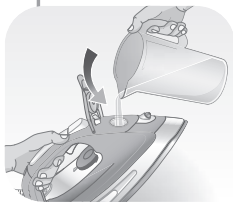
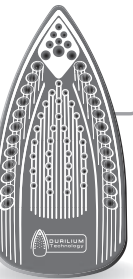
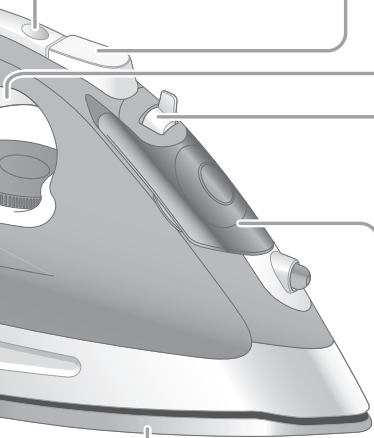

## IMPORTANT SAFETY RECOMMENDATIONS

- Please read these instructions carefully before first use. This product has been designed for domestic and indoor use only. Any commercial use, inappropriate use or failure to comply with the instructions, the manufacturer accepts no responsibility and the guarantee will not apply.
- Never unplug the appliance by pulling the power cord. Always unplug your appliance: before filling the water tank or rinsing the water tank, before cleaning the appliance, after each use.
- The appliance must be used and placed on a flat, stable, heat and water resistant surface. When you place the iron on the iron rest, make sure that the surface on which you place it is stable.
- This appliance is not intended to be used by persons (including children) with reduced or impaired physical, sensory or mental capabilities or persons lacking appropriate knowledge or experience, unless a person responsible for their safety provides either supervision or appropriate instructions concerning use of the appliance prior to its use.
- Children should be supervised to ensure they do not play with the appliance.
- This appliance may be used by children aged 8 or over and persons lacking appropriate knowledge or experience or persons with reduced or impaired physical, sensory or mental capabilities provided that

they have been thoroughly instructed regarding use of the appliance, are supervised, and understand the risks involved. Children shall not play with the appliance. Cleaning and user maintenance shall not be made by children without supervision. Keep the iron and its cord out of reach of children less than 8 years of age when it is energized or cooling down.



- The surfaces of your appliance can reach very high temperatures when functioning, which may cause burns. Do not touch the hot surfaces of the appliance (accessible metal parts and plastic parts adjacent to the metallic parts).
- Never leave the appliance unattended when it is connected to the mains. Before storing the appliance, once it is unplugged, please wait until it has cooled down (around 1 hour).
- The appliance must not be used if it has been dropped, if it has any visible damage, if it leaks, or if it functions abnormally in any way. Do not attempt to dismantle your appliance: have it examined at an Approved Service Centre to avoid any danger.
- The iron should only be used with the base provided (for cordless irons).
- Check the electrical power for sign of wear or damage prior to use. If the electrical power cord is damaged, it must be replaced at an Approved Service Centre to avoid any danger.

- The iron must always be placed on its base and never on its heel (for cordless irons) .
- Your iron and its base must be used and placed on a stable surface. When you place the iron on its base, ensure that the surface on which the base is placed is stable.
- For your safety, this appliance conforms to all applicable regulations (Low Voltage Directive, Electromagnetic Compatibility, Environment, etc).
- Your steam iron is an electrical appliance: it must be used under normal conditions of use. It is designed for domestic use only.
- Always plug your steam iron:
  - into a mains circuit with voltage between 220 V and 240 V,
  - into an earthed electrical socket.

Connecting to the wrong voltage may cause irreparable damage to the appliance and will invalidate your guarantee. If you are using a mains extension lead, ensure that it is correctly rated (16A) with an earth, and is fully extended.

- Completely unwind the power cord before plugging into an earthed socket.
- The soleplate of your iron can reach extremely high temperatures, and can cause burns: do not touch them. Never touch the electrical power cords with the soleplate of the iron.
- Your appliance emits steam, which can cause burns. Always handle the iron with care, especially when ironing vertically. Never direct the steam towards people or animals.
- Never immerse your steam iron in water or any other liquid. Never place it under a running tap.
- The plug must be removed from the socket-outlet before the water tank is filled with water.

## PLEASE RETAIN THIS INSTRUCTION BOOKLET FOR FUTURE REFERENCE



### Environment protection first !

- ① Your appliance contains valuable materials which can be recovered or recycled.
- ➡ Leave it at a local civic waste collection point.

# SUMMARY

## IMPORTANT SAFETY RECOMMENDATIONS

Important safety recommendations.....	p. 4
Before first use.....	p. 8

## PREPARATION

Which water should I use?.....	p. 9
Filling the water tank.....	p. 9

## USE

Adjusting the temperature and steam.....	p. 10
Dry ironing.....	p. 11
Getting more steam.....	p. 11
Vertical steam ironing.....	p. 12
Dampening clothing (Spray).....	p. 13
While ironing.....	p. 13
Auto-Off Function (according to model).....	p. 13

## IRON STORAGE AND MAINTENANCE

Iron storage.....	p. 14
Cleaning the anti-calc Collector.....	p. 15
Cleaning the anti-calc valve (once per month).....	p. 16
Descaling the steam chamber (3 times a year).....	p. 17
Cleaning the soleplate.....	p. 18

## IS THERE A PROBLEM WITH YOUR IRON?

Problems, possible causes, solutions.....	p. 19
---	-------

## BEFORE FIRST USE



Remove any labels from the soleplate before heating the iron.

Before using the steam function in your iron for the first time, we recommend that you allow the iron to operate a few moments in a horizontal position without coming into contact with your laundry. Keeping the iron in this position, push the steam button several times.

During the first few uses, the appliance may produce smoke, a harmless odour and a light emission of particles. These are simply the engineering residues from the manufacturing process burning off. These are harmless and will quickly disappear.



## PREPARATION

### Which water should I use?

- Your appliance was designed to operate using untreated tap water. However, it is necessary to periodically clean the steam chamber to remove any mineral deposits.
- Do not use pure demineralised or pure distilled water, water from clothes dryers, scented or softened water, rain water, filtered, bottled or boiled water, water from refrigerators, batteries or air conditioners, pure distilled water or rain water as these may damage the iron. These types of water contain organic waste, mineral elements that become concentrated when heated and cause spitting, brown staining, leaking or premature wear on your iron.

If your water is very hard, mix 50% untreated tap water with 50% distilled water (available in hardware stores).

### Filling the water tank

- Unplug the iron before filling it.
- Set the steam control to 
- Lift the iron and, holding it at a slight incline, point the soleplate up.
- Open the water tank cover.
- Fill the water tank to the mark "Max".
- Close the water tank cover.

**Warning !** Do not fill your iron through the scale collector opening. Do not remove the anti-calc collector to fill the tank.

## USE



- Plug in the appliance.

### Adjusting the temperature and steam



- Set the steam control to 



- Adjust the temperature control, referring to the table below.

FABRIC	TEMPERATURE CONTROL POSITION
LINEN	<b>Max</b>
COTTON	•••
WOOL	••
SILK/SYNTHETIC (Polyester, Acetate, Acrylic, Polyamide)	•

 = STEAM ZONE



- The temperature indicator light turns on.



- It will turn off automatically once the soleplate achieves the desired temperature.

Set the temperature control dial to match the type of fabric you wish to iron. Your iron automatically and accurately determines the exact temperature and steam flow that are suitable, in order to guarantee the best results.



Your iron heats quickly: begin with fabrics that require lower temperatures.

When ironing fabrics with most delicate fibres: set the ironing temperature for the most fragile fibre.

The iron will not heat up if the thermostat control is set to "Min".



- Set the temperature according to the fabric to be ironed.
- Set the steam control to 
- You may continue to iron when the indicator light turns off.



- Set the thermostat control to "Max" or "•••".



- Press the turbo steam button periodically (turbo steam).
- To avoid water dripping on the laundry, maintain an interval of a few seconds in between each press.

## Vertical steam ironing



- Hang the item on a hanger and keep the fabric taut with one hand. The steam is very hot; never steam iron clothing while it is being worn—always use a hanger.



- Set the thermostat control to “Max”

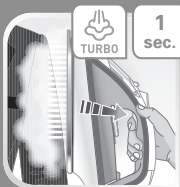

- Press the turbo steam button (turbo steam) in pulses, moving the iron from top to bottom.



- Hold the iron at a distance of a few centimetres from the clothing to avoid burning delicate fabrics.

## Dampening clothing (Spray)



- When dry or steam ironing, press repeatedly on the spray button to moisten clothing and remove stubborn creases.
- Ensure that there is water in the tank before using the spray button.

## While ironing



- Do not lay the iron down on the soleplate; use the heel rest for this purpose.



## Auto-Off Function (according to model)



- If the iron remains unused for more than 8 minutes on the heel rest or more than 30 seconds laid flat or on its side, the electronic system will cut the power, the iron will stop heating **and the auto-off indicator will begin to flash.**
- To restart the iron, move it gently until the indicator stops flashing.

## IRON STORAGE AND MAINTENANCE

### Storing your iron



- Unplug the iron and wait for the soleplate to cool (approx. 1 hour).



- Empty the water tank.



- Set the steam control to .



- Wrap the cord lightly around the bottom of the iron's body. Store the iron on its heel rest.

## Cleaning the anti-calc Collector (every 4 months)



- Unplug the iron, empty the water tank and wait for the soleplate to cool down (approx. 1 hour).

- Once the steam iron has completely cooled down, raise and turn the tab of the collector to unlock it.

- Remove the collector from the iron, it contains the limescale collected in the iron.

- To clean the collector thoroughly rinse in water to remove the limescale inside.

- Reposition the collector in its housing and turn the tab a quarter turn to the right in order to lock the collector and ensure it is watertight.

**Warning !** The iron does not work without the anti-calc collector.

## Cleaning the anti-calc valve (once per month)



- Unplug your iron and empty the water tank.



- To remove the anti-calc valve, open the water tank cover and pull on the valve near the steam control.



- Soak the valve for 4 hours in a glass of water with lemon juice.



- Rinse the valve under the tap.



- Insert the valve in place, pushing it until you hear a click.



**Beware!**

Never touch the end of the valve.

The iron will not function without the anti-calc valve.



## Descaling the steam chamber (once per month)



- Allow your iron to heat up with a full water tank while on its heel rest and with the temperature control set to maximum.



- Once the indicator light switches off, unplug the iron and place it over a sink.



- Remove the anti-calc collector.

- Shake the iron gently in a horizontal position above the sink until some of the water (containing the impurities) leaks from the soleplate. You may push the turbo steam trigger to help flush out the minerals.



- To finish the process, replace the anti-calc collector, pushing it until you hear a click.



- Plug in your iron for 2 minutes on the heel rest to dry the soleplate.



- Unplug your iron and, once cooled, wipe it with a soft cloth.

- Never use chemical or abrasive products.



During the next use, turn on your iron in a horizontal position without putting it into contact with your laundry in order to eliminate any water containing mineral residues that remain in the soleplate.

### Cleaning the soleplate



- While the soleplate is still cool, clean it with a damp non-metallic pad.



- Never use chemical or abrasive products.

## IS THERE A PROBLEM WITH YOUR IRON?

PROBLEMS	POSSIBLE CAUSES	SOLUTIONS
<b>Water is leaking from the holes in the soleplate.</b>	You are using the steam when the iron is not hot enough.	Wait for the indicator light to turn off.
	You are using the turbo steam button (turbo steam) too often.	Wait a few seconds between each use.
	You have stored the iron horizontally without emptying the water tank or setting the steam control to ☒.	See the chapter on "Storing your iron".
<b>The iron leaks at the start of ironing.</b>	You have removed the anti-calc collector to fill up your iron.	Do not remove the anti-calc collector when filling the iron.
	The steam control dial is not set to ☒ when filling the water tank.	Ensure that the steam control dial is set to ☒ when filling the water tank.
<b>A brown discharge coming from the soleplate is staining the clothing.</b>	You are using chemical descaling agents.	Do not introduce a descaling agent into the water tank.
	You are not using the right type of water.	Clean the steam chamber and see the chapter on "What water should I use?"
	Clothing fibres are building up in the holes of the soleplate and burning.	Clean the steam chamber and the soleplate with a damp sponge. Periodically vacuum the holes in the soleplate.
<b>The soleplate is dirty or brown and may stain clothing.</b>	The temperature of the iron is too hot.	Clean the soleplate as indicated above. Consult the table of temperatures to adjust the temperature.
	You are using starch.	Clean the soleplate as indicated above. Spray the starch on the reverse side of the clothing to be ironed.
	Your laundry has not been rinsed sufficiently or you are ironing a new item of clothing before washing it.	Ensure that your laundry is sufficiently rinsed to eliminate potential soap deposits or chemical products on new items of clothing being sucked up by the iron and then deposited on the linen.

## IS THERE A PROBLEM WITH YOUR IRON?

PROBLEMS	POSSIBLE CAUSES	SOLUTIONS
<b>Your iron produces little to no steam.</b>	The water tank is empty.	Fill it up.
	The anti-calc collector is dirty.	Clean the anti-calc collector.
	Your iron is clogged up with limescale.	Clean the anti-calc collector and steam chamber.
	Your iron has been used for too long in the dry ironing function.	Clean the steam chamber.
<b>The soleplate is scratched or damaged.</b>	You have placed your iron on a metallic iron rest or ironed over metal zips or fasteners.	Always place your iron on its heel rest when not in use. Do not iron over metal zips or fasteners.
<b>The iron steams once the water tank has been filled.</b>	The steam control dial is not set to ☒.	Ensure that the steam control dial is set to ☒.
	The water tank is too full.	Do not exceed the max level for filling.
<b>The spray does not spray water.</b>	The water tank is not full enough.	Add water to the water tank.

**If you have any problems or queries please call our Customer Relations team first for expert help and advice. See Helpline number in the separate guarantee and country list leaflet.**