



McGregor 37cm CORDLESS ROTARY LAWNMOWER



4548324 (Model: MCLLM3637)

VI: 10/24

**Important - Please read these
instructions fully before starting assembly**

These instructions contain important information that will help you get the best from your mower, ensuring it is assembled correctly and safely. If you need help or have damaged or missing parts, call the Customer Helpline on **0345 605 2062**

**AFTER SALES SUPPORT
0345 605 2062**

SAN NO: 0321802311ZJ

Contents

Safety Information	2
In the box	19
Parts list	20
Assembly	21
Preparation.....	24
Operation.....	28
Maintenance and Storage	32
Troubleshooting.....	35
Technical Data	37
Recycling and Disposal.....	38
Getting Help	38
Guarantee	39

Produced in China for Argos Limited, London, EC1N 2HT, UK.

Argos (N.I.) Ltd, Forestside Shopping Centre, Upper Galwally, Belfast, BT8 6FX, UK.

<https://bit.ly/Coreservice-McGregor>

Safety Information

Important - Please read these instructions fully before operating or maintaining

Warning symbols



To reduce the risk of injury, user must read instruction manual carefully.



Avoid using tool in the rain.

Wait until all machine components have completely stopped before touching them.



Keep bystanders away. Objects thrown by the product could hit the user or other bystanders.

Always ensure that other people and pets remain at a safe distance from the product when it is in operation.



Beware of sharp blades. Blades continue to rotate after the motor is switched off. Remove battery packs before performing any maintenance tasks.



Wear hearing protection when using the product.



Wear eye protection when using the product.



Wear protective gloves



Guaranteed sound power level value 96 dB(A)

Safety Information

Important - Please read these instructions fully before operating or maintaining

Warning symbols

IPX1 Moisture resistance protection degree



The product complies with the applicable European directives and an evaluation method of conformity for these directives was done.



The product complies with the applicable UK Directives, and an evaluation method of conformity for these directives was done.



WEEE symbol. Waste electrical products should not be disposed of with household waste. Please recycle where facilities exist. Check with your local authority or local store for recycling guidelines.

Warning symbols on battery pack and charger



To reduce the risk of injury, user must read instruction manual carefully.



Do not throw into water.



Do not throw on fire.



Do not subject the battery to strong sunlight over long periods of time. Do not leave on a heater (max.45°C).



Li-Ion

Batteries contain Li-ion. Do not dispose of waste batteries in domestic waste. Contact local authority to find out how to dispose of batteries.

Safety Information

Important - Please read these instructions fully before operating or maintaining

Warning symbols on battery pack and charger



The charger is for indoor use only.



Double insulation.

T5A



Protective 5A limited with B0Q-SP07-2040ZB.

Introduction



IMPORTANT ! IN ORDER TO OBTAIN THE UTMOST SATISFACTION FROM THIS PRODUCT UPON SETTING IT UP, USING IT, AND MAINTAINING IT, WE RECOMMEND THAT YOU CAREFULLY READ THIS USER MANUAL BEFORE USING THE PRODUCT. PLEASE PAY ATTENTION TO BASIC WARNINGS RELATING TO SAFETY WITHIN THIS MANUAL, AND KEEP THE MANUAL FOR LATER REFERENCE.

Thank you for choosing McGregor product. Upon designing and manufacturing our products, we place all of our efforts into ensuring an excellent quality that meets the needs of the users.

Safety Information

Important - Please read these instructions fully before operating or maintaining

Intended use

This product is intended for outdoor use only, and must not be used inside a building under any circumstances. The cordless lawn mower is only intended for use in dry and well-illuminated conditions. This lawn mower is only intended to be used for cutting grass in domestic use. Do not use it for others purposes. The product is not intended to be used by children or persons with reduced physical, mental or sensory capabilities.

After unwrapping the packing, make sure that the product is complete with its accessories (if any). If the product is damaged or has any defect, please do not use it and bring back it to your dealer. If you give this tool to another people, please give him also this instruction manual.

Please note that our equipment has not been designed for use in commercial, trade or industrial applications. Our warranty will be voided if the machine is used in commercial, trade or industrial businesses or for equivalent purposes. This product has been designed to be used over a period of years (Expected lifetime).

Safety Information

Important - Please read these instructions fully before operating or maintaining

General Machine Safety Warnings



WARNING!

Read all safety warnings, instructions, illustrations and specifications provided with this machine. Failure to follow all instructions listed below may result in electric shock, fire and/or serious injury.

Save all warnings and instructions for future reference.

The term " machine " in the warnings refers to battery-operated (cordless) machine.

- This appliance is not intended for use by persons (including children) with reduced physical, sensory or mental capabilities, or lack of experience and knowledge, unless they have been given supervision or instruction concerning use of the appliance by a person responsible for their safety.
- Children should be supervised to ensure that they do not play with the appliance.
- The appliance is only to be used with the power supply unit provided with the appliance.

Work Area safety

- **Keep work area clean and well lit.** Cluttered or dark areas invite accidents.
- **Do not operate the machine in explosive atmospheres, such as in the presence of flammable liquids, gases or dust.** Machine create sparks which may ignite the dust or fumes.
- **Keep children and bystanders away while operating a power machine.** Distractions can cause you to lose control.

Safety Information

Important - Please read these instructions fully before operating or maintaining

Electrical Safety

- **Machine plugs must match the outlet. Never modify the plug in any way. Do not use any adapter plugs with earthed (grounded) machine.** Unmodified plugs and matching outlets will reduce risk of electric shock.
- **Avoid body contact with earthed or grounded surfaces, such as pipes, radiators, ranges and refrigerators.** There is an increased risk of electric shock if your body is earthed or grounded.
- **Do not operate the lawnmower in rain or wet conditions.** This may increase the risk of electric shock.
- **Do not abuse the cord. Never use the cord for carrying, pulling or unplugging the machine. Keep cord away from heat, oil, sharp edges or moving parts.** Damaged or entangled cords increase the risk of electric shock.
- **When operating a machine outdoors, use an extension cord suitable for outdoor use.** Use of a cord suitable for outdoor use reduces the risk of electric shock.
- **If operating a machine in a damp location is unavoidable, use a residual current device (RCD) protected supply.** Use of an RCD reduces the risk of electric shock.

Personal Safety

- **Stay alert, watch what you are doing and use common sense when operating a machine. Do not use machine while you are tired or under the influence of drugs, alcohol or medication.** A moment of inattention while operating machine may result in serious personal injury.

Safety Information

Important - Please read these instructions fully before operating or maintaining

Personal Safety

- **Use personal protective equipment. Always wear eye protection.** Protective equipment such as dust mask, non-skid safety shoes, hard hat, or hearing protection used for appropriate conditions will reduce personal injuries.
- **Prevent unintentional starting. Ensure the switch is in the off-position before connecting to power source and/or battery pack, picking up or carrying the machine.** Carrying machines with your finger on the switch or energising machines that have the switch on invites accidents.
- **Remove any adjusting key or wrench before turning the machine on.** A wrench or a key left attached to a rotating part of the machine may result in personal injury.
- **Do not overreach. Keep proper footing and balance at all times.** This enables better control of the machine in unexpected situations.
- **Dress properly. Do not wear loose clothing or jewellery. Keep your hair, clothing and gloves away from moving parts.** Loose clothes, jewellery or long hair can be caught in moving parts.
- **If devices are provided for the connection of dust extraction and collection facilities, ensure these are connected and properly used.** Use of dust collection can reduce dust-related hazards.
- **Do not let familiarity gained from frequent use of machines allow you to become complacent and ignore machine safety principles.** A careless action can cause severe injury within a fraction of a second.

Safety Information

Important - Please read these instructions fully before operating or maintaining

Machine use and care

- **Do not force the machine. Use the correct machine for your application.** The correct machine will do the job better and safer at the rate for which it was designed.
- **Do not use the machine if the switch does not turn it on and off.** Any machine that cannot be controlled with the switch is dangerous and must be repaired.
- **Disconnect the plug from the power source and/or the battery pack, if detachable, from the machine before making any adjustments, changing accessories, or storing machines.** Such preventive safety measures reduce the risk of starting the power machine accidentally.
- **Store idle machine out of the reach of children and do not allow persons unfamiliar with the machine or these instructions to operate the machine.** Machines are dangerous in the hands of untrained users.
- **Maintain machines and accessories. Check for misalignment or binding of moving parts, breakage of parts and any other condition that may affect the machine's operation. If damaged, have the machine repaired before use.** Many accidents are caused by poorly maintained power machines.
- **Use the machine, accessories and machine bits etc. in accordance with these instructions, taking into account the working conditions and the work to be performed.** Use of the machine for operations different from those intended could result in a hazardous situation.
- **Keep handles and grasping surfaces dry, clean and free from oil and grease.** Slippery handles and grasping surfaces do not allow for safe handling and control of the machine in unexpected situations.

Safety Information

Important - Please read these instructions fully before operating or maintaining

Battery machine use and care

- **Recharge only with the charger specified by the manufacturer.** A charger that is suitable for one type of battery pack may create a risk of fire when used with another battery pack.
- **Use machines only with specifically designated battery packs.** Use of any other battery packs may create a risk of injury and fire.
- **When battery pack is not in use, keep it away from other metal objects, like paper clips, coins, keys, nails, screws or other small metal objects, that can make a connection from one terminal to another.** Shorting the battery terminals together may cause burns or a fire.
- **Under abusive conditions, liquid may be ejected from the battery; avoid contact. If contact accidentally occurs, flush with water. If liquid contacts eyes, additionally seek medical help.** Liquid ejected from the battery may cause irritation or burns.
- **Do not use a battery pack or machine that is damaged or modified.** Damaged or modified batteries may exhibit unpredictable behaviour resulting in fire, explosion or risk of injury.
- **Do not expose a battery pack or machine to fire or excessive temperature.** Exposure to fire or temperature above 130 °C may cause explosion.
- **Follow all charging instructions and do not charge the battery pack or machine outside the temperature range specified in the instructions.** Charging improperly or at temperatures outside the specified range may damage the battery and increase the risk of fire.

Safety Information

Important - Please read these instructions fully before operating or maintaining

Service

- **Have your machine serviced by a qualified repair person using only identical replacement parts.** This will ensure that the safety of the machine is maintained.
- **Never service damaged battery packs.** Service of battery packs should only be performed by the manufacturer or authorized service providers.

Lawnmower safety warnings

- **Do not use the lawnmower in bad weather conditions, especially when there is a risk of lightning.** This decreases the risk of being struck by lightning.
- **Thoroughly inspect the area for wildlife where the lawnmower is to be used.** Wildlife may be injured by the lawnmower during operation.
- **Thoroughly inspect the area where the lawnmower is to be used and remove all stones, sticks, wires, bones, and other foreign objects.** Thrown objects can cause personal injury.
- **Before using the lawnmower, always visually inspect to see that the blade and the blade assembly are not worn or damaged.** Worn or damaged parts increase the risk of injury.
- **Check the grass catcher frequently for wear or deterioration.** A worn or damaged grass catcher may increase the risk of personal injury.
- **Keep guards in place. Guards must be in working order and be properly mounted.** A guard that is loose, damaged, or is not functioning correctly may result in personal injury.
- **Keep all cooling air inlets clear of debris.** Blocked air inlets and debris may result in overheating or risk of fire.

Safety Information

Important - Please read these instructions fully before operating or maintaining

Lawnmower safety warnings

- **While operating the lawnmower, always wear non-slip and protective footwear. Do not operate the lawnmower when barefoot or wearing open sandals.** This reduces the chance of injury to the feet from contact with the moving blade.
- **While operating the lawnmower, always wear long trousers.** Exposed skin increases the likelihood of injury from thrown objects.
- **Do not operate the lawnmower in wet grass. Walk, never run.** This reduces the risk of slipping and falling which may result in personal injury.
- **Do not operate the lawnmower on excessively steep slopes.** This reduces the risk of loss of control, slipping and falling which may result in personal injury.
- **When working on slopes, always be sure of your footing, always work across the face of slopes, never up or down and exercise extreme caution when changing direction.** This reduces the risk of loss of control, slipping and falling which may result in personal injury.
- **Use extreme caution when reversing or pulling the lawnmower towards you. Always be aware of your surroundings.** This reduces the risk of tripping during operation.
- **Do not touch blades and other hazardous moving parts while they are still in motion.** This reduces the risk of injury from moving parts.
- **When clearing jammed material or cleaning the lawnmower, make sure all power switches are off and the battery pack is disconnected.** Unexpected operation of the lawnmower may result in serious personal injury.

Safety Information

Important - Please read these instructions fully before operating or maintaining

Lawnmower safety warnings

**IMPORTANT
READ CAREFULLY BEFORE USE.
KEEP FOR FUTURE REFERENCE.**
**Safe operating practices for electrically powered
lawnmowers**

Training

- Read the instructions carefully. Be familiar with the controls and the proper use of the equipment.
- Never allow children or people unfamiliar with these instructions to use the lawnmower. Local regulations can restrict the age of the operator.
- Never mow while people, especially children, or pets are nearby.
- Keep in mind that the operator or user is responsible for accidents or hazards occurring to other people or their property.

Preparation

- While mowing, always wear substantial footwear and long trousers. Do not operate the equipment when barefoot or wearing open sandals. Avoid wearing clothing that is loose fitting or that has hanging cords or ties.
- Thoroughly inspect the area where the equipment is to be used and remove all objects which can be thrown by the machine.
- Before using, always visually inspect to see that the blades, blade bolts and blades assembly are not worn or damaged. Replace worn or damaged blades and bolts in sets to preserve balance. Replace damaged and unreadable labels.

Safety Information

Important - Please read these instructions fully before operating or maintaining

Preparation

- Ensure the switch is in the off position before inserting the battery pack. Inserting the battery pack into a machine that is switched on can result in injury.
- CAUTION! Do not touch a rotating cutting blade.

Operation

- Operate the product in daylight or in good artificial light.
- Avoid operating the product on wet grass.
- Always be sure of your footing on slopes.
- Walk, never run.
- Mow across the face of slopes, never up and down.
- Exercise extreme caution when changing direction on slopes.
- Do not mow excessively steep slopes.
- Use extreme caution when reversing or pulling the product towards you.
- Stop the blades if the product has to be tilted for transportation, when crossing surfaces other than grass and when transporting the product to and from the area to be used.
- Never operate the machine with defective guards or shields, or without safety devices, for example deflectors and/or grass collector, in place.
- Switch on the motor carefully according to instructions and with feet well away from the blade(s).
- Do not tilt the product when switching on the motor, except if the product has to be tilted for starting. In this case, do not tilt it more than absolutely necessary and lift only the part furthest away from the operator.
- Do not start the product when standing in front of the discharge opening.
- Do not put hands or feet near or under rotating parts. Keep clear of the discharge opening at all times.

Safety Information

Important - Please read these instructions fully before starting assembly

Operation

- Do not transport the product while the power source is running.
- Stop the machine, and remove battery pack from the machine. Make sure that all moving parts have come to a complete stop.
 - whenever you leave the machine,
 - before clearing blockages or unclogging chute,
 - before checking, cleaning or working on the machine,
 - after striking a foreign object. Inspect the machine for damage and make repairs before restarting and operating the machine;
- If the product starts to vibrate abnormally or struck a foreign object (check immediately):
 - Inspect for any damages.
 - Replace or repair any damaged parts.
 - Check for and tighten any loose parts.

Maintenance and Storage

- Improper maintenance will lead to malfunction/failure of the product.
- Keep all nuts, bolts and screws tight to be sure the product is in a safe working condition.
- Check the grass collector frequently for wear or deterioration.
- Be careful during adjustment of the machine to prevent entrapment of the fingers between moving blades and fixed parts of the machine.
- Always allow the machine to cool down before storing.
- When servicing the blades be aware that even though the power source is switched off, the blades can still move.
- Replace worn or damaged parts for safety. Use only genuine replacement parts and accessories.

Safety Information

Important - Please read these instructions fully before operating or maintaining

Maintenance and Storage

- Wear strong work gloves when removing and re-assembling the cutting blade.
- Have the product repaired only by an authorised service centre or similar qualified specialist.
- When not in use, store the product out of the reach of children.

Health surveillance

All employees should be part of an employer's health surveillance scheme to help identify any vibration related diseases at an early stage, prevent disease progression and help employees stay in work.

Vibration and noise reduction

To reduce the impact of noise and vibration emission, limit the time of operation, use low-vibration and low-noise operating modes as well as wear personal protective equipment.

Take the following points into account to minimize the vibration and noise exposure risks:

- Only use the product as intended by its design and these instructions.
- Ensure that the product is in good condition and well maintained.
- Use correct application tools for the product and ensure they in good condition.
- Keep tight grip on the handles/gripping surface.
- Maintain this product in accordance with these instructions and keep it well lubricated (where appropriate).
- Plan your work schedule to spread any high vibration tool use across a longer period of time.

Safety Information

Important - Please read these instructions fully before operating or maintaining

Vibration and noise reduction

- Prolonged use of the product exposes the user to vibrations that can cause a range of conditions collectively known as hand-arm vibration syndrome (HAVS) e.g. fingers going white; as well as specific diseases such as carpal tunnel syndrome. To reduce this risk when using the product, always wear protective gloves and keep your hands warm.

Emergency

Familiarise yourself with the use of this product by means of this instruction manual. Memorise the safety directions and follow them to the letter. This will help to prevent risks and hazards.

- **Always be alert when using this product, so that you can recognise and handle risks early.** Fast intervention can prevent serious injury and damage to property.
- **Switch off and disconnect from the power supply if there is any malfunction.** Have the product checked by a qualified specialist and repaired, if necessary, before you put it into operation again.

Residual risks

Even if you are operating this product in accordance with all the safety requirements, potential risks of injury and damage remain. The following dangers can arise in connection with the structure and design of this product:

- Health defects resulting from vibration emission if the product is being used over long periods of time or not adequately managed and properly maintained.

Safety Information

Important - Please read these instructions fully before operating or maintaining

Residual risks

- Injuries and damage to property due to broken application tools or the sudden impact of hidden objects during use.
- Danger of injury and property damage caused by flying objects.

 **WARNING! This product produces an electromagnetic field during operation! This field may under some circumstances interfere with active or passive medical implants! To reduce the risk of serious or fatal injury, we recommend persons with medical implants to consult their doctor and the medical implant manufacturer before operating this product!**

In the Box

Parts description

- | | |
|------------------------------------|------------------------------|
| A. Lawn mower with upper handle | F. Upper handle fix knob x 2 |
| B. Grass collection bag and handle | G. Cable clips x 2 |
| C. Lower handle x 2 | H. Battery pack x 2 |
| D. Lower handle fix knob x 2 | I. Charger |
| E. Teeth clamps x 2 | J. Cable protection sleeve |

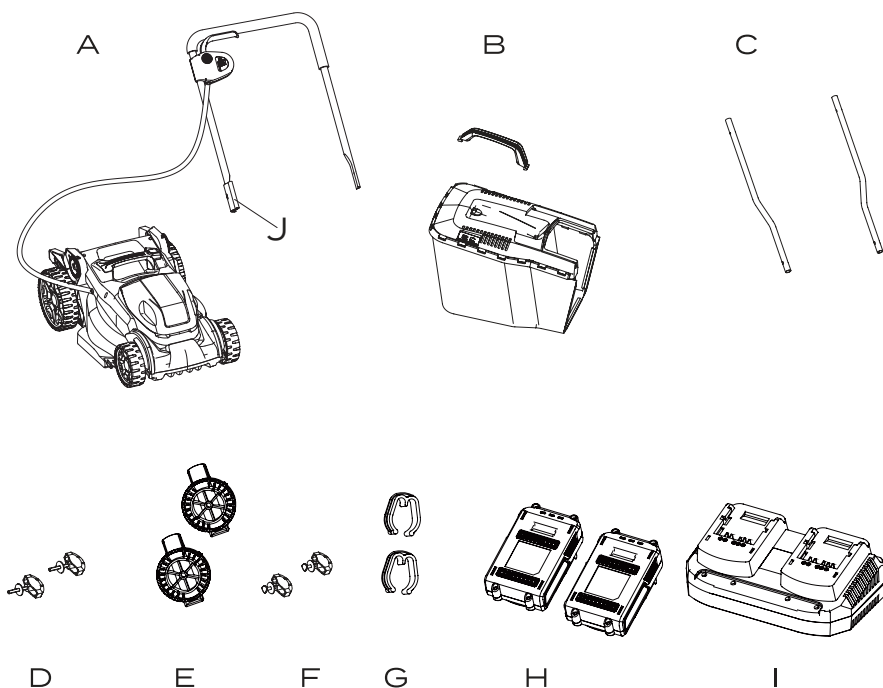

Parts list

Parts description

- | | |
|-------------------------------------|---------------------------|
| 1. Switch box | 8. Grass bag |
| 2. Lower handle | 9. Upper handle fix knob |
| 3. Carry handle | 10. Upper handle |
| 4. Battery compartment cover | 11. Switch lever |
| 5. Front wheel | 12. Battery pack |
| 6. Cutting height adjustment button | 13. Charger |
| 7. Rear wheel | 14. Lower handle fix knob |

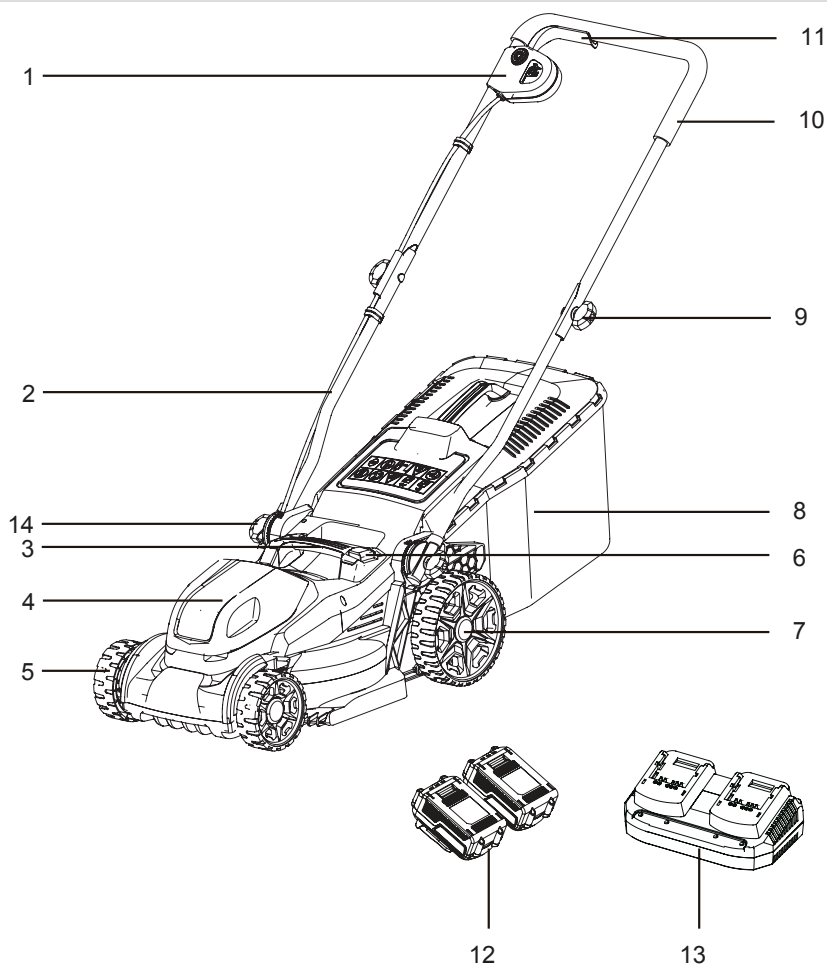

Assembly



WARNING!

Ensure the battery pack is disconnected from the mower before starting assembly.

Assemble the lower handle

Attach the two tooth clamps(part E) to the lower handle.

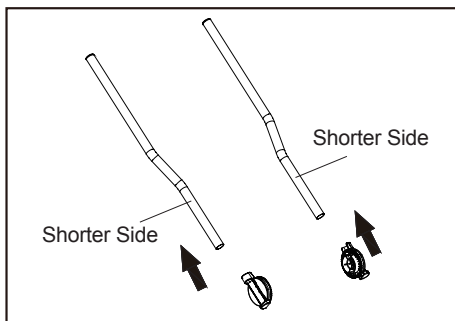

Attach the lower handle to the lawn mower

Install the lower handle to the lawn mower with two lower handle fix knobs (14). Make sure that the teeth of the fixing gears interlock correctly.



WARNING!

Please assemble the lower handle as the picture shown below, or it will be hard for you to attach the top handle to the lower handle. At the same time, the clamp should be fixed on the same position.

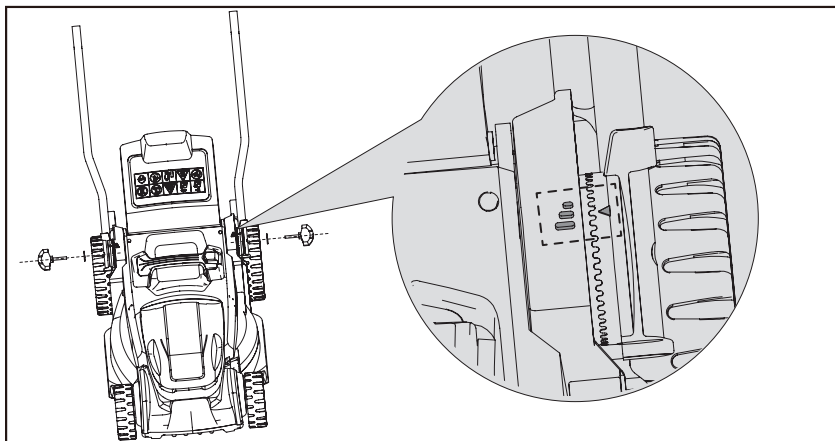

Assembly

Attach the top handle to the lawn mower

Mount the top handle to the lower handle using two upper handle fix knobs (9). Make sure to insert the flattened end of top handle in to the cable protection sleeve (J) on the cable. And align the hold of the clip with the one on the handle. Then Make sure the screw been inserted through them.

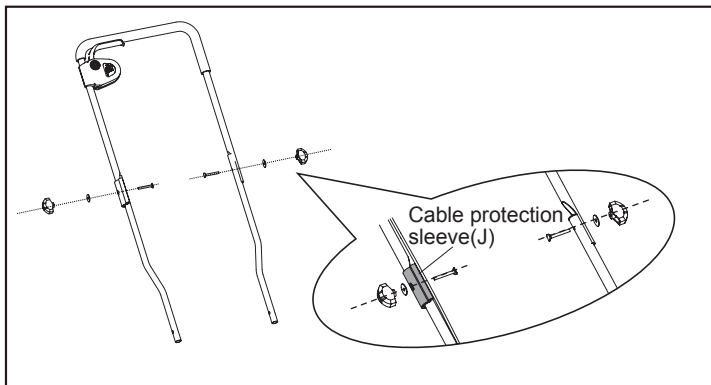

Fitting the cable clip

Ensure that the cable clips(Part G) supplied are used to fix the cable to the upper handle and lower handle.

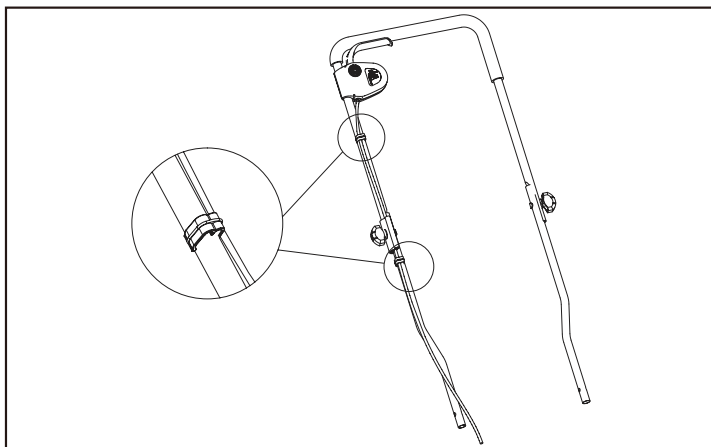

Assembly

Attach the grass bag

Insert the grass bag handle into the groove of the grass bag.

Then press the grass bag handle into the clip of the grass bag, and hear “click” to indicate that the handle is in place.

Attach the grass bag to the frame by fixing the plastic hooks onto the side as shown below.

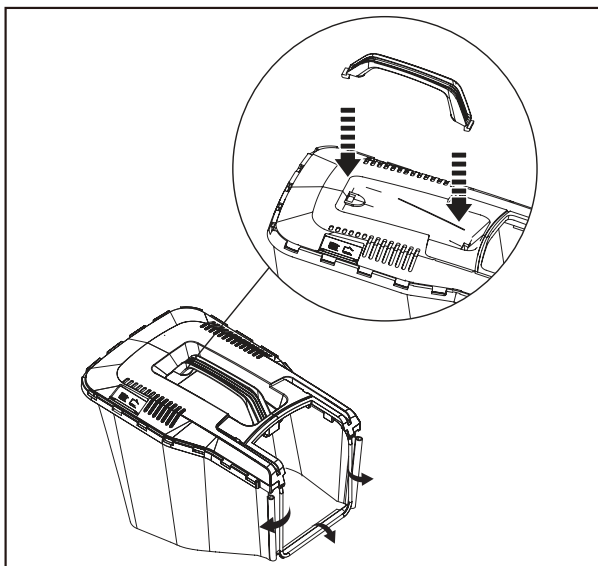

Lift the deflector guard with one hand and hook in the grass bag. Release the deflector guard to secure the grass bag in position.

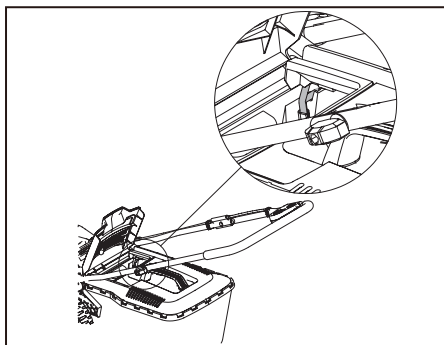
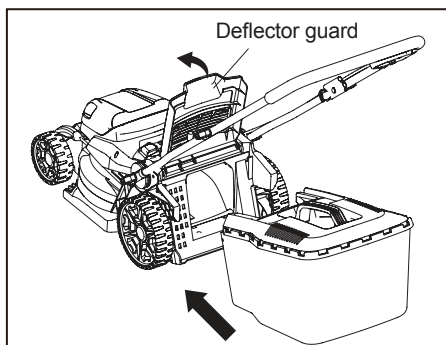

Preparation

Charging the battery pack



NOTE: The battery pack comes not fully charged. Charge the battery pack prior to first use, ideally at least 60 minutes.

- Always pull out the plug of the charger from the mains before removing or connecting the battery pack to the charger.
- Never charge the battery pack when the ambient temperature is below 0°C or above 45°C.
- Never recharge the battery pack again immediately after use. Let the battery pack to cool down.
- Rest the charger for at least 15 minutes between charging sessions.
- If no battery pack is inserted into the charger and the charger is connected to mains, the charging status LED illuminates red.



NOTE: Always fully charge the two batteries at the same time to maximize the cutting time and performance.

Checking battery capacity

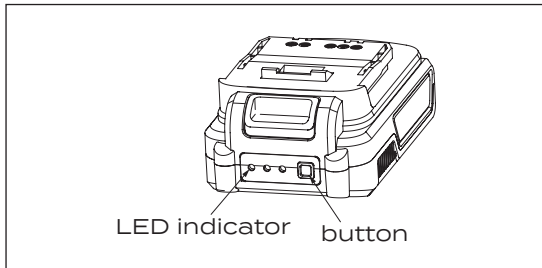

- Press the battery capacity level button to check the charging level of the battery pack. The status / remaining charge will be shown on the battery capacity level indicator light.

Battery charging level indicators	Battery capacity
●○○□	≤ 35% and need to be charged
●●○□	35-65%
●●●■	≥ 65%

Charge the battery pack before operating when it is at medium or low battery charging level.

Preparation

Charging

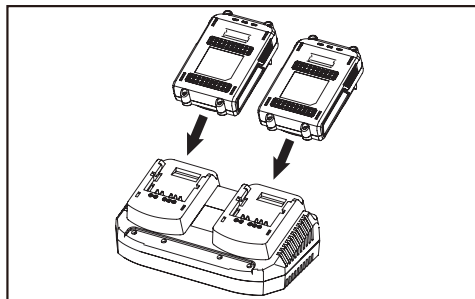

1. Connect the battery pack to the battery charger.
2. Insert the mains plug into the socket. The green charging status LED light will flash. Once the battery pack is completely charged, the green charging status LED is lit continuously, indicating that the charging process is complete.
3. Disconnect the charger from the mains and remove the battery pack from the charger.

LED Light on charger (Red & Green)	Charger Status
● ○	Charger standby
○ ☀	Battery pack charging
○ ●	Battery pack fully charged
☀ ☀	Battery pack defect
● ●	Battery pack too cold or warm

75 minutes (charge 1 battery only), 150 minutes (charge 2 batteries together).

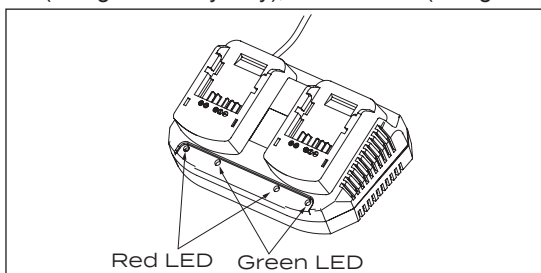

Note! It is not recommended to charge the battery pack immediately after using the machine. The battery pack should be cooled for a period of time.

Note! There will be different charging time for different capacity of the battery pack.

Preparation

Install the battery pack

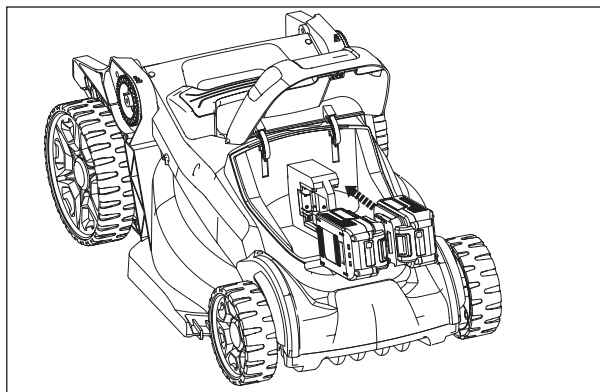

Align the battery pack with its compartment on the lawn mower. Push the battery pack into the compartment until you hear a click. This means the battery pack has been locked in position, then close the battery pack compartment cover.

Removing the battery pack from the lawn mower

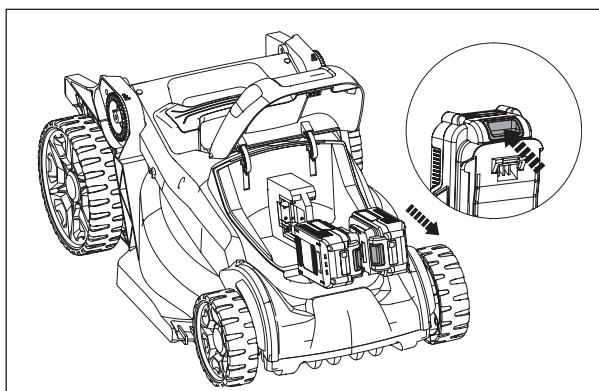

Open the battery pack compartment cover. Press the battery pack release button on the battery pack, then pull the battery pack out.

Preparation

Setting the cutting height



NOTE: The original cutting height was set to the lowest level in the packing box. Please set to the suitable height for your lawn.

If you wish to change the cutting height, you need to hold the carry handle and push the adjusting button up and down to select desired cutting height.

The number on the height bar aligning on the motor housing shows the cutting height position.

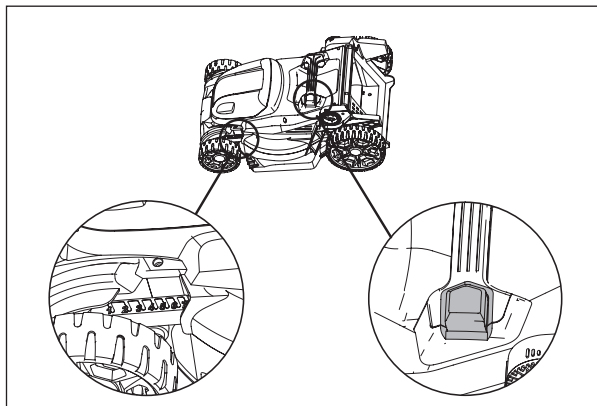

Level	Cutting height(mm)
1	25
2	33
3	41
4	49
5	57
6	65
7	75



WARNING!

Never operate the cutting height adjustment button roughly.

Operation

Switching on/off

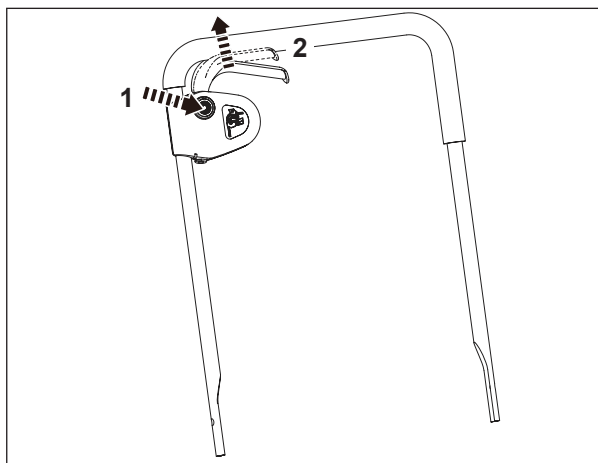

Switching on/off

Switch on:

1. Press and hold the safety button on the side of the switch box with one hand.
2. Pull the switch lever towards the handle and hold it with the other hand.
3. Release the safety button.

Switch off:

Release the switch lever.

Operation

Operating the lawn mower



WARNING!

Ensure the battery pack is disconnected from the mower before making any adjustment, cleaning and maintenance.

Operation on a slope:

Slopes increase the risk of slip-and-fall accidents, which can result in severe injury. Always be sure of your footing on slopes. Operation on slopes requires extra caution. If you feel uneasy on a slope, do not mow it.

Do:

- Mow across the face of slopes, never mow up and down. Exercise extreme caution when changing direction on slopes.
- Watch for holes, ruts, rocks, hidden objects or bumps which could cause you to slip or trip. Tall grass can hide obstacles.

Do not:

- Do not mow near drop-offs, ditches or embankments; you could lose your footing or balance.
- For safety reasons, do not use the mower on gradients exceeding 15°.
- Do not mow on wet grass. Unstable footing could cause you to slip.

This mower is equipped with a roller underneath for creating a stripe after mowing your lawn.

Operation

Mower overload protection

To prevent overload conditions, do not try to cut too much grass at one time. Slow down your cutting pace or raise the cutting height. Your mower has built-in overload circuit protection. When the mower is overloaded, the mower will stop. Switch the mower off and check to see if grass has collected beneath the deck and clear it if necessary, then restart the mower.

Battery high temperature protection

The battery pack will generate heat during operation. The heat dissipates slower in hot weather. If the battery temperature exceeds more than 70°C during operation, the protection circuit will immediately turn off the mower to protect the battery pack from damage. Release the switch bar, wait until the battery pack cools down and then restart the mower.

Function of full indicator

If the grass bag is empty or it is not filled with full grass, the grass full indicator will be open.

If the grass bag is filled with full grass, the grass full indicator will be closed.

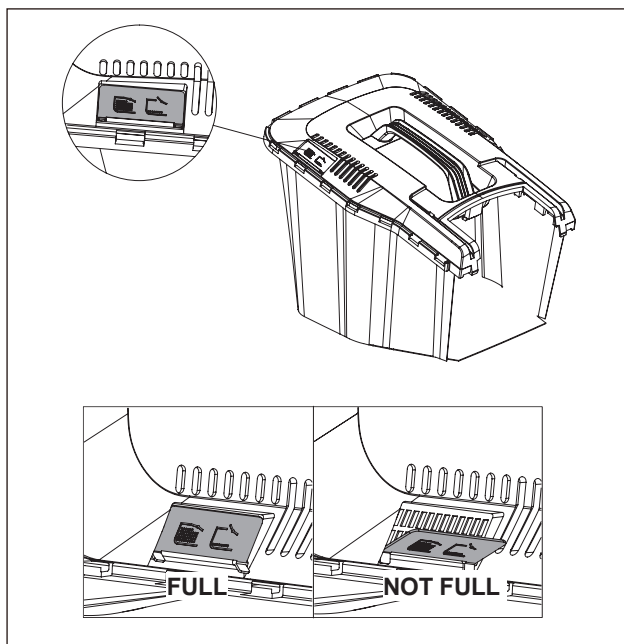

Operation

Emptying the grass bag

As soon as the grass bag indicator closes while you are mowing, it is time to empty the grass bag. Lift the deflector guard with one hand and remove the grass bag. Release the deflector guard and then empty the grass bag.

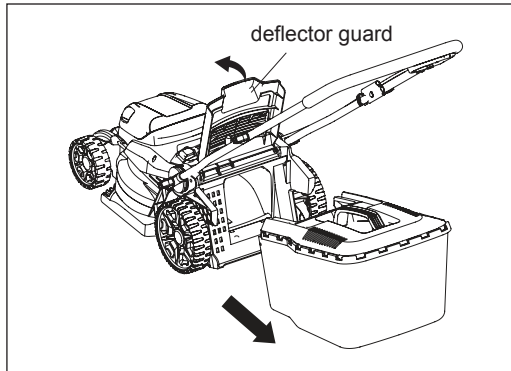

NOTE:

Before removing the grass bag, switch off the mower, disconnect the battery pack and wait until the blade has come to a complete stop.

To take off the grass bag, use one hand to lift up the safety flap and the other to grab on to the carry handle of the grass bag. The safety flap automatically falls down after removing the grass bag and closes off the rear chute opening. Empty out the grass bag then refit to the mower.



NOTE:

If any grass residue is caught in the discharge chute, clean it using a brush. Do not remove grass debris in the mower casing or on the blade by hand or with your feet. Instead, use suitable tools, such as a brush or broom. To ensure that the cut grass can be collected into the grass bag, the discharge opening and inside the mower casing must be cleared of any blockages.

Maintenance and Storage



WARNING!

Before performing any maintenance or cleaning work, always ensure that the battery pack have been removed. Wait until the blade has stopped completely and the machine has cooled down.

Cleaning the product

- Use a soft brush to remove accumulated dust and debris. Wear safety glasses to protect your eyes whilst cleaning.
- Wipe down the product enclosure with a slightly damp cloth. Do not spray the unit with water. Water may destroy the switch unit and the electric motor.

Maintenance



WARNING!

Always wear gardening gloves when working with sharp blades.

1. Keep all nuts, bolts and screws tight to ensure that the machine is in a safe working condition.
2. Check the grass bag frequently for wear or deterioration.
3. Examine the machine and replace worn or damaged parts for safety.

Removing/installing the blade

1. Use the correct size wrench to uninstall the blade bolt nut.
2. Wearing heavy gloves, hold the blade still and turn the wrench anti-clockwise to remove the bolt.
3. Fit the replacement blade correctly with marks facing up and align the pegs, refit the bolt and retighten securely to torque 20N.m.

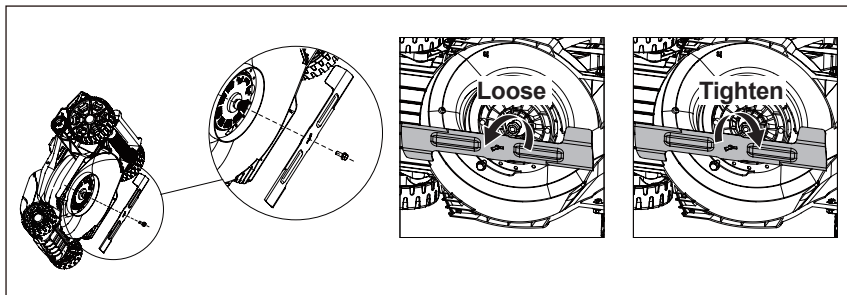

Maintenance and Storage

Maintenance



WARNING!

Replace or re-sharpen the mower blade at the end of the season. Always have the mower blade re-sharpened or replaced by a recommended service centre.

Unbalanced blades will cause the lawn mower to vibrate violently, which can increase the risk of accidents occurring.

Battery maintenance:

Use the following procedures to achieve the best battery life:

1. Protect the battery against moisture and water.
2. Store the battery only within temperature range of 5°C to 45°C. Do not leave the battery in direct sunlight for extended periods of time.
3. Clean the battery regularly with a soft, clean and dry brush.
4. If you do not use the product for a long time, remember to charge and discharge the battery pack once every 6 months.

Storage and transport

Storage

After cleaning the unit thoroughly, store the lawn mower in a dry room and allow the motor to cool down.

To reduce storage space, the lawn mower can be folded.

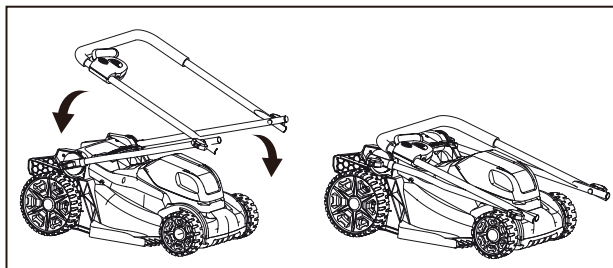

1. Loosen the quick-release lock system on the handles.
2. Fold the handles.



WARNING! Remove the battery packs. Ensure cables are not trapped when folding/unfolding the handle. If stored vertically, make sure the mower is positioned in a corner so that the blade is facing inwards against a wall, and the lawn mower is secure to prevent it falling over.

Maintenance and Storage

Storage and transport

Transport

Use the original packaging to ship whenever possible.

Consumable parts

Part Number	Part Name
1057312000	Grass bag
1252774000	Blade

Troubleshooting

Troubleshooting



WARNING!

Before performing any repair work, ensure that the battery pack has been removed.



WARNING!

Always wear heavy-duty gloves when adjusting or cleaning, especially when handling sharp objects.

Fault/malfunction	Cause	Remedy
Mower fails to start	Battery is not correctly inserted	Remove the battery and reinsert
	Mower standing in high grass	Start motor on shorter grass or already mowed area, change cutting height if necessary
	The mower housing is clogged	Clean housing so that the blade can move freely
	Battery has no power	Check and recharge battery
Mower stops working /loses power	Cutting height is incorrect	Adjust the cutting height
	Cutting blade is worn or damaged	Replace with new blade
	Battery performance decreasing	Check the battery performance and charge if necessary
Grass bag is not filled sufficiently	Cutting height is too low	Adjust cutting height
	The lawn / grass is wet	Allow the lawn to dry
	Underside of the mower deck is clogged	Clean the underside of the mower deck
	Cutting blade is worn or damaged	Replace cutting blade

Troubleshooting

Troubleshooting

Mower vibrating at higher speed	Cutting blade is unbalanced	Balance the blade by grinding each cutting edge until equal
	Blade is loosened /incorrectly fitted	Tighten the blade bolt
Mower cuts unevenly	The blade is damaged	Sharpen the blade or replace
	Blade is assembled incorrectly	Re-assemble blade correctly

Technical data

Technical Data Table

Model no.	MCLLM3637
Nominal voltage	36V \equiv (2X18V)
No-load cutting speed	3000/min
Cutting width	37cm
Cutting height	25-75mm, 7 positions
Capacity of grass bag	40l
Weight	15.2kg
Moisture resistance protection degree	IPX1
Measured sound pressure level(L_{pA})	76.9dB(A), K=3dB(A)
Measured sound power level(L_{wA})	88.50dB(A), K=0.85dB(A)
Guaranteed sound power level	96dB(A)
Vibrations	0.412 (<2.5) m/s ² K=1.5m/s ²
Battery pack model	B0P-SP06-20ZH
Battery capacity	18V(Max.20V) \equiv 5.0Ah
Fully charging time	approx. 150 minutes for 2 batteries together
Battery pack quantity	2pcs
Battery charger model	B0Q-SP07-2040ZB
Input	220-240V~, 50/60Hz 120W
Output	21V \equiv 4A
Insulation protection class	II

The sound values have been determined according to noise test code given in EN IEC 62841-4-3, using the basic standards ISO 11094 and EN ISO 3744.

The sound intensity level for the operator may exceed 80dB(A) and ear protection measures are necessary.

The declared vibration value has been measured in accordance with a standard test method (according to EN IEC 62841-4-3) and may be used for comparing one product with another. The declared vibration value may also be used in a preliminary assessment of exposure.



WARNING: The vibration emission during actual use of the machine can differ from the declared total value depending on the ways in which the machine is used.

There is the need to identify safety measures to protect the operator that are based on an estimation of exposure in the actual conditions of use (taking account of all parts of the operating cycle such as the times when the machine is switched off and when it is running idle in addition to the trigger time).

Recycling and Disposal

Recycling and disposal



The product comes in a package that protects it against damage during shipping. Keep the packaging until you are sure that all parts have been delivered and the product is functioning properly. Recycle the packaging afterwards.

Old products are potentially recyclable and do not, therefore, belong in your household waste. You are requested to assist us and our contribution to saving resources and protecting the environment by handing this product at an equipped collection centre.

Getting Help

Customer Helpline 0345 605 2062

Our dedicated UK based customer service centre is open 7 days a week to assist you with assembly, parts queries and technical support. We are open during office hours. Our experts are here to get you back enjoying your garden in no time.

Calling our service does not affect your statutory rights.

UK/N.I. 0345 605 2062

Guarantee

Dear Customer,

In the unlikely event that your device develops a fault, please contact our Customer service department on the telephone number shown below.

1. These guarantee terms cover additional guarantee rights and do not affect your statutory warranty rights. Claims must be accompanied by Proof of Purchase. This must be in the form of a Sales receipt or Bank statement and must show that the product has been purchased within 2 year prior to the claim, from the retailer that it was originally sold to.

2. Our guarantee covers problems caused by material or manufacturing defects, and will result in the repair of these defects or replacement of the device with a like for like or similar article. Please note that our devices have not been designed for use in commercial, trade or industrial applications. Consequently, the guarantee is invalidated if the equipment is used in commercial, trade or industrial applications or for other equivalent activities.

3. The following are also excluded from our guarantee:

A. Faults due to accidents, customer misuse or unauthorised repairs

B. Consumable parts such as shoulder strap, blade cover and other accessories that are compatible with the product.

C. Failure due to lack of routine maintenance.

D. Failure as a result of not using the equipment in accordance with the manual and safety instructions

E. The adjustment of chargers, or battery packs

4. The guarantee is valid for a period of 2 year starting from the purchase date of the device. Guarantee claims should be submitted before the end of the guarantee period within two weeks of the defect being noticed. No guarantee claims will be accepted after the end of the guarantee period. The original guarantee period remains applicable to the device even if repairs are carried out or parts are replaced. In such cases, the work performed or parts fitted will not result in an extension of the guarantee period, and no new guarantee will become active for the work performed or parts fitted. This also applies when an on-site Service is used.

5. Please keep your sales receipt in a safe place. If the defect is covered by our guarantee your device will either be repaired under the terms of guarantee or we will send you a replacement device. This device may be re-conditioned or like for like replacement.