

ELECTRIC FAN

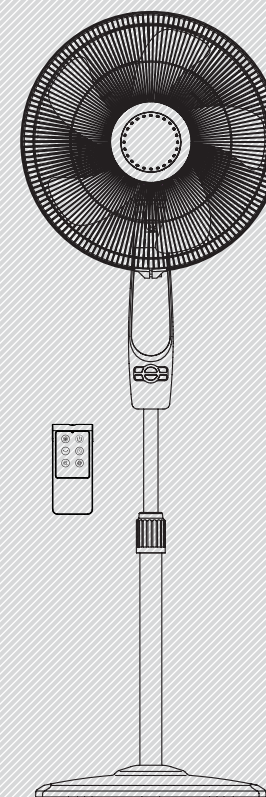

OWNER'S MANUAL

STAND FAN

MODEL: FS40-10AR

READ AND SAVE THESE INSTRUCTIONS

Attention: Pictures in the IM are for reference only.

GD Midea Environment Appliances MFG.Co.,Ltd.
No.28, Dong Fu Road, Hesui East Industrial Area, Dong Feng Town,
Zhongshan, Guangdong 528425 P.R.China

CAUTION

Read Rules for Safe Operation and Instructions Carefully.

WARNING

1. If the supply cord is damaged, it must be replaced by manufacturer or its service agent or a similarly qualified person in order to avoid a hazard.
2. Indoor use only.
3. To protect against the risk of electrical shock, do not immerse the unit, cord or plug in water or other liquid.
4. This appliance is not intended for use by persons (including children) with reduced physical, sensory or mental capabilities, or lack of experience and knowledge, unless they have been given supervision or instruction concerning use of the appliance by a person responsible for their safety. Young children should be supervised to ensure that they do not play with the appliance.
5. When the appliance is not in use and before cleaning, unplug the appliance from the outlet.
6. Keep electrical appliances out of reach from Children or infirm persons. Do not let them use the appliances without supervision.
7. When the fan was assembled, the rotor blade guard shall not be taken off anymore
 - Prior cleaning unplug the fan
 - The rotor guard shall not be disassembled/opened to clean the rotor blades.
 - Wipe the fan enclosure and rotor blade guard with a slightly damp cloth.

RULES FOR SAFE OPERATION

1. Never insert fingers, pencils, or any other object through the grill when fan is running.
2. Disconnect fan when moving from one location to another.
3. Be sure fan is on a stable surface when operating to avoid overturning.
4. DO NOT use fan in window, rain may create electrical hazard.
5. Indoor use only.

PART FIGURE

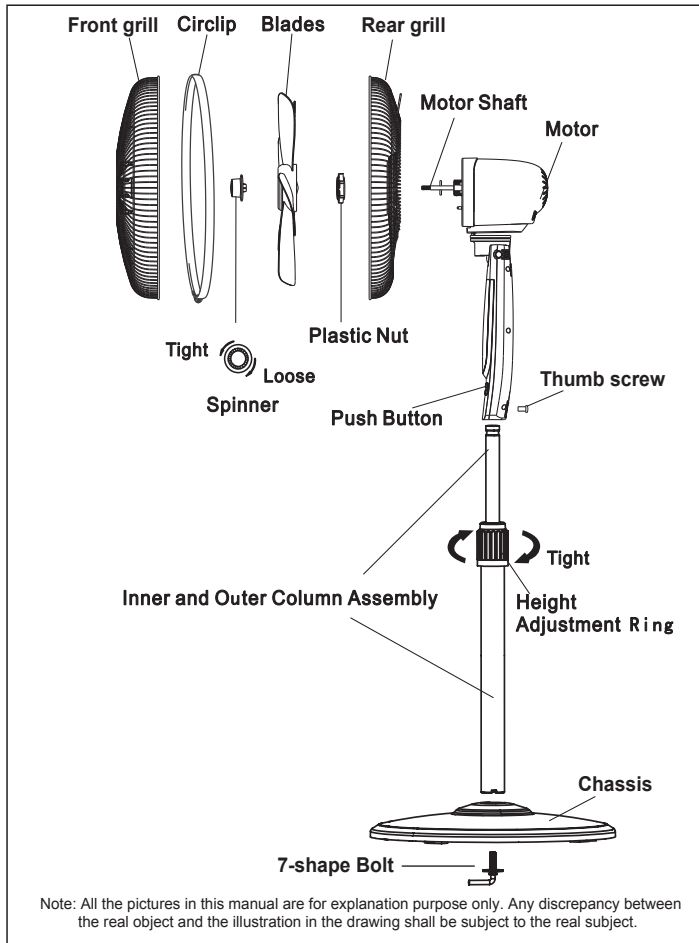

ASSEMBLY OF BASE & COLUMN UNIT

1. Unscrew the 7-shape Bolt from the Extension Pole. (Fig.1)
2. Insert the extension pole in the base and tighten the 7-shape Bolt. (Fig.2)
3. From the extension pole loosen the height adjustment ring and adjust the internal pipe to the desired height. (Note: If you can't find the internal pole, it slides inside the extension pole. You can pull it out from the extension pole.) (Fig.3)
4. To attach the head unit to the extension pole, loosen the thumb screw on the bottom of the head unit. Place the head unit on the extension pole and tighten the thumb screw in alignment with the groove on the internal pole. (Fig.4)

CAUTION: Height adjustment ring must be fully fastened before the assembly of the motor section to the extension pole.

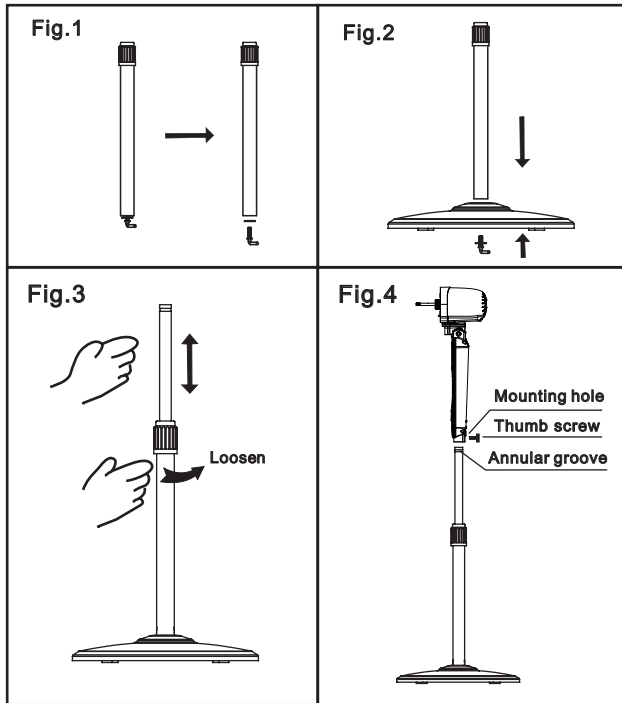

GRILL & FAN BLADE ASSEMBLY

1. Unscrew the spinner clockwise (or take the spinner out from the bag) and the plastic nut counterclockwise to remove both of them. Fix the rear grill to the motor then tighten the plastic nut again. (Fig. 5)
2. Insert the blade into shaft, and make sure the rotor shaft pin is fitted into groove of the blade. Turn the spinner counterclockwise to tighten the blade. (Fig. 6)
3. Fasten the front grill and the rear grill by the grill clip and then tighten the fan grill locking screw and nut. (Fig. 7)

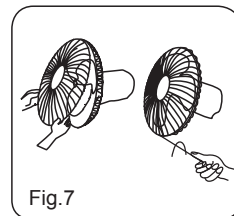
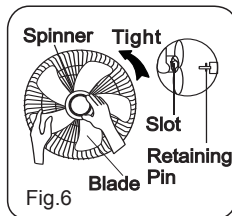
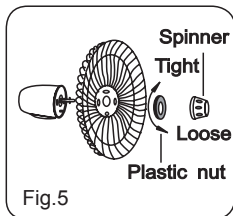



OPERATING INSTRUCTION

I. Remote Controller (Fig.8)

a. KEY INSTRUCTION

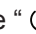
1. “” ON/OFF KEY

The “” key is for switching on the fan .The fan will be started at breeze step.

Press the “” key if the fan needs to switch off.

2. “” SPEED KEY

When the fan started, press this key repeated, the fan will work with “1-2-3-4-5-6” circulatory.

3. “” MODE KEY

Press this key to select mode. The sequence is normal, natural and sleep when this key being touched repeatedly or continuously. The light can indicate mode state.

Normal wind

Press the “mode” key to select the normal wind, then press the “speed” repeatedly to choose 8 speed.

Natural wind

Press the “mode” key to select the natural wind, then press the “speed” repeatedly to choose 3 speed.

Sleep wind

Press the “mode” key to select the sleep wind, then press the “speed” repeatedly to choose 2 speed.

4. “” OSC/LOUVER KEY

After the fan has started, press this key to select oscillation mode. The sequence is wiggly, fluctuating, eight-rock and fixedly. The lights on the display can indicate fan oscillation mode.

5. “” TIMING KEY

When the fan is in the stand by mode after the power line is plugged in, press the key to switch the fan to the appointment mode. When this key is pressed repeatedly, appointment time will be subject to the cyclic change in the order of “0.5h-1h-...-7h-7.5h-0h-0.5h...”. Meanwhile, corresponding indicators will be on. Time indicator will extinguish in turn as the time pass by.

When the appointment time is over, the fan will automatically work at the normal air mode with the level 1 speed.

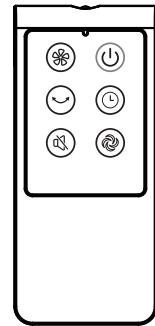

Fig.8

When the fan is working, press this key to preset the time of turning off. When this key is pressed repeatedly, the time will be subject to the cyclic change in the order of “0.5h-1h-...-7h-7.5h-0h-0.5h...”. Meanwhile, corresponding indicator will be on. Time indicators will extinguish in turn as the time pass by. When the preset time is over, the fan will be switched off automatically.

6. “” SILENCE KEY

Press this key to activate the silent feature. Wind type and speed setting buttons will not work on this function. Press the button again to deactivate the silent feature

b. BATTERIES

(battery not included in the packing)

- (1) Slide the battery compartment Cover.
- (2) Insert the batteries, and make sure that the batteries are placed as shown in the Fig.9.
- (3) Slide back the battery cover.

NOTES: Use size “AAA” manganese or alkaline batteries. Do not use rechargeable batteries.

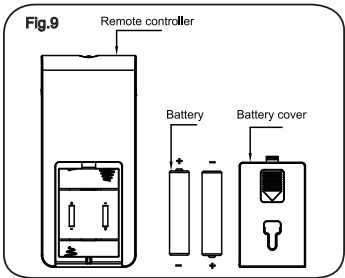

c. BATTERY WARNING AS BELOW

1. “Do not dispose of batteries in fire, batteries may explode or leak.”
2. -Do not mix old and new batteries.
3. -Do not mix alkaline, standard (carbon-zinc) or rechargeable (nickel-cadmium) batteries.

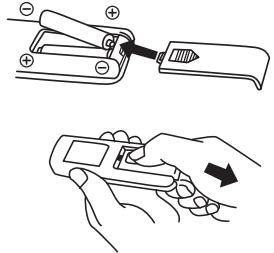

d. REMOTE CONTROLLER OPERATION

Point the remote controller at the receptor on body of the fan and press the desired button. The remote controller will work at distances of up to roughly five meters and the angle of 30 degree included between right and left from the receptor. The batteries must be removed from the remote controller before it is scrapped and that they are disposed of safely.

e. OVERHEAT PROTECTION OF THE MOTOR

The windings of the motor have a thermal-fuse that burns out and the fan switches off and temperature of the motor is no longer going up so that plastic parts of the fan don't subject to deformation so far so to be burned by the overheat if the motor is overheat for any unexpected reason.

II. Buttons on fan body (Fig.10) / Panel indication (Fig.11)

The buttons on the body such as air speed, on/off, air mode, mute, appointment/timer, oscillation have the same functions as those of the corresponding keys on the remote controller.

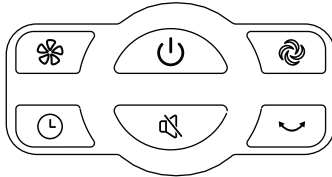

Fig.10



Fig.11

III. Height adjustment

Turn the outer joint to adjust the inner/outer upright post tube to the proper height, and then tighten the outer joint. (Fig.3)

IV. Pitching air supply

When adjusting the upward or downward air supply of the fan, it is allowed to slightly lift or press the nose or grill for adjustment.

MAINTENANCE INSTRUCTION

The fan requires little maintenance. Do not try to fix it by yourself. Refer it to qualified service personnel if service is needed.

1. Before cleaning and assembling, fan must be unplugged.
2. To ensure adequate air circulation to the motor, keep vents at the rear of the motor free of dust. Do not disassemble the fan to remove dust.
3. Please wipe the exterior parts with a soft cloth soaking a mild detergent.
4. Do not use any abrasive detergent or solvents to avoid scratching the surface.
Do not use any of the following as a cleaner: gasoline, thinner.
5. Do not allow water or any other liquid into the motor housing or interior parts.

CLEANING

1. Be sure to unplug from the electrical supply source before cleaning.
2. Plastic parts should be cleaned with a soft cloth moisten with mild soap.
Thoroughly remove soap film with dry cloth.

DISPOSAL: Do not dispose of electrical appliances as unsorted municipal waste, use separate collection facilities. Contact your local government for information regarding the collection systems available. If electrical appliances are disposed of in landfills or dumps, hazardous substances can leak into the groundwater and get into the food chain, damaging your health and well-being.

