



## PRODUCT GUARANTEE

This product is guaranteed against manufacturing defects for a period of



This product is guaranteed for twelve months from the date of original purchase. Any defect that arises due to faulty materials or workmanship will either be replaced, refunded or repaired free of charge where possible during this period by the dealer from whom you purchased the unit.

The guarantee is subject to the following provisions:

- The guarantee does not cover accidental damage, misuse, cabinet parts, knobs or consumable items.
- The product must be correctly installed and operated in accordance with the instructions contained in this manual.
- It must be used solely for domestic purpose.
- The guarantee will be rendered invalid if the product is re-sold or has been damaged by inexpert repair.
- Specifications are subject to change without notice.
- The manufacturer disclaims any liability for the incidental or consequential damages.
- The guarantee is in addition to, and does not diminish your statutory or legal rights.

Guarantor: Argos Ltd  
489 - 499 Avebury Boulevard  
Central Milton Keynes  
MK9 2NW

# ProAction

Instruction Manual - Please keep for future reference

## Proaction 12V Pets Handheld



# HR878 A

# IMPORTANT SAFETY INSTRUCTIONS

**Read all instruction before use and keep for future reference.**

## Location

- Do not use or keep the appliance outside.
- Do not store the appliance near hot ovens or heating appliances.  
Store the appliance inside in a dry environment away from accidental damage.

## Children

- Children do not understand the dangers associated with operating electrical appliances. Never allow children to use this appliance.



## Other safety considerations

- User must read and understand instructions prior to using this product. Use as described in this manual. Use manufacturer's original accessories ONLY.
- Follow all label and marking instructions on your Vacuum Cleaner.
- Do not use or recharge the vacuum cleaner, outdoors.
- Do not pick up anything that is burning or smoking, such as cigarettes, matches, or hot ashes. Fire Risk!
- Do not use the vacuum to pick up, flammable or combustible liquids.
- Do not use in an area, where dangerous items are stored.
- Do not handle or use the vacuum or battery charging Adapter with wet hands.
- Do not use the vacuum, while it is plugged into a mains socket.
- Do not use the vacuum without the filter in place.
- While vacuuming; do not block the air-intake, or the exhaust vents of the vacuum. Otherwise, the motor will overheat and could become damaged.
- Be careful, keep all parts of body (hair, fingers and clothing etc...) away from moving parts and openings.
- Keep the air-intake (nozzle), exhaust vents, crevice tool and brush away from your face and body 'loose clothing'.
- Be careful when cleaning stairs
- Do not use if the charger plug or lead is damaged
- Plug the charging unit directly into a mains wall socket. do not use an extension lead
- Store the vacuum (indoors) properly after use to avoid accidents
- This vacuum includes rechargeable cells. Do not incinerate cells or expose to high temperatures as they may blow up. Personal injury Risk!
- If the Battery Pack is removed, please make sure that it is neither in the vicinity of strong heat, nor in area with high risk of short circuit.
- Use only the attachment and charging adapter supplied by the manufacturer.
- Do not continue to use this vacuum if it appears to be malfunctioned.
- If the vacuum malfunctions, or is damaged in any way it should be returned to a qualified service engineer for repair
- Do not apply lubricants to the motor of the Vacuum Cleaner
- Leaks from Batteries: it could happen under extreme environments. If the liquid which is 20-35% solution of potassium hydroxide leaks and, if the liquids get on skin, you should wash immediately with mild soap and water, or neutralise the areas with lemon juice or vinegar. seek medical treatment immediately
- If the Battery Leaks get into eyes, you should flush them at once with clean running water and seek medical treatment immediately
- The vacuum is not a toy, keep away from children
- Close attention is necessary when used near children
- Do not abuse the charger cord. Never carry the charger or base by the cord or yank to disconnect from an outlet instead grasp the plug and pull to disconnect
- Keep charger cord away from heated surfaces
- Do not put any object into openings. do not use with any opening blocked; keep free of dust, lint, hair and anything that may reduce air flow
- Do not attempt to use the charger with any product nor attempt to charge this product with another charger, use only charger supplied with this appliance
- The appliance must be disconnected from the supply when removing the battery
- This appliance is not intended for used by persons (include children) with reduced physical, sensory or mental capabilities, or lack of experience and knowledge unless they have been given supervision concerning use of the appliances by a person responsible for their safety.
- Children should be supervised to ensure that they do not play with the appliance

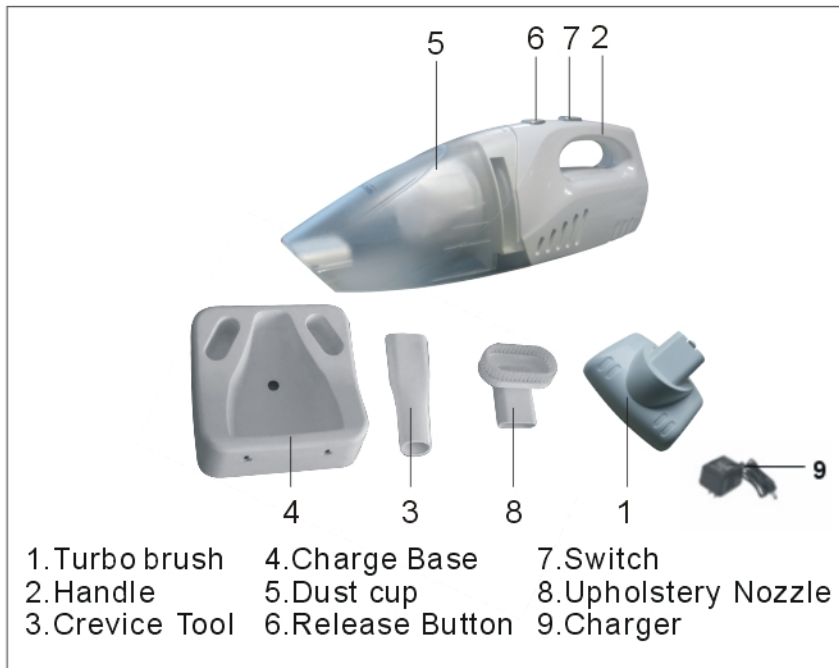

Product Specifications: (FOR INDOORS USE ONLY)	
Rechargeable Handheld Vacuum Cleaner	Model No. :HR878 A
Motor	12 Volt DC
Switch	On/Off
Adapter (Charger) Rating	230-240V 50Hz, AC only
Adapter (Charger) Voltage	12 V DC 200mA
Charging Rate	16 hours
Battery Pack	1.2-Volt X10 Ni-MhCells

## Setting up the vacuum

1. Install wall Bracket (see below-Wall Bracket Fitting Instructions).

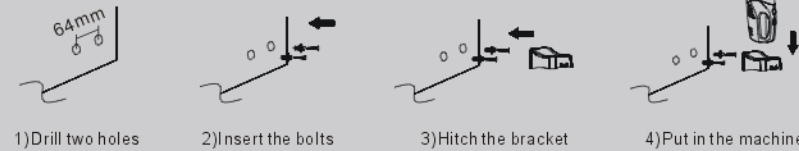

2. Slide the Vacuum onto the Wall Bracket. Make sure the Recharging Pin of the Charger and the Recharging Socket of the Vacuum is connected.

3. Plug in the charger The pilot light will illuminate to indicate that the vacuum cleaner is being charged it is recommend to charge the vacuum cleaner for 16 hours after each use. Before the 1st use ,please charge the vacuum cleaner for 16 hours.

4. A fully charged battery-pack will give approximately 8 minutes cleaning time. It is normal that the charging will get warm while charging.

## Mounting the wall bracket

1. Before drilling any holes ensure that their position is away from hidden cables and pipes.

2. Ensure the wall is sound and support the vacuum cleaner and bracket plus the reasonable down force involved when inserting and removing the vacuum cleaner.

3. Choose a mounting location away from heat and damp and out of easy reach of children.

4. There should be at least 300mm of free space above and 130mm below the bracket to facilitate storage and removal of vacuum cleaner.

## Storage /Charging Location:

1. Extreme weather (too hot or too cold ) is dangerous and not good for the battery do not charge the battery in temperatures above 37°C, or below 0°C.

2. Keep away from heat sources. Garages ,workshops and indoor areas are the ideal .storage/Charging places for the vacuum.

3. Do not store the vacuum in areas with high temperature ,or in the trunk of your car ,while it is parked underneath direct hot sunshine.

## Operate:

1. Lift and remove the vacuum from the bracket and push the on/off switch forward. The vacuum cleaner will start to work.

2. The vacuum cleaner will be switched off when you pull the on/off switch backward.

3. To pick up the solids vacuum in any direction until the area is clean.

4. If you like , you may use the crevice tool .upholstery nozzle fit if into the mouth of the dust container.

5. Empty the container before doing any more vacuuming and cleaning it before putting it away.

6. Replace the cleaner on the bracket .the pilot light will come on to indicate that the cleaner is being charged.

**This Vacuum Cleaner is intended for normal household use only**

## Cleaning the filter

- The dust container should be emptied and cleaned after each use.
- To clean the dust container, Hold the vacuum in a vertical position, with the intake mouth pointing down.
- Press the release button and pull the dust container gently out.
- Empty the container. If you like, you may wash it with soap and water and then dry it.
- Refit the filter into the dust container.
- If damaged, replace it with a new one.
- Then refit the dust container and place the cleaner on the bracket.
- Wipe the outside of the cleaner with a dry cloth. DO not clean the unit with paint thinner or chemical solution and this will damage the unit.

## Dust container Removal:

- Dirt in the dust cup should be emptied after each use.
- Hold vacuum cleaner vertically with the air-intake (nozzle end) pointing downward to avoid spillage.
- Press the release button in top of the vacuum cleaner and release the Dust Container.
- Remove the Filter Bracket from the Dust Container.
- Empty, wash, wipe and dry the interior of the Dust Container.

## Using the Cleaning Attachments:

The Crevice tool, upholstery nozzle, turbo brush are provided for your usage.

- Ensure to turn off the vacuum cleaner.
- Fit the crevice tool into the mouth of dust container for cleaning of cracks and corners.
- Fit the turbo brush into the mouth of dust container for picking-up dirt.
- Fit the upholstery nozzle into the mouth of the dust container for cleaning upholstery, curtains, etc.

TROUBLESHOOTING		
PROBLEM	POSSIBLE CAUSE	POSSIBLE ANSWER
Unit won't work	1. Battery is not charged 2. The vacuum is not fixed well to the bracket	1. Charge for at least 16 hours 2. Take out the vacuum and refit to the bracket
Low or No Suction power	A. Weak Battery B. Dust container full C. Filter is clogged	a) Recharge the Battery b) Empty dust container c) Clean Filter or replace by new one
Dust Leaking from the Unit	I. Dust container full II. Dust container does not completely refit to the unit	i. Empty dust container ii. Reassemble the unit by aligning both halves of the unit, and lightly fit into place. The Release button will lock on the dust container to the main body.

The NI-MH batteries in this handheld have a nominal service life of many years. When the batteries eventually expire they should be removed from the handheld for recycling. Please contact your local solid waste authority for recycling information.

- **Always dispose of batteries safely.**
- **Never dispose of batteries in fire**
- **Never try to dismantle batteries.**
- **Never short circuit batteries.**

To remove the batteries

- Unscrew and disassemble the handheld.
- Pull out the batteries.
- Disconnect the battery terminals from the handheld's internal wiring.
- Cover the battery terminals with 'NON' conductive tape such as packing or insulation tape to prevent accidental short circuit of the battery terminals and place the batteries in a strong plastic bag.
- Take your batteries to your local recycling station.

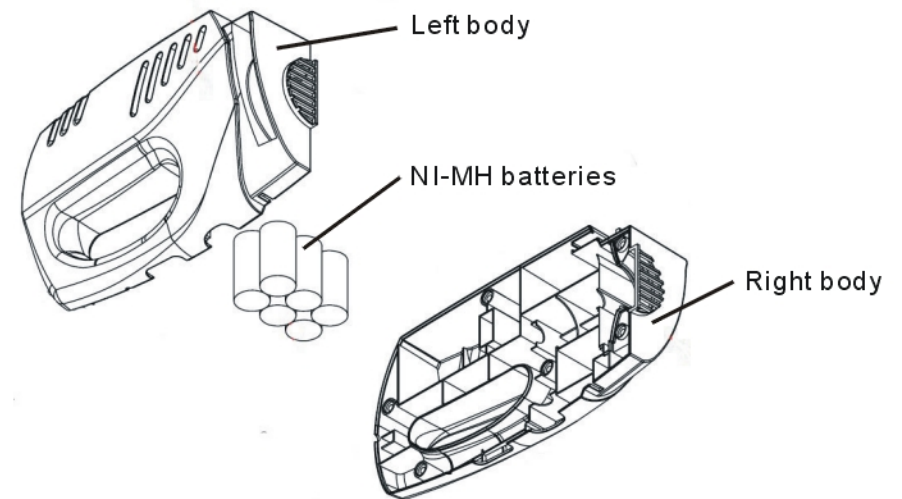

# IMPORTANT

- This vacuum is a 'Super Spot cleaning Master'; it is not designed for the purpose of lengthy or massive cleaning.
- Recommendation-For efficient cleaning, please keep the usage time to no more than 8 minutes each time.
- Before First Use-Charge your vacuum for at least 16 hours.
- Do not over charge the battery.
- It is recommended that the dust cup filter be replaced every six months to ensure the performance of unit.
- CAUTION: The air-vent must be open and free of any obstructions at all times. Otherwise, the motor will overheat and damaged.
- It is recommended that the Dust Container and Filter must be cleaned and dried completely after each use.
- The vacuum cleaner is a powerful unit, make sure that you hold it firmly, otherwise it can slip out of your hand and cause injury.
- IMPORTANT: to maintain peak performance of your vacuum cleaner, it is recommended that the unit be fully discharged, then completely re-charged for 16 hours once a month.
- Use only with the battery pack supplied with the unit.
- Do not attempt to remove the battery pack from the unit to charge it.
- Never attempt to throw the battery pack or unit into a fire or incinerate it.
- Do not attempt to remove or damage the battery casing.
- Battery must be recycled or disposed of properly at the end of its service life.
- Do not use ordinary batteries for replacement, as these may leak and damage your vacuum cleaner, and personal injury RISK!
- If the Rechargeable battery is leaking, stop using the product and disconnect from main supply immediately. Return to service centre for repair or dispose at an official waster collection site. Remove the battery before disposal. Wash your hand after touch the leak battery.
- Do not use the appliance to pick up liquids, it is dry only.



## WARNING:

**This appliance is not intended for used by persons (including children) with reduced physical, sensory or mental capabilities, or lack of experience and knowledge, unless they have been given supervision or instruction concerning use of the appliances by a person responsible for their safety.**

**Children should be supervised to ensure that they do not play with the appliance.**

## PROACTION CUSTOMER HELPLINE AND FOR SPARES

Please contact 01733 404711



WASTE ELECTRICAL PRODUCTS SHOULD NOT BE DISPOSED OF WITH HOUSEHOLD WASTE. PLEASE RECYCLE WHERE FACILITIES EXIST CHECK WITH YOUR LOCAL AUTHORITY FOR RECYCLING ADVICE