

INSTRUCTION MANUAL

HITACHI
Inspire the Next

TV Soundbar

AXS030BTU

346/3424



Important - Please read these instructions fully before installing or operating and keep for future reference.

These instructions contain important information which will help you get the best from your Soundbar and ensure safe and correct installation and operation.

For and help concerning set up and use of your TV

Please call the Customer Helpline: 0345 604 0105

Lines open: 9am - 8pm Monday to Saturday and 10am - 4pm Sunday

Contents

Some Dos and Don'ts on the Safe Use of Equipment	4
Safety Warnings.....	6
Support	8
Unpacking.....	9
Product Overview	10
Front View	10
Top View	10
Bottom View.....	10
Remote Control.....	11
Remove the plastic strip from the remote control.....	11
Inserting new batteries and replacing old batteries for the Remote Control.....	11
Handling the Battery.....	12
Handling the Remote Control	12
Remote Control Operation Range.....	12
Connections	13
Using the AUX 1 Connection.....	13
Using the AUX 2 Connection.....	13
Using the Bluetooth Connection.....	13
Using the Optical Connection.....	14
Using the COAXIAL Connection.....	14
Connecting to the Mains Supply.....	15
General Operation.....	15
Selecting Modes.....	15
Special Operation.....	16
Compound keys on the Unit.....	16
Maintenance	16
Cleaning the Unit	16
Hints and Tips	17
Specifications.....	17
Notes for battery disposal.....	18
Guarantee	19
Contact Us	20

SOME DOS AND DON'TS ON THE SAFE USE OF EQUIPMENT

This equipment has been designed and manufactured to meet international safety standards but, like any electrical equipment, care must be taken if you are to obtain the best results and safety is to be assured.

.....

- DO read the operating instructions before you attempt to use the equipment.
- DO ensure that all electrical connections (including the mains plug, extension leads and inter-connections between the pieces of equipment) are properly made and in accordance with the manufacturer's instructions. Switch off and withdraw the mains plug before making or changing connections.
- DO consult your dealer if you are ever in doubt about the installation, operation or safety of your equipment.
- DO be careful with glass panels or doors on the equipment.
- DO route the mains lead so that it is not likely to be walked on, crushed, chafed, or subjected to excessive wear and tear or heat.

.....

- DON'T remove any fixed cover as this may expose dangerous voltages.
- DON'T obstruct the ventilation openings of the equipment with items such as newspapers, tablecloths, curtains, etc. Overheating will cause damage and shorten the life of the equipment.
- DON'T allow electrical equipment to be exposed to dripping or splashing, or objects filled with liquids, such as vases.
- DON'T place hot objects or naked flame sources such as lighted candles or nightlights on, or close, to equipment. High temperatures can melt plastic and lead to fires.
- DON'T use makeshift stands and NEVER fix legs with wooden screws. To ensure complete safety always fit the manufacturer's approved stand or legs with the fixings provided and according to the instructions.
- DON'T use equipment such as personal stereos or radios that will distract you from the requirements of traffic safety.
- DON'T adjust the volume of the headphones which can be connected to any device with the equipment to be too high and use that for an extended period, it can damage hearing.
- DON'T leave equipment switched on when it is unattended unless it is specifically stated that is designed for unattended operation or has a stand-by mode. Switch off using the ON/OFF switch on the equipment or at the mains socket, and make sure that your family knows how to do this. Special arrangements may need to be made for infirm or handicapped people.
- DON'T continue to operate the equipment if you are in any doubt about it working normally, or if it is damaged in any way – switch off, remove the mains plug from the mains socket and consult your dealer.

.....

ABOVE ALL

- NEVER let anyone especially children push anything into holes, slots or any other opening in the equipment – this could result in a fatal electric shock.
- NEVER guess or take chances with electrical equipment of any kind. It is better to be safe than sorry!

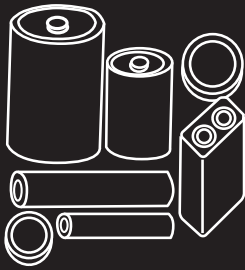

BATTERY SAFETY GUIDELINES

Used correctly, domestic batteries are a safe and dependable source of portable power. Problems can occur if they are misused or abused – resulting in leakage or, in extreme cases, fire or explosion. Here are some simple guidelines to safe battery use designed to eliminate any such problems.



Take care to fit your batteries correctly, observing the plus and minus marks on the battery and appliance. Incorrect fitting can cause leakage or, in extreme cases, fire or even an explosion.

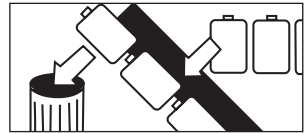

Replace the whole set of batteries at one time, taking care not to mix old and new batteries or batteries of different types, since this can result in leakage or, in extreme cases, fire or even an explosion.



Store unused batteries in their packaging and away from metal objects which may cause a short-circuit resulting in leakage or, in extreme cases, fire or even an explosion.



Remove dead batteries from equipment and all batteries from equipment you know you are not going to use for a long time. Otherwise the batteries may leak and cause damage.

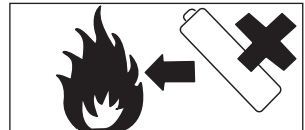

Never dispose of batteries in fire as this can cause them to explode. Please recycle dead batteries; do not put with the normal household waste.



Never attempt to recharge ordinary batteries, either in a charger or by applying heat to them. They may leak, cause fire or even explode. There are special rechargeable batteries which are clearly marked as such.



Supervise children if they are replacing batteries themselves in order to ensure these guidelines are followed.

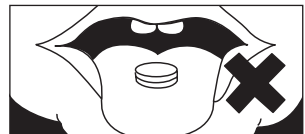

Remember that small button cell batteries such as used in some hearing aids, toys, games and other appliances, are easily swallowed by young children and this can be dangerous.



Keep loose button cells away from young children.



Make sure battery compartments are secure.

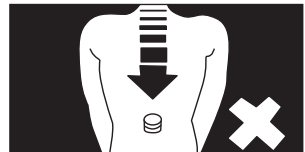

Seek medical advice if you believe a cell has been swallowed.

Safety Warnings

- Read all the instructions carefully before using the unit and keep them for future reference.
- Retain the manual. If you pass the unit onto a third party make sure to include this manual.
- Check that the voltage marked on the rating label matches your mains voltage.

Damage

- Please inspect the unit for damage after unpacking.
- Do not continue to operate the unit if you are in any doubt about it working normally, or if it is damaged in any way - switch off, withdraw the mains plug and consult your dealer.

Location of Unit

- The unit must be placed on a flat stable surface and should not be subjected to vibrations.
- Do not place the unit on sloped or unstable surfaces as the unit may fall off or tip over.
- The mains socket must be located near the unit and should be easily accessible.

Temperature

- Avoid extreme degrees of temperature, either hot or cold. Place the unit well away from heat sources such as radiators or gas/ electric fires.
- Avoid exposure to direct sunlight and other sources of heat.

Naked Flames

- Never place any type of candle or naked flame on the top of or near the unit.

Moisture

- To reduce the risk of fire, electric shock or product damage, do not expose this unit to rain, moisture, dripping or splashing. No objects filled with liquids, such as vases, should be placed on the unit.
- If you spill any liquid into the unit, it can cause serious damage. Switch it off at the mains immediately. Withdraw the mains plug and consult your dealer.

Ventilation

- To prevent the risk of electric shock or fire hazard due to overheating, ensure that curtains and other materials do not obstruct the ventilation vents.
- Do not install or place this unit in a bookcase, built-in cabinet or in another confined space. Ensure the unit is well ventilated.

Safety

- Always disconnect the unit from the mains supply before connecting/ disconnecting other devices or moving the unit.
- Unplug the unit from the mains socket before a lightning storm.

Mains Adapter

- The mains adapter will continue to draw electricity from the mains supply when plugged in the mains socket. In the interests of safety and to avoid unnecessary energy consumption, never leave the adapter plugged in the mains socket while unattended for long periods of time. Disconnect the adapter from the power supply.

Mains Adapter Cable

- Make sure the unit or unit stand is not resting on top of the mains adapter cable, as the weight of the unit may damage the cable and create a safety hazard.

Interference

- Do not place the unit on or near appliances which may cause electromagnetic interference. If you do, it may adversely affect the operating performance of the unit, and cause a distorted picture or sound.

Batteries

- Batteries used in the remote control for this unit are easily swallowed by young children and this is dangerous.
- Please dispose of batteries correctly by following the guidance in this manual.

Supervision

- Children should be supervised to ensure that they do not play with the unit and the remote control.
- Never let anyone especially children push anything into the holes, slots or any other openings in the case - this could result in a fatal electric shock.



The lightning flash with arrowhead symbol, within an equilateral triangle, is intended to alert the user to the presence of uninsulated “dangerous voltage” within the unit’s enclosure that may be of sufficient magnitude to constitute a risk of electric shock.



The exclamation point within an equilateral triangle is intended to alert the user to the presence of important operating and maintenance (servicing) instructions in the manual accompanying the unit.

Service

- To reduce the risk of electric shock, do not remove screws. The unit does not contain any user-serviceable parts. Please leave all maintenance work to qualified personnel.
- Do not open any fixed covers as this may expose dangerous voltages.

Maintenance

- Ensure the unit is fully unplugged from the power supply before cleaning.
 - Do not use any type of abrasive pad or abrasive cleaning solutions as these may damage the unit’s surface.
 - Do not use liquids to clean the unit.
-
- No naked flame sources, such as lighted candles, should be placed on the apparatus.

Technical experts are available 7 days a week

- **Simple help and advice on setting up your digital equipment (image).**
- **Guidance on connecting other devices to your television such as a DVD player, Sky, home cinema system or a games console.**
- **Order spare parts, including that lost remote control.**
- **Any other technical issues you may need assistance with.**

Call us today: 0345 604 0105

Local call rates applies*

Lines open 9am-8pm Monday to Saturday and 10am-4pm Sunday.

*Calls to Argos enquiry lines may attract a charge and set up fee from residential lines depending on your call plan/tariff. Mobile and other providers costs may vary, see www.bt.com/pricing for details.

For Security and training purposes, telephone calls to and from customer service centres maybe recorded and monitored. Calls from Republic of Ireland will attract international call charges.

Thank you for purchasing your new HITACHI Soundbar.

We recommend that you spend some time reading this instruction manual so that you fully understand all the operational features it offers. You will also find some hints and tips to help you resolve any issues.

Read all the safety instructions carefully before use and keep this instruction manual for future reference.

Unpacking

Remove all items from the packaging. Retain the packaging. If you dispose of it please do so according to local regulations.

The following items are included:



Sound Bar

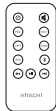

Remote Control



3.5-RCA Cable



Power Cable



Power Adapter



Instruction Manual

Product Overview

Front View

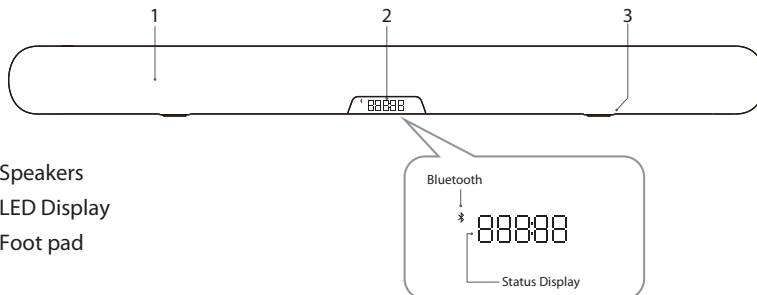

Top View

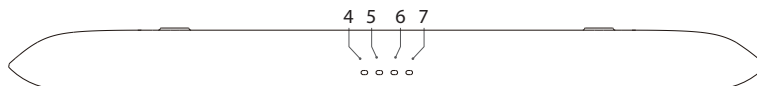

- 4. **⏻** Button
Switches the unit between **ON** and **STANDBY** modes.
- 5. **MODE** Button
Selects the input source.
- 6. **VOL -** Button
Decreases the volume.
- 7. **VOL +** Button
Increases the volume.

Bottom View

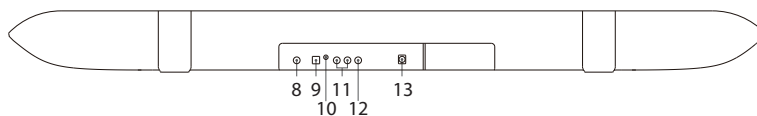

- 8. **COAXIAL** Socket
- 9. **OPTICAL** Socket
- 10. **INPUT 2** Socket
- 11. **INPUT 1** Socket
- 12. **SUB OUT** Socket
- 13. **DC** Socket

Remote Control

1. **⏻** button
Switches the unit between **ON** and **STANDBY** modes.
2. **Mute** button mutes ON or OFF.
3. **VOL-** button short press reduces the volume, long press reduces continue to reduce the volume.
4. **VOL+** button short press increases the volume, long press increases continue to increase the volume.
5. **OPT** button allows user to select the **OPTICAL** channel.
6. **COAX** button allows user to select the **COAXIAL** channel.
7. **AUX** button allows the user to select the **AUX1** or **AUX2**
8. **📶** button allows the user to select the **BLUETOOTH** source and activate pairing mode.
9. **⏮** Skip to the previous track in **BT** mode.
10. **⏭** Skip forwards to the next track in **BT** mode.
11. **▶** Play / pause / resume playback in **BT** mode.

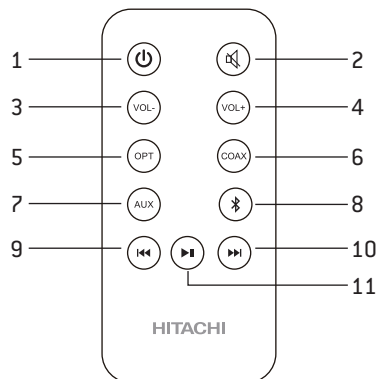

Remove the Plastic Strip from the Remote Control

Remove the plastic strip from the battery if the battery is being used for the first time. It is located at the bottom rear of the remote control.

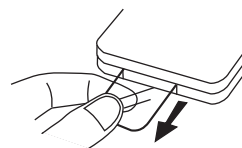

Inserting new batteries and replacing old batteries for the Remote Control

The remote control requires a CR2025, 3V Lithium battery.

1. Slide and hold the battery release tab in the direction of the arrow.
2. Pull out the battery holder and remove the old battery.

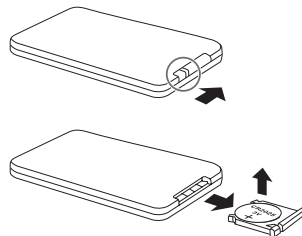

3. Replace with a new battery.
4. Insert the battery holder back into the remote control.

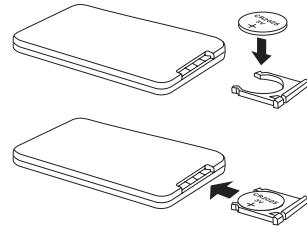

Handling the Battery

- Improper or incorrect use of batteries may cause corrosion or battery leakage, which could cause fire, personal injury or damage to property.
- Install the batteries correctly in the battery compartment.
- Use only the battery type indicated in this manual.
- Do not dispose of the used battery as domestic waste. Dispose of it accordance with local regulations.

Handling the Remote Control

- Take care of your fingernails when you slide and pull the battery release tab.
- Do not drop the remote control.
- Do not allow anything to impact the remote control.
- Do not spill water or liquid on the remote control.
- Do not place the remote control on a wet object.
- Do not place the remote control under direct sunlight or near sources of excessive heat.
- Remove the battery from the remote control when not in use for a long period of time, as corrosion or battery leakage may occur and result in physical injury, and/or property damage, and/or fire.
- When the battery is exhausted, the remote control will not function.

Remote Control Operation Range

- The remote control sensor on the front unit is sensitive to the remote control's commands up to a maximum of 5 metres away and within a maximum of a 60° arc.
- Please note that the operating distance may vary depending on the brightness of the room.

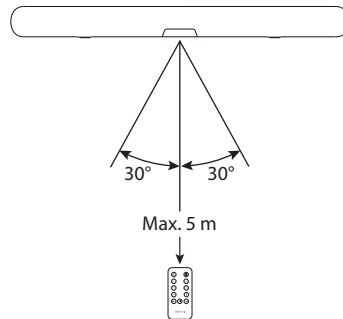

Connections

Using the AUX 1 Connection

Use a 3.5mm to phono stereo audio cable (included) to connect the TV's audio output sockets to the soundbar's **AUX1 (L/R)** sockets, turn on the unit and go to **AUX 1(Phono)** mode.

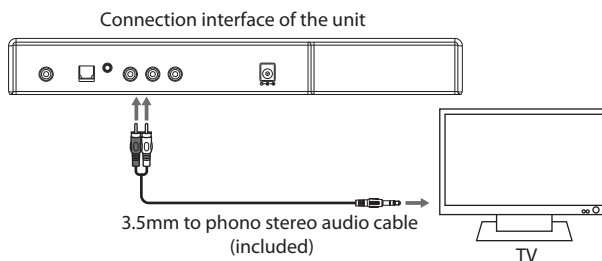

Using the AUX 2 Connection

Use a 3.5mm to phono stereo audio cable (included) to connect the TV's audio output sockets to the soundbar's **AUX 2** socket, then turn on the unit and go to **AUX 2 (3.5)** mode.

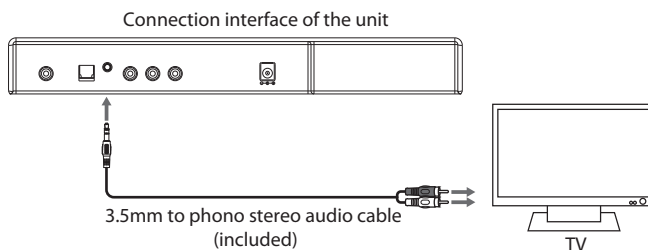

Using the Bluetooth Connection

Connecting Your Mobile Device:

Turn on the unit and go to **BT** mode (Make sure the mobile device you want to connect to the unit is close by).

For first time your installation, press and hold the **INPUT** button on unit (or the **BT** button on remote control) for 5 seconds to enter the Pairing Mode (The **BT** icon will flash).

Open the **BT** interface on your mobile device, find the unit ID: AXS030BTU, and connect to it, the **BT** icon on unit will stop flashing and light on to indicate a successful connection.

If your device has already been connected to the unit before, then they will always automatically connect when they are both in **BT** mode.

Disconnecting Your Mobile Device:

Press and hold the **Input** button on unit (or the **BT** button on remote control) for 5 seconds, your mobile device is disconnected, the **BT** icon will flash and other mobile device can connect to it.



NOTE: The BT ID for the unit is AXS030BTU.

Using the OPTICAL Connection

Use an optical cable (not included) to connect the DVD's **OPTICAL OUT** socket to the soundbar's **OPTICAL** socket, then turn on the unit and go to **OPTICAL** mode.

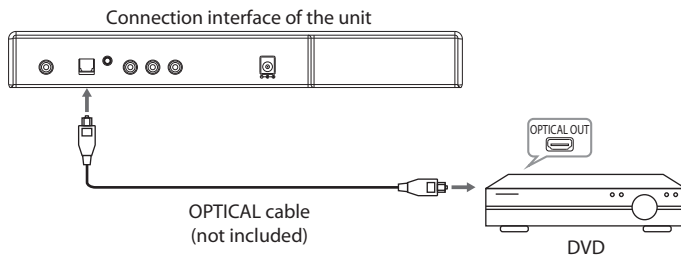

Using the COAXIAL Connection

Use a COAXIAL cable (not included) to connect the DVD's **COAXIAL OUT** socket to the soundbar's **COAXIAL** socket, then turn on the unit and go to **COAXIAL** mode.

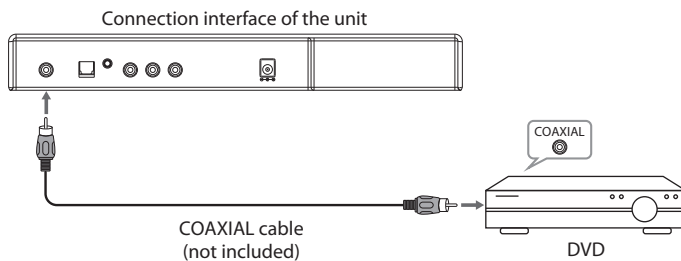

Connecting to the Mains Supply

- This unit is designed to operate with the provided mains adapter.
- Connecting the unit to any other power source may damage the unit. Connect the power plug and adapter which are attached in the package, then connect the DC plug to the unit 24V DC in, then connect the power plug to mains socket.
- To switch the unit off completely, unplug the mains adapter from the mains socket.

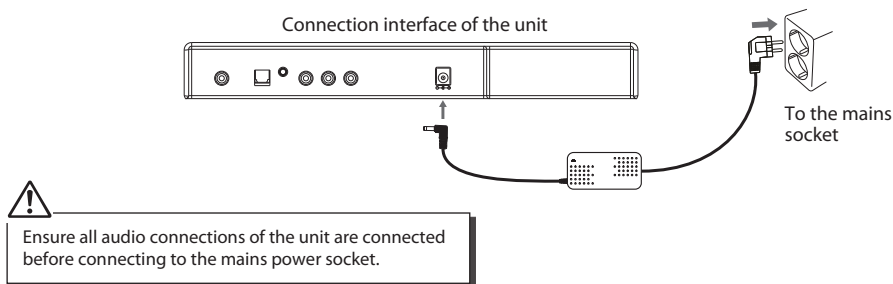

General Operation

When you first connect the unit to the mains socket, the unit will be in **STANDBY** mode.

- Press the ψ button on the unit or the remote control to switch the unit to **ON** mode. The LED display will light up.
- Press the ψ button to switch the unit back to **STANDBY** mode. The LED display will turn off.
- Disconnect the power plug from the mains socket if you want to switch the unit off completely.



When the unit is idle for approximately 10 minutes, it will automatically switch to Standby mode.

Selecting Modes

Press the **MODE** button on the unit or the remote control to cycle between following modes:

AUX1(Phono) → AUX2(3.5) → BT → OPTICAL → COAXIAL → AUX 1 (Phono) →



AUX 1 is set as the default mode for first time use. When you turn on the unit next time, it will automatically go to the mode which you have selected from last time.

Special Operations

Compound keys on the Unit

VOL- & VOL+: Hold down the VOL- & VOL+ at the same time for 5 seconds to mute or un-mute the unit;

VOL- & VOL+ & POWER: Hold down VOL- & VOL+ & POWER at the same time for 5 seconds to reset the unit.

Maintenance

Cleaning the Unit



Ensure the unit is fully unplugged from the mains socket before cleaning.

- To clean the unit, wipe the case with a slightly moist, lint-free cloth.
- Do not use any cleaning fluids containing alcohol, ammonia or abrasives.
- Do not spray aerosol at or near the unit.

Hints and Tips

If a problem occurs, it may often be due to something very minor. The following table contains various tips:

Problem	Solution
No power.	<ul style="list-style-type: none">• Ensure the mains adapter is connected securely at both ends.• Make sure that the ON mode is selected.
The remote control is not functioning.	<ul style="list-style-type: none">• Use the remote control near the unit.• Point the remote control at the remote sensor on the unit.• Replace the battery in the remote control with a new one.• Remove any obstacles between the remote control and the unit.
Loud hum or noise is heard.	<ul style="list-style-type: none">• The plugs and sockets are dirty. Wipe them with a cloth slightly moistened with an appropriate non-abrasive cleaning solution.



If any functional abnormality is encountered, unplug the unit from the mains socket and reconnect it again.

Specifications

Model	AXS030BTU
Mains Adapter	Adaptor Model Name: S065AQ2400270; Input: AC 100-240V~50/60Hz 1800mA; Output: DC 24V, 2.7A; Manufacturer: Ten Pao Industrial Co.,Ltd.
Power Consumption	60W
Speaker Output Power	2 x 30W RMS @ 3%THD
Net Weight	3.5kg
Dimension	1064mm(W) x 86mm(D) x 98mm(H)

Features and specifications are subject to change without prior notice.

Notes for battery disposal

The batteries used with this product contain chemicals that are harmful to the environment. To preserve our environment, dispose of used batteries according to your local laws or regulations. Do not dispose of batteries with normal household waste.

For more information, please contact the local authority or your retailer where you purchased the product.

Warning: The batteries shall not to be exposed to excessive heat such as sunshine, fire or the like.



The above mark is in compliance with the Waste Electrical and Electronic Equipment Directive 2002/96/EC (WEEE).

The mark indicates the requirement NOT to dispose the equipment including any spent or discarded batteries as unsorted municipal waste, but use the return and collection systems available. If the batteries or accumulators included with this equipment display the chemical symbol Hg, Cd or Pb, then it means that the battery has a heavy metal content of more than 0.0005% Mercury, or more than 0.002% Cadmium or more than, 0.004% Lead.

In the unlikely event of a problem developing, please contact the store where you purchased your equipment.

We continually strive to improve our products; specifications may change without prior notice. For advice on where to purchase accessories, please contact the store where you purchased your equipment.

All trademarks are the property of their respective owners and all rights are acknowledged.



Product Guarantee

This product is guaranteed against manufacturing defects for a period of



This product is guaranteed for twelve months from the date of original purchase. Any defect that arises due to faulty materials or workmanship will either be replaced, refunded or repaired free of charge where possible during this period by the dealer from whom you purchased the unit.

The guarantee is subject to the following provisions:

- The guarantee does not cover accidental damage, misuse, cabinet parts, knobs or consumable items.
- The product must be correctly installed and operated in accordance with the instructions contained in this manual.
- It must be used solely for domestic purpose.
- The guarantee will be rendered invalid if the product is re-sold or has been damaged by inexpert repair.
- Specifications are subject to change without notice.
- The manufacturer disclaims any liability for the incidental or consequential damages.
- The guarantee is in addition to, and does not diminish your statutory or legal rights.
- In the event of a problem with the product with in the guarantee period call the **Customer Helpline: 0345 604 0105**.

Guarantor: Argos Ltd
489 - 499 Avebury Boulevard
Central Milton Keynes
MK9 2NW

HITACHI

Inspire the Next

Manufacturer:

Hitachi Europe Ltd.,
Whitebrook Park,
Lower Cookham Road,
Maidenhead,
Berkshire SL6 8YA
U.K.

Importer:

Argos Ltd.,
489 - 499 Avebury Boulevard,
Central Milton Keynes,
Buckinghamshire MK9 2NW
U.K.

www.hitachidigitalmedia.com