

## Rapid Toaster User's Manual

Please visit [www.drewandcole.com](http://www.drewandcole.com) for video instructions and cooking demonstrations.

by

**drew & cole**<sup>®</sup>

# Index

## Topic

---

Important safeguards	03
Features	08
Preparing your toaster	09
Using your toaster	10
Other features	11
Crumb tray	12
Care & maintenance	13

## Important Safeguards

**This user's manual is also available in PDF format, please contact the Customer Services Team if you wish to have one.**

If you require any more information or assistance, please contact our Customer Services Team - their opening hours are as follows:

8:00am - 7:30pm (Monday - Friday)

8:00am - 1:00pm (Saturdays and Sunday)

You can contact them between these hours on:

0344 800 0631 (UK customers)

0412 132 998 (Irish customers)

Alternatively you can send them an email on: [CustomerCare@highstreettv.com](mailto:CustomerCare@highstreettv.com)

**When using electrical appliances, basic safety precautions should always be followed including the following:**

## IMPORTANT SAFEGUARDS

### SAFETY INSTRUCTIONS

Read these instructions for use carefully before using your appliance for the first time and keep them to hand for future reference.

- This appliance is not intended for use in the following applications:
  - staff kitchens in shops, offices, and other working environments;
- This appliance is intended for household uses in places such as:
  - a farm house;

## Important Safeguards (cont...)

- by clients in hotels, motels and other residential type environments;
- bed and breakfast type environments.

### **DANGER OF ELECTRIC SHOCK!**

- This appliance can be used by children aged from 8 years and above and persons with reduced physical, sensory or mental capabilities or lack of experience and knowledge if they have been given supervision or instruction concerning use of the appliance in a safe way and understand the hazards involved. Children shall not play with the appliance. Cleaning and user maintenance shall not be made by children unless they are older than 8 and supervised.
- If the supply cord is damaged, it must be replaced by the manufacturer, its service agent or similarly qualified persons in order to avoid a hazard.
- Keep the appliance and its cord out of the reach of children less than 8 years.
- The toasters are not intended to be operated by means of an external timer or separate

## Important Safeguards (cont...)

remote control system.

- The outer surface may get hot when the appliance is operating
- The bread may burn, therefore do not use the toaster near or below combustible material, such as curtains.
- Do not touch parts other than the operating controls as the toaster can become hot during toasting.
- Unplug the toaster and allow it to cool down before cleaning it.
- Never leave the toaster unattended while it is in use!
- Enclose these instructions when you give this appliance to someone else.
- Do not let the cable run across a cooker or hot area which may damage the cable.
- Unplug after every use or if defective.
- Do not insert any objects into the toast slot.
- Only operate the toaster when it is upright.
- Connect and operate the appliance only according to the type plate specifications. Do not use if the power cord or appliance show any signs of damage.
- **WARNING** - Do not attempt to dislodge food when the appliance is plugged in and never insert cooking utensils on the into the slots. Should the food item remain blocked in the

## Important Safeguards (cont...)

toaster, remove the plug from the mains, wait for the toaster to cool down until it is safe to touch, then turn the toaster over and shake it gently.

- **WARNING** - Misuse of the appliance can cause personal injury.
- Never cover the toast slot.
- Never place bread or other items on top of the slots as this may damage the appliance and it creates a fire hazard.
- Press down the push-down lever only for toasting; never block it.
- Do not use food that may drip as it is toasted or warmed, since this is a fire hazard.
- Never immerse the appliance in water or place it in the dishwasher!
- Do not steam-clean the appliance.
- Do not use oven or grill spray for cleaning.
- Do not use near water contained in bath tubs, sinks or other containers.
- Risk of suffocation! Do not allow children to play with packaging material.
- Do not use very thin or broken slices of bread as these may become trapped and burn or catch fire.
- Do not insert (by force) foods that are too big for the slots as these may become trapped and catch fire or damage the toaster.
- **WARNING** - Do not use under cupboards.
- Ratings: 230V~50-60Hz 1600W

## Important Safeguards (cont...)

### HINTS AND TIPS:

- In order to achieve uniform browning, we recommend a minimum of 30 seconds between each toasting cycle.
- When toasting 2 slices it is recommended they are of equal size and freshness.
- Stale bread toasts more rapidly than fresh bread. Therefore the browning dial should be set at a lower setting than usual.



To avoid environmental and health problems due to hazardous substances, appliances and rechargeable and non-rechargeable batteries marked with one of these symbols must not be disposed of with unsorted municipal waste. Always dispose of electrical and electronic products and, where applicable, rechargeable and non-rechargeable batteries, at an appropriate official recycling/collection point.

# Features

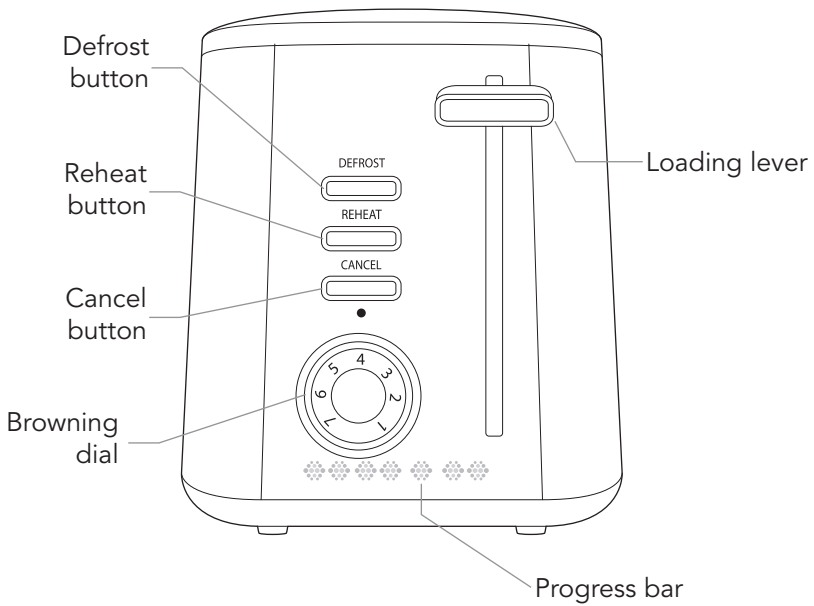
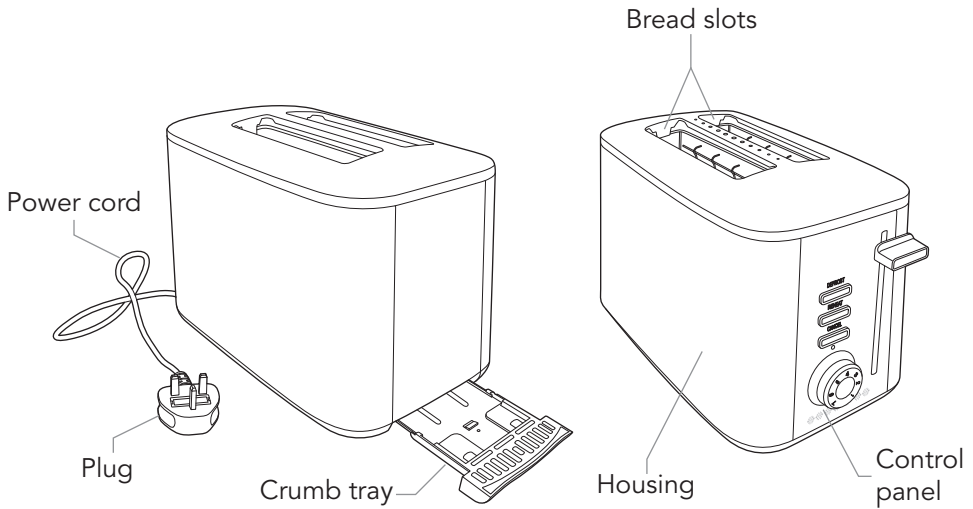



# Preparing Toaster

**Important:** Read these instructions carefully and follow them. There may be manufacturing residue or oil remaining inside your toaster or its heating element. This may emit a “new” smell when you first use your toaster. This is normal and will not occur after several uses. Please follow the steps below.

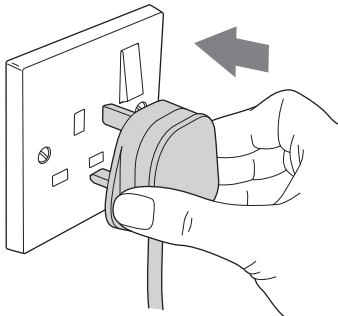

Place your toaster on a stable, level and heat resistant surface.

Slot the plug into a mains socket and turn the power on at the socket if required.

Check there is adequate clearance around and above your toaster to allow sufficient air circulation.

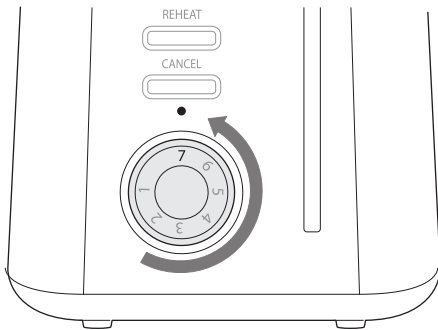

Set the browning dial to maximum, number 7.

**NOTE:** Ensure the bread slots are empty.

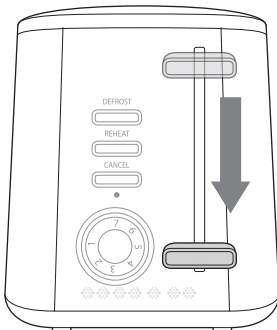

Push the loading lever down until it locks in place.

When the toasting cycle is completed and the loading lever pops back up, allow the toaster to cool, then repeat process until the “new” smell is no longer emitted. Your toaster is ready for use.

# Using Your Toaster

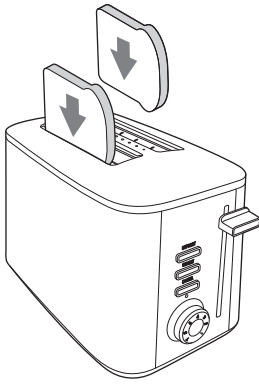

Check that the crumb tray at the back of your toaster is fully inserted, then slot one or two slices of bread into the bread slots in the top of the toaster.

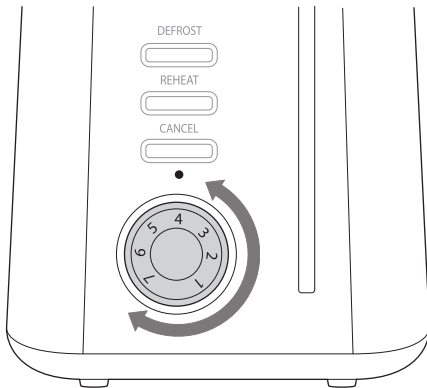

Rotate the browning dial to the desired setting.

**Reheat:** Only used to reheat toast

**1-3:** Light brown.

**4-5:** Medium brown.

**6-7:** Dark brown.

**Note:** Your toast will be darker if you are using your toaster over extended periods.

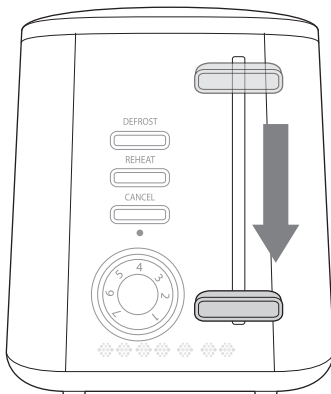

Press the loading lever down until it locks in place to begin toasting.

When your toast has finished browning the loading lever will automatically spring upwards.

Your toast is now ready to eat.

# Other Features

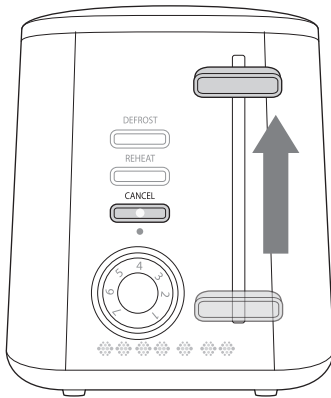

## Cancel function

You can press the cancel button at any time when using the toaster to stop the bread from burning or over browning.

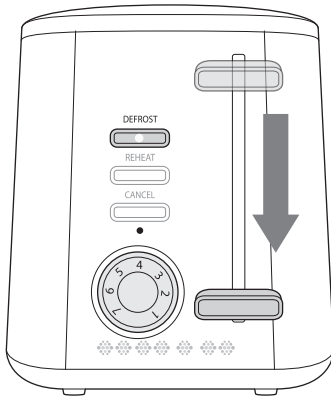

## Defrost button

Your toaster can cook bread from frozen.

1. Place the bread in the toaster.
2. Turn the browning dial to the desired setting.
3. Press the loading lever down and press the defrost button.

After selecting defrost, your toaster will automatically increase the toasting time to achieve the desired colour.

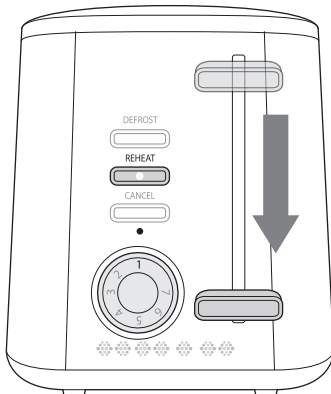

## Reheat function

You can use your toaster to reheat toast that has cooled.

1. Place the toast in your toaster.
2. Set the browning dial to 1.
3. Push the loading lever down and press the reheat button.
4. The loading lever will automatically pop up when the toasting cycle is completed.

# Crumb Tray

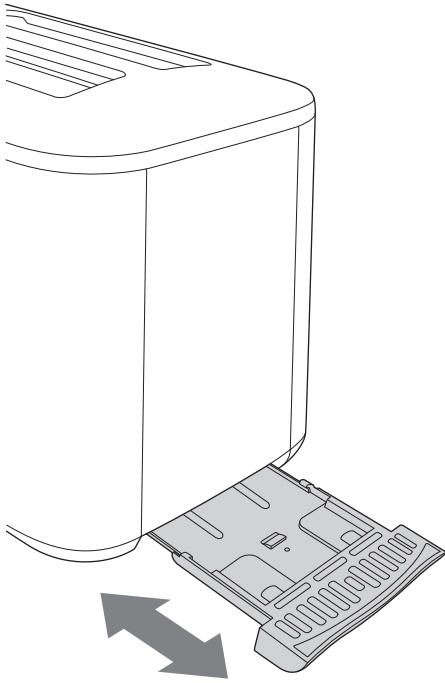

Pull out crumb tray on bottom of toaster and empty it. If toaster is used frequently.

Ideally, you should clean the crumb tray in your toaster weekly, to avoid accumulating stale crumbs which can pose a fire risk.

Make sure the crumb tray is inserted correctly to the toaster and completely closed before using the toaster again.

# Care & Maintenance

- **DISCONNECT THE TOASTER FROM OUTLET BEFORE CLEANING.**
- Wipe the outside with a soft dry cloth after toaster cools down. Never use metal polish.
- The power cord may be wound under the bottom of the toaster when not in use or for storage.
- This appliance requires little maintenance. Do not try to repair it yourself. Any servicing requiring disassembly must be performed by a qualified appliance repair technician.
- **DO NOT IMMERSE THE TOASTER IN WATER OR ANY OTHER LIQUID.**

# Notes

# Notes

# drew & cole<sup>®</sup>

SWITCHED ON LIVING

Distributed by: High Street TV,  
PO Box 724, Altrincham, WA15 5BJ  
[www.highstreettv.com](http://www.highstreettv.com)

Model Numbers:  
Charcoal & Red version: TA1408-GS  
Chrome version: TA1408A-GS

V2-08/19