

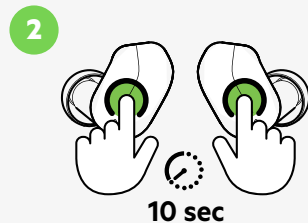

# SOUNDFORM™ True Wireless Earbuds

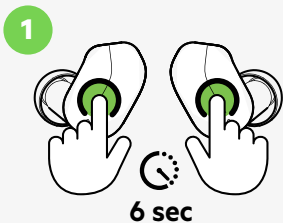
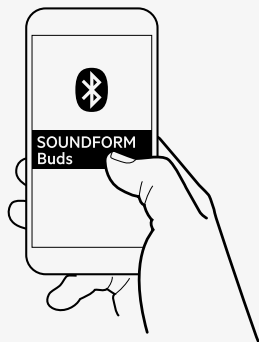
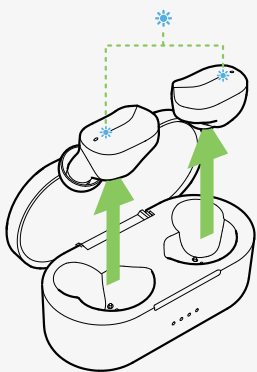

## Initial pairing

From the factory, your earbuds come in pairing mode. If you just purchased the earbuds, simply open the charging case and remove the earbuds from it. The indicator lights on the earbuds will alternate between blue and white..

**Step 1:** On your mobile device, turn ON Bluetooth to begin searching for nearby devices.

**Step 2:** When your earbuds are detected, it will show as SOUNDFORM True Wireless Earbuds. Tap on the name to complete pairing. Your earbuds will make a confirmation sound once paired.

It will also show on your phone or tablet as a paired device.

## Set your earbuds to pairing mode

**Step 1:** Ensure your earbuds are turned OFF. To do this, press on both earbuds and hold for **6 seconds** and then release.

**Step 2:** Verify that your earbuds are turned OFF, then press and hold on both earbuds for **10 seconds**. This will turn your earbuds back ON and place them into pairing mode. You can now proceed with pairing your earbuds.

## How to unpair your earbuds

Your earbuds should be turned OFF. To do this, you can do either of the two options:

- Press on both earbuds for **6 seconds**.
- Return the earbuds to the charging case and close the lid.

To unpair them, follow the instructions below:

### For Android™

**Step 1:** Go to Settings.

**Step 2:** Tap on Connections > Bluetooth.

**Step 3:** Under Paired devices, select the paired earbuds then tap Unpair.

### For iOS

**Step 1:** Go to Settings.

**Step 2:** Tap on Bluetooth.

**Step 3:** Under MY DEVICES, tap the info icon on the paired earbuds and then tap on Forget This Device.

## How to use the touch controls on the Belkin AUC002

### Audio Playback

Control	Left Earbud	Right Earbud
Volume up ( + )		Tap one time
Volume down ( - )	Tap one time	
Pause / Resume playback	Tap two times	Tap two times
Next track		Tap three times
Previous track	Tap three times	

### Call Handling

Control	Left Earbud	Right Earbud
Accept / End call	Tap two times	Tap two times
Reject call	Hold for 2 seconds	Hold for 2 seconds

### Virtual Assistants

Control	Left Earbud	Right Earbud
Activate virtual assistant	Hold for 2 seconds	Hold for 2 seconds



# SOUNDFORM™ True Wireless Earbuds

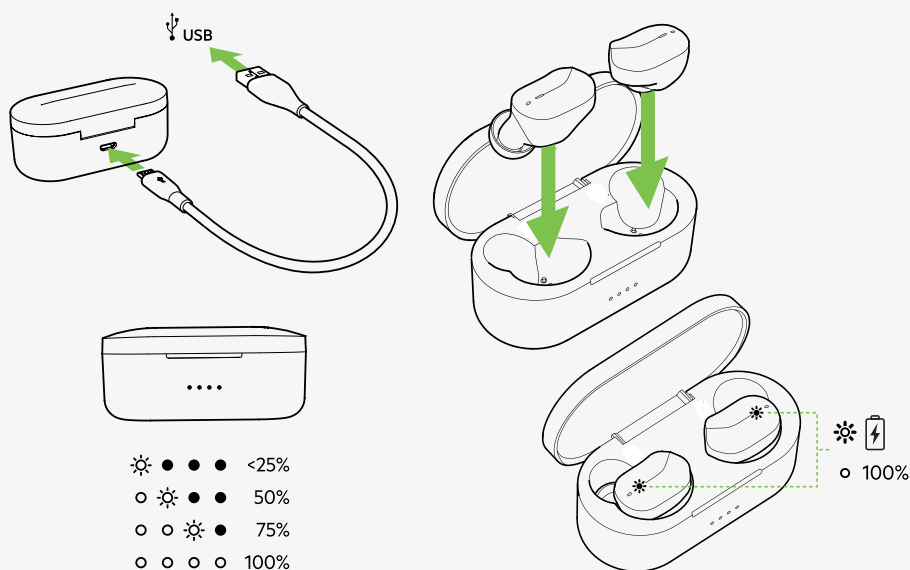

## How to charge the case and the earbuds

**Case:** Connect the micro-USB end of the connector to the back of the charging case, below the lid hinge. Connect the USB end of the connector to a power adapter or into the USB port of your computer.

**Earbuds:** To charge your earbuds, simply open the case and place each earbud in its designated slot and close the lid. If the case has battery power remaining, you do not need to plug it in while charging your earbuds.

**NOTE:** Connecting your case to a power outlet while charging the earbuds will not increase the charging speed of the earbuds.

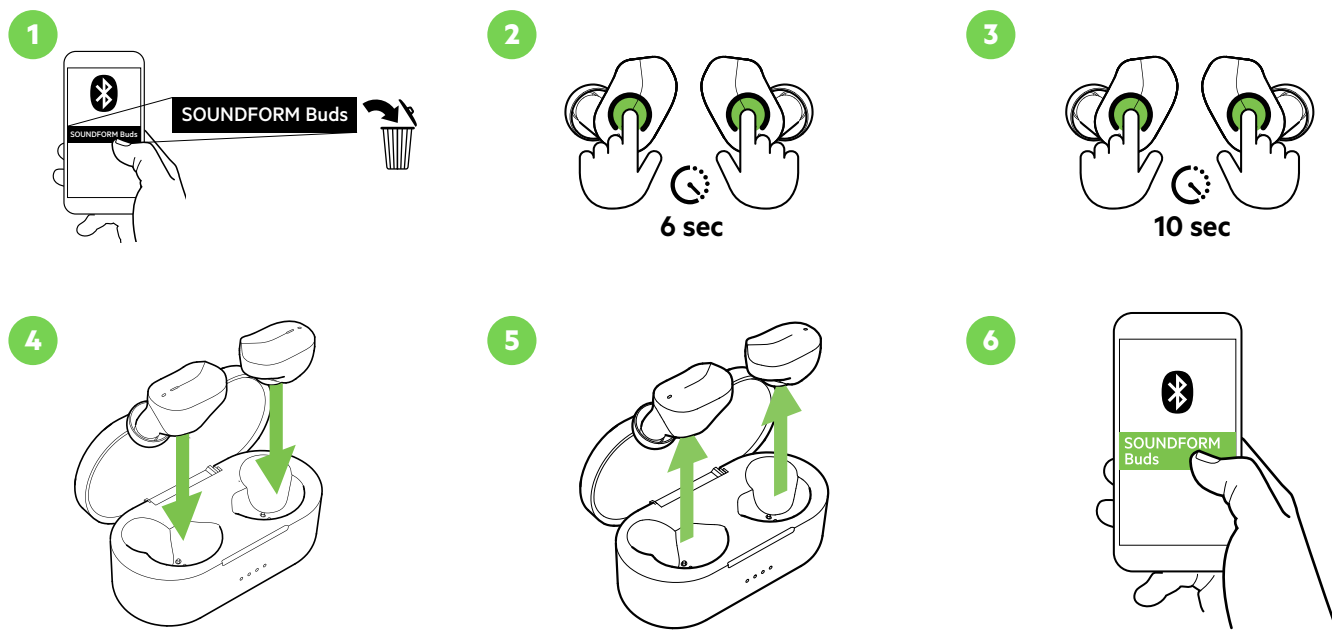

## Resetting your earbuds to factory settings

If, for instance, you are only able to pair one earbud to your phone or tablet, the best solution to this issue would be to reset your earbuds to factory settings and pair the earbuds again. Follow the step-by-step instructions below to learn how:

**Step 1:** On your phone or tablet, go to Settings and unpair the earbuds (see page 1 for instructions).

**Step 2:** Press on both earbuds simultaneously for 6 seconds to turn OFF your earbuds.

**Step 3:** Press and hold on both earbuds for 10 seconds. This will reset the device. Release when the indicator lights turn OFF.

**Step 4:** Return the earbuds to the charging case and close the lid.

**Step 5:** Open the case and take out the earbuds.

**NOTE:** It takes around 4 to 5 seconds for the left and right earbuds to connect to each other.

**Step 6:** On your mobile device, turn ON Bluetooth® to search for nearby devices, and begin pairing. Steps in enabling Bluetooth may vary depending on your device's operating system. When detected, select your earbuds from the list of Bluetooth devices. Wait for about 2 to 3 seconds for both of the earbuds' indicator lights to flash blue and turn OFF.