

TOWER[®]

over 100 YEARS of quality

T548005

TSC10 AQUAJETPLUS SPOT PRO CLEANER



3*

YEAR
GUARANTEE

SAFETY AND INSTRUCTION MANUAL **PLEASE READ CAREFULLY**

*Subject to registering your Extended Guarantee online at www.towerhousewares.co.uk.

Specifications:

This box contains:

Instruction Manual

Hose

Hose Hook

Accessory Attachments:

- Suction Nozzle
- Brush with water suction cover

1. Handle
2. ON/OFF button
3. Clean Water Bucket
4. Hose
5. Hose Hook
6. Watering Button
7. Hose Handle
8. Water Level Indicator
9. Sewage Bucket
10. Power Cord Hook
11. Air Outlet
12. Air Outlet
13. Brush With Water Suction Cover
14. Suction Nozzle

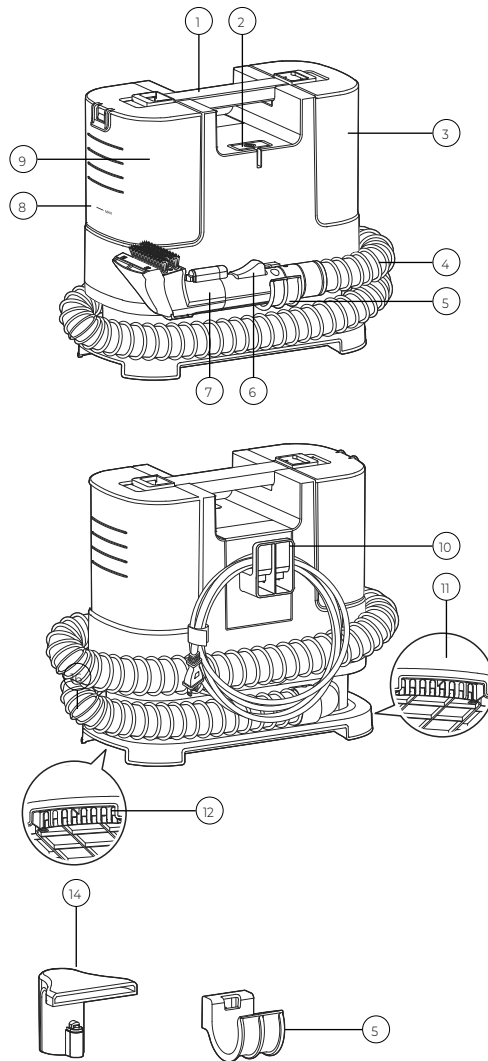

Technical Data:

Model:	T548005
Voltage:	220-240V
Wattage:	400W
Frequency:	50Hz
Clean Water Tank:	1.2Ltr
Dirty Water Tank:	1.2Ltr (Working Volume: 0.5L)

Wiring Safety for UK Use Only

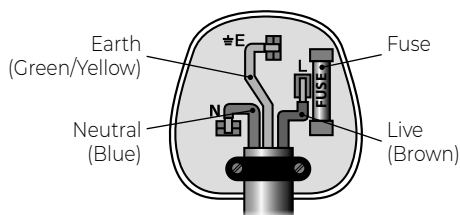

IMPORTANT

As the colours in the mains lead of this appliance may not correspond with the coloured markings identifying the terminals in your plug, please proceed as follows:

The wires in the mains lead are labelled in accordance with the following code:

Blue neutral [N] Brown live [L] Green/Yellow [EARTH]

Plug Fitting Details (Where Applicable).

The wire labelled blue is the neutral and must be connected to the terminal marked [N].

The wire labelled brown is the live wire and must be connected to the terminal marked [L].

The wire labelled green/yellow must be connected to the terminal marked with the letter [E].

On no account must either the brown or the blue wire be connected to the [EARTH] terminal. Always ensure that the cord grip is fastened correctly.

The plug must be fitted with a fuse of the same

rating already fitted and conforming to BS 1362 and be ASTA approved.

If in doubt consult a qualified electrician who will be pleased to do this for you.

Non-Rewireable Mains Plug.

If your appliance is supplied with a non-rewireable plug fitted to the mains lead and should the fuse need replacing, you must use an ASTA approved one (conforming to BS 1362 of the same rating).

If in doubt, consult a qualified electrician who will be pleased to do this for you.

If you need to remove the plug - disconnect it from the mains - then cut it off of the mains lead and immediately dispose of it in a safe manner. Never attempt to reuse the plug or insert it into a socket outlet as there is a danger of an electric shock.

WARNING:

This appliance **MUST** be earthed!

DISPOSAL OF THE UNIT

Appliances bearing the symbol shown here may not be disposed of in domestic rubbish. You are required to dispose of old electrical and electronic appliances like this separately.

Please visit www.recycle-more.co.uk or www.recyclenow.co.uk for access to information about the recycling of electrical items.

Please visit www.weeeireland.ie for access to information about the recycling of electrical items purchased in Ireland.

The WEEE directive, introduced in August 2006, states that all electrical items must be recycled, rather than taken to landfill.

Please arrange to take this appliance to your local Civic Amenity site for recycling, once it has reached the end of its life.



Important Safety Information:

Please read these notes carefully BEFORE using your Tower appliance

- Check that the voltage of the main circuit corresponds with the rating of the appliance before operating.
- If the supply cord or appliance is damaged, stop using the appliance immediately and seek advice from the manufacturer, its service agent or a similarly qualified person. Do not disassemble, repair or modify.
- DO NOT let the cord hang over the edge of a table or counter or let it come into contact with any hot surfaces.
- DO NOT carry the appliance by the power cord.
- DO NOT pull the plug out by the cord as this may damage the plug and/or the cable.
- DO NOT pull cord, use cord as a handle, close a door on cord, or pull cord around sharp edges or corners.
- DO NOT use any extension cord with this appliance.
- Switch off at the wall socket then remove the plug from the socket before fitting or removing tools/ attachments, when not in use or before cleaning.
- **WARNING:** Always switch off and unplug your machine from the electrical outlet before filling the clean water tank, emptying the dirty water tank, before assembling, opening, before connecting/ disconnecting the attachments, or carrying out maintenance or troubleshooting checks.
- DO NOT leave the appliance unattended when plugged in.
- DO NOT handle the plug or appliance with wet hands.
- Close supervision is necessary when any appliance is used by or near children.
- Children should not play with the appliance.

- This appliance can be used by children aged from 8 years and above and persons with reduced physical, sensory or mental capabilities or lack of experience and knowledge if they have been given supervision or instruction concerning use of the appliance in a safe way and understand the hazards involved.
- Cleaning and user maintenance should not be undertaken by children without supervision.
- Take care when any appliance is used near pets.
- Not suitable for carpets with long fibres as the bristles will damage the fibres.
- Keep the appliance moving over the carpet surface at all times to avoid damaging the carpet fibres.
- DO NOT use this product for anything other than its intended use.
- DO NOT immerse cords, plugs or any part of the appliance in water or any other liquid.
- This appliance is for household use only and NOT for commercial or industrial use.
- DO NOT use the appliance outdoors.
- Keep hair, loose clothing, fingers and all body parts away from openings.
- DO NOT put any objects into openings.
- DO NOT operate with openings blocked, keep them free of anything that may reduce suction.
- DO NOT use to pick up flammable or combustible liquids such as petrol or use in an area where they may be present.
- DO NOT use the appliance on any glowing, burning or smoking particles.
- DO NOT use the appliance to pick up fine particles such as powder, sand or dust.
- DO NOT use the appliance to pick up sharp items such as needles, pins and glass.

- DO NOT use the appliance without the solution tank and dirty water tank in place.
- DO NOT sit on the appliance.
- Use extra care when cleaning on stairs.
- Use only manufacturer's recommended accessories.
- To prevent dirty water from running into the motor, keep the unit on the floor, DO NOT hold the appliance upside-down or lay on its side. Use the appliance in a normal cleaning position.
- DO NOT use the appliance to clean arts and crafts, non-waterproof fibers (nets, acetic acid, rayon, etc.), non-waterproof products (furs, leather products, white wood furniture, tea sets, etc.) and vulnerable surfaces (floors, tables).
- Keep the appliance away from heat sources.
- In the unlikely event the appliance develops a fault, stop using it immediately and seek advice from the Customer Support Team:
+44 (0) 333 220 6066

Before First Use:

Read all instructions and safety information carefully before first use. Please retain this information for future reference.

1. Remove any packaging from the product and retain until you have checked all the parts are present and checked for any visible damage to the appliance or cord.
2. Prepare the appliance, as instructed below.
3. Vacuum the carpet thoroughly. Use a vacuum cleaner with a rotating brush bar for best results.
4. Test a small area of the carpet for colour fastness. To do this, dampen a white cloth with the carpet cleaning solution, rub it gently over a small, hidden test area and check for any colour bleeding. Check each colour. If the cloth remains clean and there is no colour bleeding, the carpet should be safe to clean.
5. Dispose of the packaging in a responsible manner.

Preparing the appliance:

1. Insert the hose hook into the body of the appliance.

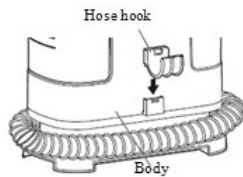

2. Slide the lock catch and lift the clean water tank from the unit.

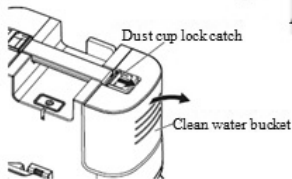

3. Unscrew the cap and fill the clean water tank with clean water up to the maximum level. Use tap water or alkali ionized water below 40°C.



4. Screw the cap tightly to prevent leakage.

- Re-install the clean water tank onto the appliance, sliding the tank into the unit until there is an audible click and the lock catch reengages.

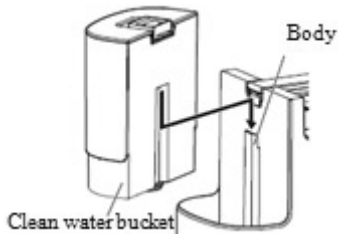

- Insert the handle into the chosen accessory attachment, ensuring that the water outlet hole is aligned.



Attaching the water suction cover:

- Align the holes on the front of the cover with the pins on the brush head and press the back of the cover until it engages with the brush head and there is an audible click.

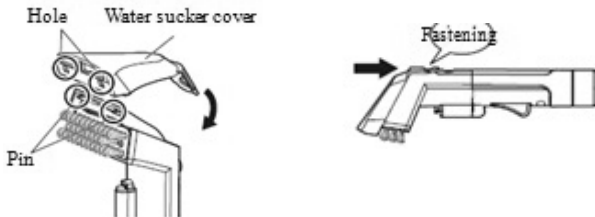

Note: To remove the accessory from the hose handle, press the button on the handle and pull the accessory away from the handle.

To remove the water suction cover, lift the tab on the cover and pull away from the brush head.



- Fix the hose and the power cord to their respective hooks before moving the appliance.

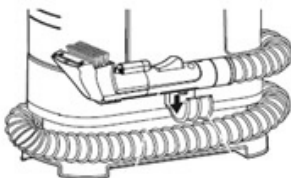

Accessories:

- Brush - To agitate stubborn stains and suck up spills on e.g. carpets
Suction Nozzle - For difficult to reach places such as the back of a chair

Using your Appliance:

- This portable carpet cleaner uses powerful suction to remove stains, spots and stubborn dirt in tricky spots around your home and car and is suitable for carpets, hard floors, stairs, upholstery and car interiors.
- This product is used to remove dirt by rinsing.
- Take care not to tilt the machine whilst water is in the tanks, in order to avoid spillage.
- Stop use and empty the dirty water tank when the 'max.' level is reached. If the appliance continues to be used after the tank exceeds the maximum water level, the floating ball will activate and the suction will stop.
- Be aware that fibrous carpets may block the air outlet, causing the appliance to stop operating.
- If the hose becomes blocked, turn off the appliance unplug before clearing the blockage.

1. Plug the cord in to an electrical socket and turn the socket on.
2. Press the on/off button to turn the appliance on.
3. Press the water spray button to activate the water spray.
Spray the stain with the clean water and allow it to soak in to the fibres. Do not spray continuously at the same spot.

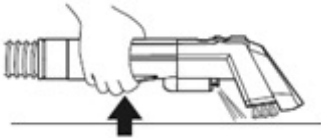

4. After spraying, absorb the dirty water, so as not to cause mildew and odour.
Press the water suction inlet on to the stain and pull backwards in order to bring the water and dirt up. Allow the appliance to suck up the dirty water.
Spray clean water while absorbing the dirty water.

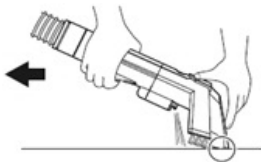

Stop spraying, and absorb the dirty water.

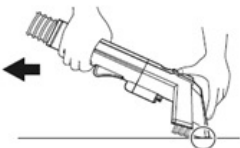

5. Use an absorbent cloth to dry the surface further and then allow to air dry.
6. Press the on/off button to turn off the appliance and then unplug.
7. Hang the cord on the unit's cord hook.
8. Empty the dirty water tank and any remaining water in the clean water tank. Refer to the Cleaning and Care section.

Stubborn Dirt:

Clean the area with cleaning solvent first, prior to scrubbing.

CAUTION! DO NOT put cleaning solvent in to the clean water tank.

CAUTION! Ensure that the solvent is not harmful to the carpet before use. For the amount and usage of the cleaning solvent, please read and follow the manufacturer's instructions carefully.

DO NOT use diluents, aniline, chloroform and flammable solvents.

Recommended:

- Alkali ionized water
- Citric acid
- Hydrochloric acid water
- Not recommended:
 - Neutral detergent for the kitchen
 - Alkaline detergent
 - Acid detergent

1. Apply the cleaning solvent to the carpet and rub the dirt with the brush to lift it up.

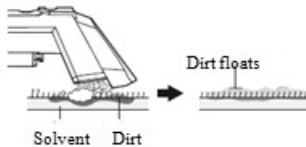

2. Spray the cleaning solvent with water and pull the water suction inlet backwards and forwards across the stain in order to suck up the water, solvent and dirt.



3. Do not leave any solvent.

Safety Cut-off:

The motor is equipped with a thermal cut-out. If for any reason, the appliance should over-heat, the thermostat will automatically turn the unit off. Should this occur:

1. Press the power switch and unplug the appliance from the electrical outlet.
2. Check for any blockages.
3. Clean the filters.
4. Allow the appliance to cool for approximately one hour.
5. Re-start the appliance; plug into an electrical outlet and switch back on.

Troubleshooting

Problem	Possible Solution
The appliance does not work after the switch is turned on	<p>Ensure that the plug is properly connected.</p> <p>Check that the power cord is not damaged.</p> <p>The overheat protection has activated. Refer to the Safety Cut-off section.</p>
When the water spray button is pressed, there is no or little water.	<p>Ensure that the nozzle is not blocked. Remove and rinse with clean water.</p> <p>Check that the handle or pump is not damaged.</p>
The suction does not work or is very weak.	<p>Ensure that the power switch is turned on.</p> <p>Ensure that the dirty water tank is correctly installed.</p> <p>Empty the dirty water tank. If this tank is full, the floating ball may have activated in the tank.</p> <p>Ensure that the hose is not twisted, damaged or blocked.</p> <p>Ensure that the inlet air sponge is not clogged. Clean or replace the sponge.</p>

Cleaning & Care

WARNING! Always switch off the appliance and unplug from the mains socket before carrying out and cleaning and care.

DO NOT use chemical cleaners or abrasives to clean the appliance.

DO NOT immerse the appliance, cord or plugs in water or any other liquid.

Cleaning the Dirty Water Tank:

Note: This unit is equipped with an overflow protection feature, which will filter water out of the front of the appliance whenever the dirty water tank is left full. This helps protect the electronics inside the appliance from accidental water damage when the tank is left full.

1. Empty the dirty water tank when full or when cleaning is complete, in order to prevent bacteria and bad odours.
2. Remove the dirty water tank taking care not to shake and tip the tank in order to prevent leakage.

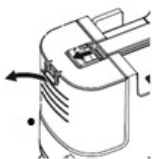

3. Open the upper cover of the dirty water tank, lifting the locking tab, and pour away the contents.



4. Clean the tank, upper cover and sealing strip.



5. Re- install the sealing ring and upper cover, ensuring the tabs at the rear of the cover fit into the slots of the tank. Press down until the locking tab reengages and there is an audible click.
6. Slide the dirty water tank into the unit until the locking tab engages and there is an audible click.

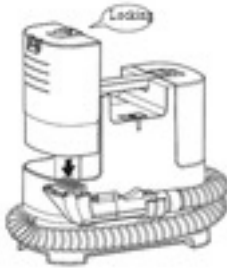

Cleaning the Clean Water Tank:

1. After use, pour away the residual water in the clean water tank to prevent leakage and mildew.
2. Remove the clean water tank.
3. Unscrew the screw cap and pour away the remaining water.



4. Re-install the empty tank and then plug in and turn on the power again.



5. Press the water spray button to remove the remaining water from the appliance. When water is no longer discharged, turn off the power switch and unplug the appliance.



6. Remove the clean water tank once more, tilt the appliance and pour away any remaining water in the base of the unit.

**Cleaning the Housing:**

Wipe the housing with a soft, damp cloth. Add a little detergent to remove any stubborn dirt.

Cleaning the Accessories:

Remove the used accessories from the appliance and rinse thoroughly with clean water. Allow to air dry.

Checking the Hose:

Always check the hose for breakage and leakage.

Cleaning the Inlet Air and Filter Sponges:

Rinse the inlet air sponge and filtering sponge after use, and replace them if they are damaged.

To access the inlet air sponge, remove the dirty water tank. The sponge is located in the unit beneath the tank.



To access the filter sponge, remove the clean water tank. The sponge is located in the unit beneath the tank.

**Tip:**

- Use a pair of tweezers to remove the sponges.
- Allow the sponges to dry after cleaning.
- Replace the sponges as necessary.

Storing the Appliance:

- Store in a dry place at room temperature, and avoid direct sunlight.
- Do not store in cold environments with water in the tanks, in order to prevent damage from freezing.





TOWER®

over 100 YEARS of quality

thank you!

We hope you enjoy your appliance for many years

This product is guaranteed for 12 months from the date of original purchase. If any defect arises due to faulty materials or workmanship, the faulty products must be returned to the place of purchase.

Refund or replacement is at the discretion of the retailer.

The Following Conditions Apply:

The product must be returned to the retailer with proof of purchase or a receipt. The product must be installed and used in accordance with the instructions contained in this instruction guide.

It must be used only for domestic purposes.

It does not cover wear and tear, damage, misuse or consumable parts.

Tower has limited liability for incidental or consequential loss or damage.

This guarantee is valid in the UK and Eire only.

The standard one year guarantee is only extended to the maximum available for each particular product upon registration of the product within 28 days of purchase. If you do not register the product with us within the 28 day period, your product is guaranteed for 1 year only.

To validate your extended warranty, please visit
www.towerhousewares.co.uk and register with us online.

Please note that length of extended warranty offered is dependent on product type and that each qualifying product needs to be registered individually in order to extend its warranty past the standard 1 year.

Extended warranty is only valid with proof of purchase or receipt.

Your warranty becomes void should you decide to use non Tower spare parts.

Spare parts can be purchased from
www.towerhousewares.co.uk

Should you have a problem with your appliance, or need any spare parts, please call our Customer Support Team on:

+44 (0) 333 220 6066

