

TOWER®

over 100 YEARS of quality

TCW5 AQUAJET PLUS

CARPET WASHER

BRING YOUR CARPET BACK TO LIFE!

T548003

SUITABLE
FOR HOMES
WITH PETS

QUICK
POWERFUL
COMPACT
& LIGHT

AQUA JETS
EASILY
REMOVE
PET MESS
& TOUGH
STAINS

REMOVABLE
HANDLE
FOR
COMPACT
STORAGE

LARGE
DUAL
TANK
TECHNOLOGY

5M
POWER
CORD

3*

YEAR
GUARANTEE



REMOVES
STUBBORN STAINS
AND ODOURS

For that fresh
“just like new”
carpet feeling

PLUS
FREE
250ml
CARPET
DETERGENT



For a powerful,
anti-allergen,
bacteria killing,
deep down clean

SAFETY AND INSTRUCTION MANUAL **PLEASE READ CAREFULLY**

*Subject to registering your Extended Guarantee online at www.towerhousewares.co.uk.

Specifications:

This box contains:

Instruction Manual
Carpet Washer
3 x Crosshead Screws
Carpet Cleaning Solution

1. Handle
2. Clean water tank release button
3. Clean water tank
4. Dirty water tank release latch
5. Dirty water tank handle
6. Exhaust filter
7. Dirty water tank
8. Brushbar (hidden)
9. Solution release trigger
10. Cord safety hook
11. Cord wrap
12. Cord
13. On/Off switch
14. Appliance recline pedal

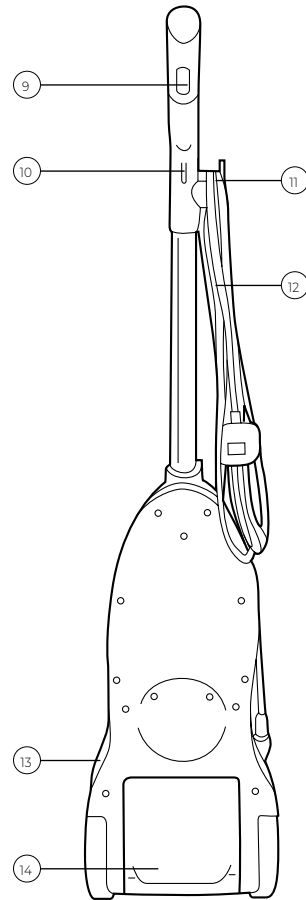
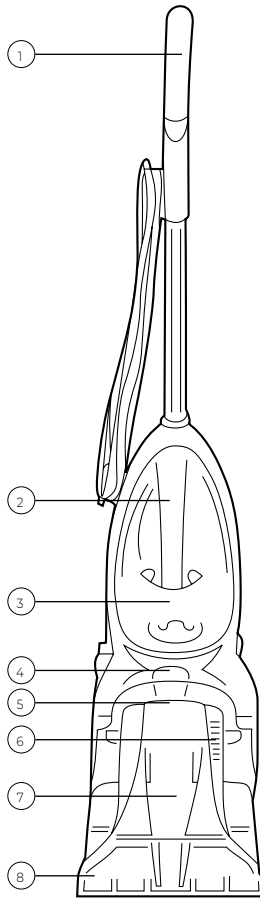

Technical Data:

Description:	Carpet Washer	Protection Class:	IPX4
Model:	T548003	Clean Water Tank:	2.3Ltr
Voltage:	220-240V	Dirty Water Tank:	1.5Ltr
Wattage:	500W	Weight:	5.8Kg
Frequency:	50-60Hz		

Documentation

We declare that this product conforms to the following product legislation in accordance with the following directive(s):

2014/30/EU	Electromagnetic Compatibility (EMC)
2014/35/EU	Low Voltage Directive (LVD)
2011/65/EU	Restriction of Hazardous Substances Directive. (including amendment (EU) 2015/863).

RK Wholesale LTD Quality Assurance, United Kingdom.

Wiring Safety for UK Use Only

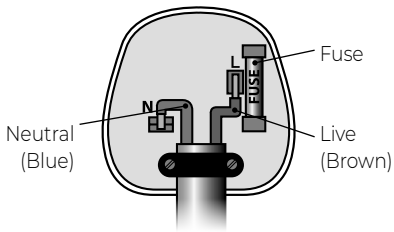

IMPORTANT

As the colours in the mains lead of this appliance may not correspond with the coloured markings identifying the terminals in your plug, please proceed as follows:

The wires in the mains lead are coloured in accordance with the following code:
Blue neutral [N] Brown live [L]

Plug Fitting Details (Where Applicable).

The wire coloured blue is the neutral and must be connected to the terminal marked [N] or coloured black.

The wire coloured brown is the live wire and must be connected to the terminal marked [L] or coloured red.

On no account must either the brown or the blue wire be connected to the [EARTH] terminal



Always ensure that the cord grip is fastened correctly.

The plug must be fitted with a fuse of the same rating already fitted and conforming to BS 1362 and be ASTA approved.

If in doubt please consult a qualified electrician who will be pleased to do this for you.

Non-Rewireable Mains Plug.

If your appliance is supplied with a non-rewireable plug fitted to the mains lead and should the fuse need replacing, you must use an ASTA approved one (conforming to BS 1362 of the same rating).

If in doubt, consult a qualified electrician who will be pleased to do this for you.

If you need to remove the plug – disconnect it from the mains – and then cut it off of the mains lead and immediately dispose of it in a safe manner. Never attempt to reuse the plug or insert it into a socket outlet as there is a danger of an electric shock.

WARNING:

This appliance is double insulated.
Do not connect any wire to the earth terminal.

DISPOSAL OF THE UNIT

Appliances bearing the symbol shown here may not be disposed of in domestic rubbish. You are required to dispose of old electrical and electronic appliances like this separately.

Please visit www.recycle-more.co.uk or www.recyclenow.co.uk for access to information about the recycling of electrical items.

Please visit www.weeeireland.ie for access to information about the recycling of electrical items purchased in Ireland.

The WEEE directive, introduced in August 2006, states that all electrical items must be recycled, rather than taken to landfill.

Please arrange to take this appliance to your local Civic Amenity site for recycling, once it has reached the end of its life.



Important Safety Information:

Please read these notes carefully BEFORE using your Tower appliance

- **DO NOT** let the cord hang over the edge of a table or counter or let it come into contact with any hot surfaces.
- **DO NOT** carry the appliance by the power cord.
- **DO NOT** use any extension cord with this appliance.
- **DO NOT** pull the plug out by the cord as this may damage the plug and/or the cable.
- Turn off all controls before unplugging.
- Switch off at the wall socket then remove the plug from the socket before fitting or removing tools/ attachments, when not in use or before cleaning.
- **WARNING:** Always switch off and unplug your machine from the electrical outlet before filling the clean water tank, emptying the dirty water tank, before assembling, opening, before connecting/ disconnecting the attachments, or carrying out maintenance or troubleshooting checks.
- **DO NOT** leave the carpet washer unattended when plugged in.
- **DO NOT** handle the plug or carpet washer with wet hands.
- Close supervision is necessary when any appliance is used by or near children.
- Children should not play with the appliance.
- This appliance can be used by children aged from 8 years and above and persons with reduced physical, sensory or mental capabilities or lack of experience and knowledge if they have been given supervision or instruction

concerning use of the appliance in a safe way and understand the hazards involved.

- Cleaning and user maintenance should not be undertaken by children without supervision.
- Take care when any appliance is used near pets.
- Not suitable for carpets with long fibres as the bristles will damage the fibres.
- Keep the vacuum cleaner moving over the carpet surface at all times to avoid damaging the carpet fibres.
- **DO NOT** use this product for anything other than its intended use.
- **DO NOT** immerse cords, plugs or any part of the appliance in water or any other liquid.
- This appliance is for household use only and NOT for commercial or industrial use.

- **DO NOT** use the appliance outdoors.
- Keep hair, loose clothing, fingers and all body parts away from openings or moving parts.
- **DO NOT** put any objects into openings or operate with openings blocked, keep them free of anything that may reduce airflow.
- **DO NOT** use to pick up flammable or combustible liquids such as petrol or use in an area where they may be present.
- **DO NOT** use the appliance without the solution tank and dirty water tank in place..
- **DO NOT** use the carpet washer on any glowing, burning or smoking particles.
- Use extra care when cleaning on stairs.
- Use only manufacturer's recommended accessories.

- **DO NOT** pull cord, use cord as a handle, close a door on cord, or pull cord around sharp edges or corners.
- **DO NOT** run carpet washer over the cord. Keep cord away from heated surfaces.
- To prevent dirty water from running into the motor, keep the unit on the floor, **DO NOT** hold the appliance upside-down or lay on its side. Use the appliance in a normal cleaning position.
- **DO NOT** carry the appliance while the motor is running.
- The motor is equipped with a thermal cut-out. If for any reason, the carpet washer should over-heat, the thermostat will automatically turn the unit off. Should this occur, unplug the appliance from the electrical outlet and turn off the switch. Remove the dirt container and empty. Clean the filters. Allow the appliance to cool for approximately one (1) hour. To re-start, plug into an electrical outlet and switch back on.
- In the unlikely event the appliance develops a fault, stop using it immediately and seek advice from the Customer Support Team:
+44 (0) 333 220 6066

Before First Use:

1. Read all instructions and safety information carefully before first use. Please retain this information for future reference.
2. Remove the product from the box.
3. Remove any packaging from the product.
4. Please retain all packaging until you have checked and counted all the parts and the contents against the parts list and checked for any visible damage to the appliance or cord.
5. Assemble the unit, as instructed below.
6. Prepare the carpet. To do this, remove as much furniture from the room as possible. Alternatively, place plastic or foil under and around the legs until the carpet has dried completely.
7. Vacuum the carpet thoroughly. Use a vacuum cleaner with a rotating brushbar for best results.
8. **IMPORTANT: DO NOT** use the carpet washer as a dry vacuum.
9. Test a small area of the carpet for colour fastness. To do this, dampen a white cloth with the included carpet cleaning solution, rub it gently over a small, hidden test area and check for any colour bleeding. Check each colour for colour bleeding. If the cloth remains clean and there is no colour bleeding, the carpet should be safe to clean.
10. Dispose of the packaging in a responsible manner.

USING YOUR APPLIANCE:

Components

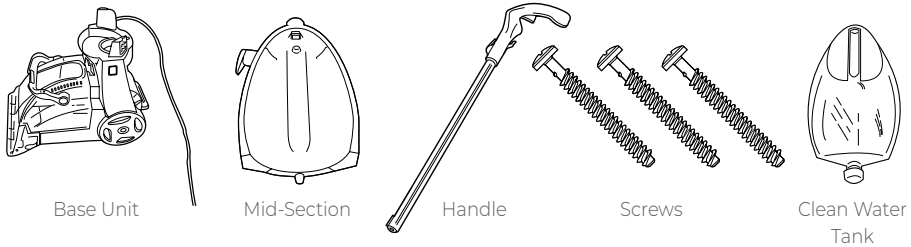

Assembly

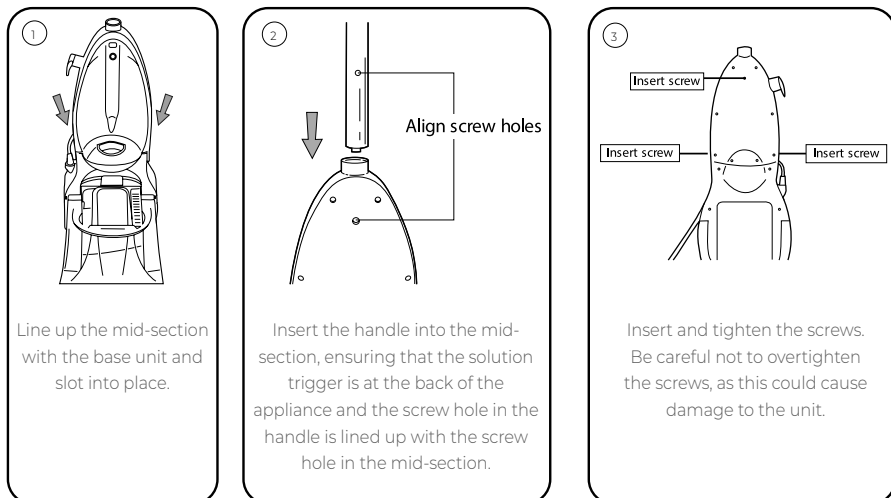

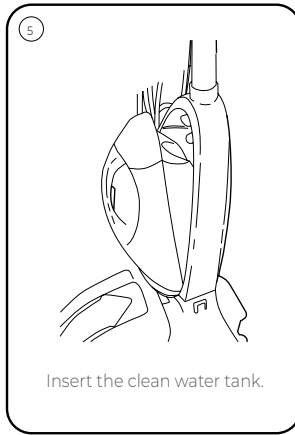
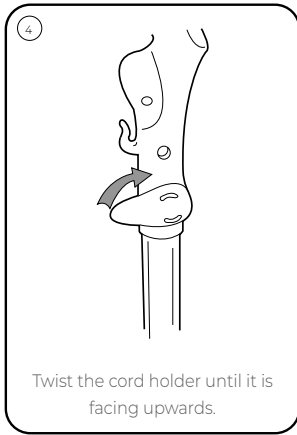

NOTE: The included carpet cleaning solution can be purchased (1 litre bottle code T146002) or replaced with any low-foaming carpet cleaning solutions available in the market.

Preparing the Appliance:

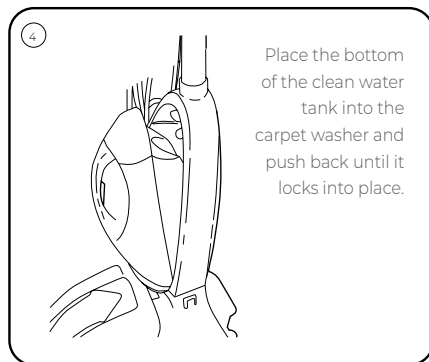
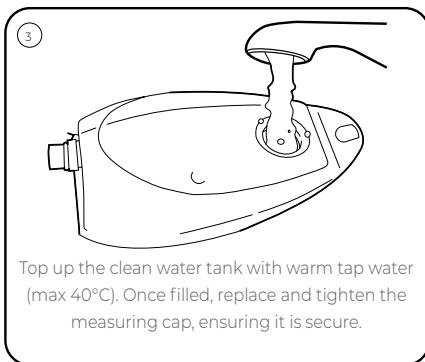
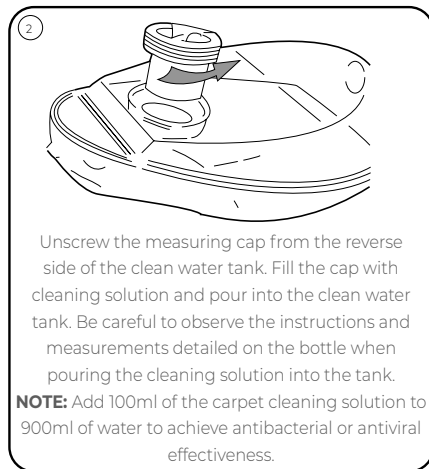
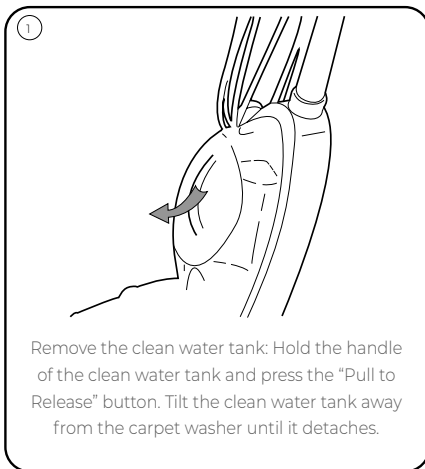

Using the Appliance:

1. When the water tank has been filled, plug the cord into an electrical socket and turn the socket on.
2. Turn on the appliance by using the on/off switch located on its side.

IMPORTANT: Never leave the appliance unattended with power on. Turn off and unplug when emptying and filling tanks. Do not saturate the carpet.

3. Put the machine into the cleaning position by stepping onto the recline pedal.
4. For the best results, press the solution spray trigger and push the carpet washer in a forward motion.
5. Release the trigger and pull the unit backwards in the same path to agitate and remove dirty water and solution from the carpet. For more heavily soiled areas, repeat as necessary.

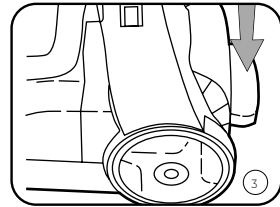

IMPORTANT: For best cleaning results use a steady, moderate, forward and backward motion. Always work from back to front across the room to avoid stepping on wet carpet and lowering the pile.

6. When the dirty water tank is full, lift the dirty water tank latch and remove the dirty water tank from the base unit using the tank handle.
7. Twist the dirty water tank outlet cap and remove. Empty the dirty water tank and rinse out. Replace the cap and then put the dirty water tank back into the unit.

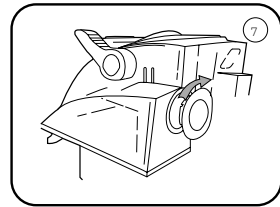
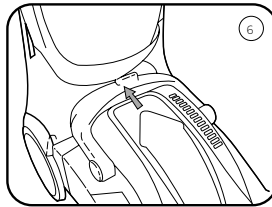

Tips for Carpet Cleaning:

1. Do not saturate carpet with cleaning solution while using the carpet washer.
2. For heavily soiled areas, additional applications may be necessary.
3. Allow plenty of time to dry carpet thoroughly.
4. Open a window or use a fan or dehumidifier to help a freshly cleaned carpet dry out faster and prevent the growth of mould or mildew.
5. Wipe cleaning solution from woodwork and wood to prevent any damage to these surfaces.
6. If the carpet is not dry and the furniture must be placed back in the room, use plastic or foil under the furniture to prevent staining the carpet.
7. Try not to walk on carpet until it is completely dry. If it is necessary to walk on the carpet, place white towels on the areas to be walked on.
8. After carpet is thoroughly dry, vacuum the carpet using a vacuum cleaner with a rotating brushbar.
9. Before cleaning, determine where to start and end, making sure not to walk over previously cleaned areas.

IMPORTANT: Do not use any chemicals when cleaning.

SAFETY INFORMATION FOR THE INCLUDED CARPET CLEANING SOLUTION:

- Keep out of the reach of children.
- Causes serious eye irritation.
- Harmful to aquatic life with long lasting effects.
- Avoid release to the environment.
- IF IN EYES: Rinse cautiously with water for several minutes. Remove contact lenses, if present and easy to do. Continue rinsing. If eye irritation persists: Get medical advice.
- Dispose of container in accordance with national regulations.

Troubleshooting

Problem	Possible Solution
The carpet washer will not work	Ensure the carpet cleaner is plugged into a mains socket and that the socket switch is turned to the ON position. If the unit will still not run, contact a qualified service person or our Customer Support team.
The suction power is weak while cleaning	The water tank may be full, or the filters may require cleaning. Empty the water tank and clean the filters, as detailed in the 'Cleaning and Care' section of this instruction manual. Ensure the water tank is correctly installed and secured into place within the main body of the unit.
The unit will not dispense cleaning solution when the trigger is pressed	Ensure the water tank is full. If necessary, fill the water tank as detailed in the 'Preparing the Appliance' section of this instruction manual. Ensure the water tank is correctly installed and secured into place within the main body of the unit.
The motor is making an unusual sound	The water tank is full. Empty the water tank as detailed in the 'Cleaning and Care' section of this instruction manual.

Cleaning & Care

NOTE: Ensure the carpet cleaner is turned off and unplugged from the mains before carrying out any cleaning or maintenance.

Cleaning the Water Tank:

Once carpet cleaning is fully complete, remove the dirty water tank as described above in the Using Your Appliance section and thoroughly clean and rinse with warm (max 40°C) tap water. Allow to dry completely before replacing in to the unit.

Cleaning the Filters:

IMPORTANT: Cleaning filters maintains cleaning performance. It is recommended that your filters should be checked and cleaned periodically. Make sure they are completely dry before inserting back into the machine.

1. Remove the filter.
2. Rinse the filter with warm water (max.40°C).

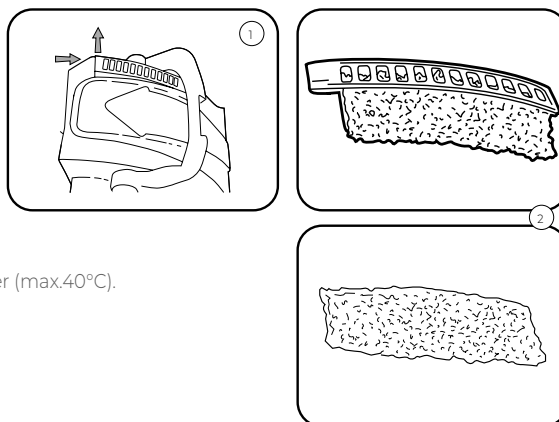

CAUTION! DO NOT allow water to enter any part of the unit other than the water tank, as this could cause damage to the internal components.

NOTE: DO NOT attempt to remove blockages with sharp objects as they may cause damage.

Storing the Appliance:

DO NOT store the appliance with solution in the clean water tank or dirty water in the dirty water tank. Mineral deposits and mildew can form with will affect the performance of the carpet washer. Ensure the appliance is unplugged and completely dry before storing.

Store the appliance in a cool, dry place, preferably in its original packaging and out of reach of children.

SPARE PARTS available to order via website/customer service should you require replacements)		
Part No	Description	Image
T146002	1 Litre Solution	

TOWER®

over 100 YEARS of quality

thank you!

We hope you enjoy your appliance for many years

This product is guaranteed for 12 months from the date of original purchase. If any defect arises due to faulty materials of workmanship, the faulty products must be returned to the place of purchase.

Refund or replacement is at the discretion of the retailer.

The Following Conditions Apply:

The product must be returned to the retailer with proof of purchase or a receipt. The product must be installed and used in accordance with the instructions contained in this instruction guide.

It must be used only for domestic purposes.

It does not cover wear and tear, damage, misuse or consumable parts.

Tower has limited liability for incidental or consequential loss or damage.

This guarantee is valid in the UK and Eire only.

The standard one year guarantee is only extended to the maximum available for each particular product upon registration of the product within 28 days of purchase. If you do not register the product with us within the 28 day period, your product is guaranteed for 1 year only.

To validate your extended warranty, please visit www.towerhousewares.co.uk and register with us online.

Please note that length of extended warranty offered is dependent on product type and that each qualifying product needs to be registered individually in order to extend its warranty past the standard 1 year.

Extended warranty is only valid with proof of purchase or receipt.

Your warranty becomes void should you decide to use non Tower spare parts.

Spare parts can be purchased from

www.towerhousewares.co.uk

Should you have a problem with your appliance, or need any spare parts, please call our Customer Support Team on:

+44 (0) 333 220 6066

